

Well #2

STATE WELL REPORT

204

County: Yazoo
 Permit #: _____
 Driller: David West
 Date drilling completed: 11-9-2018

Part 1
Driller's Log
 Mississippi Department of Environmental Quality
 Office of Land and Water Resources
 P.O. Box 2309
 Jackson, MS 39225-2309
 (601)961-5555
 (601)961-5228 (fax)

For Office Use Only:
 Well #: Q 85
 Aquifer: _____
 E-Log #: _____

State Law requires that this report be prepared by the license holder responsible for the work and filed with the Department at the above address within 30 days of completion of drilling of the well or borehole.

Well Owner Information (Landowner if borehole is not for a water well)	Well or Borehole Location
Owner Name: <u>Century Resources</u>	Latitude: <u>32.740089</u> Longitude: <u>-90.463069</u>
Mailing Address: <u>5320 Legacy Dr.</u>	<u>32-44-45.91</u> <u>90-27-47.04</u> Method of Lat/Long (check one): Conventional Survey _____
	USGS quad _____, Hand-held GPS _____, Survey-grade GPS _____
<u>Piano</u> Tx <u>95024</u>	<u>NW 1/4 NE 1/4, Sec 1 T10N R3W</u>
City State Zip Code	<u>7</u> Miles <u>S</u> of <u>Yazoo City</u>
Telephone No. <u>(972) 693-2000</u>	(Distance) (Direction) (Nearest Town)

Well / Borehole Data

Date drilling started: 11-8-2018 Date drilling completed: 11-9-2018 Hole depth: 390' Hole diameter: 6 1/2"

Location of the source of any surface water used for drilling: Well water

Method of dosing and volume of Chlorine used in drilling and development: Tabs 50 ppm

Logs run (check all applicable): log run Electric Gamma Ray Density Sonic Neutron Other: _____

Name of organization running log(s): _____

Purpose of borehole (check one): Water Well Geotechnical/Geological Investigation Ground Source Heat Pump Seismic Survey Other (describe) _____

If drilling is not related to water well construction, skip the remainder of this block

Purpose of Well (check all applicable): Home Industrial Public Supply Irrigation Fish Culture
 Other (describe): Wig Supply

If a flowing well, method of flow regulation: Valve _____ Other (describe) _____

Static Water Level: 108 feet above or below land surface Date measured: 11-9-2018
 (check one)

Method of measurement (check one) Steel tape Electric tape Air line Other (describe): Sonic

Well depth: 390' Well grouted to a depth of: 50 feet Type of grout (check one) Neat Cement Bentonite Mix

Casing length: 330 feet Casing diameter: 4 inches Type of casing: Pvc

Screen length: 60 feet Screen diameter: 4 inches Type of screen: Pvc

Screen slot size: .010 inches Setting depth: From 330 feet to 390 feet

Type of completion (check all applicable) gravel packed Underreamed Open hole Natural Development

Other (describe): _____

Top of lap pipe or reduction in casing: _____ feet

If telescoped or more than one screen, describe on next page

well#2

County: Yazoo
Permit #: _____

For Office Use Only:
Well #: Q 85

The sketch below only required for water wells

If well telescopes, show depths on sketch.

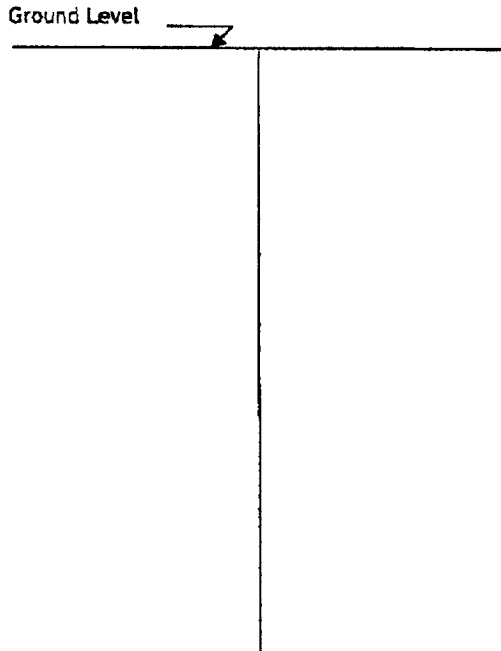

Description of formations encountered must be provided for all wells and boreholes, unless specifically exempted by regulations

Description of Formations Encountered	From (depth)	To (depth)
Clay	Ground level	75
Sandy clay	75	118
clay	118	220
Sandy streaks	220	300
sand	300	390

If more than one screen, show location of each on sketch

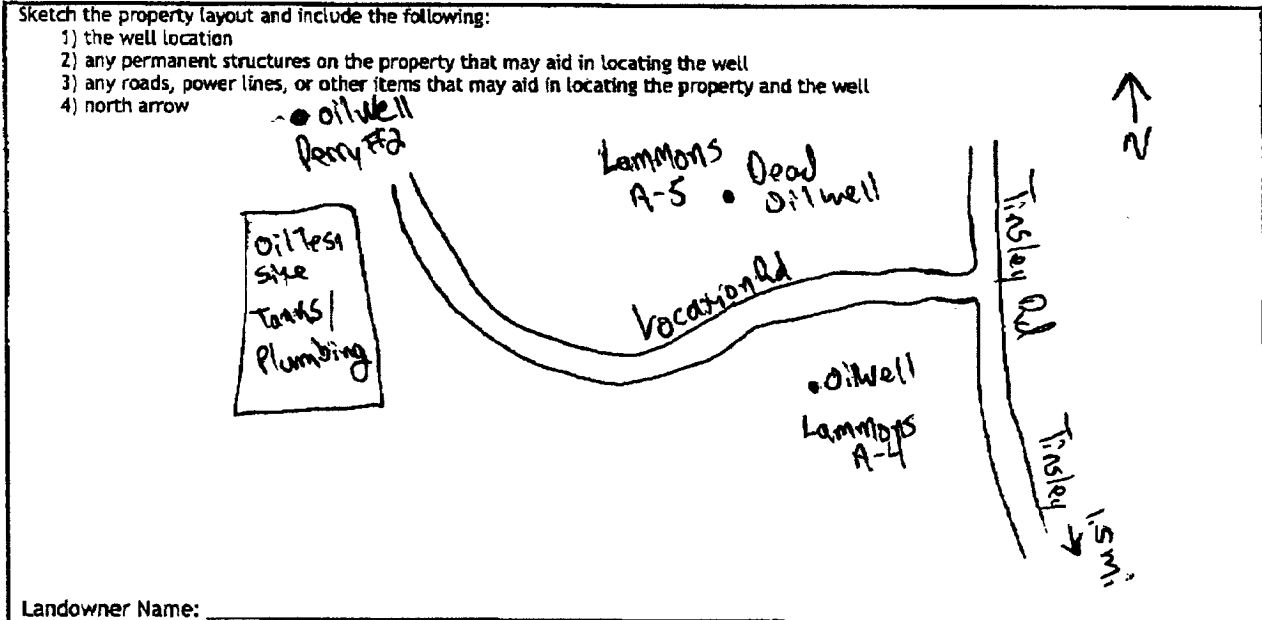

Landowner Name: _____

I HEREBY CERTIFY that the well/borehole was drilled, constructed, and completed in accordance with all applicable requirements of the Mississippi Department of Environmental Quality and the Mississippi Department of Health regulations, if applicable, and state laws.

David West 0672 11-12-2013 [Signature]
Print Name of Responsible Licensee and License No. Date Signature of Licensee

STATE WELL REPORT

Part 2

Pump Installer's Completion Report
Mississippi Department of Environmental Quality
Office of Land and Water Resources
P.O. Box 2309
Jackson, MS 39225-2309
(601)961-5210
(601) 360-0535 (fax)

For Office Use Only:

Well #: 985
Aquifer: _____

County: W200
Permit #: _____
Driller: David West
Date completed: 11-9-2018
Copy information from block on Part 1

This part of the report must be completed by a licensed water well contractor or a licensed pump installer. A copy of Part 1 of the report must be attached and both parts filed with the Department at the above address within 30 days of well completion.

Well Owner Information			Well Location	
Owner Name:	<u>Denbury Resources</u>		Latitude:	<u>32.741087</u>
Mailing Address:	<u>5320 Legacy Dr.</u>		Longitude:	<u>-90.463067</u>
City:	State:	Zip Code:	Method of Lat/Long (check one): Conventional Survey _____	
<u>Plano</u>	<u>Tx</u>	<u>75024</u>	USGS quad _____, Hand-held GPS _____, Survey-grade GPS _____	
Telephone No.:	<u>(972) 673-2000</u>		<u>NW 1/4 NE 1/4, Sec 1 T 10N R 3W</u>	
			<u>7</u> Miles <u>S</u> of <u>Vado CW</u>	
			(Distance) (Direction) (Nearest Town)	

Pump Type (check one)

Submersible Turbine Air Lift Centrifugal Flowing Well Jet Piston Rotary Other (describe): _____

Date Pump Installed: 11-14-2018 Rated Pump Capacity: 85 Gallons Per Minute

Is This Pump (check one): New Repaired Replacement

Power Type (check one)

Electric Diesel Gasoline Natural Gas Tractor PTO Windmill Other (describe): _____

Horse Power Rating of Motor: 7.5 Setting Depth: 200 feet Number of Stages: _____

Pump Test Data for Non Flowing Well

Date Well Tested: _____ Duration of Pump Test (minimum 4 hours): _____ hours

Static Water Level (A): _____ Feet Below Land Surface Pumping Water Level (B): _____ Feet Below Land Surface

Drawdown ((B) - (A)): _____ Feet Below Land Surface Test Pumping Rate: _____ Gallons Per Minute

Method of measurement (check one): Steel tape Electric tape Air line Other (describe): _____

Pump Test Data for Flowing Well

Measured shut in head: _____ feet.

Well yielded _____ GPM with a drawdown of _____ feet after _____ hours of pumping

Meter Installation

Meter Manufacturer: _____ Meter Serial Number: _____

Meter Model Number/Name: _____ Type of Meter: _____

Totalizer Register Unit and Multiplier Factor (AF x .001, gal x 1000, etc): _____

Installation Date: _____ Meter installed by: _____

Is This Meter (check one): New Repaired Replacement

Important: By submitting the above information you are certifying that this meter was installed to manufacturer standards. For agricultural wells, a list of approved meters is on the MDEQ website.

I HEREBY CERTIFY that the above statements are true to the best of my knowledge.

David West 0672 11-12-2018 [Signature]
Print Name of Pump Installer and License No. (if applicable) Date Signature of Pump Installer