

STATE WELL REPORT

Part 1

Driller's Log

Mississippi Department of Environmental Quality
 Office of Land and Water Resources
 P.O. Box 2309
 Jackson, MS 39225-2309
 (601)961-5555
 (601)961-5228 (fax)

For Office Use Only:

Well #: Q80
 Aquifer: _____
 E-Log #: _____

County: Yazoo
 Permit #: _____
 Driller: Dand West
 Date drilling completed: 3-2-2018

State Law requires that this report be prepared by the license holder responsible for the work and filed with the Department at the above address within 30 days of completion of drilling of the well or borehole.

Well Owner Information <i>(Landowner if borehole is not for a water well)</i> Owner Name: <u>Mike Harris</u> Mailing Address: <u>2393 Hwy 3 Tinsley Rd</u> <u>Yazoo City</u> <u>MS</u> <u>39194</u> City State Zip Code Telephone No. <u>(601) 571-9148</u>			Well or Borehole Location Latitude: <u>32.72351°</u> Longitude: <u>90.47521°</u> <u>32-43-25</u> <u>90-28-31</u> Method of Lat/Long (check one): Conventional Survey _____ USGS quad _____, Hand-held GPS _____, Survey-grade GPS _____ <u>SW 1/4 SE 1/4, Sec 11 T10N R3W</u> _____ Miles _____ of _____ (Distance) (Direction) (Nearest Town)		
--	--	--	--	--	--

Well / Borehole Data

Date drilling started: 3-2-18 Date drilling completed: 3-2-18 Hole depth: 42.5' Hole diameter: 6"

Location of the source of any surface water used for drilling: Community Water

Method of dosing and volume of Chlorine used in drilling and development: _____

Logs run (check all applicable): log run Electric Gamma Ray Density Sonic Neutron Other: _____

Name of organization running log(s): _____

Purpose of borehole (check one): Water Well Geotechnical/Geological Investigation Ground Source Heat Pump
 Seismic Survey Other (describe) _____

If drilling is not related to water well construction, skip the remainder of this block

Purpose of Well (check all applicable): Home Industrial Public Supply Irrigation Fish Culture
 Other (describe): _____

If a flowing well, method of flow regulation: Valve _____ Other (describe) _____

Static Water Level: 118 feet above or below land surface Date measured: 3-2-2018
 (check one)

Method of measurement (check one) Steel tape Electric tape Air line Other (describe): Sonic

Well depth: 42.5 Well grouted to a depth of: 50 feet Type of grout (check one) Neat Cement Bentonite Mix

Casing length: 385 feet Casing diameter: 4 inches Type of casing: PVC

Screen length: 40 feet Screen diameter: 4 inches Type of screen: PVC

Screen slot size: .008 inches Setting depth: From 385 feet to 42.5 feet

Type of completion (check all applicable) gravel packed Underreamed Open hole Natural Development
 Other (describe): _____

Top of tap pipe or reduction in casing: _____ feet

If telescoped or more than one screen, describe on next page

County: Yazoo
 Permit #: _____

For Office Use Only:
 Well #: 280

The sketch below only required for water wells
If well telescopes, show depths on sketch.

Description of formations encountered must be provided for all wells and boreholes, unless specifically exempted by regulations

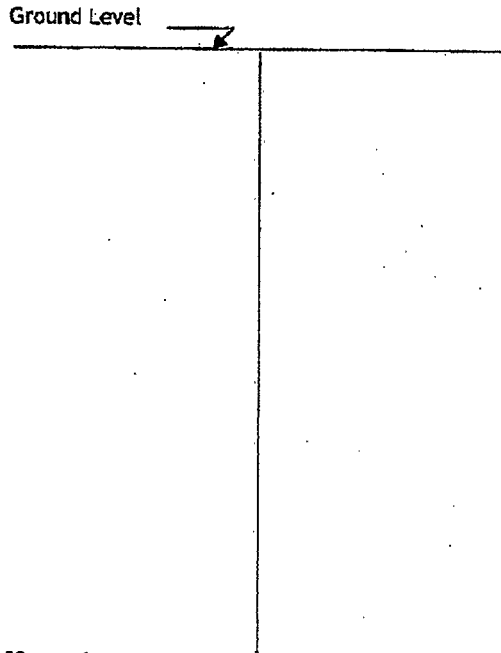

Description of Formations Encountered	From (depth)	To (depth)
Clay	Ground level	49
Gravel/Sand	49	78
Clay	78	190
Mandy's	190	220
Sand - occasional clay beads	220	425

If more than one screen, show location of each on sketch

- Sketch the property layout and include the following:
- 1) the well location
 - 2) any permanent structures on the property that may aid in locating the well
 - 3) any roads, power lines, or other items that may aid in locating the property and the well
 - 4) north arrow

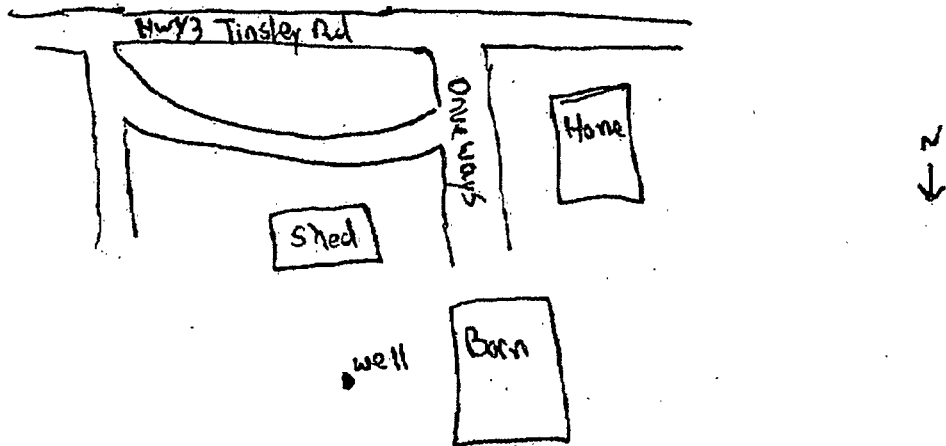

Landowner Name: Mike Horns

I HEREBY CERTIFY that the well/borehole was drilled, constructed, and completed in accordance with all applicable requirements of the Mississippi Department of Environmental Quality and the Mississippi Department of Health regulations, if applicable, and state laws.

David West 0-672
 Print Name of Responsible Licensee and License No.

3-12-2018
 Date

[Signature]
 Signature of Licensee

STATE WELL REPORT

Part 2

Pump Installer's Completion Report

Mississippi Department of Environmental Quality
 Office of Land and Water Resources
 P.O. Box 2309
 Jackson, MS 39225-2309
 (601)961-5210
 (601) 360-0535 (fax)

For Office Use Only:

Well #: Q80
 Aquifer: _____

County: Yazoo
 Permit #: _____
 Driller: David West
 Date completed: 3-2-2018
Copy information from block on Part 1

This part of the report must be completed by a licensed water well contractor or a licensed pump installer. A copy of Part 1 of the report must be attached and both parts filed with the Department at the above address within 30 days of well completion.

Well Owner Information			Well Location	
Owner Name: <u>Mike Harris</u>			<u>32-43-25</u>	<u>90-28-31</u>
Mailing Address: <u>2393 HWY 3 Tinsley Rd.</u>			Latitude: <u>32.72354°</u>	Longitude: <u>90.47521°</u>
<u>Yazoo City</u> <u>MS</u> <u>39194</u>			Method of Lat/Long (check one): Conventional Survey _____	
City State Zip Code			USGS quad _____, Hand-held GPS _____, Survey-grade GPS _____	
Telephone No. <u>(662) 571-7148</u>			<u>SW 1/4 SE 1/4, Sec 11 T10N R3W</u>	
			Miles _____ of _____	(Distance) (Direction) (Nearest Town)

Pump Type (check one)

Submersible Turbine Air Lift Centrifugal Flowing Well Jet Piston Rotary Other (describe): _____

Date Pump Installed: 3-3-2018 Rated Pump Capacity: 30 Gallons Per Minute

Is This Pump (check one): New Repaired Replacement

Power Type (check one)

Electric Diesel Gasoline Natural Gas Tractor PTO Windmill Other (describe): _____

Horse Power Rating of Motor: 3 Setting Depth: 168 feet Number of Stages: _____

Pump Test Data for Non Flowing Well

Date Well Tested: _____ Duration of Pump Test (minimum 4 hours): _____ hours

Static Water Level (A): _____ Feet Below Land Surface Pumping Water Level (B): _____ Feet Below Land Surface

Drawdown [(B) - (A)]: _____ Feet Below Land Surface Test Pumping Rate: _____ Gallons Per Minute

Method of measurement (check one): Steel tape Electric tape Air line Other (describe): _____

Pump Test Data for Flowing Well

Measured shut in head: _____ feet.

Well yielded _____ GPM with a drawdown of _____ feet after _____ hours of pumping

Meter Installation

Meter Manufacturer: _____ Meter Serial Number: _____

Meter Model Number/Name: _____ Type of Meter: _____

Totalizer Register Unit and Multiplier Factor (AF x .001, gal x 1000, etc): _____

Installation Date: _____ Meter installed by: _____

Is This Meter (check one): New Repaired Replacement

Important: By submitting the above information you are certifying that this meter was installed to manufacturer standards. For agricultural wells, a list of approved meters is on the MDEQ website.

I HEREBY CERTIFY that the above statements are true to the best of my knowledge.

David West 0672 3-2-2018 David West
 Print Name of Pump Installer and License No. (if applicable) Date Signature of Pump Installer

