





County: Yazoo  
 Permit #: GW-49908  
 Driller: Irrigation Equipment, Inc.  
 Date drilling completed: 4-7-17  
*Copy information from block on Part 1*

**STATE WELL REPORT**  
**Part 2**  
**Pump Installer's Completion Report**  
 Mississippi Department of Environmental Quality  
 Office of Land and Water Resources  
 P.O. Box 2309  
 Jackson, MS 39225-2309  
 (601) 961-5210  
 (601) 360-0535 (fax)

**For Office Use Only:**

Well #: J152  
 Aquifer: \_\_\_\_\_

*This part of the report must be completed by a licensed water well contractor or a licensed pump installer. A copy of Part 1 of the report must be attached and both parts filed with the Department at the above address within 30 days of well completion.*

Well Owner Information	Well Location
Owner Name: <u>Love, Linda Rae and Carol Shannon</u>	Latitude: <u>32° 49' 02.6"</u> Longitude: <u>090° 45' 20.3"</u>
Mailing Address: <u>P.O. Box 1045</u>	Method of Lat/Long (check one): <input type="checkbox"/> Conventional Survey, <input type="checkbox"/> USGS quad, <input checked="" type="checkbox"/> Hand-held GPS, <input type="checkbox"/> Survey-grade GPS
<u>Yazoo City</u> <u>MS</u> <u>39194</u> City State Zip code	<u>SW 1/4 NW 1/4, Sec 7 T 11N R 5W</u>
Telephone No. <u>( ) -</u>	<u>      </u> Miles <u>West</u> of <u>Holly Bluff</u> (Distance) (Direction) (Nearest Town)

**Pump Type (check one)**

Submersible  Turbine  Air Lift  Centrifugal  Flowing Well  Jet  Piston  Rotary  Other (describe): \_\_\_\_\_

Date Pump Installed 4-8-17 Rated Pump Capacity: 2100+/- Gallons Per Minute

Is This Pump (check one):  New  Repaired  Replacement

**Power Type (check one)**

Electric  Diesel  Gasoline  Natural Gas  Tractor PTO  Windmill  Other (describe): \_\_\_\_\_

Horse Power Rating of Motor: 60 Setting Depth: 70 feet Number of Stages: 1

**Pump Test Data for Non Flowing Well**

Date Well Tested: \_\_\_\_\_ Duration of Pump Test (minimum 4 hours): \_\_\_\_\_ Hours

Static Water Level (A): \_\_\_\_\_ Feet Below Land Surface Pumping Water Level (B): \_\_\_\_\_ Feet Below Land Surface

Drawdown [(B) - (A)]: \_\_\_\_\_ Feet Below Land Surface Test Pumping Rate: \_\_\_\_\_ Gallons Per Minute

Method of measurement (check one):  Steel tape  Electric tape  Air line  Other (describe): \_\_\_\_\_

**Pump Test Data for Flowing Well**

Measured shut in head: \_\_\_\_\_ Feet

Well yielded \_\_\_\_\_ GPM with a drawdown of \_\_\_\_\_ feet after \_\_\_\_\_ hours of pumping

**RECEIVED**  
 APR 05 2017

**Meter Installation**

Meter Manufacturer: \_\_\_\_\_ Meter Serial Number: \_\_\_\_\_

Meter Model Number/Name: \_\_\_\_\_ Type of Meter: \_\_\_\_\_

Totalizer Register Unit and Multiplier Factor (AF x .001, gal x 1000, etc): \_\_\_\_\_

Installation Date: \_\_\_\_\_ Meter installed by: \_\_\_\_\_

Is This Meter (check one):  New  Repaired  Replacement

*Important: By submitting the above information you are certifying that this meter was installed to manufacturer standards.  
 For agricultural wells, a list of approved meters is on the MDEQ website.*

**BY OLW/R**

I HEREBY CERTIFY that the above statements are true to the best of my knowledge.

0695 6-30-17  
 Print Name of Pump Installer and License No. (if applicable) Date

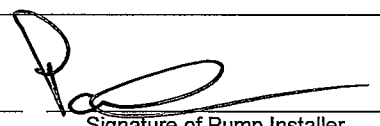
  
 Signature of Pump Installer  
 Form: OLWR-SWR-1B (4/13)

# STATE OF MISSISSIPPI

Department of Environmental Quality

Office of Land and Water Resources

P. O. Box 2309

Jackson, Mississippi 39225

J152

## PERMIT

### TO DIVERT OR WITHDRAW FOR BENEFICIAL USE THE PUBLIC WATERS

This permit is issued to the landowner named below in accordance with the provisions of the Mississippi Water Laws, Mississippi Code Sections 51-3-1, et seq. (1972, as amended), and the regulations and standards as promulgated thereunder. Whether or not specifically named in this permit or in the applications for this permit, anyone using water from the diversion/withdrawal point described below shall do so in compliance with the provisions of this permit. Neither this permit, nor any authority conferred hereby, may be sold, conveyed, encumbered, assigned, or otherwise aliened, for any period of time or under any conditions whatsoever. This permit may not be modified, transferred or revoked without prior action by the Permit Board. Any attempts to modify, transfer or revoke this permit, or to take any other action on this permit, shall be invalid and unenforceable and may result in immediate revocation or suspension of this permit. The holder of this permit shall at all times be responsible for adherence to the terms and conditions of this permit. No agreement between the permit holder and any other party shall affect the obligations and liabilities of the permit holder. Water use under this permit is allowed only when the streamflow, lake level elevation, or static groundwater level (whichever, if any, is applicable) is above the established minimum, pursuant to Mississippi Code Section 51-3-7. Authorization is hereby granted to divert/withdraw water for the beneficial use designated herein, and for no other purpose, subject to the following terms, conditions, and limitations:

**Permit Number:** MS-GW-49908

**Landowner Name:** LOVE, CAROL SHANNON AND LINDA RAE SHANNON

**Landowner Address:** PO BOX 1045

YAZOO CITY MS 39194

**Source Of Water:** MISSISSIPPI RIVER VALLEY ALLUVIAL AQUIFER

**Beneficial Use:** IRRIGATION

**Diversion/Withdrawal Location:** IR 1/4 of the IR 1/4

**Section:** 07 **Township:** 11N **Range:** 05W

**County:** YAZOO

**Quad:** RED ROCK

**Maximum Volume:** 188 Acre-Feet/Year equivalent to .1678 Million Gallons/Day

**Maximum Rate:** 2500 Gallons/Minute

**Applicant Name:** MWB FARMS

**Applicant Address:** PO BOX 463

BENTONIA MS 39040

**Date Permit Issued:** 06/22/2017

**Date Permit Expires:** 06/22/2022

**Date Permit Modified:**

**Date Permit Re-issued:**

This permit shall be deemed null and void if construction has not begun within one (1) year of permit issue date.

**SPECIAL TERMS AND CONDITIONS:** SEE ATTACHMENT 1, WHICH IS HEREBY DECLARED TO BE PART OF THIS PERMIT.

**SPECIAL TERMS AND CONDITIONS:** 2:

RECEIVED

JUL 05 2017

BY OLWR

Gary C. Rikard, Executive Director

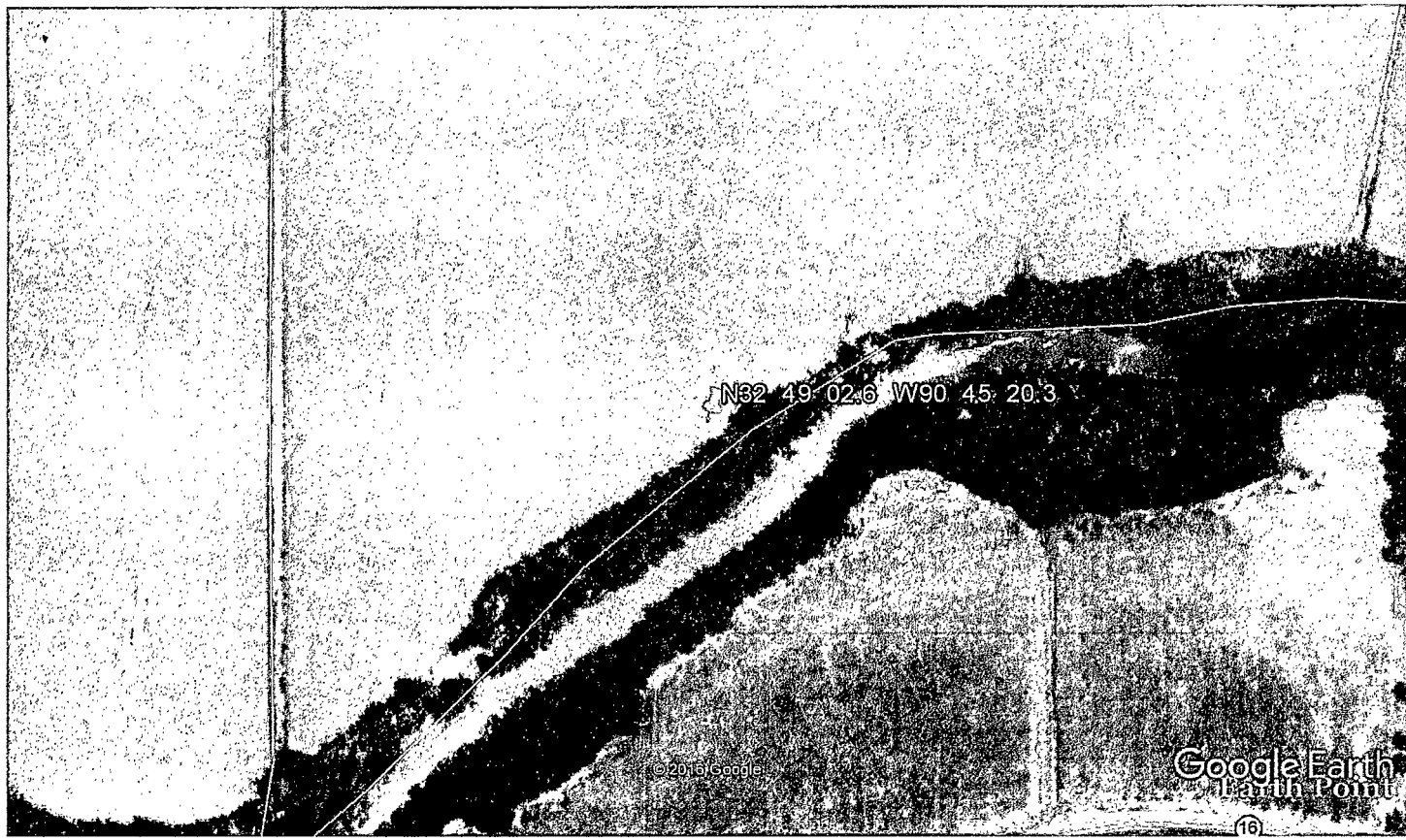

Google Earth



RECEIVED  
 JUL 05 2017  
 BY OLWR  
 RECEIVED  
 JUL 6  
 BY OLWR