

SDSmith et al 1H

STATE WELL REPORT

Part 1

Driller's Log

Mississippi Department of Environmental Quality
Office of Land and Water Resources
P.O. Box 2309
Jackson, MS 39225-2309
(601)961-5210
(601)360-0535 (fax)

For Office Use Only:

Well #: R69
Aquifer: _____
E-Log #: _____

County: Wilkinson
Permit #: _____
Driller: Gary Rayborn
Date drilling completed: 5/31/14

State Law requires that this report be prepared by the license holder responsible for the work and filed with the Department at the above address within 30 days of completion of drilling of the well or borehole.

Well Owner Information <i>(Landowner if borehole is not for a water well)</i>	Well or Borehole Location
Owner Name: <u>Halcon Resources</u>	Latitude: <u>31.00203"</u> Longitude: <u>91.27800"</u> <small>31-01-19 91-16-41</small>
Mailing Address: <u>1000 Louisiana St.</u>	Method of Lat/Long (check one): Conventional Survey _____
<u>Suite 6700</u>	USGS quad _____, Hand-held GPS _____, Survey-grade GPS _____
<u>Houston TX 77002</u>	<u>1R 1/4 NW 1/4, Sec 44 T 1N R 2W</u>
City State Zip Code	<u>5.5</u> Miles <u>S/SE</u> of <u>Woodville</u>
Telephone No. <u>(830) 202-0047</u>	(Distance) (Direction) (Nearest Town)

Well / Borehole Data

Date drilling started: 5/31/14 Date drilling completed: 5/31/14 Hole depth: 180 Hole diameter: 4"

Location of the source of any surface water used for drilling: _____

Method of dosing and volume of Chlorine used in drilling and development: _____

Logs run (circle all applicable): No log run Electric Gamma Ray Density Sonic Neutron Other: _____

Name of organization running log(s): _____

Purpose of borehole (circle one): Water Well Geotechnical/Geological Investigation Ground Source Heat Pump
 Seismic Survey Other (describe) _____

If drilling is not related to water well construction, skip the remainder of this block

Purpose of Well (circle all applicable): Home Industrial Public Supply Irrigation Fish Culture
Other (describe): RIG SUPPLY

If a flowing well, method of flow regulation: Valve _____ Other (describe) _____

Static Water Level: 90 feet [above or below] land surface Date measured: 5/31/14
(circle one)

Method of measurement (circle one): Steel tape Electric tape Air line Other (describe): _____

Well depth: 180 Well grouted to a depth of: 180 feet Type of grout (circle one): Neat Cement Bentonite Mix

Casing length: 160 feet Casing diameter: 4 inches Type of casing: PVC

Screen length: 20 feet Screen diameter: 4 inches Type of screen: PVC

Screen slot size: .020 inches Setting depth: From 160 feet to 180 feet

Type of completion (circle all applicable): Gravel packed Underreamed Open hole Natural Development

Other (describe): _____

Top of lap pipe or reduction in casing: _____ feet

If telescoped or more than one screen, describe on next page

Received
JUN 24 2014
BY OLWR

County: Wilkinson
 Permit #: _____

For Office Use Only:
 Well #: R69

The sketch below only required for water wells
If well telescopes, show depths on sketch.

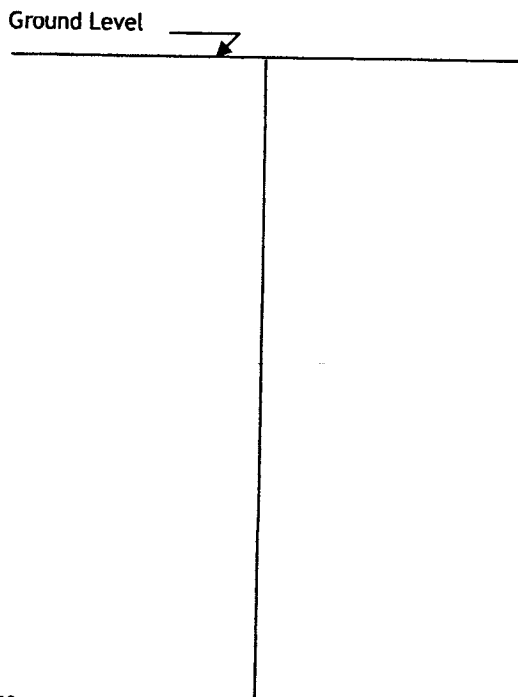

Description of formations encountered must be provided for all wells and boreholes, unless specifically exempted by regulations

Description of Formations Encountered	From (depth) Ground level	To (depth)

If more than one screen, show location of each on sketch

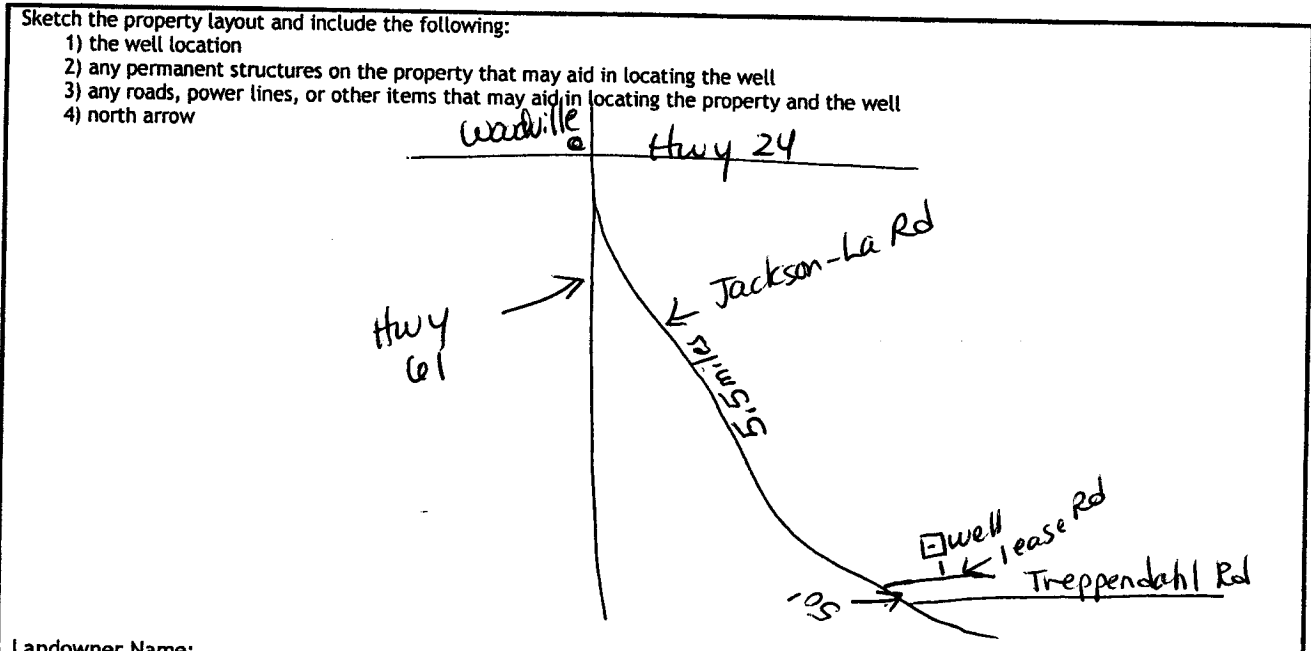

Landowner Name: _____

I HEREBY CERTIFY that the well/borehole was drilled, constructed, and completed in accordance with all applicable requirements of the Mississippi Department of Environmental Quality and the Mississippi Department of Health regulations, if applicable, and state laws.

Rayborn Drilling Inc 0-60 6/20/14 [Signature]
 Print Name of Responsible Licensee and License No. Date Signature of Licensee

STATE WELL REPORT

Part 2

Pump Installer's Completion Report
 Mississippi Department of Environmental Quality
 Office of Land and Water Resources
 P.O. Box 2309
 Jackson, MS 39225-2309
 (601)961-5210
 (601) 360-0535 (fax)

County: Wilkinson
 Permit #: _____
 Driller: Gary Rayborn
 Date completed: 5/31/14
Copy information from block on Part 1

For Office Use Only:

Well #: R69
 Aquifer: _____

This part of the report must be completed by a licensed water well contractor or a licensed pump installer. A copy of Part 1 of the report must be attached and both parts filed with the Department at the above address within 30 days of well completion.

Well Owner Information	Well Location
Owner Name: <u>Halcon Resources</u>	Latitude: <u>31.00203"</u> Longitude: <u>91.27800"</u>
Mailing Address: <u>1000 Louisiana St</u>	Method of Lat/Long (check one): <u>Conventional Survey</u>
<u>Suite 6700</u>	USGS quad _____, Hand-held GPS _____, Survey-grade GPS _____
<u>Houston TX 77002</u>	<u>1R 1/4 NW 1/4, Sec 44 T 1N R 2W</u>
City State Zip Code	<u>5.5</u> Miles <u>S/SE</u> of <u>Woodville</u>
Telephone No. <u>(832) 202-0047</u>	(Distance) (Direction) (Nearest Town)

Pump Type (circle one)

Submersible Turbine Air Lift Centrifugal Flowing Well Jet Piston Rotary Other (describe): _____

Date Pump Installed: 5/31/14 Rated Pump Capacity: 60 Gallons Per Minute

Is This Pump (circle one): New Repaired Replacement

Power Type (circle one)

Electric Diesel Gasoline Natural Gas Tractor PTO Windmill Other (describe): _____

Horse Power Rating of Motor: 5HP Setting Depth: 168 feet Number of Stages: 11

Pump Test Data for Non Flowing Well

Date Well Tested: 5/31/14 Duration of Pump Test (minimum 4 hours): _____ hours

Static Water Level (A): 90 Feet Below Land Surface Pumping Water Level (B): _____ Feet Below Land Surface

Drawdown [(B) - (A)]: _____ Feet Below Land Surface Test Pumping Rate: 60 Gallons Per Minute

Method of measurement (circle one): Steel tape Electric tape Air line Other (describe): _____

Pump Test Data for Flowing Well

Measured shut in head: _____ feet.

Well yielded _____ GPM with a drawdown of _____ feet after _____ hours of pumping

Meter Installation

Meter Manufacturer: _____ Meter Serial Number: _____

Meter Model Number/Name: _____ Type of Meter: _____

Totalizer Register Unit and Multiplier Factor (AF x .001, gal x 1000, etc): _____

Installation Date: _____ Meter installed by: _____

Is This Meter (circle one): New Repaired Replacement

Important: By submitting the above information you are certifying that this meter was installed to manufacturer standards. For agricultural wells, a list of approved meters is on the MDEQ website.

I HEREBY CERTIFY that the above statements are true to the best of my knowledge.

Gary Rayborn 0-60 6/20/14 _____
 Print Name of Pump Installer and License No. (if applicable) Date Signature of Pump Installer

Received
 BY OLWR
 JUN 24 2014

The first part of the document discusses the importance of maintaining accurate records of all transactions. It emphasizes that every entry should be supported by a valid receipt or invoice. This ensures transparency and allows for easy auditing of the accounts.

Furthermore, it is noted that regular reconciliation of the books is essential to identify any discrepancies early on. This process involves comparing the internal records with bank statements and other external sources to ensure they match.

In addition, the document highlights the need for clear communication between all parties involved in the business. This includes providing timely updates to stakeholders and addressing any concerns promptly.

The second section of the document focuses on the financial aspects of the business. It details the various methods used to calculate profit and loss, including the use of the cost of sales and the gross profit margin.

It is also discussed how these financial metrics can be used to make informed decisions about the future of the business. For example, a high gross profit margin indicates that the company is effectively managing its costs, which is a positive sign.

Moreover, the document provides a breakdown of the different types of expenses that can be deducted from the total revenue. This includes both fixed and variable costs, as well as depreciation and amortization.

Finally, it stresses the importance of having a clear understanding of the company's cash flow. This involves tracking the inflows and outflows of cash to ensure that the business has enough liquidity to meet its obligations.

The third and final part of the document covers the legal and regulatory requirements that apply to the business. It outlines the various taxes that must be paid and the deadlines for filing returns.

It also discusses the importance of staying up-to-date on changes in the law, as these can have a significant impact on the business's operations. For example, new regulations regarding data protection or employment law may require the company to make adjustments.

In conclusion, the document provides a comprehensive overview of the key areas that a business owner should focus on to ensure the success and sustainability of their enterprise.