

Crosby #1

STATE WELL REPORT

Part 1

Driller's Log

Mississippi Department of Environmental Quality
Office of Land and Water Resources
P.O. Box 2309
Jackson, MS 39225-2309
(601)961-5210
(601)360-0535 (fax)

For Office Use Only:

Well #: B65
Aquifer:
E-Log #:

County: Wilkinson
Permit #:
Driller: Gary Rayborn
Date drilling completed: 4/3/15

State Law requires that this report be prepared by the license holder responsible for the work and filed with the Department at the above address within 30 days of completion of drilling of the well or borehole.

Well Owner Information (Landowner if borehole is not for a water well)
Owner Name: D3D Drilling, Inc.
Mailing Address: P.O. Box 1634
Ferriday LA 71334
Telephone No. (38) 757-3274
Well or Borehole Location 11° 20' 13.85"
Latitude: 31.26669 Longitude: -91.33721
Method of Lat/Long (check one): Conventional Survey
USGS quad 50 1/4 NW 1/4, Sec 42 T 4N R 2W
4 Miles S/SE of Dolorosso
(Distance) (Direction) (Nearest Town)

Well / Borehole Data
Date drilling started: 4/3/15 Date drilling completed: 4/3/15 Hole depth: 190' Hole diameter: 4"
Location of the source of any surface water used for drilling:
Method of dosing and volume of Chlorine used in drilling and development:
Logs run (circle all applicable): No log run Electric Gamma Ray Density Sonic Neutron Other:
Name of organization running log(s):
Purpose of borehole (circle one): Water Well Geotechnical/Geological Investigation Ground Source Heat Pump
Seismic Survey Other (describe)
If drilling is not related to water well construction, skip the remainder of this block

Purpose of Well (circle all applicable): Home Industrial Public Supply Irrigation Fish Culture
Other (describe): RIG SUPPLY
If a flowing well, method of flow regulation: Valve Other (describe)
Static Water Level: 120 feet [above or below] land surface Date measured: 4-3-15
Method of measurement (circle one): Steel tape Electric tape Air line Other (describe)
Well depth: 190' Well grouted to a depth of: 10 feet Type of grout (circle one): Neat Cement Bentonite Mix
Casing length: 170 feet Casing diameter: 4 inches Type of casing: PVC
Screen length: 20 feet Screen diameter: 4 inches Type of screen: PVC
Screen slot size: .020 inches Setting depth: From 170 feet to 190 feet
Type of completion (circle all applicable): Gravel packed Underreamed Open hole Natural Development
Other (describe):
Top of lap pipe or reduction in casing: feet
If telescoped or more than one screen, describe on next page

County: Wilkinson
Permit #: _____

For Office Use Only:
Well #: B 65

The sketch below only required for water wells

If well telescopes, show depths on sketch.

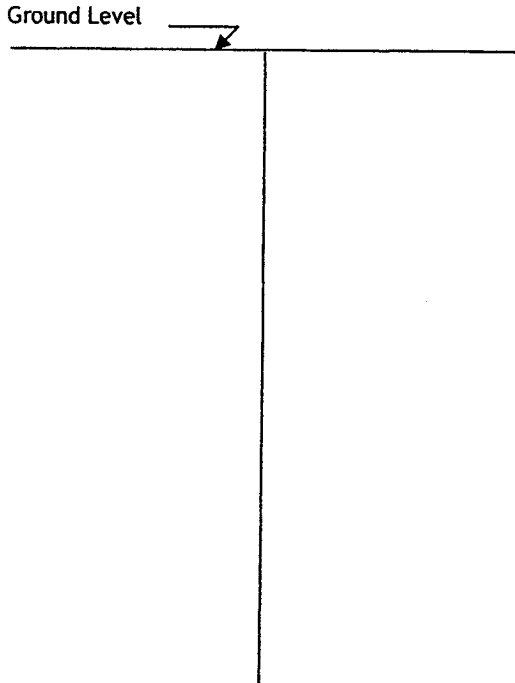

Description of formations encountered must be provided for all wells and boreholes, unless specifically exempted by regulations

Description of Formations Encountered	From (depth)	To (depth)
Chalk	Ground level	35
Sand	35	45
Chalk	45	170
Fine Sand	170	190

If more than one screen, show location of each on sketch

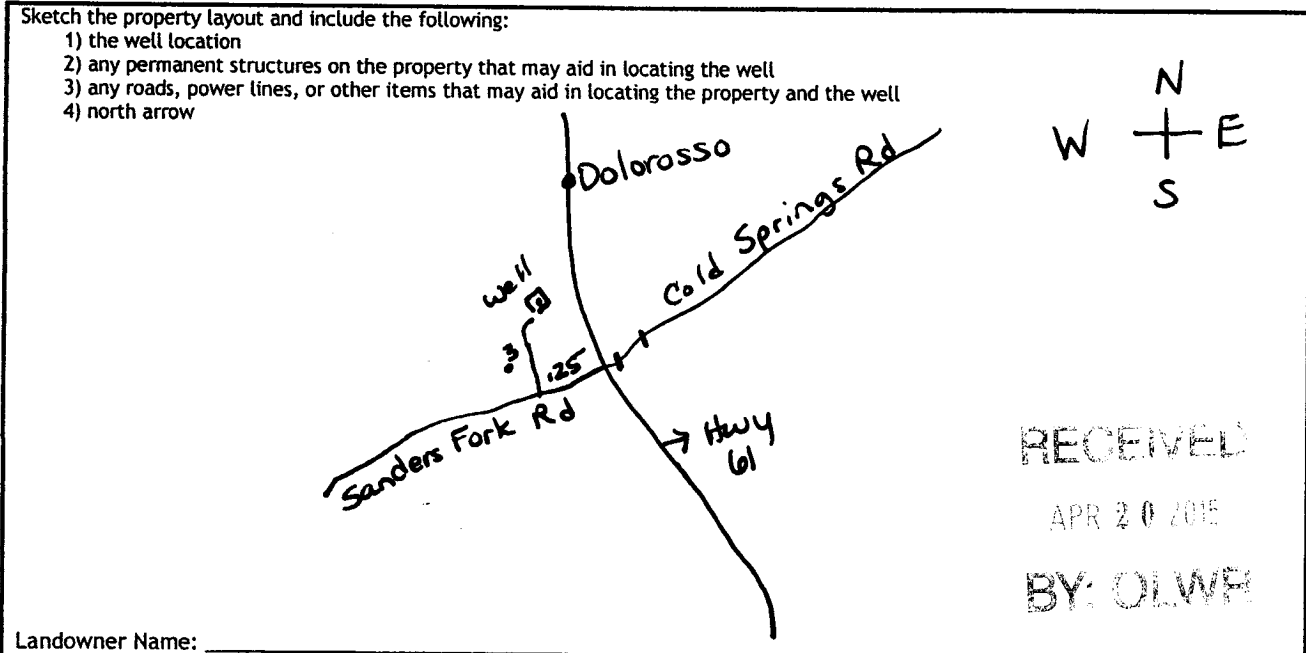

I HEREBY CERTIFY that the well/borehole was drilled, constructed, and completed in accordance with all applicable requirements of the Mississippi Department of Environmental Quality and the Mississippi Department of Health regulations, if applicable, and state laws.

Print Name of Responsible Licensee and License No. OLWR CONSULTING INC. 0-60 Date 4/16/15 Signature of Licensee [Signature]

STATE WELL REPORT

Part 2

Pump Installer's Completion Report
Mississippi Department of Environmental Quality
Office of Land and Water Resources
P.O. Box 2309
Jackson, MS 39225-2309
(601)961-5210
(601) 360-0535 (fax)

For Office Use Only:

Well #: 8605

Aquifer:

County: Wilkinson

Permit #:

Driller: Gary Rayborn

Date completed: 4/3/15

Copy information from block on Part 1

This part of the report must be completed by a licensed water well contractor or a licensed pump installer. A copy of Part 1 of the report must be attached and both parts filed with the Department at the above address within 30 days of well completion.

Well Owner Information: D & D Drilling, Inc., P.O. Box 1634, Ferriday La 71334, Telephone No. (318) 757-3274. Well Location: Latitude: 31.26669, Longitude: -91.33721, Method of Lat/Long: Conventional Survey, USGS quad: 42 T 4N R 2W, 4 Miles S/SE of Doloresco.

Pump Type (circle one): Submersible. Date Pump Installed: 4/3/15. Rated Pump Capacity: 60 Gallons Per Minute. Is This Pump (circle one): New.

Power Type (circle one): Electric. Horse Power Rating of Motor: 5HP. Setting Depth: 163 feet. Number of Stages: 14.

Pump Test Data for Non Flowing Well. Date Well Tested: 4/3/15. Duration of Pump Test: — hours. Static Water Level (A): 120 Feet Below Land Surface. Pumping Water Level (B): — Feet Below Land Surface. Drawdown [(B) - (A)]: — Feet Below Land Surface. Test Pumping Rate: 60 Gallons Per Minute. Method of measurement (circle one): Electric tape.

Pump Test Data for Flowing Well. Measured shut in head: — feet. Well yielded — GPM with a drawdown of — feet after — hours of pumping.

Meter Installation. Meter Manufacturer: — Meter Serial Number: — Meter Model Number/Name: — Type of Meter: — Totalizer Register Unit and Multiplier Factor (AF x .001, gal x 1000, etc): — Installation Date: — Meter installed by: — Is This Meter (circle one): New. Important: By submitting the above information you are certifying that this meter was installed to manufacturer standards. For agricultural wells, a list of approved meters is on the MDEQ website.

I HEREBY CERTIFY that the above statements are true to the best of my knowledge. RAYBORN DRILLING, INC. 0-60 4-16-15. Signature of Pump Installer: [Signature]