

County: Wilkinson  
 Permit #: 0-586  
 Driller: JAMES WELLS  
 Date drilling completed: 4-13-10

**State Well Report**  
**Part 1 - Driller's Log**

Mississippi Department of Environmental Quality  
 Office of Land and Water Resources  
 P.O. Box 2309  
 Jackson, MS 39225  
 (601)961- 5210  
 (601)961- 5228 (fax)

For Office Use Only:  
 Aquifer: B 55  
 Well #: \_\_\_\_\_  
 L. S. Elevation: \_\_\_\_\_  
 E-log #: \_\_\_\_\_

*State Law requires that this report be prepared by the license holder responsible for the work and filed with the Department at the above address within 30 days of completion of drilling of the well or borehole.*

<p><b>Information on Well Owner</b>  <i>(Landowner if borehole is not for a water well)</i>          Owner Name: <u>Big Piney Creek Farms</u>          Mailing Address: <u>1201 Main St.</u>  <u>Baton Rouge LA 70802</u>          City State Zip Code          Telephone No. ( ) _____</p>	<p><b>Well or Borehole Location</b>          Latitude: <u>31° 16' 56"</u> Longitude: <u>91° 17' 29"</u>          Method of Lat/Long (circle one): Conventional Survey,          USGS quad, Hand-held GPS, Survey-grade GPS  <u>N<math>\frac{1}{2}</math> SW <math>\frac{1}{4}</math> Sec 33 Twn 4N Rng 2W</u>          Distance Direction Nearest Town  <u>17</u> Miles <u>N</u> of <u>Woodville</u></p>
---	--

**Well / Borehole Data**

Date drilling started: 4-13-10 Date drilling completed: 4-13-10 Hole depth: 300 Hole diameter: 7 1/2"

Location of the source of any surface water used for drilling: Flunning Creek  
 Method of dosing and volume of Chlorine used in drilling and development: shock

Logs run (circle all applicable): No log run Electric Gamma Ray Density Sonic Neutron Other: \_\_\_\_\_  
 Name of organization running log(s): \_\_\_\_\_

Purpose of borehole (check one): Water Well  Geotechnical/Geological Investigation \_\_\_\_\_ Ground Source Heat Pump \_\_\_\_\_  
 Seismic Survey \_\_\_\_\_ Other (describe) \_\_\_\_\_

*If drilling is not related to water well construction, skip the remainder of this block*

Purpose of Well (check one): Home  Industrial \_\_\_\_\_ Public Supply \_\_\_\_\_ Irrigation \_\_\_\_\_ Fish Culture \_\_\_\_\_ Other: \_\_\_\_\_

If a flowing well, method of flow regulation: Valve \_\_\_\_\_ Other (describe) \_\_\_\_\_

Static Water Level: 180 feet above or below (circle one) land surface Date measured: 4-13-10

Method of Measurement (circle one) steel tape electric tape air line other: \_\_\_\_\_

Well depth: 300 Well grouted to a depth of 10 feet Type of grout (circle one): Neat Cement Bentonite Mix

Casing length: 280 feet Casing diameter: 4 inches Type of casing: PVC

Screen length: 20 feet Screen diameter: 4 inches Type of screen: PVC

Screen slot size: .008 inches Setting depth: From 280 feet to 300 feet

Type of completion (circle all applicable): Gravel packed Underreamed Telescoped Open hole Natural Development  
 Other (describe): \_\_\_\_\_

Top of lap pipe or reduction in casing: \_\_\_\_\_ feet. *If telescoped or more than one screen, describe on next page*

Form: OLWR-SWR-1A (04/08)

**RECEIVED**  
 MAY 13 2010  
 BY: OLWR

BSS

The sketch below only required for water wells

Description of formations encountered must be provided for all wells and boreholes, unless specifically exempted by regulations

If well telescopes, show depths on sketch.

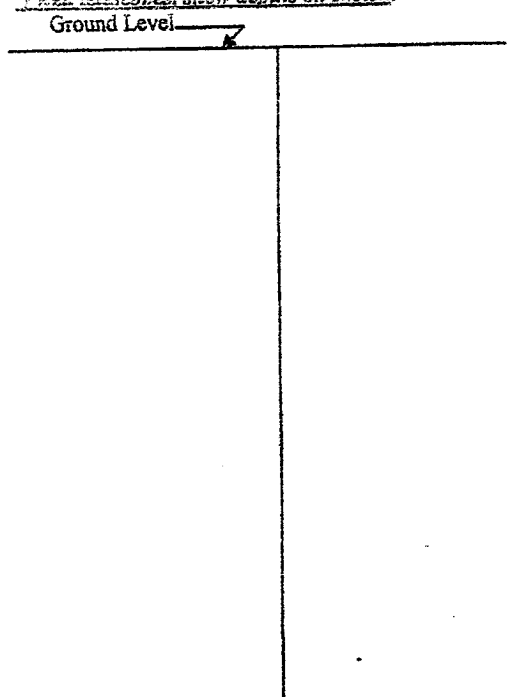

Description of Formations Encountered	From (depth)	To (depth)
topsoil	Ground Level	1
	220	300

If more than one screen, show location of each on sketch

Sketch the property layout and include the following: 1) the well location; 2) any permanent structures on the property that may aid in locating the well; 3) any roads, power lines, or other items that may aid in locating the property and the well; 4) a north arrow.

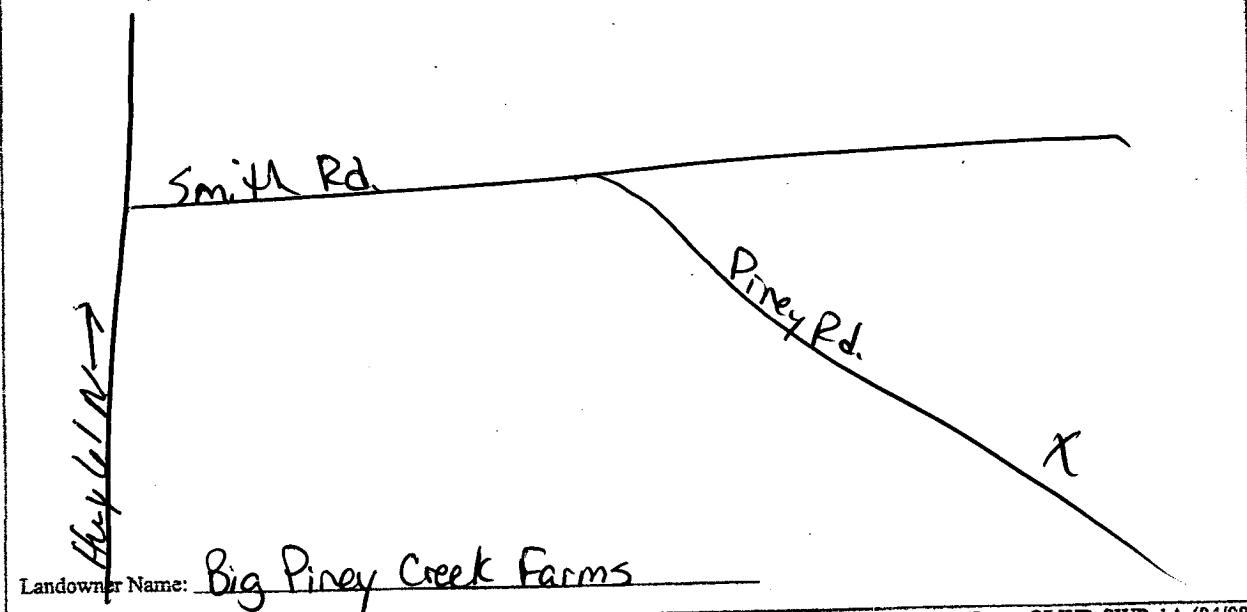

Form: OLWR-SWR-1A (04/08)

I certify that the well/borehole was drilled, constructed, and completed in accordance with all applicable requirements of the Mississippi Department of Environmental Quality and the Mississippi Department of Health regulations, if applicable, and state laws.

JAMES WELLS 0-586  
 Print Name of Responsible Licensee and License No. \_\_\_\_\_

James Wells  
 Signature of Licensee \_\_\_\_\_

**RECEIVED**  
 MAY 13 2010  
**BY: OLWR**

# STATE WELL REPORT

## Part 2

**Pump Installer's Completion Report**  
 Mississippi Department of Environmental Quality  
 Office of Land and Water Resources  
 P.O. Box 2309  
 Jackson, MS 39225  
 (601)961-5210  
 (601)961-5228 (fax)

County: Wilkinson  
 Permit #: \_\_\_\_\_  
 Driller: JAMES WELLS  
 Date completed: 4-13-10  
*Copy information from block on Part 1*

**For Office Use Only:**

Aquifer: BSS  
 Well #: \_\_\_\_\_  
 Elevation: \_\_\_\_\_

*This part of the report must be completed by a licensed water well contractor or a licensed pump installer. A copy of Part 1 of the report must be attached and both parts filed with the Department at the above address within 30 days of well completion.*

Well Owner Information	Well Location
Owner Name: <u>Big Piney Creek Farms</u>	Latitude: _____ Longitude: _____
Mailing Address: <u>1201 Main St.</u>	Method of Lat/Long (check one): Conventional Survey _____
<u>Baton Rouge LA 70802</u>	USGS quad _____, Hand-held GPS _____, Survey-grade GPS _____
City State Zip Code	_____ 1/4 _____ 1/4 Sec <u>33</u> T <u>4N</u> R <u>2W</u>
Telephone No. (____) _____	Distance Direction Nearest Town
	<u>17</u> Miles <u>N</u> of <u>Woodville</u>

Pump Type Circle one	Power Type Circle one
Air Lift Jet <input type="radio"/> <u>Submersible</u>	Diesel Engine Gasoline Engine Natural Gas
Bucket Piston Turbine	<u>Electric Motor</u> Hand Tractor PTO
Centrifugal Rotary Flowing Well	Windmill Other (specify): _____
Other (specify): _____	Horse Power Rating of Motor: <u>1</u>
Date Pump Installed: <u>4-13-10</u>	Setting Depth: <u>220</u> feet
Rated Pump Capacity: <u>12</u> Gallons Per Minute	Number of Stages: <u>14</u>

Pump Test Data	Method of Measuring Water Level Circle one
Date Well Tested: <u>4-13-10</u>	Air Line Electric Measuring Line <u>Steel Tape</u>
Static Water Level (A): <u>180</u> Feet Below Land Surface	Other (specify): _____
Pumping Water Level (B): <u>200</u> Feet Below Land Surface	For flowing well, measured shut in head: _____ feet
Drawdown [(B) - (A)]: <u>192</u> Feet Below Land Surface	Well yielded <u>17</u> GPM with a drawdown of
Test Pumping Rate: <u>17</u> Gallons Per Minute	<u>12</u> feet after <u>4</u> hours of pumping
Duration of Pump Test (minimum 4 hours): <u>4</u> hours	

I HEREBY CERTIFY that the above statements are true to the best of my knowledge.

JAMES WELLS 0-586  
 Print Name of Pump Installer and License No. (if applicable)

James Wells  
 Signature

**RECEIVED RECEIVED**  
 MAY 13 2010 MAY 13 2010  
 BY: OLWR BY: OLWR