

STATE WELL REPORT

Part I

Driller's Log

Mississippi Department of Environmental Quality
Office of Land and Water Resources
P.O. Box 2309
Jackson, MS 39225-2309
(601)961-5210
(601)360-0535 (fax)

For Office Use Only:

Well #: 5127
Aquifer: _____
E-Log #: _____

County: Wayne
Permit #: 6W-17469
Driller: A-1 Drilling Serv. Inc.
Date drilling completed: 12-2-2020

State Law requires that this report be prepared by the license holder responsible for the work and filed with the Department at the above address within 30 days of completion of drilling of the well or borehole.

Well Owner Information <small>(Landowner if borehole is not for a water well)</small>	Well or Borehole Location
Owner Name: <u>Clara Water Assn.</u>	Latitude: <u>31° 35' 40" N</u> Longitude: <u>88° 40' 46" W</u>
Mailing Address: <u>P.O. Box 134</u>	Method of Lat/Long (check one): Conventional Survey _____ USGS quad _____, Hand-held GPS <input checked="" type="checkbox"/> , Survey-grade GPS _____
<u>Clara</u> <u>Ms.</u> <u>39324</u>	<u>NW</u> ¼ <u>NE</u> ¼, Sec <u>10</u> T. <u>7N</u> R. <u>7W</u>
City State Zip Code	<u>± 2</u> Miles <u>East</u> of <u>Clara</u>
Telephone No. <u>(601) 735-2428</u>	(Distance) (Direction) (Nearest Town)

location adjusted based on aerial

Well / Borehole Data

Date drilling started: 10-26-2020 Date drilling completed: 12-2-2020 Hole depth: 325' Hole diameter: 17 1/2"

Location of the source of any surface water used for drilling: Clara Water Assn.

Method of dosing and volume of Chlorine used in drilling and development: _____

Logs run (circle all applicable): No log run Electric Gamma Ray Density Sonic Neutron Other: _____

Name of organization running log(s): Ms. DEQ

Purpose of borehole (circle one): Water Well Geotechnical/Geological Investigation Ground Source Heat Pump Seismic Survey Other (describe) _____

If drilling is not related to water well construction, skip the remainder of this block

Purpose of Well (circle all applicable): Home Industrial Public Supply Irrigation Fish Culture

Other (describe): _____

If a flowing well, method of flow regulation: Valve _____ Other (describe) _____

Static Water Level: 118' feet [above or below] land surface (circle one) Date measured: 12-16-2020

Method of measurement (circle one): Steel tape Electric tape Air line Other (describe): _____

Well depth: 318 Well grouted to a depth of: 282 feet Type of grout (circle one): Neat Cement Bentonite Mix

Casing length: 282 feet Casing diameter: 12 3/4 inches Type of casing: Steel (capped)

Screen length: 35 feet Screen diameter: 8" x 6" inches Type of screen: Muni-Pack

Screen slot size: .015 inches Setting depth: From 283 feet to 318 feet

Type of completion (circle all applicable): Gravel packed Underreamed Open hole Natural Development

Other (describe): _____

Top of tap pipe or reduction in casing: 220 feet

If telescoped or more than one screen, describe on next page

RECEIVED
DEC 22 2020
BY OLWR

Form: OLWR-SWR-1A (4/13)

County: _____
 Permit #: _____

For Office Use Only:
 Well #: 5127

The sketch below only required for water wells

If well telescopes, show depths on sketch.

Ground Level →

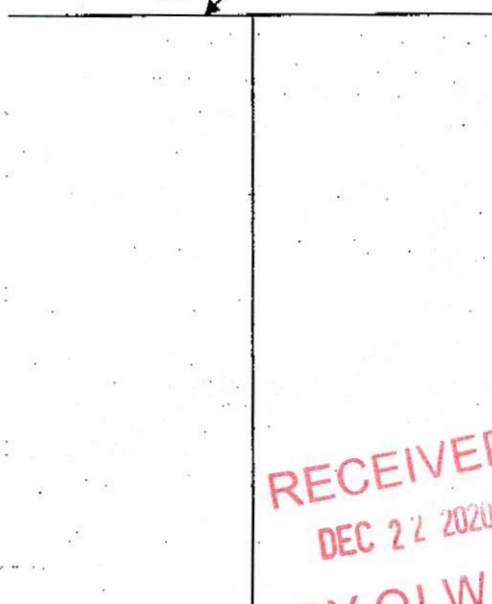

RECEIVED
 DEC 22 2020
 BY OLWR

Description of formations encountered must be provided for all wells and boreholes, unless specifically exempted by regulations

Description of Formations Encountered	From (depth)	To (depth)
Top Soil	Ground level	2
Tan sand clay	2	28
Coarse Sand	28	53
Tan sandy clay	53	66
Tan clay w/ sand streaks	66	121
Rock	121	123
stiff gray clay	123	148
Sandy streak	148	150
Clay w/ sandy streaks	150	195
Shale w/ clay streaks	195	224
Sandy clay	224	283
Rock	283	285
Sand	285	320
Stiff clay	320	325
Rock	325	325

If more than one screen, show location of each on sketch

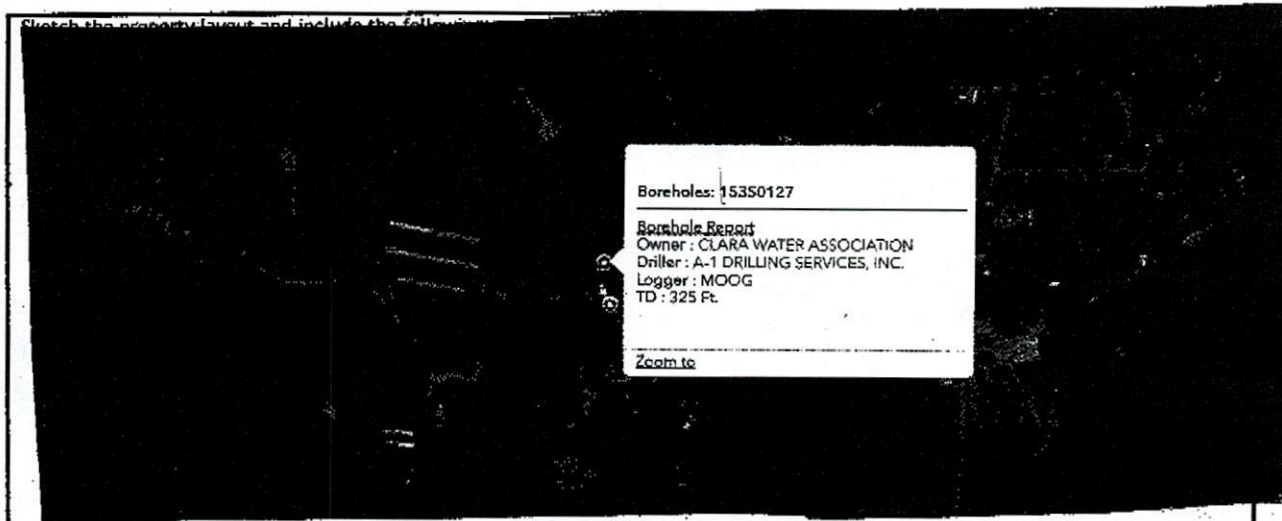

Boreholes: 15350127
 Borehole Report
 Owner: CLARA WATER ASSOCIATION
 Driller: A-1 DRILLING SERVICES, INC.
 Logger: MOOG
 TD: 325 Ft.
 Zoom to

Landowner Name: Clara Water Assn.

I HEREBY CERTIFY that the well/borehole was drilled, constructed, and completed in accordance with all applicable requirements of the Mississippi Department of Environmental Quality and the Mississippi Department of Health regulations, if applicable, and state laws.

Mike Baughman 587 [Signature]
 Print Name of Responsible Licensee and License No. Date Signature of licensee

County: _____
 Permit #: _____

For Office Use Only:
 Well #: _____

The sketch below only required for water wells
If well telescopes, show depths on sketch.

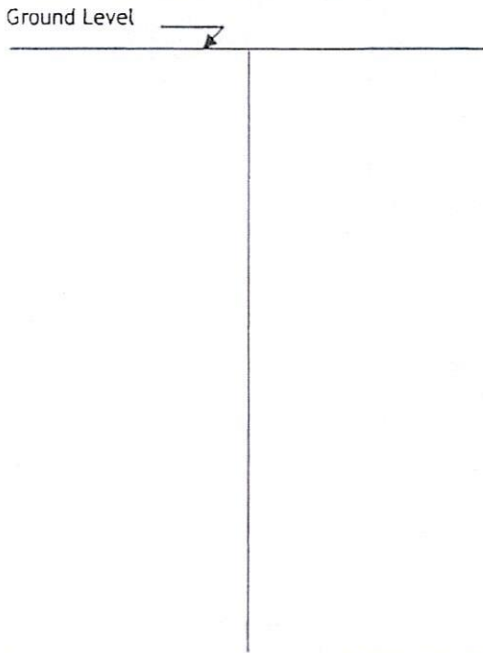

Description of formations encountered must be provided for all wells and boreholes, unless specifically exempted by regulations

Description of Formations Encountered	From (depth)	To (depth)
Top Soil	Ground level	2
Tan sand clay	2	28
Coarse Sand	28	53
Tan sandy clay	53	62
Tan clay w/ sand bits	62	121
Rock	121	123
stiff gray clay	123	148
Sandy silt	148	150
clay w/ sandy rocks	150	195
Shandy clay w/ logs	195	220
Sandy clay	220	253
Rock	253	280
Sand	280	320
Stiff clay	320	325
Rock	325	325

If more than one screen, show location of each on sketch

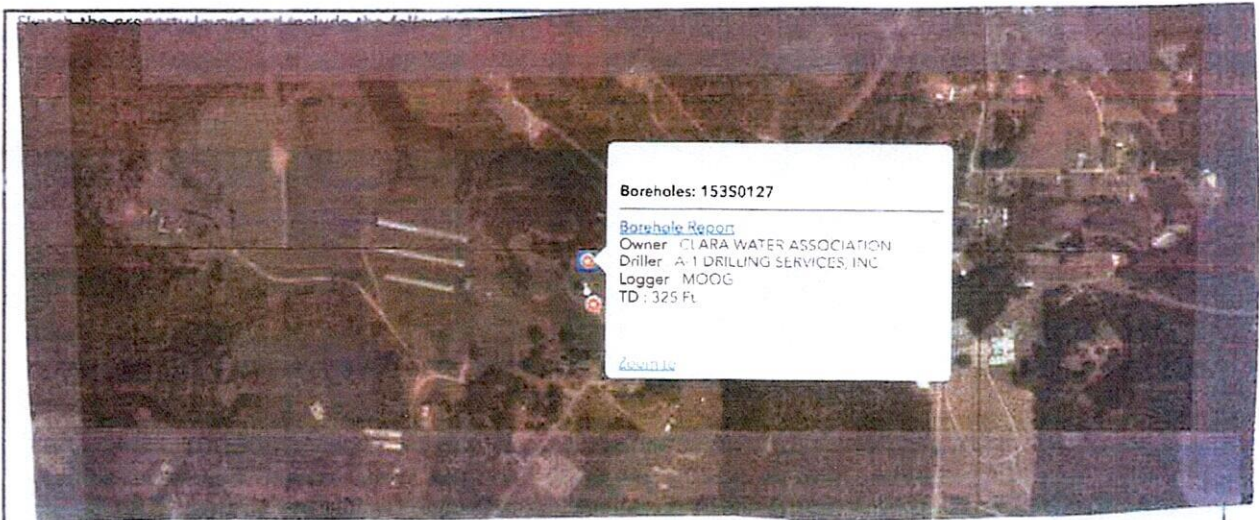

Landowner Name: Clara Water Assn.

I HEREBY CERTIFY that the well/borehole was drilled, constructed, and completed in accordance with all applicable requirements of the Mississippi Department of Environmental Quality and the Mississippi Department of Health regulations, if applicable, and state laws.

Mike Bawab 537 

Print Name of Responsible Licensee and License No. Date Signature of Licensee

A-1 DRILLING SERVICE, INC.

1553 HIGHWAY 84 EAST
LAUREL, MS 39443

LOG FORM

RECEIVED-WATER DIVISION
2021 JUN 15 AM 8:10

#6

NAME: CLARA WATER ASSOCIATION
LOCATION: 31* 35' 40" N, 88* 40' 46" W
NW,NE SEC.-10,T-7N, R-7W
ENGINEER: G & S ENGINEERING
DRILLER: A-1 DRILLING SERVICE LOG NO. S-0127
COMPLETION DATE: ACCEPTED:
SALES ENGINEER: M. BAUGHMAN FIELD SUPERVISOR: C. HAWKINS

WELL DATA

Length surface casing: --- Size surface casing: ---
Cemented: --- No. Sacks: --- Size drilled hole: ---
Depth drilled hole: 325' Sz. Well csg.: 12 3/4" Type: coated steel
Length well casing: 282' Cemented: 0-282' No. sacks: 150
Size screen 8" x 6" Type: Muni Pack Mfg. by: Alloy Machine Company
Slot size: 0.015" Material: stainless steel Length Screen: 35'
Lap pipe size: 8" Lap pipe length: 63'
Type: epoxy coated steel
Distance to lap: 220' Distance to screen top: 283'
Distance to screen bottom: 318' Type bottom: BWV
Connection top of lap: R & L Coupling Static water level: 119'

PUMP DATA

Type: Submersible Make: Grundfos Serial No. C16870006P220490001
Size bowls: 6" No. Stages: 6 Curve No.: --- Lgt. Bowls: 55"
Lgt. Column: 262' Size column: 6" Type column: epoxy coated steel
Size oil tube: --- Size shaft: --- Length suction: ---
Size suction: --- Size discharge: --- Head no.: ---
Overall pump length: --- Length headshaft: ---
Type lubrication: --- Type oiler: --- Length air line: 262'
Rated Capacity: 385 GPM Total head: 300'
Size Foundation: 3' x 3' x 3' Height: ---

ELECTRIC MOTOR DATA

Type: Submersible Make: Franklin Serial No.: 20M19-15-001848
HP: 50 Voltage: 460 RPM: 3450 Frame: ---
Style: --- Phase: 3 Cycle: 60 Amps: 77
Hgt. motor: 56" Dia. Base: --- Clutch bore: --- Clutch No.: ---
Top bearing No.: --- Lower bearing No.: --- Lubrication: ---

SWITCH DATA

Type: VLT Aqua Drive Make: Danfoss
Size: 45 kw Catalog No.: FC202P45KT4E20HZ
Rating: 80 amp Volts: 480 V Phase: 3 Cycles: VFD
HP rating: 60 HP Size relays: --- Relay type: ---
Entrance switch: 175 amp Siemens
Fuse size & type: 125 amp Breaker Siemems Size wire: Mar-00

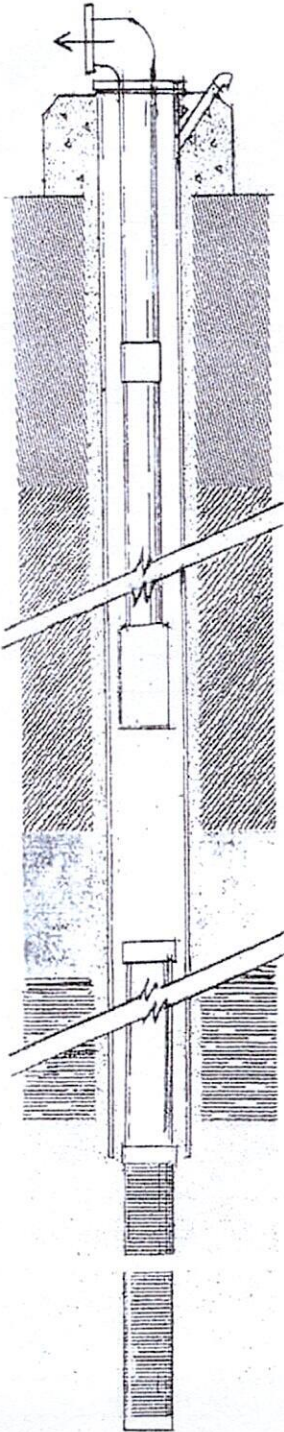



A-1 DRILLING SERVICE, INC.

1553 HIGHWAY 84 EAST
LAUREL, MS 39443

FORMATION LOG

OWNER: Clara Water Assoc.

WELL NO. 0770003-6 PAGES 1 OF 1 PAGES

ADDRESS: 2900 Highway 63 Waynesboro, MS 39367

WELL LOCATION: 31* 33' 40" N 88* 40' 46" W/NW, NE SEC 10, T-7N, R-7W

TOTAL DEPTH	THICKNESS EACH STRATUM	FORMATION	REMARKS
2	2	Top Soil	
28	26	Tan sandy clay	
53	25	Coarse sand	
66	13	Tan sandy clay	
121	55	Tan clay with sand streaks	
123	2	Rock	
148	25	Stiff gray clay	
150	2	Sandy streaks	
195	45	Clay with sandy streaks	
224	29	Sand with clay streaks	
283	59	Sandy clay	
285	2	Rock	
320	35	Sand	
325	5	Stiff clay	
325	TDH	Rock	

DATE STARTED: 10/26/2020
FIELD ENGINEER: M. Baughman

DATE COMPLETED: 12/7/2020
DRILLER: C. Hawkins

Clara Water Assn. well #2020-2 (0776003-6) 2

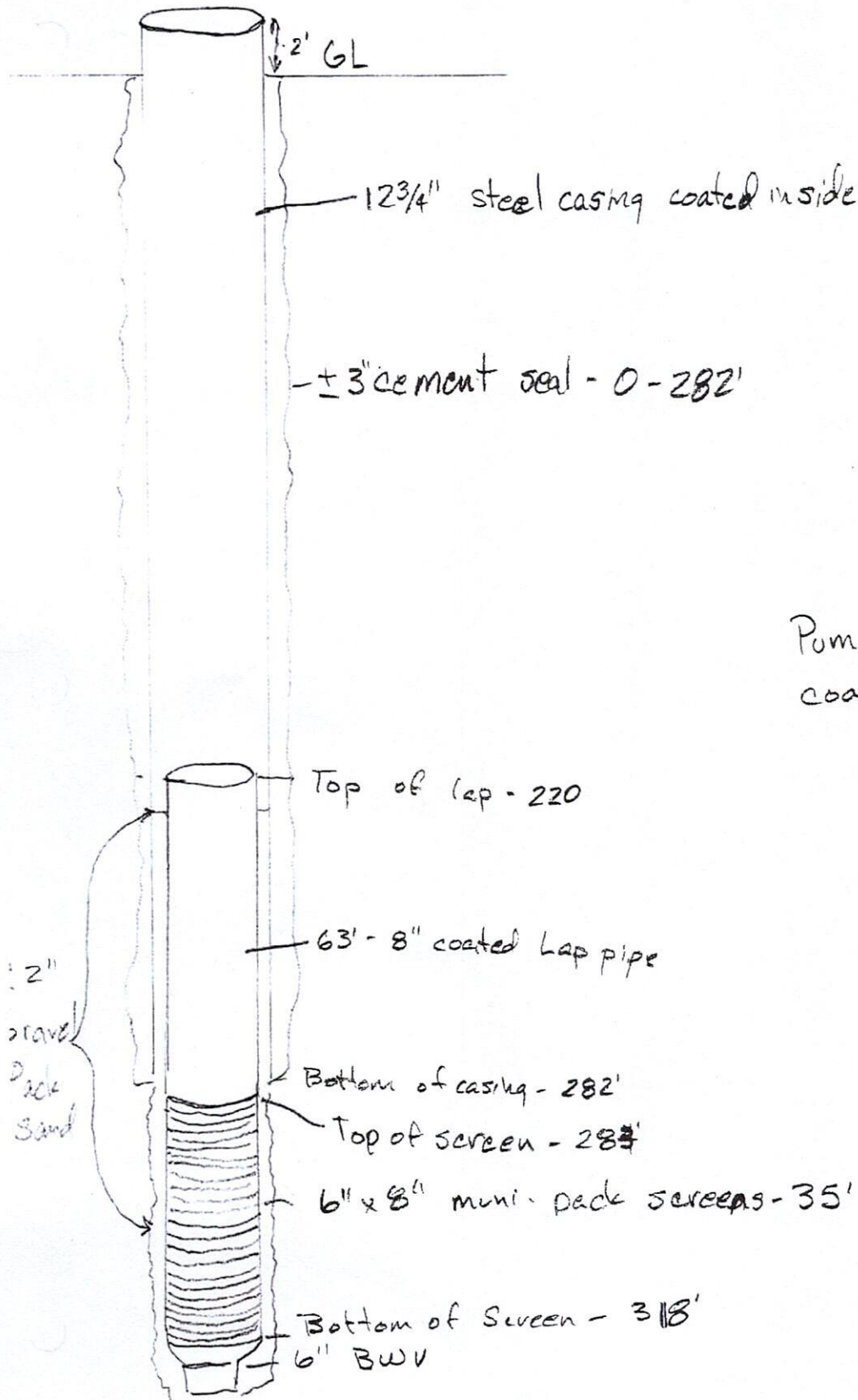

Pump set - 273' on 6" coated steel pipe