

### State Well Report

#### Part 1

Mississippi Department of Environmental Quality  
 Office of Land and Water Resources  
 P.O. Box 10631  
 Jackson, MS 39289-0631  
 (601)961-5210  
 (601)354-6938 (fax)

#### For Office Use Only:

Aquifer: \_\_\_\_\_  
 Well #: L-78  
 L. S. Elevation: \_\_\_\_\_  
 E-log #: \_\_\_\_\_

County: Wayne  
 Permit #: \_\_\_\_\_  
 Driller: M. Baughman  
 Date drilling completed: 5-16-05

**A-1**  
 State Law requires that this report be prepared by the driller in detail and filed with the Department within 30 days of completion of drilling of the well.

Well Owner Information	Well Location
Owner Name: <u>David Smith</u>	Latitude: <u>31° 40.915'</u> Longitude: <u>88° 51.712'</u>
Mailing Address: <u>839 Strouthford - Cooley Rd. Waynesboro, Ms, 39367</u> City State Zip Code	Method of Lat/Long (circle one): Conventional Survey, USGS quad <u>Hand-held GPS</u> Survey-grade GPS <u>N44SW 1/4 Sec. 11 Twn 8N Rng 9W</u>
Telephone No. <u>(601) 735 0863</u>	Distance <u>5.5</u> Miles Direction <u>W</u> of Nearest Town <u>Whistler</u>

#### Well Data

Purpose of Well (circle one) Home Industrial Public Supply Irrigation Fish Culture Other: \_\_\_\_\_

Date well drilling started: 5-10-05 Date well drilling completed: 5-16-05

If flowing, method of flow regulation: Valve \_\_\_\_\_ Other (describe) \_\_\_\_\_

Static Water Level: \_\_\_\_\_ feet above or below (circle one) land surface Date measured: \_\_\_\_\_

Method of Measurement (circle one) steel tape electric tape air line other: \_\_\_\_\_

Hole depth: 143 Well depth: 141 Well grouted to a depth of 13 feet

Type of grout (circle one): Cement Bontonite Mix

Casing length: 126 feet Casing diameter: 4 inches Type of casing: PVC

Screen length: 15' feet Screen diameter: 4 inches Type of screen: slotted PVC

Screen slot size: .006 inches Setting depth: From 126 feet to 141 feet

Type of completion (circle all applicable): Gravel packed Underreamed Telescoped Open hole Natural Development  
 Other (describe): insufficient quantity - abandoned

Top of tap pipe or reduction in casing: \_\_\_\_\_ feet. If telescoped or more than one screen, describe on back of page

Logs run (circle all applicable): No log run Electric Gamma Ray Density Sonic Neutron Other: \_\_\_\_\_

Name of organization running log(s): \_\_\_\_\_

I certify that the well was drilled, constructed, and completed in accordance with all applicable requirements of the Mississippi Department of Environmental Quality and/or the Mississippi Department of Health regulations and state laws.

Mike Baughman 0587  
 Print Name of Water Well Contractor and License No.

[Signature]  
 Signature of Water Well Contractor

06/02/2005 15:38 6014281435

A-1 DRILLING SERVICE

PAGE 02

If well telescopes please sketch below and show depths.

Ground Level

L-78

Description of Formations Encountered	From	To
Clay, Orange, tan	0	22
Gray clay	22	52
Sandy clay	52	66
Clay w/ sandy streaks	66	108
Sand	110	120
Sandy clay	120	126
Sand, v. fine, packing clay	126	141
	141	143

If more than one screen, show location of each on sketch

Sketch the property layout and include the following: 1) the well location; 2) any permanent structures on the property that may aid in locating the well; 3) any roads, power lines, or other items that may aid in locating the property and the well; 4) indicate direction.

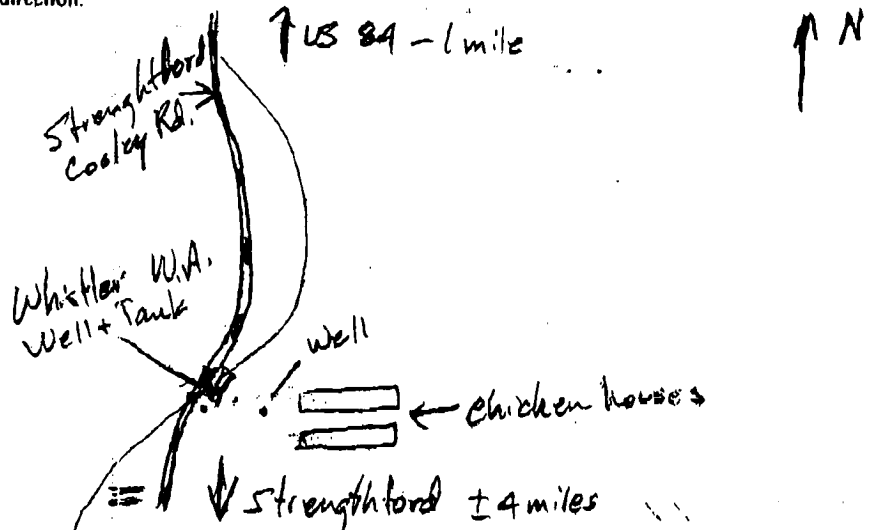

Landowner Name: David Smith

*Steve Saugher*  
 Signature of Water Well Contractor