

Well #

# STATE WELL REPORT

346

County: Wayne  
 Permit #: \_\_\_\_\_  
 Driller: Dw. J. West  
 Date drilling completed: 10-12-2020

**Part 1  
 Driller's Log**  
 Mississippi Department of Environmental Quality  
 Office of Land and Water Resources  
 P.O. Box 2309  
 Jackson, MS 39225-2309  
 (601)961-5555  
 (601)961-5228 (fax)

**For Office Use Only:**  
 Well #: G.174  
 Aquifer: \_\_\_\_\_  
 E-Log #: \_\_\_\_\_

*State Law requires that this report be prepared by the license holder responsible for the work and filed with the Department at the above address within 30 days of completion of drilling of the well or borehole.*

Well Owner Information <i>(Landowner if borehole is not for a water well)</i>	Well or Borehole Location
Owner Name: <u>Michael Cheeks</u>	Latitude: <u>31.7352</u> Longitude: <u>-88.8422</u>
Mailing Address: <u>1577 Eucutt Rd</u>	Method of Lat/Long (check one): Conventional Survey _____
<u>Shubuta</u> MS <u>39360</u>	USGS quad _____, Hand-held GPS <input checked="" type="checkbox"/> , Survey-grade GPS _____
City State Zip Code	<u>S IV 1/4 NW 1/4, Sec 79, T 9N R 8W</u>
Telephone No. (601) <u>381-2308</u>	<u>13</u> Miles <u>WNW</u> of <u>Waynesboro</u> (Distance) (Direction) (Nearest Town)

**Well / Borehole Data**

Date drilling started: 10-12-2020 Date drilling completed: 10-12-2020 Hole depth: 170' Hole diameter: 6 1/2"

Location of the source of any surface water used for drilling: Community Water

Method of dosing and volume of Chlorine used in drilling and development: Tabs 50 ppm

Logs run (check all applicable):  log run  Electric  Gamma Ray  Density  Sonic  Neutron Other: \_\_\_\_\_

Name of organization running log(s): \_\_\_\_\_

Purpose of borehole (check one): Water Well  Geotechnical/Geological Investigation  Ground Source Heat Pump  Seismic Survey Other (describe) \_\_\_\_\_

*If drilling is not related to water well construction, skip the remainder of this block*

Purpose of Well (check all applicable):  Home  Industrial  Public Supply  Irrigation  Fish Culture

Other (describe): Poultry

If a flowing well, method of flow regulation: Valve \_\_\_\_\_ Other (describe) \_\_\_\_\_

Static Water Level: 60 feet  above or  below land surface Date measured: 10-12-2020  
(check one)

Method of measurement (check one)  Steel tape  Electric tape  Air line  Other (describe): Sonar

Well depth: 170' Well grouted to a depth of: 50 feet Type of grout (check one)  Neat Cement  Bentonite  Mix

Casing length: 150 feet Casing diameter: 4 inches Type of casing: Pvc

Screen length: 20 feet Screen diameter: 4 inches Type of screen: Pvc

Screen slot size: .010 inches Setting depth: From 150 feet to 170 feet

Type of completion (check all applicable)  gravel packed  Underreamed  Open hole  Natural Development

Other (describe): \_\_\_\_\_

Top of lap pipe or reduction in casing: \_\_\_\_\_ feet

*If telescoped or more than one screen, describe on next page*

RECEIVED  
 NOV 24 2020  
 BY OLWR

Well #2

County: Wayne  
 Permit #: \_\_\_\_\_

**For Office Use Only:**  
 Well #: \_\_\_\_\_

The sketch below only required for water wells

If well telescopes, show depths on sketch.

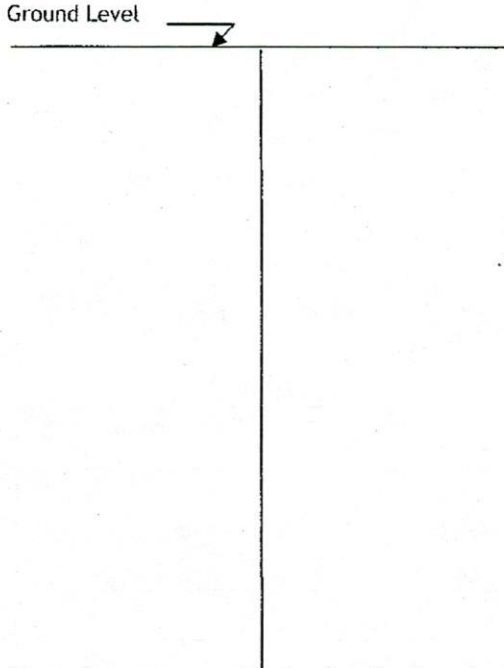

Description of formations encountered must be provided for all wells and boreholes, unless specifically exempted by regulations

Description of Formations Encountered	From (depth)	To (depth)
Sand	Ground level	12
Rock	12	13
Clay	13	16
Rock	16	17
Clay	17	18
Rock	18	19
Clay	19	24
Rock	24	25
Clay	25	33
Rock	33	34
Clay	34	37
Rock	37	38
Clay	38	45
Rock	45	46
Clay	46	54
Rock	54	55
Clay	55	114
Sand - medium	114	146
Sand - coarse	146	170

If more than one screen, show location of each on sketch

Sketch the property layout and include the following:

- 1) the well location
- 2) any permanent structures on the property that may aid in locating the well
- 3) any roads, power lines, or other items that may aid in locating the property and the well
- 4) north arrow

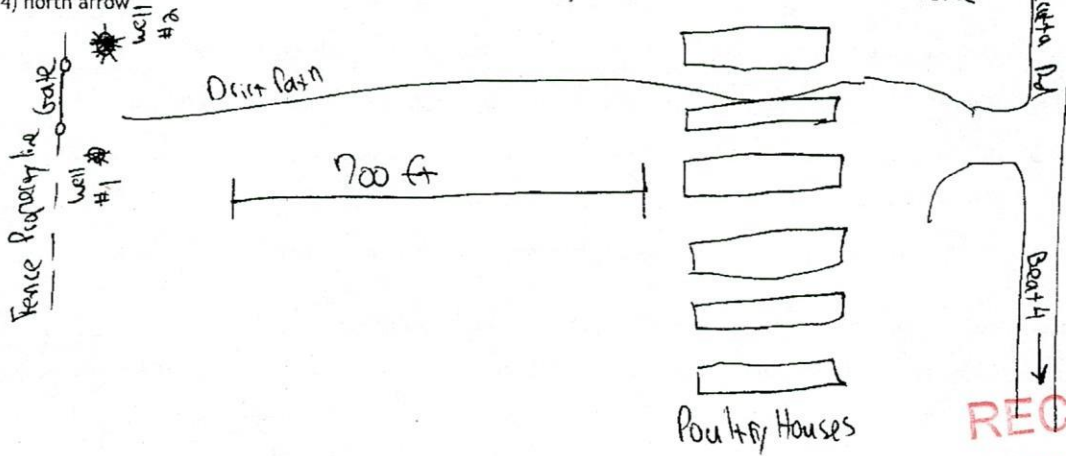

Landowner Name: Michael Cheeks

I HEREBY CERTIFY that the well/borehole was drilled, constructed, and completed in accordance with all applicable requirements of the Mississippi Department of Environmental Quality and the Mississippi Department of Health regulations, if applicable, and state laws.

David West 0670      10-13-2020      [Signature]  
 Print Name of Responsible Licensee and License No.      Date      Signature of Licensee

RECEIVED  
 NOV 24 2020  
 BY OLWR

Well #2

# STATE WELL REPORT

## Part 2

**Pump Installer's Completion Report**  
 Mississippi Department of Environmental Quality  
 Office of Land and Water Resources  
 P.O. Box 2309  
 Jackson, MS 39225-2309  
 (601)961-5210  
 (601) 360-0535 (fax)

### For Office Use Only:

Well #: 6179  
 Aquifer: \_\_\_\_\_

County: Wayne  
 Permit #: \_\_\_\_\_  
 Driller: David West  
 Date completed: 10-12-2020  
Copy information from block on Part 1

*This part of the report must be completed by a licensed water well contractor or a licensed pump installer. A copy of Part 1 of the report must be attached and both parts filed with the Department at the above address within 30 days of well completion.*

Well Owner Information	Well Location
Owner Name: <u>Michael Cheeks</u>	Latitude: <u>31.0352</u> Longitude: <u>-88.8422</u>
Mailing Address: <u>1509 Eucutt Rd</u>	Method of Lat/Long (check one): Conventional Survey _____, USGS quad _____, Hand-held GPS <u>X</u> , Survey-grade GPS _____
<u>Shubuta</u> MS <u>39360</u>	<u>S1W 1/4 NW 1/4</u> , Sec. <u>19</u> , T. <u>9N</u> , R. <u>8W</u>
City State Zip Code	<u>13</u> Miles <u>WNW</u> of <u>Waynesboro</u>
Telephone No. (local) <u>381-2308</u>	(Distance) (Direction) (Nearest Town)

**Pump Type (check one)**  
 Submersible  Turbine  Air Lift  Centrifugal  Flowing Well  Jet  Piston  Rotary  Other (describe): \_\_\_\_\_  
 Date Pump Installed: 10-13-2020 Rated Pump Capacity: 60 Gallons Per Minute  
 Is This Pump (check one):  New  Repaired  Replacement  Owner's existing pump

**Power Type (check one)**  
 Electric  Diesel  Gasoline  Natural Gas  Tractor PTO  Windmill  Other (describe): \_\_\_\_\_  
 Horse Power Rating of Motor: 5 Setting Depth: 140 feet Number of Stages: \_\_\_\_\_

**Pump Test Data for Non Flowing Well**  
 Date Well Tested: \_\_\_\_\_ Duration of Pump Test (minimum 4 hours): \_\_\_\_\_ hours  
 Static Water Level (A): \_\_\_\_\_ Feet Below Land Surface Pumping Water Level (B): \_\_\_\_\_ Feet Below Land Surface  
 Drawdown [(B) - (A)]: \_\_\_\_\_ Feet Below Land Surface Test Pumping Rate: \_\_\_\_\_ Gallons Per Minute  
 Method of measurement (check one): Steel tape  Electric tape  Air line  Other (describe): \_\_\_\_\_

**Pump Test Data for Flowing Well**  
 Measured shut in head: \_\_\_\_\_ feet.  
 Well yielded \_\_\_\_\_ GPM with a drawdown of \_\_\_\_\_ feet after \_\_\_\_\_ hours of pumping

**Meter Installation**  
 Meter Manufacturer: \_\_\_\_\_ Meter Serial Number: \_\_\_\_\_  
 Meter Model Number/Name: \_\_\_\_\_ Type of Meter: \_\_\_\_\_  
 Totalizer Register Unit and Multiplier Factor (AF x .001, gal x 1000, etc): \_\_\_\_\_  
 Installation Date: \_\_\_\_\_ Meter installed by: \_\_\_\_\_  
 Is This Meter (check one):  New  Repaired  Replacement

*Important: By submitting the above information you are certifying that this meter was installed to manufacturer standards. For agricultural wells, a list of approved meters is on the MDEQ website.*

RECEIVED  
 NOV 24 2020  
 BY OLWR

I HEREBY CERTIFY that the above statements are true to the best of my knowledge.

David West 0-672 10-13-2020 [Signature]  
 Print Name of Pump Installer and License No. (if applicable) Date Signature of Pump Installer