

State Well Report

Part 1

Mississippi Department of Environmental Quality
Office of Land and Water Resources
P.O. Box 10631
Jackson, MS 39289-0631
(601)961-5210
(601)354-6938 (fax)

For Office Use Only:

Aquifer: _____
Well #: C-69
L. S. Elevation: _____
B-log #: _____

County: Wayne
Permit #: _____
Driller: David West
Date drilling completed: 8-9-07

State Law requires that this report be prepared by the driller in detail and filed with the Department within 30 days of completion of drilling of the well.

Well Owner Information	Well Location
Owner Name: <u>Terry Agent c/o Crane Cash</u>	Latitude: <u>31.47.00</u> - Longitude: <u>88.41.00</u>
Mailing Address: <u>1965 Buckatanna - Chicora - Clara Rd</u>	Method of Lat/Long (circle one): <u>Conventional Survey</u>
<u>Buckatanna MS 39322</u>	USGS quad, Hand-held GPS, Survey-grade GPS
City State Zip Code	<u>NE 1/4 NE 1/4 Sec 33 Twn 10N Rng 7W</u>
Telephone No. <u>(601) 735-4433</u>	Distance Direction Nearest Town
	<u>9 Miles N of Wayneboro</u>

Well Data

Purpose of Well (circle one): Home Industrial Public Supply Irrigation Fish Culture Other: _____

Date well drilling started: 8-7-07 Date well drilling completed: 8-9-07

If flowing, method of flow regulation: Valve _____ Other (describe) _____

Static Water Level: 1 feet above or below (circle one) land surface Date measured: 8-13-07

Method of Measurement (circle one): steel tape electric tape air line other: EyeSight

Hole depth: 320' Well depth: 320' Well grouted to a depth of 10 feet

Type of grout (circle one): Cement Bentonite Mix

Casing length: 300 feet Casing diameter: 4 inches Type of casing: PVC

Screen length: 20 feet Screen diameter: 4 inches Type of screen: PVC

Screen slot size: .010 inches Setting depth: From 300 feet to 320 feet

Type of completion (circle all applicable): Gravel packed Underreamed Telescoped Open hole Natural Development

Other (describe): _____

Top of lap pipe or reduction in casing: _____ feet. If telescoped or more than one screen, describe on back of page

Logs run (circle all applicable): No log run Electric Gamma Ray Density Sonic Neutron Other: _____

Name of organization running log(s): _____

I certify that the well was drilled, constructed, and completed in accordance with all applicable requirements of the Mississippi Department of Environmental Quality and/or the Mississippi Department of Health regulations and state laws.

David A. West 0672

Print Name of Water Well Contractor and License No.

David A. West

Signature of Water Well Contractor

RECEIVED
AUG 24 2007
BY: OLWR

If well telescopes please sketch below and show depths.

Ground Level

Description of Formations Encountered	From	To
Sandy	0	4
Sand	4	18
Clay	18	80
Rock	80	82
Rocks and clay streaks	82	120
Shale	120	175
Clay	175	240
Sand and clay	240	280
Silty	280	293
Sand	293	307
Sand	307	320

If more than one screen, show location of each on sketch

Sketch the property layout and include the following: 1) the well location; 2) any permanent structures on the property that may aid in locating the well; 3) any roads, power lines, or other items that may aid in locating the property and the well; 4) indicate direction.

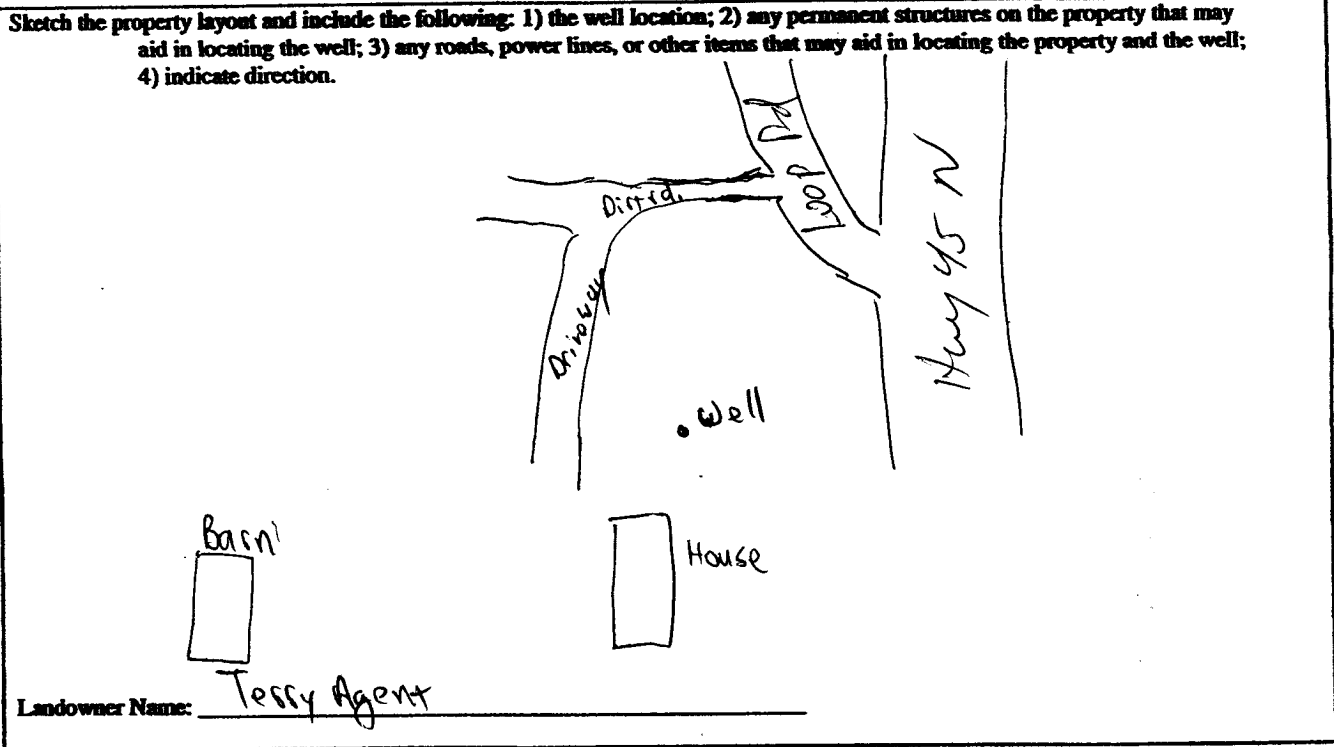

David H. Well
 Signature of Water Well Contractor

RECEIVED
 AUG 24 2007
 BY: OLWR

STATE WELL REPORT

Part 2

Pump Installer's Completion Report
 Mississippi Department of Environmental Quality
 Office of Land and Water Resources
 P.O. Box 10631
 Jackson, MS 39289-0631
 (601)961-3210
 (601)354-6938 (fax)

For Office Use Only:

Aquifer: _____

Well #: C-69

Elevation: _____

County: Wayne
 Permit #: _____
 Driller: David West
 Date completed: 8-13-07

This report should be prepared by the pump installer in detail and filed with the Department within 30 days of the installation of pump.

Well Owner Information	Well Location
Owner Name: <u>Tessy Ag^{ENT} C/o Crane Const</u>	Latitude: <u>31° 47'</u> Longitude: <u>88° 41'</u>
Mailing Address: <u>1965 Buckatunna</u> <u>Chicara- Clara Rd</u> <u>Buckatunna MS 39322</u> City State Zip Code	Method of Lat/Long (circle one): <u>Conventional Survey</u> USGS quad, Hand-held GPS, Survey-grade GPS <u>NE ¼ NE ¼ Sec 33 Twn 10N Rng 7W</u>
Telephone No. (601) <u>735-4433</u>	Distance Direction Nearest Town <u>9 Miles N of Waynesboro</u>

Pump Type Circle one	Power Type Circle one
Air Lift Jet <input checked="" type="radio"/> <u>Submersible</u>	Diesel Engine Gasoline Engine Natural Gas
Bucket Piston Turbine	<input checked="" type="radio"/> <u>Electric Motor</u> Hand Tractor PTO
Centrifugal Rotary Flowing Well	Windmill Other (specify): _____
Other (specify): _____	Horse Power Rating of Motor: <u>1</u>
Date Pump Installed: <u>8-9-07</u>	Setting Depth: <u>60</u> feet
Rated Pump Capacity: <u>19</u> Gallons Per Minute	Number of Stages: _____

Pump Test Data	Method of Measuring Water Level Circle one
Date Well Tested: _____	Air Line Electric Measuring Line Steel Tape
Static Water Level (A): _____ Feet Below Land Surface	Other (specify): _____
Pumping Water Level (B): _____ Feet Below Land Surface	For flowing well, measured shut in head: _____ feet
Drawdown [(B) - (A)]: _____ Feet Below Land Surface	Well yielded _____ GPM with a drawdown of _____ feet after _____ hours of pumping
Test Pumping Rate: _____ Gallons Per Minute	
Duration of Pump Test (minimum 4 hours): _____ hours	

I HEREBY CERTIFY that the above statements are true to the best of my knowledge.

David A. West 0672
 Print Name of Pump Installer and License No. (if applicable)

David A. West
 Signature of Pump Installer

RECEIVED
 AUG 24 2007
 BY: OLWR