

County: Washington  
 Permit #: GW-51503  
 Driller: Chicot Irrigation, Inc.  
 Date drilling completed: 5-13-21

**STATE WELL REPORT**  
**Part 1**  
**Driller's Log**  
 Mississippi Department of Environmental Quality  
 Office of Land and Water Resources  
 P.O. Box 2309  
 Jackson, MS 39225-2309  
 (601) 961-5210  
 (601) 360-0535 (fax)

**For Office Use Only:**

Well #: J 144  
 Aquifer: \_\_\_\_\_  
 E-Log #: \_\_\_\_\_

*State Law requires that this report be prepared by the license holder responsible for the work and filed with the Department at the above address within 30 days of completion of drilling of the well or borehole.*

Well Owner Information <i>(Landowner if borehole is not for a water well)</i>	Well or Borehole Location
Owner Name: <u>Bourbon Plantation / SBB Trust</u>	Latitude: <u>33° 18' 36.8"N</u> Longitude: <u>90° 48' 43.6"W</u>
Mailing Address: <u>P.O. Box 387</u>	Method of Lat/Long (check one): <input type="checkbox"/> Conventional Survey, <input type="checkbox"/> USGS quad, <input checked="" type="checkbox"/> Hand-held GPS, <input type="checkbox"/> Survey-grade GPS
<u>Leland</u> MS <u>38756</u> City State Zip code	<u>SW 1/4 NW 1/4, Sec 22 T 17N R 6W</u>
Telephone No. ( ) - _____	_____ Miles <u>South</u> of <u>Tribbett</u> <i>(Distance) (Direction) (Nearest Town)</i>

**Well / Borehole Data**

Date drilling started: 5-13-21 Date drilling completed: 5-13-21 Hole depth: 110' Hole diameter: 24"

Location of the source of any surface water used for drilling: Surface Water

Method of dosing and volume of Chlorine used in drilling and development: 50 PPM

Logs run (check all applicable):  No log run  Electric  Gamma Ray  Density  Sonic  Neutron  Other: \_\_\_\_\_

Name of organization running log(s): \_\_\_\_\_

Purpose of borehole (check one):  Water Well  Geotechnical/Geological Investigation  Ground Source Heat Pump  
 Seismic Survey  Other (describe) \_\_\_\_\_

*If drilling is not related to water well construction, skip the remainder of this block*

Purpose of Well (check all applicable):  Home  Industrial  Public Supply  Irrigation  Fish Culture  
 Other (describe): \_\_\_\_\_

If a flowing well, method of flow regulation: Valve \_\_\_\_\_ Other (describe) \_\_\_\_\_

Static Water Level: \_\_\_\_\_ feet [ above or  below] land surface Date measured: \_\_\_\_\_  
*(check one)*

Method of Measurement (check one)  Steel tape  Electric tape  Air line  Other: (describe) \_\_\_\_\_

Well depth: 110' Well grouted to a depth of: 10 feet Type of grout (check one):  Neat Cement  Bentonite  Mix

Casing length: 70 feet Casing diameter: 16 inches Type of casing: PVC

Screen length: 40 feet Screen diameter: 16 inches Type of screen: PVC

Screen slot size: .050 inches Setting depth: From 71 feet to 110 feet

Type of completion (check all applicable):  Gravel packed  Underreamed  Open hole  Natural Development  
 Other (describe): \_\_\_\_\_

Top of lap pipe or reduction in casing: \_\_\_\_\_ Feet

*If telescoped or more than one screen, describe on next page*

RECEIVED  
 JUN 14 2021  
 BY OLWR





County: Washington  
 Permit #: GW-51503  
 Driller: Chicot Irrigation, Inc.  
 Date drilling completed: 5-13-21  
Copy information from block on Part 1

**STATE WELL REPORT**  
**Part 2**  
**Pump Installer's Completion Report**  
 Mississippi Department of Environmental Quality  
 Office of Land and Water Resources  
 P.O. Box 2309  
 Jackson, MS 39225-2309  
 (601) 961-5210  
 (601) 360-0535 (fax)

**For Office Use Only:**  
 Well #: J 144  
 Aquifer: \_\_\_\_\_

*This part of the report must be completed by a licensed water well contractor or a licensed pump installer. A copy of Part 1 of the report must be attached and both parts filed with the Department at the above address within 30 days of well completion.*

Well Owner Information	Well Location
Owner Name: <u>Bourbon Plantation / SBB Trust</u>	Latitude: <u>33° 18' 36.8"N</u> Longitude: <u>90° 48' 43.6"W</u>
Mailing Address: <u>P.O. Box 387</u>	Method of Lat/Long (check one): <input type="checkbox"/> Conventional Survey, <input type="checkbox"/> USGS quad, <input checked="" type="checkbox"/> Hand-held GPS, <input type="checkbox"/> Survey-grade GPS
<u>Leland</u> <u>MS</u> <u>38756</u> City State Zip code	<u>SW 1/4 NW 1/4, Sec 22 T 17N R 6W</u>
Telephone No. <u>( ) -</u>	<u>South</u> of <u>Tribbett</u> (Distance) (Direction) (Nearest Town)

**Pump Type (check one)**

Submersible  Turbine  Air Lift  Centrifugal  Flowing Well  Jet  Piston  Rotary  Other (describe): \_\_\_\_\_

Date Pump Installed \_\_\_\_\_ Rated Pump Capacity: 2000 +/- Gallons Per Minute

Is This Pump (check one):  New  Repaired  Replacement

**Power Type (check one)**

Electric  Diesel  Gasoline  Natural Gas  Tractor PTO  Windmill  Other (describe): \_\_\_\_\_

Horse Power Rating of Motor: 60 Setting Depth: 70 feet Number of Stages: 2

**Pump Test Data for Non Flowing Well**

Date Well Tested: \_\_\_\_\_ Duration of Pump Test (minimum 4 hours): \_\_\_\_\_ Hours

Static Water Level (A): \_\_\_\_\_ Feet Below Land Surface Pumping Water Level (B): \_\_\_\_\_ Feet Below Land Surface

Drawdown [(B) - (A)]: \_\_\_\_\_ Feet Below Land Surface Test Pumping Rate: \_\_\_\_\_ Gallons Per Minute

Method of measurement (check one):  Steel tape  Electric tape  Air line  Other (describe): \_\_\_\_\_

**Pump Test Data for Flowing Well**

Measured shut in head: \_\_\_\_\_ Feet

Well yielded \_\_\_\_\_ GPM with a drawdown of \_\_\_\_\_ feet after \_\_\_\_\_ hours of pumping

**Meter Installation**

Meter Manufacturer: \_\_\_\_\_ Meter Serial Number: \_\_\_\_\_

Meter Model Number/Name: \_\_\_\_\_ Type of Meter: \_\_\_\_\_

Totalizer Register Unit and Multiplier Factor (AF x .001, gal x 1000, etc): \_\_\_\_\_

Installation Date: \_\_\_\_\_ Meter installed by: \_\_\_\_\_

Is This Meter (check one):  New  Repaired  Replacement

*Important: By submitting the above information you are certifying that this meter was installed to manufacturer standards.  
For agricultural wells, a list of approved meters is on the MDEQ website.*

I HEREBY CERTIFY that the above statements are true to the best of my knowledge.

John Newcome - 0773 5-15-21  
 Print Name of Pump Installer and License No. (if applicable) Date

[Signature]  
 Signature of Pump Installer

Form: OLWR-SWR-1B (4/13)

RECEIVED  
 JUN 14 2021  
 BY OLWR



# STATE OF MISSISSIPPI

Department of Environmental Quality

Office of Land and Water Resources

P.O.Box 2309

Jackson, Mississippi 39225

## PERMIT

### TO DIVERT OR WITHDRAW FOR BENEFICIAL USE THE PUBLIC WATERS

This permit is issued to the landowner named below in accordance with the provisions of the Mississippi Water Laws, Mississippi Code Sections 51-3-1, et seq.(1972, as amended), and the regulations and standards as promulgated thereunder. Whether or not specifically named in this permit or in the applications for this permit, anyone using water from the diversion/withdrawal point described below shall do so in compliance with the provisions of this permit. Neither this permit, nor any authority conferred hereby, may be sold, conveyed, encumbered, assigned or otherwise aliened, for any period of time or under any conditions whatsoever. This permit may not be modified, transferred, or revoked without prior action by the Permit Board. Any attempts to modify, transfer or revoke this permit, or to take any other action on this permit, shall be invalid and unenforceable and may result in immediate revocation or suspension of this permit. The holder of this permit shall at all times be responsible for adherence to the terms and conditions of this permit. No agreement between the permit holder and any other party shall affect the obligations and liabilities of the permit holder. Water use under this permit is allowed only when the streamflow or lake level elevation (whichever, if any, is applicable) is above the established minimum, pursuant to Mississippi Code Section 51-3-7. Authorization is hereby granted to divert/withdraw water for the beneficial use designated herein, and for no other purpose, subject to the following terms, conditions, and limitations:

**Permit Number:** MS-GW-51503 **Total Permitted Acreage:** 150

**Landowner Name:** BAKER, STEPHANIE ANN BROWN, TRUST

**Landowner Address:** PO BOX 387  
LELAND, MS 38756

**Source of Water:** MISSISSIPPI RIVER VALLEY ALLUVIAL AQUIFER

**Beneficial Use(s):** IRRIGATION

**Diversion/Withdrawal Location:** SW 1/4 of the NW 1/4 **Section:** 22 **Township:** 17N **Range:** 06W

**County:** WASHINGTON **Quad:** TRIBETT

**Permitted Acreage:** **Irrigation:** 150 **Fish Culture:** 0 **Wildlife Management:** 0

**Maximum Volume:** See Special Terms And Conditions (attachment I)

**Applicant Name:** BOURBON PLANTATION

**Applicant Address:** PO BOX 387  
LELAND, MS 38756

**Date Permit Issued:** 05/13/2021

**Date Permit Expires:** 05/13/2026

**Date Permit Modified:**

**Date Permit Reissued:**

This permit shall be deemed null and void if construction has not begun within one (1) year of the permit issue date.

**SPECIAL TERMS AND CONDITIONS 1:**

See Attachment I which is hereby declared part of this permit.

RECEIVED  
JUN 14 2021  
BY OLWR

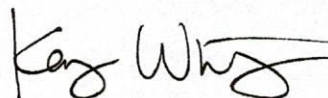

Kay Whittington, Director  
Office of Land and Water Resources



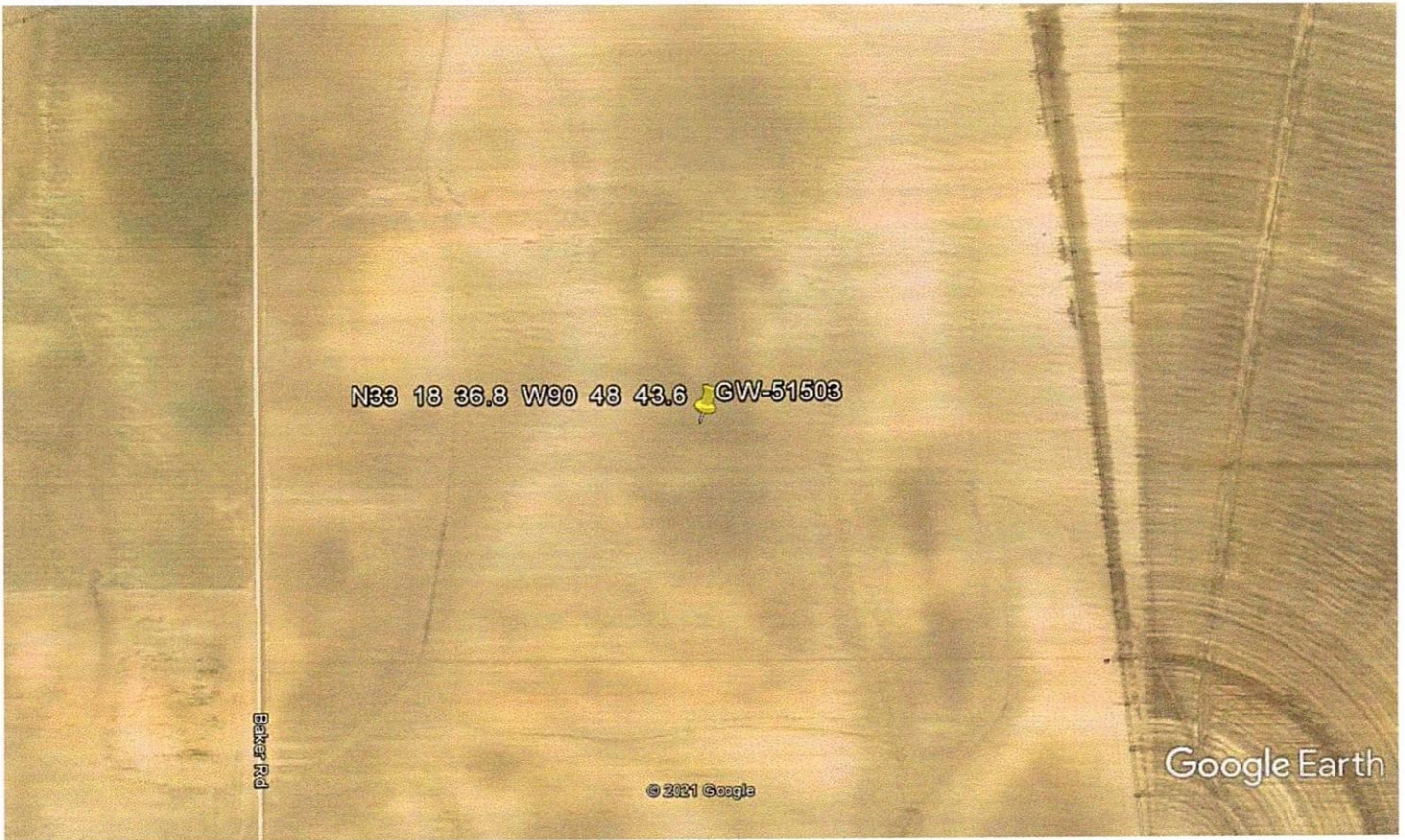

Google Earth

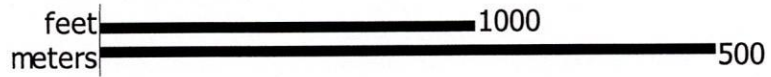

RECEIVED  
JUN 14 2021  
BY OLWR