

# State Well Report

## Part 1 - Driller's Log

Mississippi Department of Environmental Quality  
Office of Land and Water Resources  
P.O. Box 10631  
Jackson, MS 39289-0631  
(601)961-5210  
(601)354-6938 (fax)

County: Washington  
Permit #: CW 41931  
Driller: Charles M. Nichols  
Date drilling completed: 6-1-07

For Office Use Only:  
Aquifer: \_\_\_\_\_  
Well #: H-204  
L. S. Elevation: \_\_\_\_\_  
E-log #: \_\_\_\_\_

State Law requires that this report be prepared by the license holder responsible for the work and filed with the Department at the above address within 30 days of completion of drilling of the well or borehole.

Information on Well Owner (Landowner if borehole is not for a water well)	Well or Borehole Location
Owner Name: <u>AQUA FARMS INC.</u>	Latitude: <u>33° 18' 34" N</u> Longitude: <u>090° 56' 10" W</u>
Mailing Address: <u>1274 WILMOT RD</u>	Method of Lat/Long (circle one): <u>Hand-held GPS</u>
<u>GREENVILLE MS 38701</u>	USGS quad: <u>14</u>
City State Zip Code	<u>20</u> fwn <u>17</u> Rng <u>7</u>
Telephone No. ( ) _____	Distance Direction Nearest Town <u>3 1/2</u> Miles <u>NW</u> of <u>ARCOLA</u>

**Well / Borehole Data**

Date drilling started: 6-1-07 Date drilling completed: 6-1-07 Hole depth: 93 Hole diameter: 26

Location of the source of any surface water used for drilling: Fish Pond

Method of dosing and volume of Chlorine used in drilling and development: \_\_\_\_\_

Logs run (circle all applicable): No log run Electric Gamma Ray Density Sonic Neutron Other: \_\_\_\_\_

Name of organization running log(s): \_\_\_\_\_

Purpose of borehole (check one): Water Well  Geotechnical/Geological Investigation \_\_\_\_\_ Ground Source Heat Pump \_\_\_\_\_

Seismic Survey \_\_\_\_\_ Other (describe) \_\_\_\_\_

*If drilling is not related to water well construction, skip the remainder of this block*

Purpose of Well (check one): Home \_\_\_\_\_ Industrial \_\_\_\_\_ Public Supply \_\_\_\_\_ Irrigation \_\_\_\_\_ Fish Culture \_\_\_\_\_ Other: Other

If a flowing well, method of flow regulation: Valve \_\_\_\_\_ Other (describe) \_\_\_\_\_

Static Water Level: 27 feet above below (circle one) land surface Date measured: 6-4-07

Method of Measurement (circle one): steel tape electric tape air line other: \_\_\_\_\_

Well depth: 93 Well grouted to a depth of 10 feet Type of grout (circle one): Neat Cement Bentonite Mix

Casing length: 73 feet Casing diameter: 16 inches Type of casing: pvc

Screen length: 20 feet Screen diameter: 16 inches Type of screen: pvc

Screen slot size: .050 inches Setting depth: From 73 feet to 93 feet

Type of completion (circle all applicable): Gravel packed Underreamed Telescoped Open hole Natural Development

Other (describe): \_\_\_\_\_

Top of lap pipe or reduction in casing: \_\_\_\_\_ feet. *If telescoped or more than one screen, describe on next page*

Form: OLWR-SWR-1A

RECEIVED  
JUN 27 2007  
BY: OLWR

GW41931

H-204

The sketch below only required for water wells

Description of formations encountered must be provided for all wells and boreholes, unless specifically exempted by regulations

If well telescopes, show depths on sketch

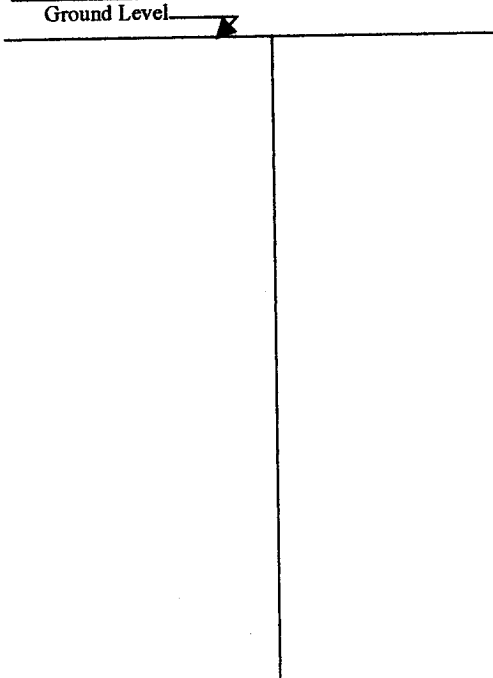

Description of Formations Encountered	From (depth)	To (depth)
	Ground Level	
Clay	0	30
Fine sand	30	40
med to coarse sand	40	50
course sand little p-gravel	50	60
fine to med sand	60	70
course sand	70	80
clay	80	83

If more than one screen, show location of each on sketch

Sketch the property layout and include the following: 1) the well location; 2) any permanent structures on the property that may aid in locating the well; 3) any roads, power lines, or other items that may aid in locating the property and the well; 4) a north arrow.

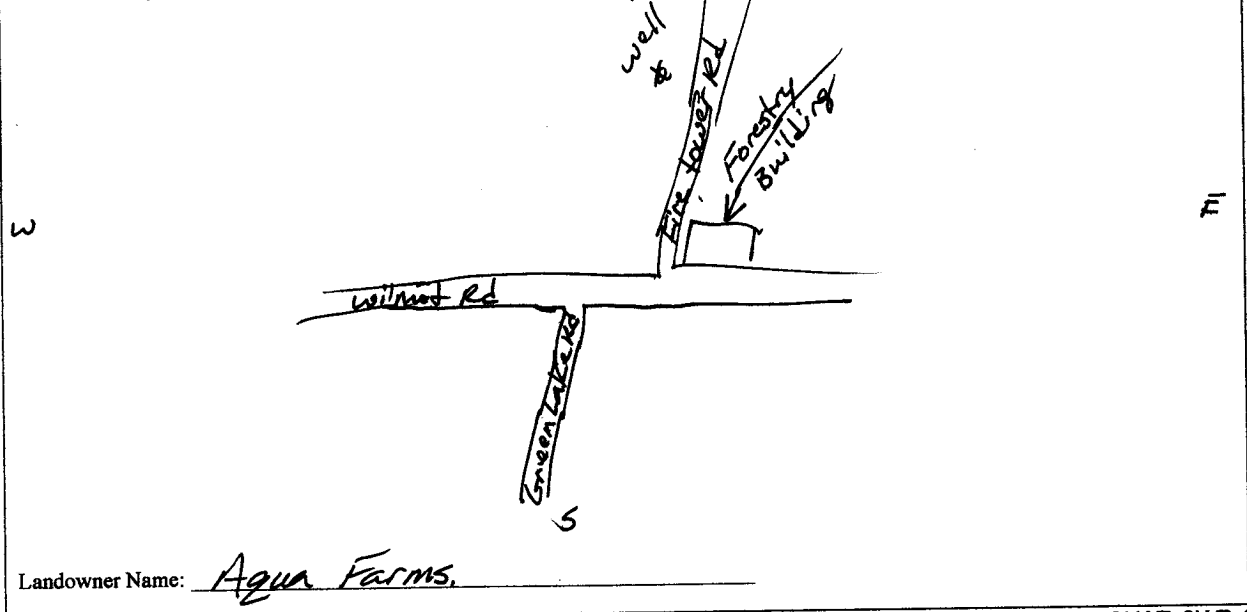

Landowner Name: Aqua Farms.

Form: OLWR-SWR-1A

I certify that the well/borehole was drilled, constructed, and completed in accordance with all applicable requirements of the Mississippi Department of Environmental Quality and the Mississippi Department of Health regulations, if applicable, and state laws.

Charles M. Nichols 0-0667 6-24-07

Charles M. Nichols

Print Name of Responsible Licensee and License No.

Date

Signature of Licensee

RECEIVED JUN 27 2007 BY: OLWR

# STATE WELL REPORT

## Part 2

**Pump Installer's Completion Report**  
 Mississippi Department of Environmental Quality  
 Office of Land and Water Resources  
 P.O. Box 10631  
 Jackson, MS 39289-0631  
 (601)961-5210  
 (601)354-6938 (fax)

County: Washington  
 Permit #: QW41931  
 Driller: Charles M. Nichols  
 Date completed: 6-1-07  
*Copy information from block on Part 1*

For Office Use Only:

Aquifer: \_\_\_\_\_  
 Well #: H-204  
 Elevation: \_\_\_\_\_

*This part of the report must be completed by a licensed water well contractor or a licensed pump installer. A copy of Part 1 of the report must be attached and both parts filed with the Department at the above address within 30 days of well completion.*

Well Owner Information	Well Location
Owner Name: <u>Aqua Farms Inc</u>	Latitude: <u>33°18'34" N</u> Longitude: <u>090°56'10" W</u>
Mailing Address: <u>1274 WILMOT RD</u>	Method of Lat/Long (check one): Conventional Survey _____
<u>Greenville MS 38701</u>	USGS quad _____, Hand-held GPS <input checked="" type="checkbox"/> , Survey-grade GPS _____
City                      State                      Zip Code	_____ 1/4 _____ 1/4 Sec <u>21</u> T <u>17N</u> R <u>7W</u>
Telephone No. ( ) _____	Distance                      Direction                      Nearest Town
	<u>3 1/2</u> Miles <u>NW</u> of <u>Arcola</u>

Pump Type Circle one	Power Type Circle one
Air Lift                      Jet <input checked="" type="radio"/> <u>Submersible</u>	Diesel Engine                      Gasoline Engine                      Natural Gas
Bucket                      Piston                      Turbine	<input checked="" type="radio"/> <u>Electric Motor</u> Hand                      Tractor PTO
Centrifugal                      Rotary                      Flowing Well	Windmill                      Other (specify): _____
Other (specify): _____	Horse Power Rating of Motor: <u>20</u>
Date Pump Installed: <u>6-4-07</u>	Setting Depth: <u>70</u> feet
Rated Pump Capacity: <u>1000</u> Gallons Per Minute	Number of Stages: <u>1</u>

Pump Test Data	Method of Measuring Water Level Circle one
Date Well Tested: _____	Air Line                      Electric Measuring Line <input checked="" type="radio"/> <u>Steel Tape</u>
Static Water Level (A): <u>27</u> Feet Below Land Surface	Other (specify): _____
Pumping Water Level (B): _____ Feet Below Land Surface	For flowing well, measured shut in head: _____ feet
Drawdown [(B) - (A)]: _____ Feet Below Land Surface	Well yielded _____ GPM with a drawdown of _____ feet after _____ hours of pumping
Test Pumping Rate: _____ Gallons Per Minute	
Duration of Pump Test (minimum 4 hours): _____ hours	

I HEREBY CERTIFY that the above statements are true to the best of my knowledge.

Charles M. Nichols 0-0667                      Charles M. Nichols  
 Print Name of Pump Installer and License No. (if applicable)                      Signature of Pump Installer

Form: OLWR-SWR-1B

RECEIVED

JUN 27 2007

BY: OLWR