

BALLARD

**State Well Report
Part 1 - Driller's Log**

Mississippi Department of Environmental Quality
Office of Land and Water Resources
P.O. Box 10631
Jackson, MS 39289-0631
(601)961-5210
(601)354-6938 (fax)

For Office Use Only:

Aquifer: _____
Well #: E-187
L. S. Elevation: _____
E-log #: _____

County: Washington
Permit #: PLW 42467
Driller: Charles M. Nichols
Date drilling completed: 3-28-08

State Law requires that this report be prepared by the license holder responsible for the work and filed with the Department at the above address within 30 days of completion of drilling of the well or borehole.

<p>Information on Well Owner (Landowner if borehole is not for a water well)</p> <p>Owner Name: <u>BALLARD FARMS</u></p> <p>Mailing Address: <u>3392 Old Hwy 61</u> <u>Leland MS 38756</u> City State Zip Code</p> <p>Telephone No. () _____</p>	<p>Well or Borehole Location</p> <p>Latitude: <u>33° 27' 30" N</u> Longitude: <u>090° 54' 19.4" W</u></p> <p>Method of Lat/Long (circle one): Conventional Survey, USGS quad, <u>Hand-held GPS</u>, Survey-grade GPS</p> <p><u>SE 1/4 SE 1/4 Sec 27 Twn 18N Rng 7W</u></p> <p>Distance Direction Nearest Town <u>3</u> Miles <u>S</u> of <u>Leland</u></p>
--	---

Well / Borehole Data

Date drilling started: 3-28-08 Date drilling completed: 3-28-08 Hole depth: 110 Hole diameter: 26 in

Location of the source of any surface water used for drilling: Deer Creek

Method of dosing and volume of Chlorine used in drilling and development: HTH

Logs run (circle all applicable): No log run Electric Gamma Ray Density Sonic Neutron Other: _____

Name of organization running log(s): _____

Purpose of borehole (check one): Water Well Geotechnical/Geological Investigation _____ Ground Source Heat Pump _____
Seismic Survey _____ Other (describe) _____

If drilling is not related to water well construction, skip the remainder of this block

Purpose of Well (check one): Home _____ Industrial _____ Public Supply _____ Irrigation Fish Culture _____ Other: _____

If a flowing well, method of flow regulation: Valve _____ Other (describe) _____

Static Water Level: 25 feet above or (below) (circle one) land surface Date measured: 3-28-08

Method of Measurement (circle one) steel tape electric tape air line other: _____

Well depth: 110 Well grouted to a depth of 10 feet Type of grout (circle one): Neat Cement Bentonite Mix

Casing length: 70 feet Casing diameter: 16 inches Type of casing: pvc

Screen length: 40 feet Screen diameter: 16 inches Type of screen: pvc

Screen slot size: .035 inches Setting depth: From 70 feet to 110 feet

Type of completion (circle all applicable): Gravel packed Underreamed Telescoped Open hole Natural Development
Other (describe): _____

Top of lap pipe or reduction in casing: _____ feet. *If telescoped or more than one screen, describe on next page*

Form: OLWR-SWR-1A

Replacement well.

42467

RECEIVED

RECEIVED

MAY - 9 2008

AUG 05 2008

YMD JOINT WATER
MANAGEMENT DISTRICT

BY: OLWR

E-187

EW42467

The sketch below only required for water wells

Description of formations encountered must be provided for all wells and boreholes, unless specifically exempted by regulations

If well telescopes, show depths on sketch

Ground Level _____

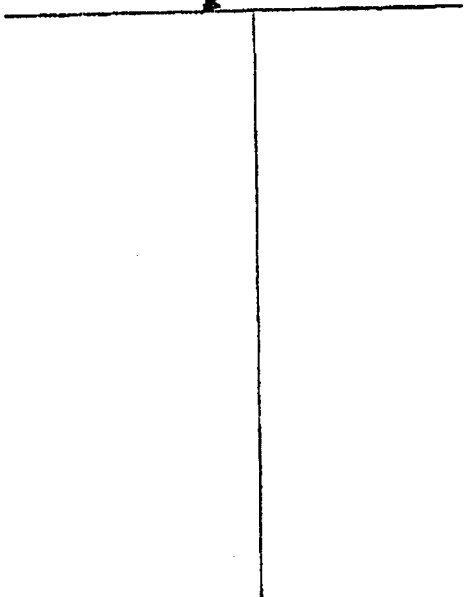

Description of Formations Encountered	From (depth)	To (depth)
sandy clay	Ground Level	10
fine sand	10	40
med to course sand	40	50
fine sand	50	60
med sand	60	70
course sand py + gravel	70	103
clay	103	110

If more than one screen, show location of each on sketch

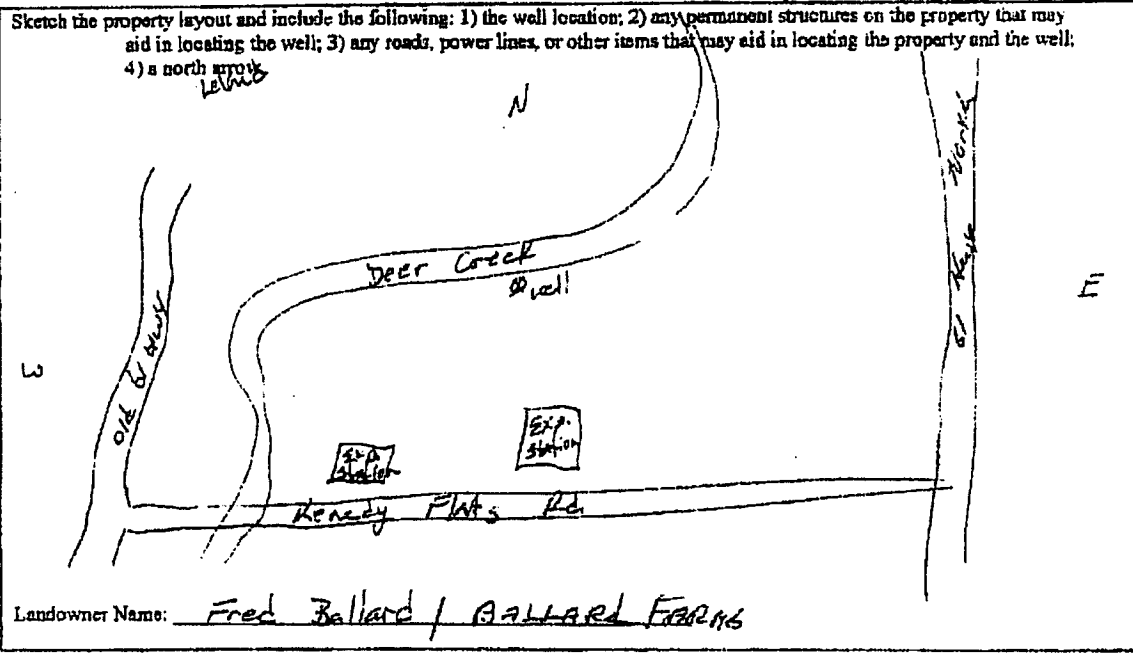

Form: OLWR-SWR-1A

I certify that the well/borehole was drilled, constructed, and completed in accordance with all applicable requirements of the Mississippi Department of Environmental Quality and the Mississippi Department of Health regulations, if applicable, and state laws.

Charles M. Nichols 0-0667 4-19-08 Charles M. Nichols
 Print Name of Responsible Licensee and License No. Date Signature of Licensee

RECEIVED
 AUG 05 2008
 BY: OLWR

STATE WELL REPORT

Part 2

Pump Installer's Completion Report
 Mississippi Department of Environmental Quality
 Office of Land and Water Resources
 P.O. Box 10631
 Jackson, MS 39289-0631
 (601)961-5210
 (601)354-6938 (fax)

County: Washington
 Permit #: 06042467
 Driller: Charles M. Nichols
 Date completed: 4-11-08
Copy information from block on Part 1

For Office Use Only:
 Aquifer: _____
 Well #: E-187
 Elevation: _____

This part of the report must be completed by a licensed water well contractor or a licensed pump installer. A copy of Part 1 of the report must be attached and both parts filed with the Department at the above address within 30 days of well completion.

Well Owner Information	Well Location
Owner Name: <u>Ballard Farms</u>	Latitude: <u>33° 22.370N</u> Longitude: <u>090° 54.194W</u>
Mailing Address: <u>3392 Old Hwy 61</u>	Method of Lat/Long (check one): Conventional Survey _____
<u>Leland MS 38756</u>	USGS quad _____ Hand-held GPS <input checked="" type="checkbox"/> Survey-grade GPS _____
City State Zip Code	<input type="checkbox"/> 1/4 <input type="checkbox"/> 1/2 Sec T _____ R _____
Telephone No. () _____	Distance Direction Nearest Town
	<u>3</u> Miles <u>South</u> of <u>Leland.</u>

Pump Type Circle one	Power Type Circle one
Air Lift Jet Submersible	<input checked="" type="radio"/> Diesel Engine Gasoline Engine Natural Gas
Bucket Piston <input checked="" type="radio"/> Turbine	Electric Motor Hand Tractor PTO
Centrifugal Rotary Flowing Well	Windmill Other (specify): _____
Other (specify): <u>Customer pump.</u>	Horse Power Rating of Motor: <u>60</u>
Date Pump Installed: <u>4-11-08</u>	Setting Depth: <u>60</u> feet
Rated Pump Capacity: <u>2500</u> Gallons Per Minute	Number of Stages: <u>2</u>

Pump Test Data	Method of Measuring Water Level Circle one
Date Well Tested: _____	Air Line Electric Measuring Line <input checked="" type="radio"/> Steel Tape
Static Water Level (A): <u>25</u> Feet Below Land Surface	Other (specify): _____
Pumping Water Level (B): _____ Feet Below Land Surface	For flowing well, measured shut in head: _____ feet
Drawdown [(B) - (A)]: _____ Feet Below Land Surface	Well yielded _____ GPM with a drawdown of _____ feet after _____ hours of pumping
Test Pumping Rate: _____ Gallons Per Minute	
Duration of Pump Test (minimum 4 hours): _____ hours	

I HEREBY CERTIFY that the above statements are true to the best of my knowledge.

Charles M. Nichols 0-0667
 Print Name of Pump Installer and License No. (if applicable)

Charles M. Nichols
 Signature of Pump Installer

Form: OLWR-SWR-1B

RECEIVED
 AUG 05 2008
 BY: OLWP