

GT & T EAST well
State Well Report

Part 1

Mississippi Department of Environmental Quality
 Office of Land and Water Resources
 P.O. Box 10631
 Jackson, MS 39289-0631
 (601)961-5210
 (601)354-6938 (fax)

County: WASHINGTON
 Permit #: GW 44154
 Driller: J. NEWCOME 0-773
 Date drilling completed: 4-13-10

For Office Use Only:

Aquifer: D 243
 Well #: _____
 L. S. Elevation: _____
 E-log #: _____

State Law requires that this report be prepared by the driller in detail and filed with the Department within 30 days of completion of drilling of the well.

Well Owner Information	Well Location
Owner Name: <u>GT & T FORMS</u>	Latitude: <u>33° 22' 38"</u> Longitude: <u>90° 59' 31"</u>
Mailing Address: <u>1844 Jacqueline Dr</u>	Method of Lat/Long (circle one): <u>Conventional Survey</u>
<u>Greenville MS 38701</u>	USGS quad: <u>Hand-held GPS</u> Survey-grade GPS
City State Zip Code	<u>SW 1/4 NE 1/4 Sec 28 Twn 18N Rng 8W</u>
Telephone No. () _____	Distance Direction Nearest Town <u>3/4</u> Miles <u>South East</u> of <u>Greenville ms</u>

Well Data

Purpose of Well (circle one) Home Industrial Public Supply Irrigation Fish Culture Other: _____

Date well drilling started: 4-13-10 Date well drilling completed: 4-13-10

If flowing, method of flow regulation: Valve _____ Other (describe) _____

Static Water Level: _____ feet above or below (circle one) land surface Date measured: _____

Method of Measurement (circle one) steel tape electric tape air line other: _____

Hole depth: 93 Well depth: 90 Well grouted to a depth of 10 feet

Type of grout (circle one): Cement Bentonite Mix

Casing length: 52 feet Casing diameter: 16 inches Type of casing: PVC

Screen length: 38 feet Screen diameter: 16 inches Type of screen: PVC

Screen slot size: .050 inches Setting depth: From 52 feet to 90 feet

Type of completion (circle all applicable): Gravel packed Underreamed Telescoped Open hole Natural Development

Other (describe): _____

Top of lap pipe or reduction in casing: _____ feet. If telescoped or more than one screen, describe on back of page

Logs run (circle all applicable) No log run Electric Gamma Ray Density Sonic Neutron Other: _____

Name of organization running log(s): _____

I certify that the well was drilled, constructed, and completed in accordance with all applicable requirements of the Mississippi Department of Environmental Quality and/or the Mississippi Department of Health regulations and state laws.

JOHN NEWCOME 0-773 _____
 Print Name of Water Well Contractor and License No. Signature of Water Well Contractor

RECEIVED
 AUG 16 2010
 BY: OLMP

If well telescopes please sketch below and show depths.

Ground Level

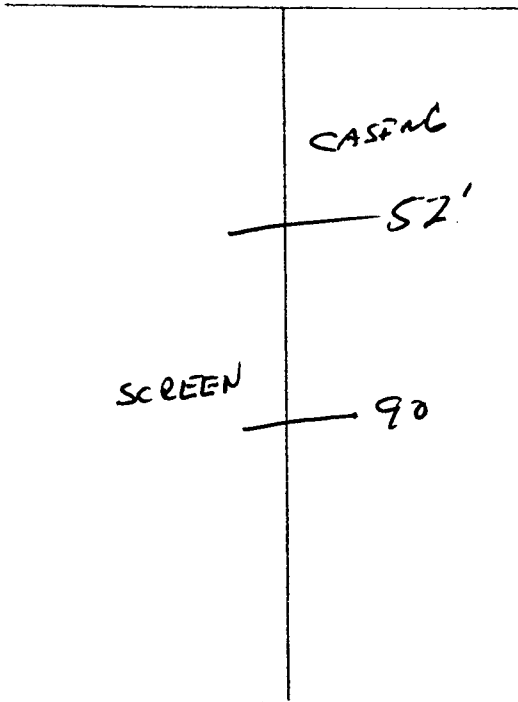

Description of Formations Encountered	From	To
TOP SOIL	0	10
MIX CLAY	10	38
FINE SAND	38	50
COARSE SAND	50	90
GRAY CLAY	90	93

If more than one screen, show location of each on sketch

Sketch the property layout and include the following: 1) the well location; 2) any permanent structures on the property that may aid in locating the well; 3) any roads, power lines, or other items that may aid in locating the property and the well; 4) indicate direction.

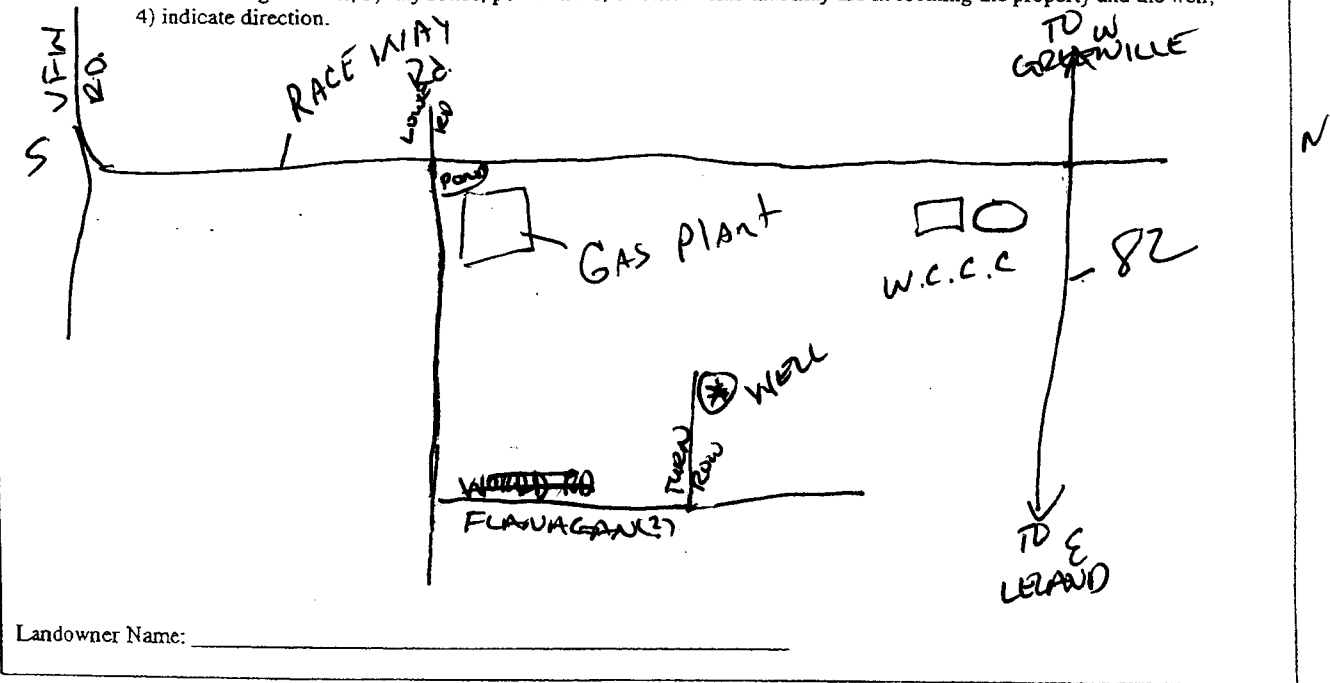

John Nowa
Signature of Water Well Contractor

STATE WELL REPORT

Part 2

Pump Installer's Completion Report
 Mississippi Department of Environmental Quality
 Office of Land and Water Resources
 P.O. Box 10631
 Jackson, MS 39289-0631
 (601)961-5210
 (601)354-6938 (fax)

For Office Use Only:

Aquifer: 10 243
 Well #: _____
 Elevation: _____

County: Washington
 Permit #: 6W 44154
 Driller: J. Newcome 0-773
 Date completed: 4-13-10

This report should be prepared by the pump installer in detail and filed with the Department within 30 days of the installation of pump.

Well-Owner Information	Well Location
Owner Name: <u>GT+T Farms</u>	Latitude: <u>33° 22' 38"</u> Longitude: <u>90° 59' 31"</u>
Mailing Address: <u>1844 Jacqueline Dr.</u>	Method of Lat/Long (circle one): Conventional Survey,
<u>Greenville MS 38701</u>	USGS quad, <u>Hand-held GPS</u> , Survey-grade GPS
City State Zip Code	<u>SW 1/4 NE 1/4 Sec 27 Twn 18N Rng 8W</u>
Telephone No. () _____	Distance Direction Nearest Town
	<u>3/4</u> Miles <u>SE</u> of <u>Greenville</u>

Pump Type Circle one	Power Type Circle one
Air Lift Jet Submersible	<u>Diesel Engine</u> Gasoline Engine Natural Gas
Bucket Piston <u>Turbine</u>	Electric Motor Hand Tractor PTO
Centrifugal Rotary Flowing Well	Windmill Other (specify): _____
Other (specify): _____	Horse Power Rating of Motor: <u>600</u>
Date Pump Installed: <u>4/14/10</u>	Setting Depth: <u>70</u> feet
Rated Pump Capacity: <u>2800</u> Gallons Per Minute	Number of Stages: <u>1</u>

Pump Test Data	Method of Measuring Water Level Circle one
Date Well Tested: _____	Air Line Electric Measuring Line Steel Tape
Static Water Level (A): _____ Feet Below Land Surface	Other (specify): _____
Pumping Water Level (B): _____ Feet Below Land Surface	For flowing well, measured shut in head: _____ feet
Drawdown [(B) - (A)]: <u> </u> Feet Below Land Surface	Well yielded _____ GPM with a drawdown of
Test Pumping Rate: _____ Gallons Per Minute	_____ feet after _____ hours of pumping
Duration of Pump Test (minimum 4 hours): _____ hours	

I HEREBY CERTIFY that the above statements are true to the best of my knowledge.

Cony Rowe 0-711P
 Print Name of Pump Installer and License No. (if applicable)

C Rowe
 Signature of Pump Installer

RECEIVED

AUG 16 2010

BY: OIWR