

dated 3-27-09

County: Washington
 Permit #: _____
 Driller: Charles M. Nichols
 Date drilling completed: 3-23-09

State Well Report
Part 1 - Driller's Log
 Mississippi Department of Environmental Quality
 Office of Land and Water Resources
 P.O. Box 10631
 Jackson, MS 39289-0631
 (601)961-5210
 (601)354-6938 (fax)

For Office Use Only:
 Aquifer: _____
 Well #: D-237
 L. S. Elevation: _____
 E-log #: _____

State Law requires that this report be prepared by the license holder responsible for the work and filed with the Department at the above address within 30 days of completion of drilling of the well or borehole.

Information on Well Owner (Landowner if borehole is not for a water well)	Well or Borehole Location
Owner Name: <u>Dennis Burke</u>	Latitude: <u>33° 26.570N</u> Longitude: <u>091° 3.315W</u>
Mailing Address: <u>300 S. Chester</u>	Method of Lat/Long (circle one): Conventional Survey, <u>19</u>
<u>Ruleville MS 38771</u>	USGS quad: <u>Hand-held GPS</u> Survey-grade GPS
City State Zip Code	<u>1/4</u> <u>1/4</u> Sec <u>2</u> Twn <u>18N</u> Rng <u>8W</u>
Telephone No. () _____	Distance Direction Nearest Town <u>1/2</u> Miles <u>North</u> of <u>Greenville</u>

Well / Borehole Data

Date drilling started: 3-19-09 Date drilling completed: 3-23-09 Hole depth: 500 Hole diameter: 7 7/8 x 5 1/8

Location of the source of any surface water used for drilling: Lake Ferguson
 Method of dosing and volume of Chlorine used in drilling and development: HTH

Logs run (circle all applicable): No log run Electric Gamma Ray Density Sonic Neuron Other: _____
 Name of organization running log(s): _____

Purpose of borehole (check one): Water Well Geotechnical/Geological Investigation _____ Ground Source Heat Pump _____
 Seismic Survey _____ Other (describe) _____

If drilling is not related to water well construction, skip the remainder of this block

Purpose of Well (check one): Home Industrial _____ Public Supply _____ Irrigation _____ Fish Culture _____ Other: _____

If a flowing well, method of flow regulation: Valve _____ Other (describe) _____

Static Water Level: 67 feet above or below (circle one) land surface Date measured: 3-23-09

Method of Measurement (circle one) steel tape electric tape air line other: _____

Well depth: 495 Well grouted to a depth of 20 feet Type of grout (circle one): Neat Cement Bentonite Mix

Casing length: 475 feet Casing diameter: 4x2 inches Type of casing: pvc

Screen length: 20 feet Screen diameter: 2 inches Type of screen: pvc

Screen slot size: .008 inches Setting depth: From 475 feet to 495 feet

Type of completion (circle all applicable): Gravel packed Underreamed Telescoped Open hole Natural Development
 Other (describe): _____

Top of lap pipe or reduction in casing: 200 feet. *If telescoped or more than one screen, describe on next page*

Form: OLWR-SWR-1A

RECEIVED
 MAR 27 2009
 BY: OLWR

well Extended 10 ft.
Above ground level.

The sketch below only required for water wells

Description of formations encountered must be provided for all
wells and boreholes, unless specifically exempted by regulations

If well telescopes, show depths on sketch

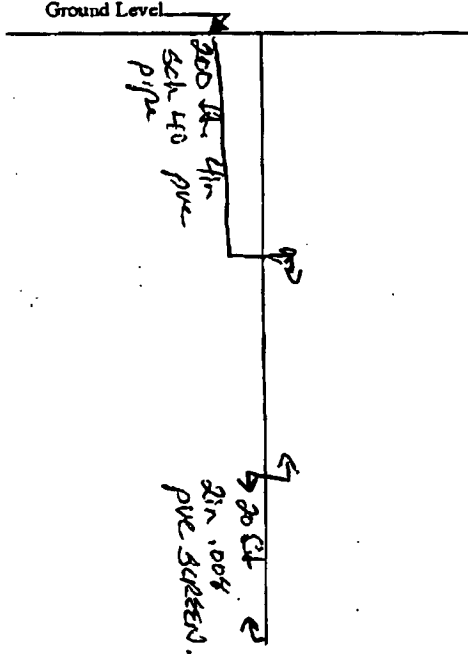

Description of Formations Encountered	From (depth)	To (depth)
Clay	Ground Level	20
sand + p-gravel	20	110
Clay	110	346
fine sand	346	440
med sand	440	460
course sand	460	500

If more than one screen, show location of each on sketch

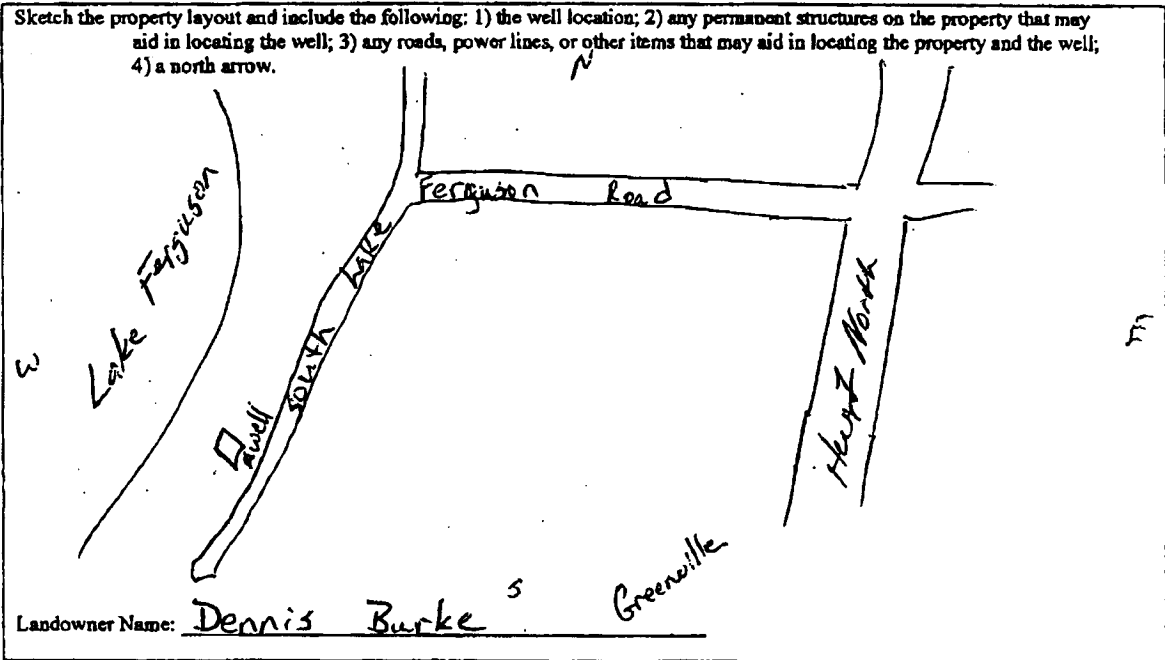

Form: OLWR-SWR-1A

I certify that the well/borehole was drilled, constructed, and completed in accordance with all applicable requirements of the Mississippi Department of Environmental Quality and the Mississippi Department of Health regulations, if applicable, and state laws.

Charles M. Nichols 0-0667 3-26-09
Print Name of Responsible Licensee and License No. Date

Charles M. Nichols
Signature of Licensee

RECEIVED

MAR 27 2009

BY: OLWR

MAR 27 09 02:04p

STATE WELL REPORT

Part 2

Pump Installer's Completion Report
 Mississippi Department of Environmental Quality
 Office of Land and Water Resources
 P.O. Box 10631
 Jackson, MS 39289-0631
 (601)961-3210
 (601)354-6938 (fax)

County: Washington
 Permit #: _____
 Driller: Charles M. Nichols
 Date completed: 3-26-09
Copy information from block on Part 1

For Office Use Only:

Aquifer: _____
 Well #: D-237
 Elevation: _____

This part of the report must be completed by a licensed water well contractor or a licensed pump installer. A copy of Part 1 of the report must be attached and both parts filed with the Department at the above address within 30 days of well completion.

Well Owner Information	Well Location
Owner Name: <u>Dennis Burke</u>	Latitude: <u>33°26.570'N</u> Longitude: <u>091°3.315'W</u>
Mailing Address: <u>300 S. CHESTER</u>	Method of Lat/Long (check one): Conventional Survey _____
<u>Ruleville MS 38771</u>	USGS quad _____ Hand-held GPS <input checked="" type="checkbox"/> Survey-grade GPS _____
City State Zip Code	_____ 1/4 _____ 1/4 Sec _____ T _____ R _____
Telephone No. () _____	Distance Direction Nearest Town
	<u>1/2</u> Miles <u>North</u> of <u>Greenville</u>

Pump Type Circle one	Power Type Circle one
Air Lift Jet <input type="checkbox"/> <u>Submersible</u>	Diesel Engine Gasoline Engine Natural Gas
Bucket Piston <input type="checkbox"/> Turbine <input type="checkbox"/>	<u>Electric Motor</u> Hand Tractor PTO
Centrifugal Rotary <input type="checkbox"/> Flowing Well <input type="checkbox"/>	Windmill Other (specify): _____
Other (specify): _____	Horse Power Rating of Motor: <u>1 HP.</u>
Date Pump Installed: <u>3-23-09</u>	Setting Depth: <u>160</u> feet
Rated Pump Capacity: <u>18</u> Gallons Per Minute	Number of Stages: <u>9</u>

Pump Test Data	Method of Measuring Water Level Circle one
Date Well Tested: _____	Air Line <input type="checkbox"/> <u>Electric Measuring Line</u> Steel Tape <input type="checkbox"/>
Static Water Level (A): <u>67</u> Feet Below Land Surface	Other (specify): _____
Pumping Water Level (B): _____ Feet Below Land Surface	For flowing well, measured shut in head: _____ feet
Drawdown [(B) - (A)]: _____ Feet Below Land Surface	Well yielded _____ GPM with a drawdown of _____ feet after _____ hours of pumping
Test Pumping Rate: _____ Gallons Per Minute	
Duration of Pump Test (minimum 4 hours): _____ hours	

I HEREBY CERTIFY that the above statements are true to the best of my knowledge.

Charles M. Nichols 0-0667 Charles M. Nichols
 Print Name of Pump Installer and License No. (if applicable) Signature of Pump Installer

RECEIVED
 Form OLWR 1B

MAR 27 2009

BY: OLWR

Mar 27 09 02:04p