

Walthall

STATE WELL REPORT

Part 1

Driller's Log

Mississippi Department of Environmental Quality
Office of Land and Water Resources
P.O. Box 2309
Jackson, MS 39225-2309
(601)961-5210
(601)360-0535 (fax)

For Office Use Only:

Well #: L63
Aquifer: _____
E-Log #: _____

County: Walthall
Permit #: _____
Driller: James M. Wells
Date drilling completed: 11-10-17

State Law requires that this report be prepared by the license holder responsible for the work and filed with the Department at the above address within 30 days of completion of drilling of the well or borehole.

Well Owner Information (Landowner if borehole is not for a water well) Owner Name: <u>Improve Grocery & Grill</u> Mailing Address: _____ <u>1649 Hwy 48E</u> <u>Sandy Hook MS 39478</u> City State Zip Code Telephone No. (____) _____	Well or Borehole Location Latitude: <u>31° 2.31' N</u> Longitude: <u>89° 53.43' W</u> <u>31-02-31</u> <u>89-53-43</u> Method of Lat/Long (check one): Conventional Survey _____ USGS quad _____, Hand-held GPS _____, Survey-grade GPS _____ <u>NW 1/4 NE 1/4, Sec 21 T1N R13E</u> _____ Miles _____ of _____ (Distance) (Direction) (Nearest Town)
--	---

Well / Borehole Data

Date drilling started: 11-10-17 Date drilling completed: 11-10-17 Hole depth: 230 Hole diameter: 7 1/2"

Location of the source of any surface water used for drilling: running creek

Method of dosing and volume of Chlorine used in drilling and development: granule chlorine

Logs run (circle all applicable): No log run Electric Gamma Ray Density Sonic Neutron Other: _____

Name of organization running log(s): _____

Purpose of borehole (circle one): Water Well Geotechnical/Geological Investigation Ground Source Heat Pump
 Seismic Survey Other (describe) _____

If drilling is not related to water well construction, skip the remainder of this block

Purpose of Well (circle all applicable): Home Industrial Public Supply Irrigation Fish Culture Other (describe): Commercial

If a flowing well, method of flow regulation: Valve _____ Other (describe) _____

Static Water Level: 170 feet [above or below] land surface (circle one) Date measured: 11-10-17

Method of measurement (circle one): Steel tape Electric tape Air line Other (describe): _____

Well depth: 230 Well grouted to a depth of: 10 feet Type of grout (circle one): Neat Cement Bentonite Mix

Casing length: 210 feet Casing diameter: 4 inches Type of casing: PVC

Screen length: 20 feet Screen diameter: 4 inches Type of screen: PVC

Screen slot size: .008 inches Setting depth: From 210 feet to 230 feet

Type of completion (circle all applicable): Gravel packed Underreamed Open hole Natural Development

Other (describe): _____

Top of lap pipe or reduction in casing: _____ feet

If telescoped or more than one screen, describe on next page

Walthall
 County: Marion
 Permit #: _____

For Office Use Only:
 Well #: L63

The sketch below only required for water wells

If well telescopes, show depths on sketch.

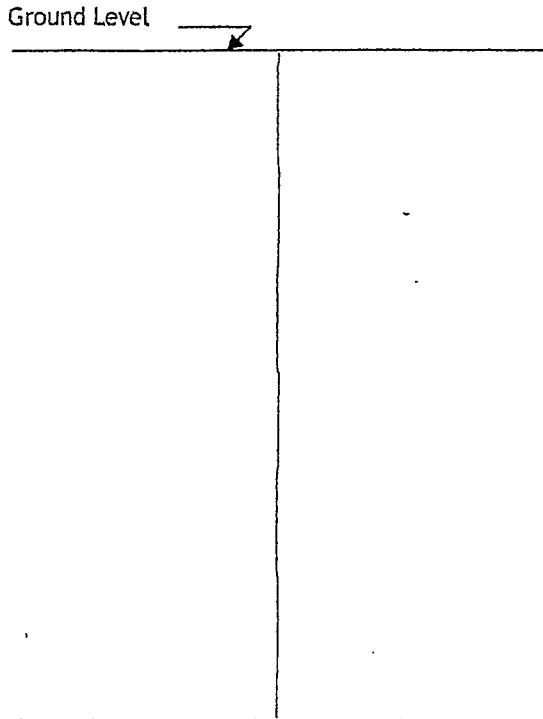

If more than one screen, show location of each on sketch

Description of formations encountered must be provided for all wells and boreholes, unless specifically exempted by regulations

Description of Formations Encountered	From (depth) Ground level	To (depth)
topsoil	1	1
Clay	1	185
sand	185	230

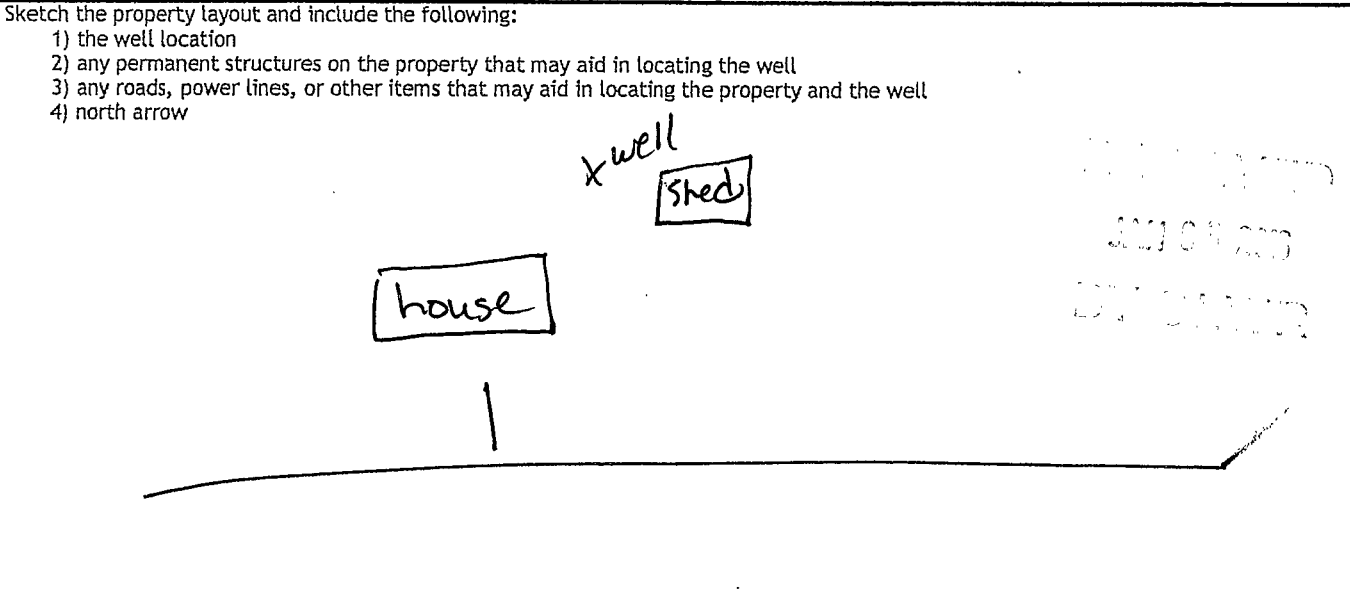

Landowner Name: Improve Grocery & Grill

I HEREBY CERTIFY that the well/borehole was drilled, constructed, and completed in accordance with all applicable requirements of the Mississippi Department of Environmental Quality and the Mississippi Department of Health regulations, if applicable, and state laws.

James M. Wells 00005889 12-28-17 James M. Wells
 Print Name of Responsible Licensee and License No. Date Signature of Licensee

Walthall

STATE WELL REPORT

Part 2

Pump Installer's Completion Report

Mississippi Department of Environmental Quality
Office of Land and Water Resources
P.O. Box 2309
Jackson, MS 39225-2309
(601)961-5210
(601) 360-0535 (fax)

For Office Use Only:

Well #: L63
Aquifer: _____

County: Walthall
Permit #: _____
Driller: James M. Wells
Date completed: 11-10-17
Copy information from block on Part 1

This part of the report must be completed by a licensed water well contractor or a licensed pump installer. A copy of Part 1 of the report must be attached and both parts filed with the Department at the above address within 30 days of well completion.

Well Owner Information		31-02-31 Well Location 89-053-43	
Owner Name: <u>Improve Grocery and Grill</u>		Latitude: <u>31°2.31N</u>	Longitude: <u>89°53.43W</u>
Mailing Address: _____		Method of Lat/Long (check one): Conventional Survey _____, USGS quad _____, Hand-held GPS _____, Survey-grade GPS _____	
<u>11649 Hwy 48E</u>		NW $\frac{1}{4}$ NE $\frac{1}{4}$, Sec <u>21</u> T <u>1N</u> R <u>13E</u>	
<u>Sandy Hook</u> City	<u>MS</u> State	<u>39478</u> Zip Code	
Telephone No. (____) _____		____ Miles of _____ (Distance) (Direction) (Nearest Town)	

Pump Type (circle one)

Submersible Turbine Air Lift Centrifugal Flowing Well Jet Piston Rotary Other (describe): _____

Date Pump Installed: 11-10-17 Rated Pump Capacity: 12 Gallons Per Minute

Is This Pump (circle one): New Repaired Replacement

Power Type (circle one)

Electric Diesel Gasoline Natural Gas Tractor PTO Windmill Other (describe): _____

Horse Power Rating of Motor: 1 Setting Depth: 190 feet Number of Stages: 14

Pump Test Data for Non Flowing Well

Date Well Tested: 11-10-17 Duration of Pump Test (minimum 4 hours): 4 hours

Static Water Level (A): 170 Feet Below Land Surface Pumping Water Level (B): 190 Feet Below Land Surface

Drawdown [(B) - (A)]: 178 Feet Below Land Surface Test Pumping Rate: 17 Gallons Per Minute

Method of measurement (circle one): Steel tape Electric tape Air line Other (describe): _____

Pump Test Data for Flowing Well

Measured shut in head: _____ feet.

Well yielded _____ GPM with a drawdown of _____ feet after _____ hours of pumping

Meter Installation

Meter Manufacturer: _____ Meter Serial Number: _____

Meter Model Number/Name: _____ Type of Meter: _____

Totalizer Register Unit and Multiplier Factor (AF x .001, gal x 1000, etc): _____

Installation Date: _____ Meter installed by: _____

Is This Meter (circle one): New Repaired Replacement

Important: By submitting the above information you are certifying that this meter was installed to manufacturer standards. For agricultural wells, a list of approved meters is on the MDEQ website.

I HEREBY CERTIFY that the above statements are true to the best of my knowledge.

James M. Wells 00005889 12-28-17 James M. Wells
Print Name of Pump Installer and License No. (if applicable) Date Signature of Pump Installer