

STATE WELL REPORT

Part 1

Driller's Log

Mississippi Department of Environmental Quality
Office of Land and Water Resources
P.O. Box 2309
Jackson, MS 39225-2309
(601)961-5210
(601)360-0535 (fax)

For Office Use Only:

Well #: K105
Aquifer: _____
E-Log #: _____

County: Walthall
Permit #: _____
Driller: James M. Wells
Date drilling completed: 4-3-14

State Law requires that this report be prepared by the license holder responsible for the work and filed with the Department at the above address within 30 days of completion of drilling of the well or borehole.

Well Owner Information <small>(Landowner if borehole is not for a water well)</small>	Well or Borehole Location
Owner Name: <u>Dennis Bell</u>	Latitude: <u>31° 00.772</u> Longitude: <u>089° 57.109</u> <small>46</small> <small>06</small>
Mailing Address: <u>47 Marshall Pittman Rd. Lot 1</u>	Method of Lat/Long (check one): Conventional Survey _____
<u>Sandy Hook</u> <u>MS</u> <u>39478</u>	USGS quad _____, Hand-held GPS _____, Survey-grade GPS _____
City State Zip Code	<u>NW</u> <u>1/4</u> <u>NW</u> <u>1/4</u> , Sec <u>36</u> <u>T</u> <u>11V</u> <u>R</u> <u>10E</u>
Telephone No. (____) _____	<u>18</u> Miles <u>SE</u> of <u>Tylertown</u> <small>(Distance) (Direction) (Nearest Town)</small>

Well / Borehole Data
Date drilling started: <u>4-3-14</u> Date drilling completed: <u>4-3-14</u> Hole depth: <u>170</u> Hole diameter: <u>7 1/2"</u>
Location of the source of any surface water used for drilling: <u>Running creek</u>
Method of dosing and volume of Chlorine used in drilling and development: <u>granule chlorine</u>
Logs run (circle all applicable): <input checked="" type="checkbox"/> No log run <input type="checkbox"/> Electric <input type="checkbox"/> Gamma Ray <input type="checkbox"/> Density <input type="checkbox"/> Sonic <input type="checkbox"/> Neutron <input type="checkbox"/> Other: _____
Name of organization running log(s): _____
Purpose of borehole (circle one): <input checked="" type="checkbox"/> Water Well <input type="checkbox"/> Geotechnical/Geological Investigation <input type="checkbox"/> Ground Source Heat Pump <input type="checkbox"/> Seismic Survey <input type="checkbox"/> Other (describe) _____
<i>If drilling is not related to water well construction, skip the remainder of this block</i>
Purpose of Well (circle all applicable): <input checked="" type="checkbox"/> Home <input type="checkbox"/> Industrial <input type="checkbox"/> Public Supply <input type="checkbox"/> Irrigation <input type="checkbox"/> Fish Culture
Other (describe): _____
If a flowing well, method of flow regulation: Valve _____ Other (describe) _____
Static Water Level: <u>110</u> feet [above or <input checked="" type="checkbox"/> below] land surface Date measured: <u>4-3-14</u> <small>(circle one)</small>
Method of measurement (circle one): <input checked="" type="checkbox"/> Steel tape <input type="checkbox"/> Electric tape <input type="checkbox"/> Air line <input type="checkbox"/> Other (describe): _____
Well depth: <u>170</u> Well grouted to a depth of: <u>10</u> feet Type of grout (circle one): <input checked="" type="checkbox"/> Neat Cement <input type="checkbox"/> Bentonite <input type="checkbox"/> Mix
Casing length: <u>150</u> feet Casing diameter: <u>4</u> inches Type of casing: <u>PVC</u>
Screen length: <u>20</u> feet Screen diameter: <u>4</u> inches Type of screen: <u>PVC</u>
Screen slot size: <u>.008</u> inches Setting depth: From <u>150</u> feet to <u>170</u> feet
Type of completion (circle all applicable): <input checked="" type="checkbox"/> Gravel packed <input type="checkbox"/> Underreamed <input type="checkbox"/> Open hole <input type="checkbox"/> Natural Development
Other (describe): _____
Top of lap pipe or reduction in casing: _____ feet
<i>If telescoped or more than one screen, describe on next page</i>

County: Walthall
 Permit #: _____

For Office Use Only:
 Well #: K165

The sketch below only required for water wells

If well telescopes, show depths on sketch.

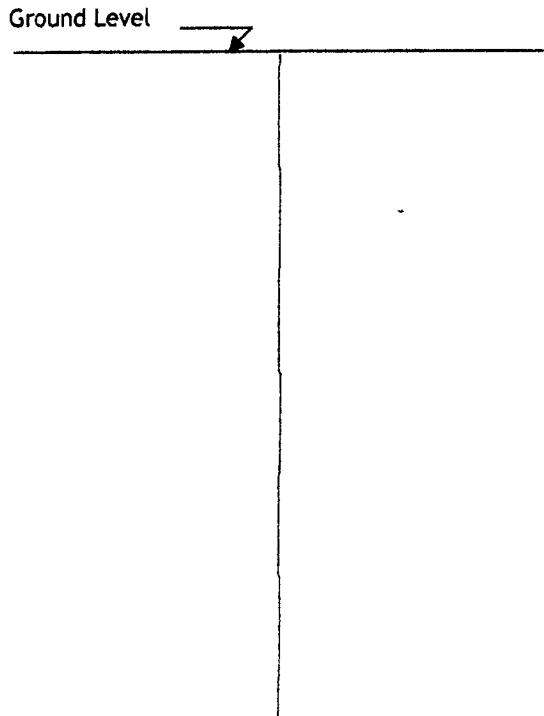

Description of formations encountered must be provided for all wells and boreholes, unless specifically exempted by regulations

Description of Formations Encountered	From (depth)	To (depth)
topsoil	Ground level	1
clay	1	130
sand	130	170

If more than one screen, show location of each on sketch

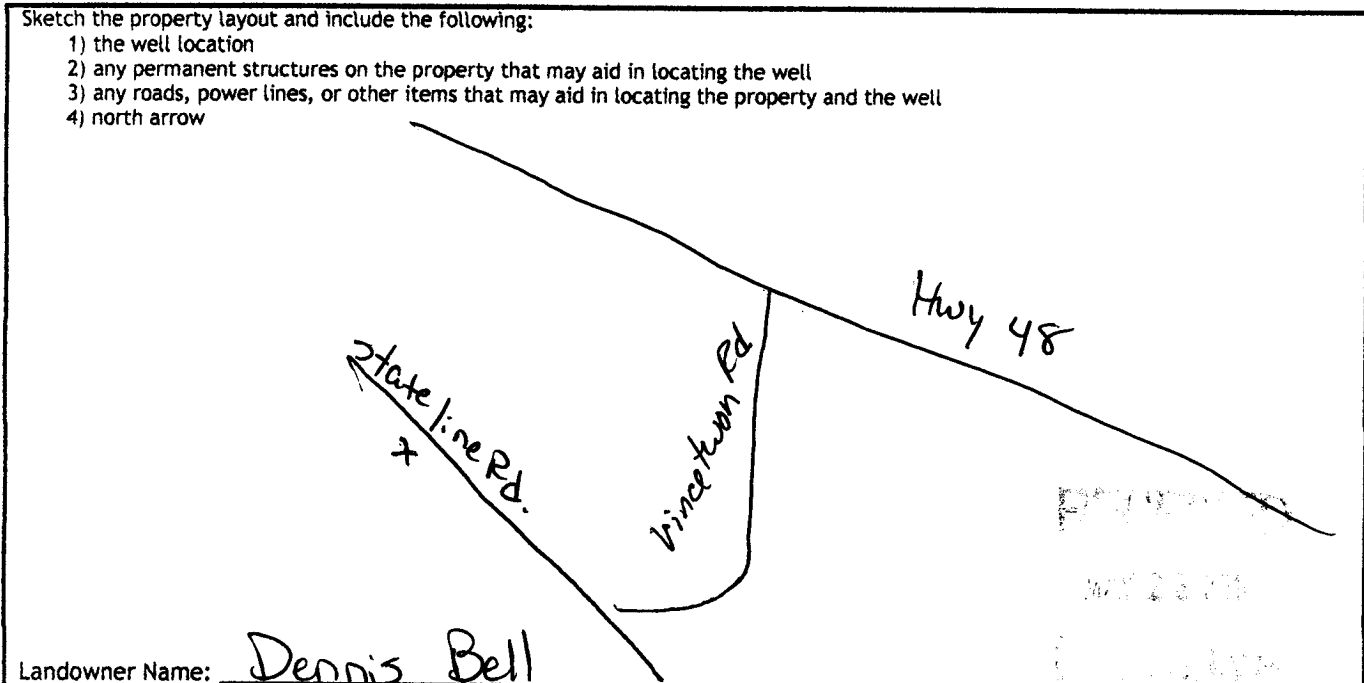

I HEREBY CERTIFY that the well/borehole was drilled, constructed, and completed in accordance with all applicable requirements of the Mississippi Department of Environmental Quality and the Mississippi Department of Health regulations, if applicable, and state laws.

James M. Wells 00005889 5-18-14 James M. Wells
 Print Name of Responsible Licensee and License No. Date Signature of Licensee

STATE WELL REPORT

Part 2

Pump Installer's Completion Report
Mississippi Department of Environmental Quality
Office of Land and Water Resources
P.O. Box 2309
Jackson, MS 39225-2309
(601)961-5210
(601) 360-0535 (fax)

County: Waltham
Permit #: _____
Driller: James M. Wells
Date completed: 4-3-14
Copy information from block on Part 1

For Office Use Only:
Well #: K105
Aquifer: _____

This part of the report must be completed by a licensed water well contractor or a licensed pump installer. A copy of Part 1 of the report must be attached and both parts filed with the Department at the above address within 30 days of well completion.

Well Owner Information	Well Location
Owner Name: <u>Dennis Bell</u>	Latitude: <u>31° 00.772</u> Longitude: <u>089° 57.109</u>
Mailing Address: _____	Method of Lat/Long (check one): Conventional Survey _____, USGS quad _____, Hand-held GPS _____, Survey-grade GPS _____
<u>47 Marshall Pittman Rd Lot 1</u>	NW ¼ NW ¼, Sec <u>36</u> T <u>1N</u> R <u>10E</u>
<u>Sandy Hook</u> MS <u>39478</u>	<u>18</u> Miles <u>SE</u> of <u>Tylertown</u>
City State Zip Code	(Distance) (Direction) (Nearest Town)
Telephone No. (____) _____	

Pump Type (circle one)
 Submersible Turbine Air Lift Centrifugal Flowing Well Jet Piston Rotary Other (describe): _____
Date Pump Installed: 4-3-14 Rated Pump Capacity: 12 Gallons Per Minute
Is This Pump (circle one): New Repaired Replacement

Power Type (circle one)
 Electric Diesel Gasoline Natural Gas Tractor PTO Windmill Other (describe): _____
Horse Power Rating of Motor: 1 Setting Depth: 140 feet Number of Stages: 14

Pump Test Data for Non Flowing Well
Date Well Tested: 4-3-14 Duration of Pump Test (minimum 4 hours): 4 hours
Static Water Level (A): 110 Feet Below Land Surface Pumping Water Level (B): 140 Feet Below Land Surface
Drawdown [(B) - (A)]: 117 Feet Below Land Surface Test Pumping Rate: 16 Gallons Per Minute
Method of measurement (circle one): Steel tape Electric tape Air line Other (describe): _____

Pump Test Data for Flowing Well
Measured shut in head: _____ feet.
Well yielded _____ GPM with a drawdown of _____ feet after _____ hours of pumping

Meter Installation
Meter Manufacturer: _____ Meter Serial Number: _____
Meter Model Number/Name: _____ Type of Meter: _____
Totalizer Register Unit and Multiplier Factor (AF x .001, gal x 1000, etc): _____
Installation Date: _____ Meter installed by: _____
Is This Meter (circle one): New Repaired Replacement
Important: By submitting the above information you are certifying that this meter was installed to manufacturer standards. For agricultural wells, a list of approved meters is on the MDEQ website.

I HEREBY CERTIFY that the above statements are true to the best of my knowledge.
James M. Wells 00005889 5-18-14 James M. Wells
Print Name of Pump Installer and License No. (if applicable) Date Signature of Pump Installer