

State Well Report

Part 1 - Driller's Log

Mississippi Department of Environmental Quality
Office of Land and Water Resources
P.O. Box 2307
Jackson, MS 39225
(601)961- 5210
(601)961- 5228 (fax)

For Office Use Only:

Aquifer: _____
Well #: H 129
L. S. Elevation: _____
E-log #: _____

County: Walthall
Permit #: _____
Driller: J.C. Sumrall
Date drilling completed: 8/15/09

State Law requires that this report be prepared by the license holder responsible for the work and filed with the Department at the above address within 30 days of completion of drilling of the well or borehole.

Information on Well Owner (Landowner if borehole is not for a water well)	Well or Borehole Location
Owner Name: <u>Donnie Bickham</u>	Latitude: <u>31° 01' 20"</u> Longitude: <u>90° 11' 18"</u>
Mailing Address: <u>745 Hwy 27 S</u> <u>Tylertown, Ms.</u>	Method of Lat/Long (circle one): Conventional Survey, USGS quad, Hand-held GPS, Survey-grade GPS
City _____ State _____ Zip Code _____	<u>NW 1/4 SW 1/4</u> Sec <u>27</u> Twn <u>1N</u> Rng <u>10E</u>
Telephone No. (____) _____	Distance _____ Direction _____ Nearest Town _____ <u>6</u> Miles <u>S</u> of <u>Tylertown</u>

Well / Borehole Data

Date drilling started: 8/15/09 Date drilling completed: 8/15/09 Hole depth: 85 Hole diameter: 7 1/2

Location of the source of any surface water used for drilling: POTABLE WATER

Method of dosing and volume of Chlorine used in drilling and development: _____

Logs run (circle all applicable): No log run Electric Gamma Ray Density Sonic Neutron Other: _____

Name of organization running log(s): _____

Purpose of borehole (check one): Water Well Geotechnical/Geological Investigation _____ Ground Source Heat Pump _____

Seismic Survey _____ Other (describe) _____

If drilling is not related to water well construction, skip the remainder of this block

Purpose of Well (check one): Home Industrial _____ Public Supply _____ Irrigation _____ Fish Culture _____ Other: _____

If a flowing well, method of flow regulation: Valve _____ Other (describe) _____

Static Water Level: 12 feet above or below (circle one) land surface Date measured: 8/15/09

Method of Measurement (circle one) steel tape electric tape air line other: _____

Well depth: 85 Well grouted to a depth of 10 feet Type of grout (circle one): Neat Cement Bentonite Mix

Casing length: 75 feet Casing diameter: 4 inches Type of casing: PVC

Screen length: 10 feet Screen diameter: 4 inches Type of screen: PVC

Screen slot size: 1010 inches Setting depth: From 75 feet to 85 feet

Type of completion (circle all applicable): Gravel packed Underreamed Telescoped Open hole Natural Development

Other (describe): _____

Top of lap pipe or reduction in casing: _____ feet. **If telescoped or more than one screen, describe on next page**

Form: OLWR-SWR-1A (04/08)

RECEIVED

AUG 12 2009

BY: OLWR

The sketch below only required for water wells

Description of formations encountered must be provided for all wells and boreholes, unless specifically exempted by regulations

If well telescopes, show depths on sketch.

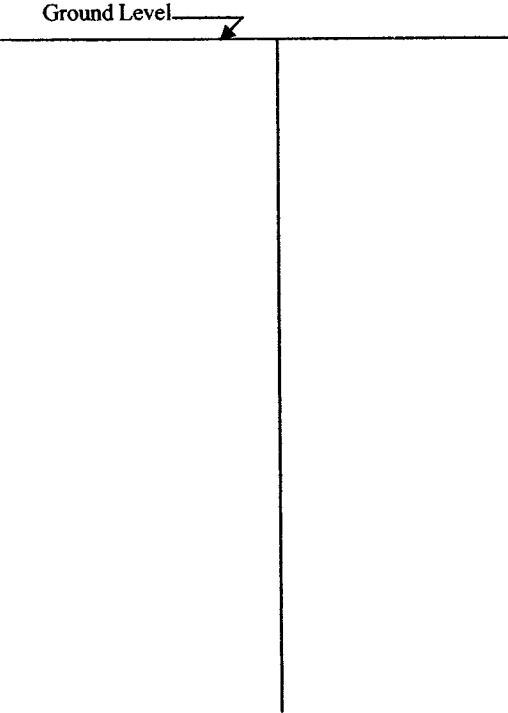

Description of Formations Encountered	From (depth)	To (depth)
Topsoil	0	1
Sandy Clay	1	12
SAND & GRAVEL	12	25
Clay	25	45
SAND	45	85

If more than one screen, show location of each on sketch

Sketch the property layout and include the following: 1) the well location; 2) any permanent structures on the property that may aid in locating the well; 3) any roads, power lines, or other items that may aid in locating the property and the well; 4) a north arrow.

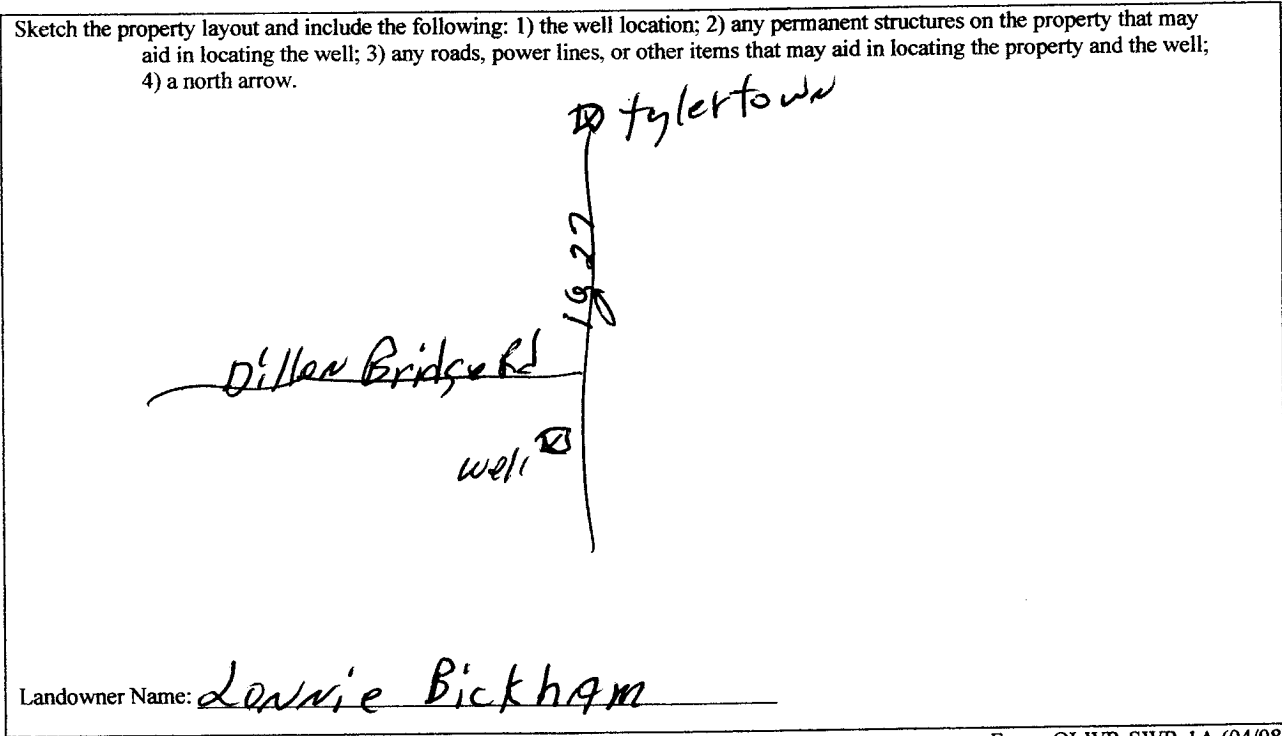

Form: OLWR-SWR-1A (04/08)

I certify that the well/borehole was drilled, constructed, and completed in accordance with all applicable requirements of the Mississippi Department of Environmental Quality and the Mississippi Department of Health regulations, if applicable, and state laws.

Jordan Well Set 0-508 8/15/09
Print Name of Responsible Licensee and License No. Date

[Signature]
Signature of Licensee

RECEIVED
AUG 12 2009
BY: OLWR

STATE WELL REPORT

Part 2

Pump Installer's Completion Report
 Mississippi Department of Environmental Quality
 Office of Land and Water Resources
 P.O. Box 2309
 Jackson, MS 39225
 (601)961-5210
 (601)961-5228 (fax)

County: Walthall
 Permit #: _____
 Driller: J.C. Sumpall
 Date completed: 8/15/09
Copy information from block on Part 1

For Office Use Only:

Aquifer: _____
 Well #: H129
 Elevation: _____

This part of the report must be completed by a licensed water well contractor or a licensed pump installer. A copy of Part 1 of the report must be attached and both parts filed with the Department at the above address within 30 days of well completion.

Well Owner Information	Well Location
Owner Name: <u>Lonnie Bickham</u>	Latitude: <u>31-01-20</u> Longitude: <u>90-11-18</u>
Mailing Address: <u>745 Hwy 275</u> <u>Tyler Town, MS</u>	Method of Lat/Long (check one): Conventional Survey _____ USGS quad _____, Hand-held GPS _____, Survey-grade GPS _____ <u>NW 1/4 SW 1/4 Sec 27 T 1 R 10E</u>
City _____ State _____ Zip Code _____	Distance _____ Direction _____ Nearest Town _____
Telephone No. (____) _____	_____ Miles _____ of _____

Pump Type Circle one	Power Type Circle one
Air Lift _____ Jet _____ <u>Submersible</u>	Diesel Engine _____ Gasoline Engine _____ Natural Gas _____
Bucket _____ Piston _____ Turbine _____	<u>Electric Motor</u> _____ Hand _____ Tractor PTO _____
Centrifugal _____ Rotary _____ Flowing Well _____	Windmill _____ Other (specify): _____
Other (specify): _____	Horse Power Rating of Motor: <u>1/2</u>
Date Pump Installed: <u>8/15/09</u>	Setting Depth: <u>50</u> feet
Rated Pump Capacity: _____ Gallons Per Minute	Number of Stages: <u>8</u>

Pump Test Data	Method of Measuring Water Level Circle one
Date Well Tested: <u>8/15/09</u>	Air Line _____ Electric Measuring Line _____ <u>Steel Tape</u>
Static Water Level (A): <u>12</u> Feet Below Land Surface	Other (specify): _____
Pumping Water Level (B): _____ Feet Below Land Surface	For flowing well, measured shut in head: _____ feet
Drawdown [(B) - (A)]: _____ Feet Below Land Surface	Well yielded <u>10</u> GPM with a drawdown of _____ feet after <u>4</u> hours of pumping
Test Pumping Rate: <u>10</u> Gallons Per Minute	
Duration of Pump Test (minimum 4 hours): <u>4</u> hours	

I HEREBY CERTIFY that the above statements are true to the best of my knowledge.

Jordan Well Ser 0-508 _____
 Print Name of Pump Installer and License No. (if applicable) Signature of Pump Installer

Form: OLWR-SWR-1B(04/08)

RECEIVED

AUG 12 2009

BY: OLWR