

# State Well Report

## Part 1 - Driller's Log

Mississippi Department of Environmental Quality  
Office of Land and Water Resources  
P.O. Box 10631  
Jackson, MS 39289-0631  
(601)961-5210  
(601)354-6938 (fax)

County: Waltham  
Permit #: \_\_\_\_\_  
Driller: Fitzgerald Well Serv.  
Date drilling completed: 12-6-07

For Office Use Only:  
Aquifer: \_\_\_\_\_  
Well #: F-114  
L. S. Elevation: \_\_\_\_\_  
E-log #: \_\_\_\_\_

State Law requires that this report be prepared by the license holder responsible for the work and filed with the Department at the above address within 30 days of completion of drilling of the well or borehole.

Information on Well Owner (Landowner if borehole is not for a water well)	Well or Borehole Location
Owner Name: <u>Joe Ellezy</u>	Latitude: <u>31° 7' 47.2"</u> Longitude: <u>90° 4' 8.9"</u>
Mailing Address: <u>Ellezy Rd</u> <u>Sidney</u>	Method of Lat/Long (circle one): <u>Conventional Survey</u>
<u>Tylertown MS</u> City State Zip Code	USGS quad, Hand-held GPS, Survey-grade GPS <u>NE 1/4 NW 1/4 Sec 23 Twn 2N Rng 11E</u>
Telephone No. ( ) _____	Distance _____ Miles Direction _____ of Nearest Town _____

**Well / Borehole Data**

Date drilling started: 12-6-07 Date drilling completed: 12-6-07 Hole depth: 107' Hole diameter: 7"

Location of the source of any surface water used for drilling: \_\_\_\_\_  
Method of dosing and volume of Chlorine used in drilling and development: \_\_\_\_\_

Logs run (circle all applicable): No log run Electric Gamma Ray Density Sonic Neutron Other: \_\_\_\_\_  
Name of organization running log(s): \_\_\_\_\_

Purpose of borehole (check one): Water Well  Geotechnical/Geological Investigation \_\_\_\_\_ Ground Source Heat Pump \_\_\_\_\_  
Seismic Survey \_\_\_\_\_ Other (describe) \_\_\_\_\_

*If drilling is not related to water well construction, strike the remainder of this block*

Purpose of Well (check one): Home  Industrial \_\_\_\_\_ Public Supply \_\_\_\_\_ Irrigation \_\_\_\_\_ Fish Culture \_\_\_\_\_ Other: \_\_\_\_\_

If a flowing well, method of flow regulation: Valve \_\_\_\_\_ Other (describe) \_\_\_\_\_

Static Water Level: 68' feet above or below (circle one) land surface Date measured: 12-6-07

Method of Measurement (circle one) steel tape electric tape air line other: \_\_\_\_\_

Well depth: 107' Well grouted to a depth of 10' feet Type of grout (circle one): Neat Cement Bentonite Mix

Casing length: 97' feet Casing diameter: 4" inches Type of casing: PVC

Screen length: 10' feet Screen diameter: 4" inches Type of screen: PVC

Screen slot size: 012 inches Setting depth: From 97' feet to 107' feet

Type of completion (circle all applicable): Gravel packed Underreamed Telescoped Open hole Natural Development  
Other (describe): \_\_\_\_\_

Top of lap pipe or reduction in casing: \_\_\_\_\_ feet. *If telescoped or more than one screen, describe on next page*

Form: OLWR-SWR-1A

RECEIVED  
JAN 02 2008  
BY: OLWR

F-114

The sketch below only required for water wells.

If well telescopes, show depths on sketch.

Ground Level          

Description of formations encountered must be provided for all wells and boreholes, unless specifically exempted by regulations.

Description of Formations Encountered	From (depth)	To (depth)
	Ground Level	
Clay	0	20
Sand	20	60
Gravel	60	90
Coarse Sand	90	107

If more than one screen, show location of each on sketch

Sketch the property layout and include the following: 1) the well location; 2) any permanent structures on the property that may aid in locating the well; 3) any roads, power lines, or other items that may aid in locating the property and the well; 4) a north arrow.

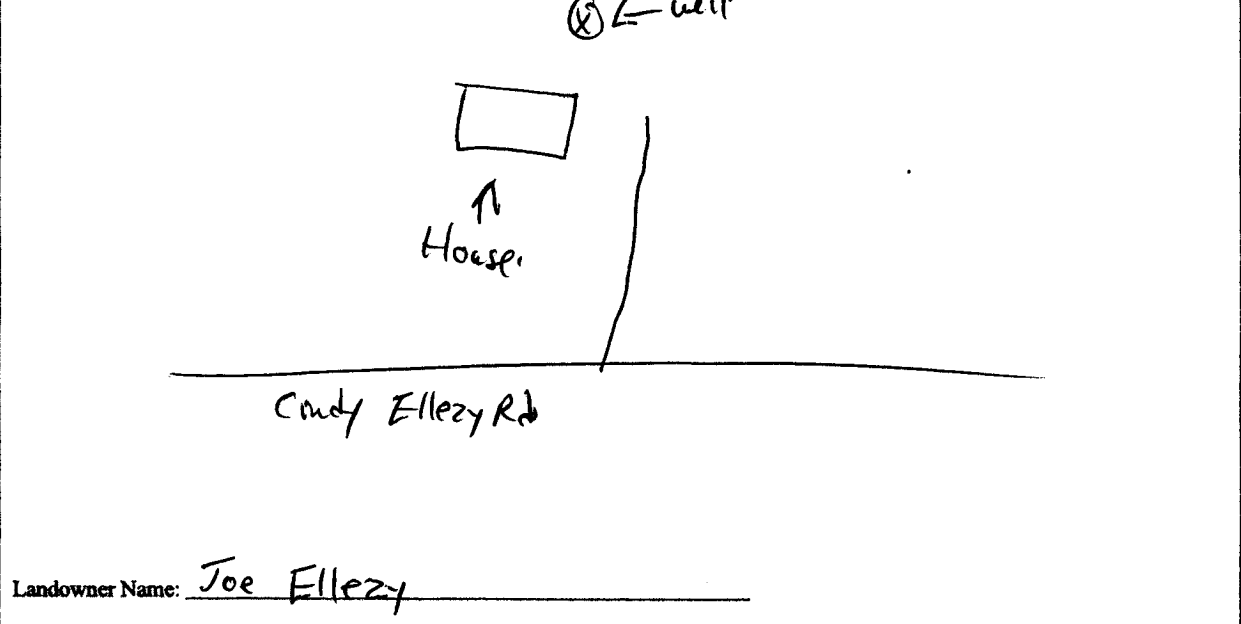

Landowner Name: Joe Ellezy

Form: OLWR-SWR-1A

I certify that the well/borehole was drilled, constructed, and completed in accordance with all applicable requirements of the Mississippi Department of Environmental Quality and the Mississippi Department of Health regulations, if applicable, and state laws.

RECEIVED

Brad Fitzgerald 029 12-6-02

Red Spaul  
Signature of Licensee

JAN 02 2008

BY: OLWR

# STATE WELL REPORT

## Part 2

**Pump Installer's Completion Report**  
 Mississippi Department of Environmental Quality  
 Office of Land and Water Resources  
 P.O. Box 10631  
 Jackson, MS 39289-0631  
 (601)961-5210  
 (601)354-6938 (fax)

County: Waltham  
 Permit #: \_\_\_\_\_  
 Driller: Fitzgerald Well Service  
 Date completed: 12-6-07  
*Copy information from block on Part 1*

**For Office Use Only:**

Aquifer: \_\_\_\_\_  
 Well #: F-114  
 Elevation: \_\_\_\_\_

*This part of the report must be completed by a licensed water well contractor or a licensed pump installer. A copy of Part 1 of the report must be attached and both parts filed with the Department at the above address within 30 days of well completion.*

Well Owner Information	Well Location
Owner Name: <u>Joe Ellezy</u>	Latitude: <u>31° 7' 47.2"</u> Longitude: <u>90° 4' 8.9"</u>
Mailing Address: <u>Cindy Ellezy Rd.</u>	Method of Lat/Long (check one): Conventional Survey _____
<u>Tylertown MS</u>	USGS quad _____ Hand-held GPS _____ Survey-grade GPS _____
City State Zip Code	_____ 1/4 _____ 1/4 Sec _____ T _____ R _____
Telephone No. (____) _____	Distance Direction Nearest Town
	_____ Miles _____ of _____

Pump Type Circle one	Power Type Circle one
Air Lift Jet <input checked="" type="radio"/> <del>Submersible</del>	Diesel Engine Gasoline Engine Natural Gas
Bucket Piston Turbine	<input checked="" type="radio"/> <del>Electric Motor</del> Hand Tractor PTO
Centrifugal Rotary Flowing Well	Windmill Other (specify): _____
Other (specify): _____	Horse Power Rating of Motor: <u>1/2</u>
Date Pump Installed: <u>12-6-07</u>	Setting Depth: <u>100'</u> feet
Rated Pump Capacity: <u>12</u> Gallons Per Minute	Number of Stages: <u>8</u>

Pump Test Data	Method of Measuring Water Level Circle one
Date Well Tested: _____	Air Line Electric Measuring Line <input checked="" type="radio"/> <del>Steel Tape</del>
Static Water Level (A): _____ Feet Below Land Surface	Other (specify): _____
Pumping Water Level (B): _____ Feet Below Land Surface	For flowing well, measured shut in head: _____ feet
Drawdown [(B) - (A)]: _____ Feet Below Land Surface	Well yielded _____ GPM with a drawdown of
Test Pumping Rate: _____ Gallons Per Minute	_____ feet after _____ hours of pumping
Duration of Pump Test (minimum 4 hours): _____ hours	

I HEREBY CERTIFY that the above statements are true to the best of my knowledge.

Brad Fitzgerald 029 Brad Fitzgerald  
 Print Name of Pump Installer and License No. (if applicable) Signature of Pump Installer

**RECEIVED**

JAN 02 2008

BY: OLWF