

County: Walthall
 Permit #: 0-586
 Driller: JAMES WELLS
 Date drilling completed: 7-22-09

State Well Report
Part 1 - Driller's Log
 Mississippi Department of Environmental Quality
 Office of Land and Water Resources
 P.O. Box 2309
 Jackson, MS 39225
 (601)961- 5210
 (601)961- 5228 (fax)

For Office Use Only:

Aquifer: _____
 Well #: D 119
 L. S. Elevation: _____
 E-log #: _____

State Law requires that this report be prepared by the license holder responsible for the work and filed with the Department at the above address within 30 days of completion of drilling of the well or borehole.

<p align="center">Information on Well Owner (Landowner if borehole is not for a water well)</p> <p>Owner Name: <u>Eloy Lemus</u> Mailing Address: <u>178 Dinan Solon Rd</u> <u>Tylertown MS #</u> <u>39467</u> City State Zip Code Telephone No. (<u>601</u>) <u>303 02 05</u></p>	<p align="center">Well or Borehole Location</p> <p>Latitude: <u>31° 13' 59"</u> Longitude: <u>90° 07' 57"</u> Method of Lat/Long (circle one): Conventional Survey, USGS quad, Hand-held GPS, Survey-grade GPS <u>NW 1/4 NE 1/4 Sec 7</u> Twn <u>3N</u> Rng <u>11E</u> <u>18</u> Distance Direction Nearest Town _____ Miles _____ of _____</p>
---	--

Well / Borehole Data

Date drilling started: 7-22-09 Date drilling completed: 7-22-09 Hole depth: 120 Hole diameter: 7
 Location of the source of any surface water used for drilling: Creek
 Method of dosing and volume of Chlorine used in drilling and development: 3 lbs Shock
 Logs run (circle all applicable): No log run Electric Gamma Ray Density Sonic Neutron Other: _____
 Name of organization running log(s): _____
 Purpose of borehole (check one): Water Well Geotechnical/Geological Investigation _____ Ground Source Heat Pump _____
 Seismic Survey _____ Other (describe) _____
If drilling is not related to water well construction, skip the remainder of this block
 Purpose of Well (check one): Home Industrial _____ Public Supply _____ Irrigation _____ Fish Culture _____ Other: _____
 If a flowing well, method of flow regulation: Valve _____ Other (describe) _____
 Static Water Level: 46 feet above or below (circle one) land surface Date measured: 7-22-09
 Method of Measurement (circle one) steel tape electric tape air line other: _____
 Well depth: 120 Well grouted to a depth of 10 feet Type of grout (circle one): Neat Cement Bentonite Mix
 Casing length: 100 feet Casing diameter: 4 inches Type of casing: PVC
 Screen length: 20 feet Screen diameter: 4 inches Type of screen: PVC
 Screen slot size: .008 inches Setting depth: From 100 feet to 120 feet
 Type of completion (circle all applicable): Gravel packed Underreamed Telescoped Open hole Natural Development
 Other (describe): _____
 Top of lap pipe or reduction in casing: _____ feet. *If telescoped or more than one screen, describe on next page*

Form: OLWR-SWR-1A (04/08)

RECEIVED
AUG 11 2009
BY: OLWR

The sketch below only required for water wells

If well telescopes, show depths on sketch.

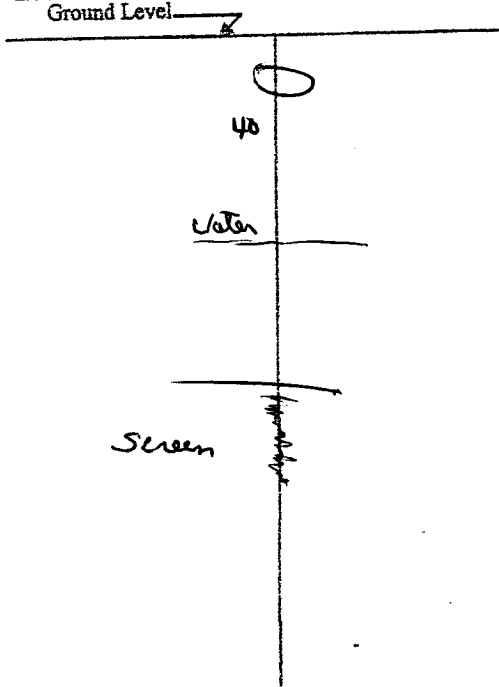

Description of formations encountered must be provided for all wells and boreholes, unless specifically exempted by regulations

Description of Formations Encountered	From (depth)	To (depth)
	Ground Level	2
Clay	2	30
S.S.	30	40
Red mud	40	120

If more than one screen, show location of each on sketch

Sketch the property layout and include the following: 1) the well location; 2) any permanent structures on the property that may aid in locating the well; 3) any roads, power lines, or other items that may aid in locating the property and the well; 4) a north arrow.

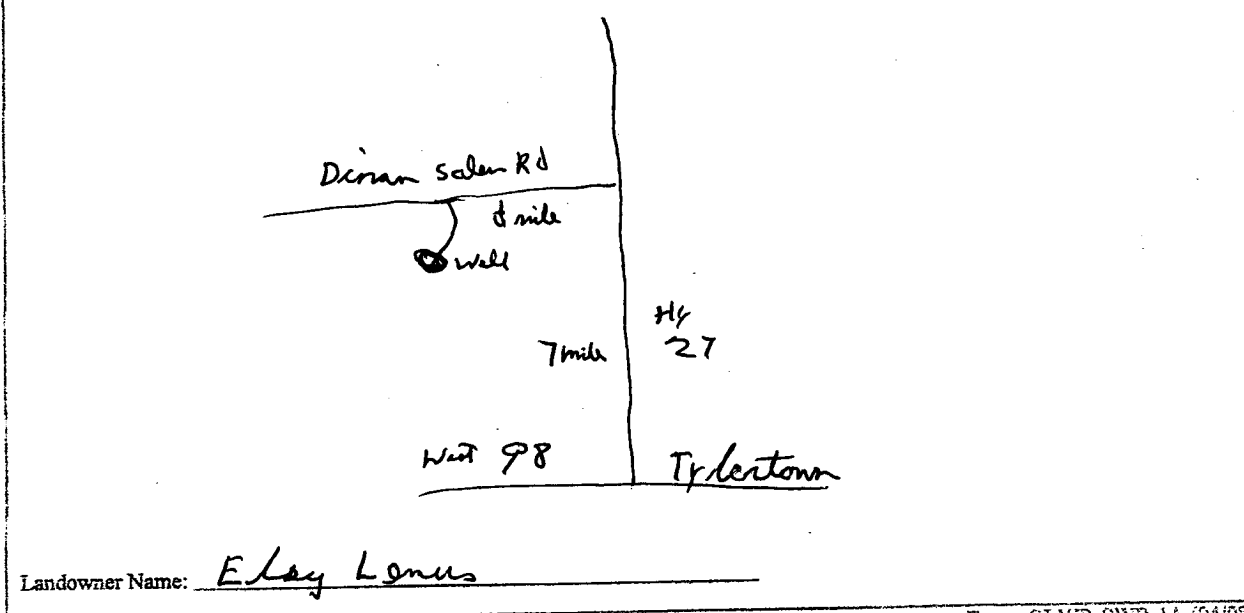

Landowner Name: E. Lay Lonus

Form: OLWR-SWR-1A (04/05)

I certify that the well/borehole was drilled, constructed, and completed in accordance with all applicable requirements of the Mississippi Department of Environmental Quality and the Mississippi Department of Health regulations, if applicable, and state

IBWS. JAMES WELLS 0-586

James Wells
Secretary of Licenses

RECEIVED
AUG 11 2009
BY: OLWF

STATE WELL REPORT

Part 2

Pump Installer's Completion Report
 Mississippi Department of Environmental Quality
 Office of Land and Water Resources
 P.O. Box 2309
 Jackson, MS 39225
 (601)961-5210
 (601)961-5228 (fax)

County: Walworth
 Permit #: _____
 Driller: JAMES WELLS
 Date completed: 7-22-09
Copy information from block on Part 1

For Office Use Only:

Aquifer: _____
 Well #: D119
 Elevation: _____

This part of the report must be completed by a licensed water well contractor or a licensed pump installer. A copy of Part 1 of the report must be attached and both parts filed with the Department at the above address within 30 days of well completion.

Well Owner Information	Well Location
Owner Name: <u>Eloy Lemus</u>	Latitude: <u>31-13-59</u> Longitude: <u>90-07-57</u>
Mailing Address: <u>178 Dinan Salem Rd</u> <u>Tylertown MS</u>	Method of Lat/Long (check one): Conventional Survey _____ USGS quad _____, Hand-held GPS _____, Survey-grade GPS _____
City State Zip Code <u>39667</u>	<u>NW 1/4 NE 1/4 Sec 7 T 34 R 11E</u>
Telephone No. (<u>601</u>) <u>3030205</u>	Distance Direction Nearest Town <u>7 Miles North of Tylertown MS</u>

Pump Type Circle one	Power Type Circle one
Air Lift Jet <input checked="" type="radio"/> <u>Submersible</u>	Diesel Engine Gasoline Engine Natural Gas
Bucket Piston Turbine	<input checked="" type="radio"/> <u>Electric Motor</u> Hand Tractor PTO
Centrifugal Rotary Flowing Well	Windmill Other (specify): _____
Other (specify): _____	Horse Power Rating of Motor: <u>2</u>
Date Pump Installed: <u>7-22-09</u>	Setting Depth: <u>100</u> feet
Rated Pump Capacity: <u>30</u> Gallons Per Minute	Number of Stages: <u>12</u>

Pump Test Data	Method of Measuring Water Level Circle one
Date Well Tested: <u>7-22-09</u>	Air Line Electric Measuring Line <input checked="" type="radio"/> <u>Steel Tape</u>
Static Water Level (A): <u>40</u> Feet Below Land Surface	Other (specify): _____
Pumping Water Level (B): <u>100</u> Feet Below Land Surface	For flowing well, measured shut in head: _____ feet
Drawdown [(B) - (A)]: <u>60</u> Feet Below Land Surface	Well yielded <u>30</u> GPM with a drawdown of
Test Pumping Rate: <u>30</u> Gallons Per Minute	<u>40</u> feet after <u>4</u> hours of pumping
Duration of Pump Test (minimum 4 hours): <u>4</u> hours	

I HEREBY CERTIFY that the above statements are true to the best of my knowledge.

JAMES WELLS 0-586 James Wells
 Print Name of Pump Installer and License No. (if applicable) Signature of Pump Installer

Form: OLWR-SWR-1B (04/08)

RECEIVED
 AUG 11 2009
 BY: OLWR