

County: Walthall
 Permit #: 0-586
 Driller: JAMES WELLS
 Date drilling completed: 9-20-12

State Well Report
Part 1 - Driller's Log
 Mississippi Department of Environmental Quality
 Office of Land and Water Resources
 P.O. Box 2309
 Jackson, MS 39225
 (601)961- 5210
 (601)961- 5228 (fax)

For Office Use Only:
 Aquifer: _____
 Well #: C159
 L. S. Elevation: _____
 E-log #: _____

State Law requires that this report be prepared by the license holder responsible for the work and filed with the Department at the above address within 30 days of completion of drilling of the well or borehole.

Information on Well Owner (Landowner if borehole is not for a water well)	Well or Borehole Location
Owner Name: <u>Michael Brown</u>	Latitude: <u>31° 11' 672"</u> Longitude: <u>90° 11' 964"</u>
Mailing Address: <u>910 Oak Grove Rd</u> <u>Tylertown, MS</u>	Method of Lat/Long (circle one): Conventional Survey, <u>40</u> <u>58</u>
City: _____ State: _____ Zip Code: <u>39667</u>	USGS quad, Hand-held GPS, Survey-grade GPS <input checked="" type="checkbox"/>
Telephone No. (<u>601</u>) <u>8769309</u>	NW ¼ SE ¼ Sec <u>28</u> Twn <u>30</u> Rng <u>10E</u>
	Distance _____ Miles Direction <u>South</u> of Nearest Town <u>Tylertown</u>

Well / Borehole Data

Date drilling started: 9-20-12 Date drilling completed: 9-20-12 Hole depth: 160 Hole diameter: 7

Location of the source of any surface water used for drilling: creek

Method of dosing and volume of Chlorine used in drilling and development: Shank 200

Logs run (circle all applicable): No log run Electric Gamma Ray Density Sonic Neutron Other: _____

Name of organization running log(s): _____

Purpose of borehole (check one): Water Well Geotechnical/Geological Investigation Ground Source Heat Pump

Seismic Survey Other (describe) _____

If drilling is not related to water well construction, skip the remainder of this block

Purpose of Well (check one): Home Industrial Public Supply Irrigation Fish Culture Other: _____

If a flowing well, method of flow regulation: Valve _____ Other (describe) _____

Static Water Level: 90 feet above or below (circle one) land surface Date measured: 9-20-12

Method of Measurement (circle one) steel tape electric tape air line other: _____

Well depth: 160 Well grouted to a depth of 10 feet Type of grout (circle one): Neat Cement Bentonite Mix

Casing length: 140 feet Casing diameter: 4 inches Type of casing: PVC

Screen length: 20 feet Screen diameter: 4 inches Type of screen: PVC

Screen slot size: .008 inches Setting depth: From 140 feet to 160 feet

Type of completion (circle all applicable): Gravel packed Underreamed Telescoped Open hole Natural Development

Other (describe): _____

Top of lap pipe or reduction in casing: _____ feet. *If telescoped or more than one screen, describe on next page*

Form: OLWR-SWR-1A (04/08)

RECEIVED
 JAN 14 2013
 BY: OLWR

The sketch below only required for water wells

If well telescopes, show depths on sketch.

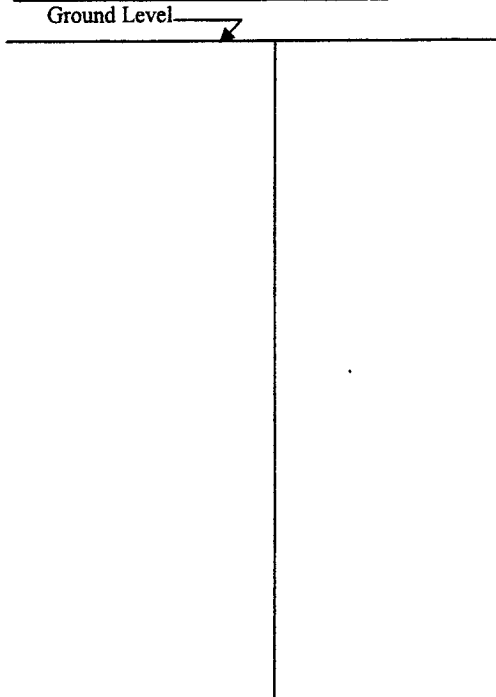

Description of formations encountered must be provided for all wells and boreholes, unless specifically exempted by regulations

Description of Formations Encountered	From (depth)	To (depth)
	Ground Level	0
Clay	2	80
Sand	80	120
Peat gravel	120	160

If more than one screen, show location of each on sketch

Sketch the property layout and include the following: 1) the well location; 2) any permanent structures on the property that may aid in locating the well; 3) any roads, power lines, or other items that may aid in locating the property and the well; 4) a north arrow.

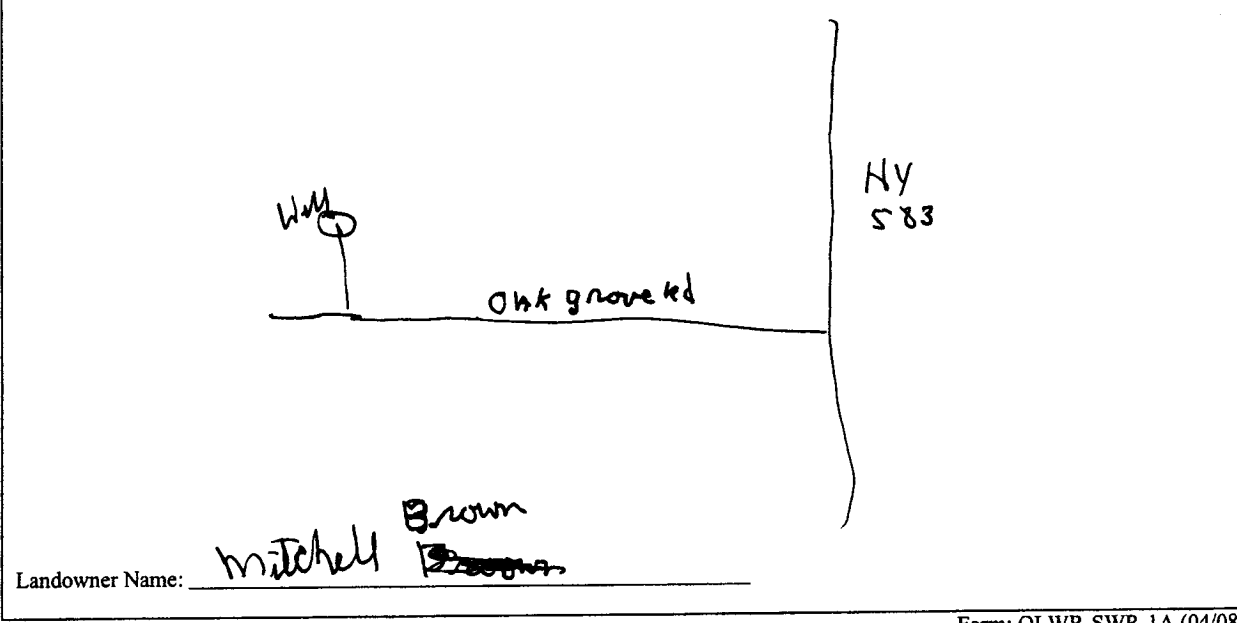

Landowner Name: Mitchell Brown

Form: OLWR-SWR-1A (04/08)

I certify that the well/borehole was drilled, constructed, and completed in accordance with all applicable requirements of the Mississippi Department of Environmental Quality and the Mississippi Department of Health regulations, if applicable, and state laws.

JAMES WELLS 0-586
 Print Name of Responsible Licensee and License No. Date

James Wells
 Signature of Licensee

RECEIVED
 JAN 14 2013
 BY: OLWR

STATE WELL REPORT

Part 2

Pump Installer's Completion Report
 Mississippi Department of Environmental Quality
 Office of Land and Water Resources
 P.O. Box 10631
 Jackson, MS 39289-0631
 (601)961-5210
 (601)354-6938 (fax)

For Office Use Only:

Aquifer: _____

Well #: C159

Elevation: _____

County: Waltham
 Permit #: _____
 Driller: JAMES WELLS
 Date completed: 9-20-12

This report should be prepared by the pump installer in detail and filed with the Department within 30 days of the installation of pump.

Well Owner Information	Well Location
Owner Name: <u>Mitchell Brown</u> Mailing Address: <u>91 Oak Grove Rd</u> <u>Tylertown Ms</u> <u>39667</u> City State Zip Code Telephone No. (<u>601</u>) <u>876 9309</u>	Latitude: <u>31.11.672</u> Longitude: <u>090.11.964</u> Method of Lat/Long (circle one): Conventional Survey, USGS quad, Hand-held GPS, Survey-grade GPS <u>NW 1/4 SE 1/4 Sec 28 Twn 37 Rng 10E</u> Distance Direction Nearest Town <u>6 Miles North of Tylertown</u>

Pump Type Circle one	Power Type Circle one
Air Lift Jet <u>Submersible</u> Bucket Piston Turbine Centrifugal Rotary Flowing Well Other (specify): _____ Date Pump Installed: <u>9-20-12</u> Rated Pump Capacity: <u>15</u> Gallons Per Minute	Diesel Engine Gasoline Engine Natural Gas <u>Electric Motor</u> Hand Tractor PTO Windmill Other (specify): _____ Horse Power Rating of Motor: <u>1 HP</u> Setting Depth: <u>136</u> feet Number of Stages: <u>14</u>

Pump Test Data	Method of Measuring Water Level Circle one
Date Well Tested: <u>9-20-12</u> Static Water Level (A): <u>90</u> Feet Below Land Surface Pumping Water Level (B): <u>130</u> Feet Below Land Surface Drawdown [(B) - (A)]: <u>40</u> Feet Below Land Surface Test Pumping Rate: <u>15</u> Gallons Per Minute Duration of Pump Test (minimum 4 hours): <u>4</u> hours	Air Line Electric Measuring Line Steel Tape Other (specify): _____ For flowing well, measured shut in head: _____ feet Well yielded <u>15</u> GPM with a drawdown of <u>40</u> feet after <u>160</u> hours of pumping

I HEREBY CERTIFY that the above statements are true to the best of my knowledge.

JAMES WELLS 0-586
 Print Name of Pump Installer and License No. (if applicable)

James Wells
 Signature of Pump Installer

RECEIVED

JAN 14 2013

BY: OLWR