

State Well Report

Part 1 - Driller's Log

Mississippi Department of Environmental Quality
Office of Land and Water Resources
P.O. Box 2309
Jackson, MS 39225
(601)961-5210
(601)961-5228 (fax)

County: Waltham
Permit #: _____
Driller: ~~John~~ Fitzgerald well
Date drilling completed: 1-31-12

For Office Use Only:
Aquifer: A155
Well #: _____
L. S. Elevation: _____
E-log #: _____

State Law requires that this report be prepared by the license holder responsible for the work and filed with the Department at the above address within 30 days of completion of drilling of the well or borehole.

Information on Well Owner (Landowner if borehole is not for a water well)	Well or Borehole Location
Owner Name: <u>Jason Faulk</u>	Latitude: <u>31° 20' 48"</u> Longitude: <u>90° 15' 9.8"</u>
Mailing Address: <u>Ham Rd.</u>	Method of Lat/Long (circle one): <u>48</u> Conventional Survey, <u>10</u>
<u>Tylertown MS</u>	USGS quad, Hand-held GPS, Survey-grade GPS <input checked="" type="checkbox"/>
City State Zip Code	<u>SE</u> <u>1/4</u> <u>NW</u> <u>1/4</u> Sec. <u>1</u> Twn <u>4N</u> Rng <u>9E</u>
Telephone No. ()	Distance Direction Nearest Town Miles of

Well / Borehole Data

Date drilling started: 1-31-12 Date drilling completed: 1-31-12 Hole depth: 140' Hole diameter: 8"

Location of the source of any surface water used for drilling: _____
Method of dosing and volume of Chlorine used in drilling and development: _____

Logs run (circle all applicable): No log run Electric Gamma Ray Density Sonic Neutron Other: _____
Name of organization running log(s): _____

Purpose of borehole (check one): Water Well Geotechnical/Geological Investigation _____ Ground Source Heat Pump _____
Seismic Survey _____ Other (describe) _____

If drilling is not related to water well construction, skip the remainder of this block

Purpose of Well (check one): Home Industrial _____ Public Supply _____ Irrigation _____ Fish Culture _____ Other: _____

If a flowing well, method of flow regulation: Valve _____ Other (describe) _____

Static Water Level: 90' feet above or below (circle one) land surface Date measured: 1-31-12

Method of Measurement (circle one) steel tape electric tape air line other: _____

Well depth: 140' Well grouted to a depth of 10' feet Type of grout (circle one): Neft Cement Bentonite Mix

Casing length: 130' feet Casing diameter: 4" inches Type of casing: Pvc

Screen length: 10' feet Screen diameter: 4" inches Type of screen: Pvc

Screen slot size: .012 inches Setting depth: From 130' feet to 140' feet

Type of completion (circle all applicable): Gravel packed Underreamed Telescoped Open hole Natural Development
Other (describe): _____

Top of lap pipe or reduction in casing: _____ feet. *If telescoped or more than one screen, describe on next page*

Form: OLWR-SWR-1A (04/08)

RECEIVED

FEB 29 2012

BY: OLWR

The sketch below only required for water wells.

If well screens, show depths on sketch.

Ground Level \rightarrow

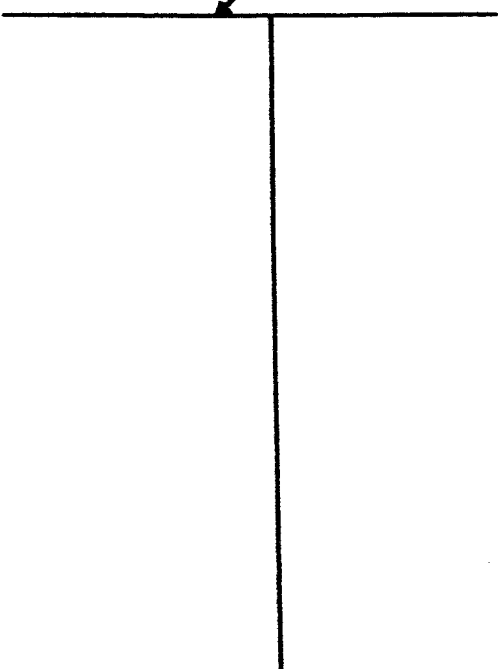

Description of formations encountered must be provided for all wells and boreholes, unless specifically exempted by regulation.

Description of Formations Encountered	From (depth)	To (depth)
	Ground Level	
Clay	0	20
Clay	20	40
Gravel	40	70
sand	70	100
Clay	100	120
Sand	120	130
Coarse Sand	130	140

If more than one screen, show location of each on sketch

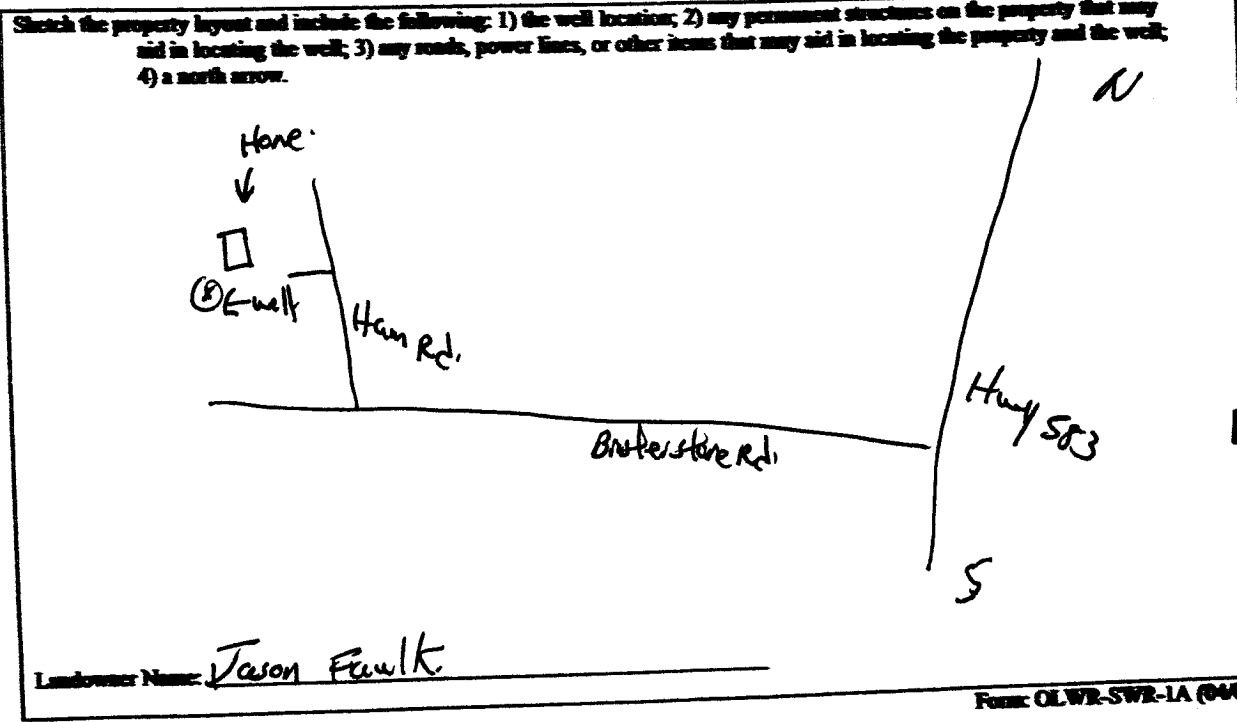

RECEIVED
FEB 29 2012
BY: OLWR

I certify that the well/borehole was drilled, constructed, and completed in accordance with all applicable requirements of the Mississippi Department of Environmental Quality and the Mississippi Department of Health regulations, if applicable, and state

Print Name of Responsible Licensee and License No. Brad Fitzgerald 029 Date 1-31-12 Signature of Licensee [Signature]

STATE WELL REPORT

Part 2

Pump Installer's Completion Report
Mississippi Department of Environmental Quality
Office of Land and Water Resources
P.O. Box 2309
Jackson, MS 39225
(601)961-5210
(601)961-5228 (fax)

For Office Use Only:

Aquifer: _____
Well #: A155
Elevation: _____

County: Waltham
Permit #: _____
Driller: Fitzgerald Well Serv.
Date completed: 1-31-12
Copy information from block on Part 1

This part of the report must be completed by a licensed water well contractor or a licensed pump installer. A copy of Part 1 of the report must be attached and both parts filed with the Department at the above address within 30 days of well completion.

Well Owner Information	Well Location
Owner Name: <u>Jason Faulk</u>	Latitude: <u>31° 20' 48"</u> Longitude: <u>90° 15' 8.8"</u>
Mailing Address: <u>Hum Rd.</u>	Method of Lat/Long (check one): Conventional Survey _____
<u>Tylertown MS</u>	USGS quad _____ Hand-held GPS _____ Survey-grade GPS _____
City State Zip Code	_____ 1/4 _____ 1/4 Sec <u>11</u> T <u>4N</u> R <u>9E</u>
Telephone No. () _____	Distance _____ Direction _____ Nearest Town _____
	Miles _____ of _____

Pump Type Circle one	Power Type Circle one
Air Lift <input type="checkbox"/> Jet <input type="checkbox"/> Submersible <input checked="" type="checkbox"/>	Diesel Engine <input type="checkbox"/> Gasoline Engine <input type="checkbox"/> Natural Gas <input type="checkbox"/>
Bucket <input type="checkbox"/> Piston <input type="checkbox"/> Turbine <input type="checkbox"/>	Electric Motor <input checked="" type="checkbox"/> Hand <input type="checkbox"/> Tractor PTO <input type="checkbox"/>
Centrifugal <input type="checkbox"/> Rotary <input type="checkbox"/> Flowing Well <input type="checkbox"/>	Windmill <input type="checkbox"/> Other (specify): _____
Other (specify): _____	Horse Power Rating of Motor: <u>1/2</u>
Date Pump Installed: <u>1-31-12</u>	Setting Depth: <u>110'</u> feet
Rated Pump Capacity: <u>12</u> Gallons Per Minute	Number of Stages: <u>8</u>

Pump Test Data	Method of Measuring Water Level Circle one
Date Well Tested: _____	Air Line <input type="checkbox"/> Electric Measuring Line <input type="checkbox"/> Steel Tape <input checked="" type="checkbox"/>
Static Water Level (A): _____ Feet Below Land Surface	Other (specify): _____
Pumping Water Level (B): _____ Feet Below Land Surface	For flowing well, measured shut in head: _____ feet
Drawdown [(B) - (A)]: _____ Feet Below Land Surface	Well yielded _____ GPM with a drawdown of _____
Test Pumping Rate: _____ Gallons Per Minute	_____ feet after _____ hours of pumping
Duration of Pump Test (minimum 4 hours): _____ hours	

This is for (circle one): **New Well** Replacement of Existing Pump Repair of Existing Pump

I HEREBY CERTIFY that the above statements are true to the best of my knowledge.
Brad Fitzgerald 029 Balford
Print Name of Pump Installer and License No. (if applicable) Signature of Pump Installer
Form: OLWR-SWR-1C (07-09)

RECEIVED
FEB 29 2012
BY: OLWR