

State Well Report

Part I

Mississippi Department of Environmental Quality
Office of Land and Water Resources
P.O. Box 10631
Jackson, MS 39289-0631
(601)961-5210
(601)354-6938 (fax)

For Office Use Only:

Aquifer: _____
Well #: M-22
L. S. Elevation: _____
E-log #: _____

County: Tunica
Permit #: 0043071
Driller: Delta Drilling of Tunica Inc.
Date drilling completed: 3-23-09

State Law requires that this report be prepared by the driller in detail and filed with the Department within 30 days of completion of drilling of the well.

Well Owner Information	Well Location
Owner Name: <u>Roger Johnson</u>	Latitude: <u>N34° 28' 29.7"</u> Longitude: <u>90° 27' 35.6"</u>
Mailing Address: <u>40 Will Owen</u> <u>1100 Evansville Cove</u>	Method of Lat/Long (circle one): <u>29</u> Conventional Survey, <u>36</u>
City: <u>Tunica</u> State: <u>Ms.</u> Zip Code: <u>38676</u>	USGS quad, <u>Hand-held GPS</u> Survey-grade GPS
Telephone No.: <u>(662) 363-6182</u>	SW <u>1/4</u> Sec <u>16</u> Twn <u>7S</u> Rng <u>12W</u>
	Distance <u>NW</u> Direction <u>15</u> Nearest Town <u>Lula, Ms.</u>
	<u>3</u> Miles <u>North</u> of _____

Well Data

Purpose of Well (circle one) Home Industrial Public Supply Irrigation Fish Culture Other: _____

Date well drilling started: 3-23-09 Date well drilling completed: 3-23-09

If flowing, method of flow regulation: Valve _____ Other (describe) _____

Static Water Level: 28 feet above below (circle one) land surface Date measured: 3-24-09

Method of Measurement (circle one) steel tape electric tape air line other: _____

Hole depth: 118' Well depth: 118' Well grouted to a depth of 10 feet

Type of grout (circle one): Cement Bentonite Mix

Casing length: 78 feet Casing diameter: 16 inches Type of casing: PVC

Screen length: 40 feet Screen diameter: 16 inches Type of screen: PVC

Screen slot size: .032 inches Setting depth: From 78 feet to 118 feet

Type of completion (circle all applicable): Gravel packed Underreamed Telescoped Open hole Natural Development

Other (describe): _____

Top of lap pipe or reduction in casing: _____ feet. If telescoped or more than one screen, describe on back of page

Logs run (circle all applicable): No log run Electric Gamma Ray Density Sonic Neutron Other: _____

Name of organization running log(s): _____

I certify that the well was drilled, constructed, and completed in accordance with all applicable requirements of the Mississippi Department of Environmental Quality and/or the Mississippi Department of Health regulations and state laws.

Delta Drilling of Tunica Inc. # 0674 _____
Print Name of Water Well Contractor and License No. Signature of Water Well Contractor

RECEIVED
MAR 27 2009
BY: OLWR

STATE WELL REPORT

Part 2

Pump Installer's Completion Report
 Mississippi Department of Environmental Quality
 Office of Land and Water Resources
 P.O. Box 10631
 Jackson, MS 39219-0631
 (601)961-5210
 (601)934-6938 (fax)

For Office Use Only:

Acquifer: _____

Well #: M-22

Elevation: _____

County: Tunica
 Permit #: OW43071
 Driller: Delta Drilling of Tunica Inc.
 Date completed: 3-24-09

This report should be prepared by the pump installer in detail and filed with the Department within 30 days of the installation of pump.

Well Owner Information	Well Location
Owner Name: <u>Roger Johnson</u>	Latitude: <u>N34° 28' 28.7"</u> Longitude: <u>90° 27' 35.6"</u>
Mailing Address: <u>c/o Will Owen</u>	Method of Lat/Long (circle one): <u>Conventional Survey</u>
<u>1100 Evansville Cove</u>	USGS quad: <u>Hand-held GPS</u> Survey-grade GPS
<u>Tunica Ms. 38676</u>	<u>SW 1/4 SW 1/4 Sec 16 Twn 7S Rng 12W</u>
City State Zip Code	Distance Direction Nearest Town
Telephone No. <u>(662) 363-6192</u>	<u>3 miles North of Lula, Ms.</u>

Pump Type Circle one	Power Type Circle one
Air Lift <input type="checkbox"/> Jet <input type="checkbox"/> Submersible <input type="checkbox"/>	<u>Diesel Engine</u> Gasoline Engine Horizontal Gas
Bucket <input type="checkbox"/> Piston <input type="checkbox"/> <u>Turbine</u>	Electric Motor Hand Tractor PTO
Centrifugal <input type="checkbox"/> Rotary <input type="checkbox"/> Flowing Well <input type="checkbox"/>	Windmill Other (specify): _____
Other (specify): _____	Motor Power Rating of Motor: <u>125</u>
Date Pump Installed: <u>3-24-09</u>	Setting Depth: <u>50</u> feet
Rated Pump Capacity: <u>3000</u> Gallons Per Minute	Number of Stages: <u>1</u>

Pump Test Data	Method of Measuring Water Level Circle one
Date Well Tested: _____	Air Line <input type="checkbox"/> Electric Measuring Line <input type="checkbox"/> <u>Steel Tape</u>
Static Water Level (A): _____ Feet Below Land Surface	Other (specify): _____
Pumping Water Level (B): _____ Feet Below Land Surface	For flowing well, measured shut in head: _____ feet
Drawdown (B) - (A): _____ Feet Below Land Surface	Well yielded _____ GPM with a drawdown of _____ feet after _____ hours of pumping
Test Pumping Rate: _____ Gallons Per Minute	
Duration of Pump Test (minimum 4 hours): _____ hours	

I HEREBY CERTIFY that the above statements are true to the best of my knowledge.

Delta Drilling of Tunica, # 0674
 Print Name of Pump Installer and License No. (if applicable)

Alan Lyh
 Signature of Pump Installer

RECEIVED
 MAR 27 2009
 BY: OLWR

M-22

6W43071

If well telescopes please sketch below and show depths

Ground Level

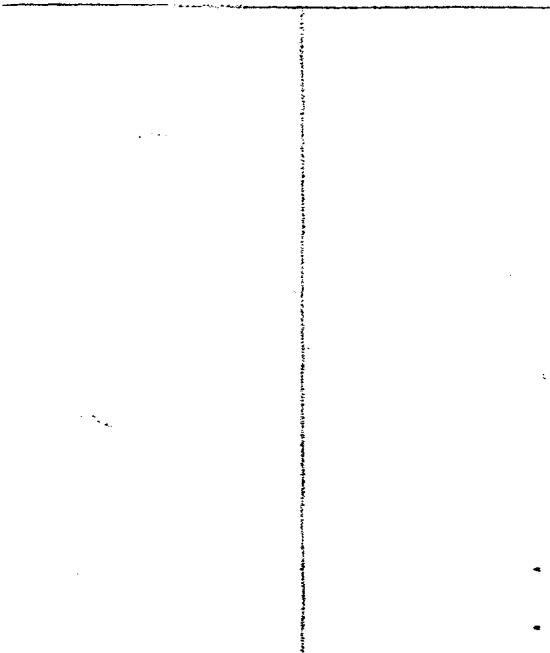

DESCRIPTION OF FORMATIONS ENCOUNTERED	From	To
loamy soil / fine sand	0	21
clay / fine sand	22	71
coarse sand & gravel formation	72	118

If more than one screen show location of each on sketch

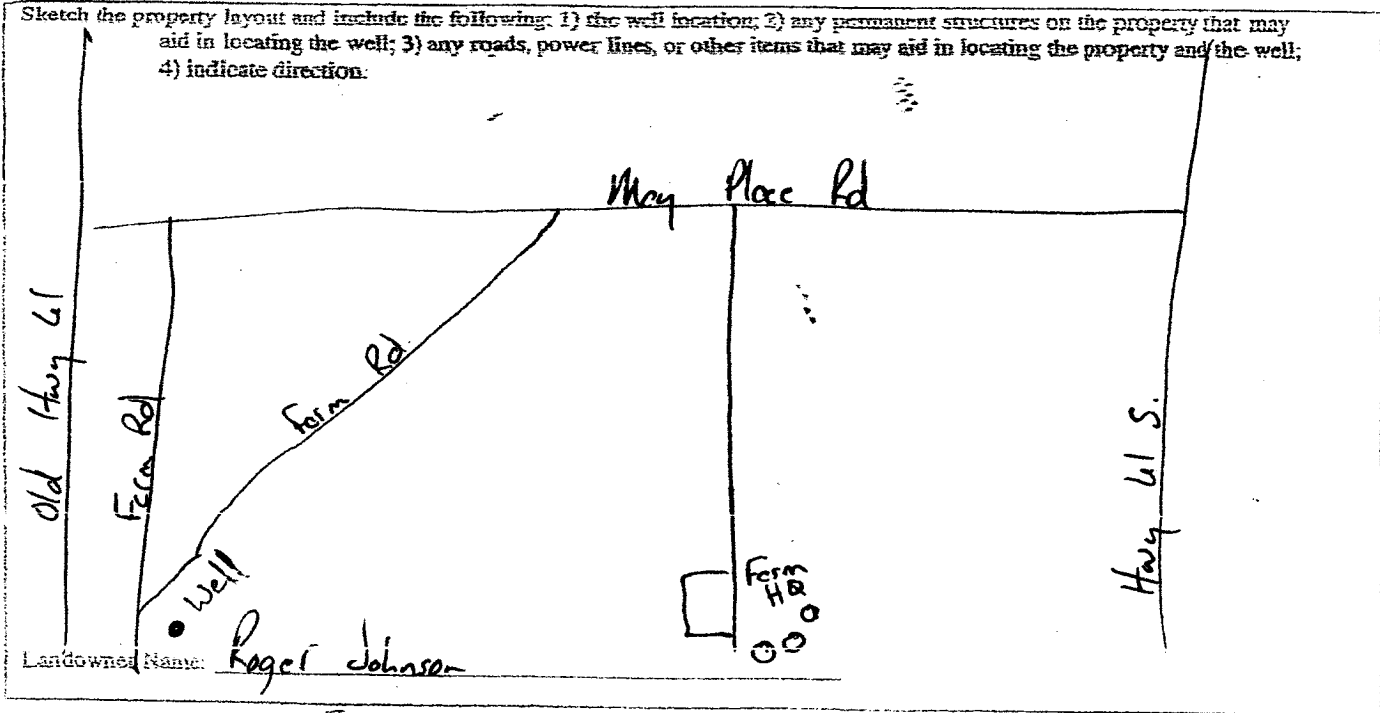

Alan Pugh
Signature of Watch Well Contractor

RECEIVED
MAR 27 2009
BY: OLWR