

# State Well Report

## Part 1

Mississippi Department of Environmental Quality  
 Office of Land and Water Resources  
 P.O. Box 10631  
 Jackson, MS 39289-0631  
 (601)961-5210  
 (601)354-6938 (fax)

For Office Use Only:

Aquifer: \_\_\_\_\_  
 Well #: N-53  
 L. S. Elevation: \_\_\_\_\_  
 E-log #: \_\_\_\_\_

County: TATE  
 Permit #: \_\_\_\_\_  
 Driller: BOB SMITH  
 Date drilling completed: 1-29-07

State Law requires that this report be prepared by the driller in detail and filed with the Department within 30 days of completion of drilling of the well.

Well Owner Information	Well Location
Owner Name: <u>BARRY SWEET</u>	Latitude: _____ Longitude: _____
Mailing Address: <u>107 11</u> <u>PO BOX 0415</u> <u>SENAWA, MS 38668</u> City State Zip Code	Method of Lat/Long (circle one): <input type="radio"/> Conventional Survey <input type="radio"/> USGS quad, Hand-held GPS, Survey-grade GPS
Telephone No. <u>901 828-6763</u>	Distance Direction Nearest Town <u>2</u> Miles <u>W</u> of <u>POCAHONTA</u>

**Well Data**

Purpose of Well (circle one):  Home  Industrial  Public Supply  Irrigation  Fish Culture  Other: \_\_\_\_\_

Date well drilling started: 1-29-07 Date well drilling completed: 1-29-07

If flowing, method of flow regulation: Valve \_\_\_\_\_ Other (describe) \_\_\_\_\_

Static Water Level: 60 feet above or below (circle one) land surface Date measured: 1-29-07

Method of Measurement (circle one):  steel tape  electric tape  air line  other: \_\_\_\_\_

Hole depth: 111 Well depth: 111 Well grouted to a depth of 10 feet

Type of grout (circle one):  Cement  Bentonite  Mix

Casing length: 101 feet Casing diameter: 4 inches Type of casing: PVC

Screen length: 10 feet Screen diameter: 4 inches Type of screen: PVC

Screen slot size: 137mic inches Setting depth: From 101 feet to 111 feet

Type of completion (circle all applicable):  Gravel packed  Unscreened  Telescoped  Open hole  Natural Development  
 Other (describe): WASHED SAND

Top of lap pipe or reduction in casing: \_\_\_\_\_ feet. If telescoped or more than one screen, describe on back of page

Logs run (circle all applicable):  No log run  Electric  Gamma Ray  Density  Sonic  Neutron  Other: \_\_\_\_\_

Name of organization running log(s): \_\_\_\_\_

I certify that the well was drilled, constructed, and completed in accordance with all applicable requirements of the Mississippi Department of Environmental Quality and/or the Mississippi Department of Health regulations and state laws.

BOB SMITH 0-645 \_\_\_\_\_  
 Print Name of Water Well Contractor and License No. Signature of Water Well Contractor

RECEIVED  
 MAR 01 2007  
 BY: OLWR

If well telescopes please sketch below and show depths.

N-53

Ground Level

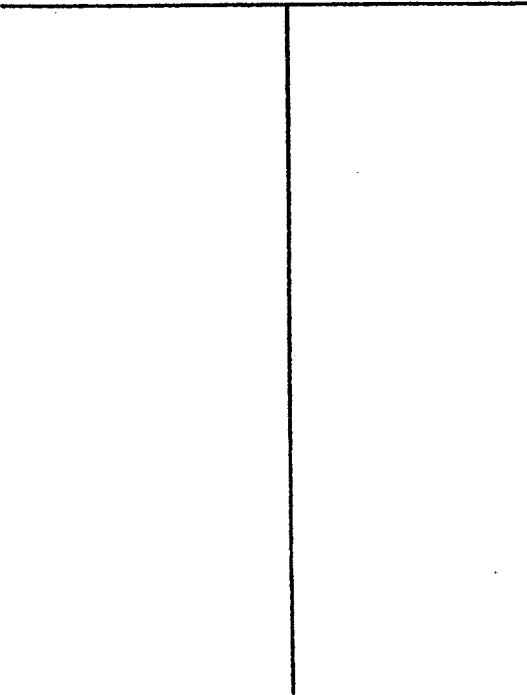

Description of Formations Encountered	From	To
TOP SOIL	0	5
BROWN CLAY	5	17
RED CLAY	17	40
GRAVEL	40	48
WHITE CLAY	48	72
WHITE SAND	72	111

If more than one screen, show location of each on sketch

Sketch the property layout and include the following: 1) the well location; 2) any permanent structures on the property that may aid in locating the well; 3) any roads, power lines, or other items that may aid in locating the property and the well; 4) indicate direction.

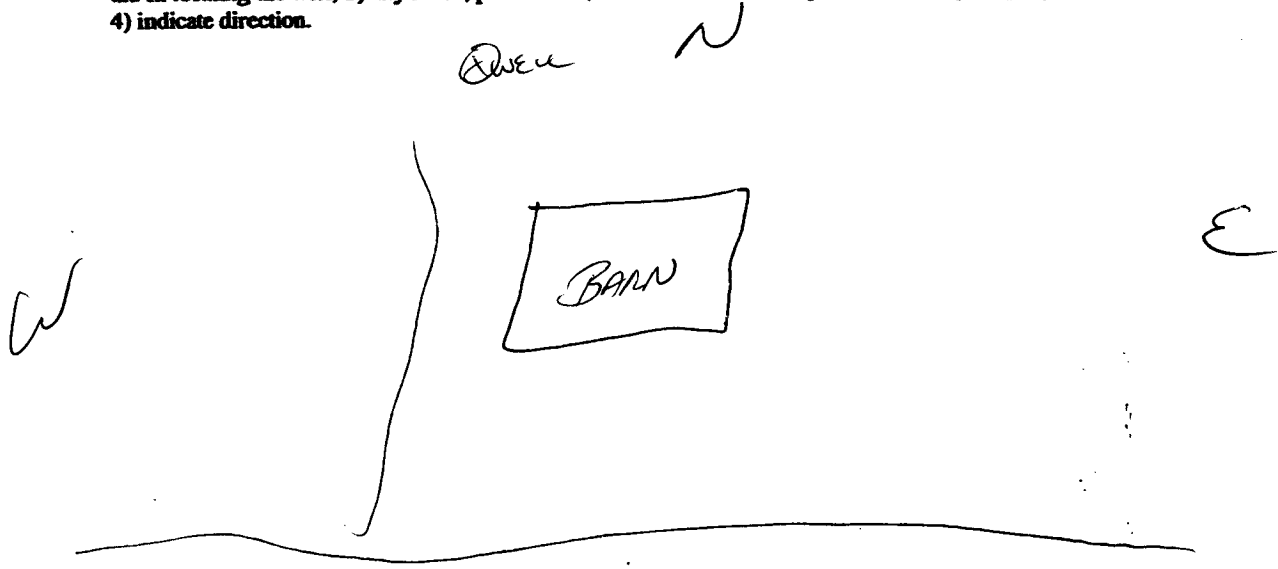

Landowner Name: Barry Sowell S

  
Signature of Water Well Contractor

# STATE WELL REPORT

## Part 2

**Pump Installer's Completion Report**  
 Mississippi Department of Environmental Quality  
 Office of Land and Water Resources  
 P.O. Box 10631  
 Jackson, MS 39289-0631  
 (601)961-5210  
 (601)354-6938 (fax)

For Office Use Only:

County: TATE  
 Permit #: \_\_\_\_\_  
 Driller: BOB SMITH  
 Date completed: 1-29-07

Aquifer: \_\_\_\_\_  
 Well #: N-53  
 Elevation: \_\_\_\_\_

This report should be prepared by the pump installer in detail and filed with the Department within 30 days of the installation of pump.

Well Owner Information	Well Location
Owner Name: <u>BARRY SOWELL</u>	Latitude: _____ Longitude: _____
Mailing Address: <u>LOT 11</u>	Method of Lat/Long (circle one): Conventional Survey,
<u>RAINBOWS</u>	USGS quad, Hand-held GPS, Survey-grade GPS
<u>ERMONA, MS. 38668</u>	_____ 1/4 _____ 1/4 Sec <u>N-6</u> Twn <u>T65</u> Rng <u>R6W</u>
City State Zip Code	Distance Direction Nearest Town
Telephone No. <u>901 828-6763</u>	<u>2</u> Miles <u>W</u> of <u>ERMONA</u>

Pump Type Circle one	Power Type Circle one
Air Lift Jet <input checked="" type="radio"/> <u>Submersible</u>	Diesel Engine Gasoline Engine Natural Gas
Bucket Piston Turbine	<input checked="" type="radio"/> <u>Electric Motor</u> Hand Tractor PTO
Centrifugal Rotary Flowing Well	Windmill Other (specify): _____
Other (specify): _____	Horse Power Rating of Motor: <u>3/4</u>
Date Pump Installed: <u>1-29-07</u>	Setting Depth: <u>80</u> feet
Rated Pump Capacity: <u>12</u> Gallons Per Minute	Number of Stages: <u>11</u>

Pump Test Data	Method of Measuring Water Level Circle one
Date Well Tested: <u>1-29-07</u>	Air Line <input checked="" type="radio"/> <u>Electric Measuring Line</u> Steel Tape
Static Water Level (A): <u>60</u> Feet Below Land Surface	Other (specify): _____
Pumping Water Level (B): <u>65</u> Feet Below Land Surface	For flowing well, measured shut in head: _____ feet
Drawdown [(B) - (A)]: <u>5</u> Feet Below Land Surface	Well yielded <u>16</u> GPM with a drawdown of
Test Pumping Rate: <u>16</u> Gallons Per Minute	<u>5</u> feet after _____ hours of pumping
Duration of Pump Test (minimum 4 hours): _____ hours	

I HEREBY CERTIFY that the above statements are true to the best of my knowledge.

BOB SMITH 0645 \_\_\_\_\_  
 Print Name of Pump Installer and License No. (if applicable) Signature of Pump Installer

RECEIVED  
 MAR 01 2007  
 BY: OLWR