

County: Tate  
 Permit #: \_\_\_\_\_  
 Driller: Joel Jumper  
 Date drilling completed: 9-26-19

**State Well Report**  
**Part I - Driller's Log**  
 Mississippi Department of Environmental Quality  
 Office of Land and Water Resources  
 P.O. Box 2309  
 Jackson, MS 39225  
 (601)961- 5210  
 (601)961- 5228 (fax)

For Office Use Only:  
 Aquifer: \_\_\_\_\_  
 Well #: G 198  
 L. S. Elevation: \_\_\_\_\_  
 E-log #: \_\_\_\_\_

*State Law requires that this report be prepared by the license holder responsible for the work and filed with the Department at the above address within 30 days of completion of drilling of the well or borehole.*

Information on Well Owner <i>(Landowner if borehole is not for a water well)</i>	Well or Borehole Location
Owner Name: <u>Cameron Smith</u>	Latitude: <u>34° 38' 17"</u> Longitude: <u>89° 55' 32"</u>
Mailing Address: <u>2047 Halls Mill</u> <u>Levee Rd</u>	Method of Lat/Long (circle one): Conventional Survey, USGS quad, <u>Hand-held GPS</u> , Survey-grade GPS
<u>Senatobia Ms 38668</u> City State Zip Code	<u>NE 1/4 NW 1/4 Sec 22 Twn 5S Rng 7W</u>
Telephone No. <u>(662) 288-6612</u>	Distance _____ Direction _____ Nearest Town _____ Miles _____ of _____
Well / Borehole Data	
Date drilling started: <u>9-26-19</u> Date drilling completed: <u>9-26-19</u> Hole depth: <u>135</u> Hole diameter: <u>6in</u>	
Location of the source of any surface water used for drilling: <u>Nearest Well</u>	
Method of dosing and volume of Chlorine used in drilling and development: _____	
Logs run (circle all applicable): <u>No log run</u> Electric Gamma Ray Density Sonic Neutron Other: _____	
Name of organization running log(s): _____	
Purpose of borehole (check one): Water Well <input checked="" type="checkbox"/> Geotechnical/Geological Investigation _____ Ground Source Heat Pump _____ Seismic Survey _____ Other (describe) _____	
<i>If drilling is not related to water well construction, skip the remainder of this block</i>	
Purpose of Well (check one): Home <input checked="" type="checkbox"/> Industrial _____ Public Supply _____ Irrigation _____ Fish Culture _____ Other: _____	
If a flowing well, method of flow regulation: Valve _____ Other (describe) _____	
Static Water Level: <u>68</u> feet above or <u>below</u> (circle one) land surface Date measured: <u>9-27-19</u>	
Method of Measurement (circle one) <u>steel tape</u> electric tape air line other: _____	
Well depth: <u>135</u> Well grouted to a depth of <u>10</u> feet Type of grout (circle one): Neat Cement <u>Bentonite</u> Mix	
Casing length: <u>115</u> feet Casing diameter: <u>4</u> inches Type of casing: <u>PVC</u>	
Screen length: <u>20</u> feet Screen diameter: <u>4</u> inches Type of screen: <u>PVC</u>	
Screen slot size: <u>0.15</u> inches Setting depth: From <u>115</u> feet to <u>135</u> feet	
Type of completion (circle all applicable): <u>Gravel packed</u> Underreamed Telescoped Open hole Natural Development	
Other (describe): _____	
Top of lap pipe or reduction in casing: _____ feet. <i>If telescoped or more than one screen, describe on next page</i>	

RECEIVED  
 NOV 01 2019  
 BY OLWR







11:02

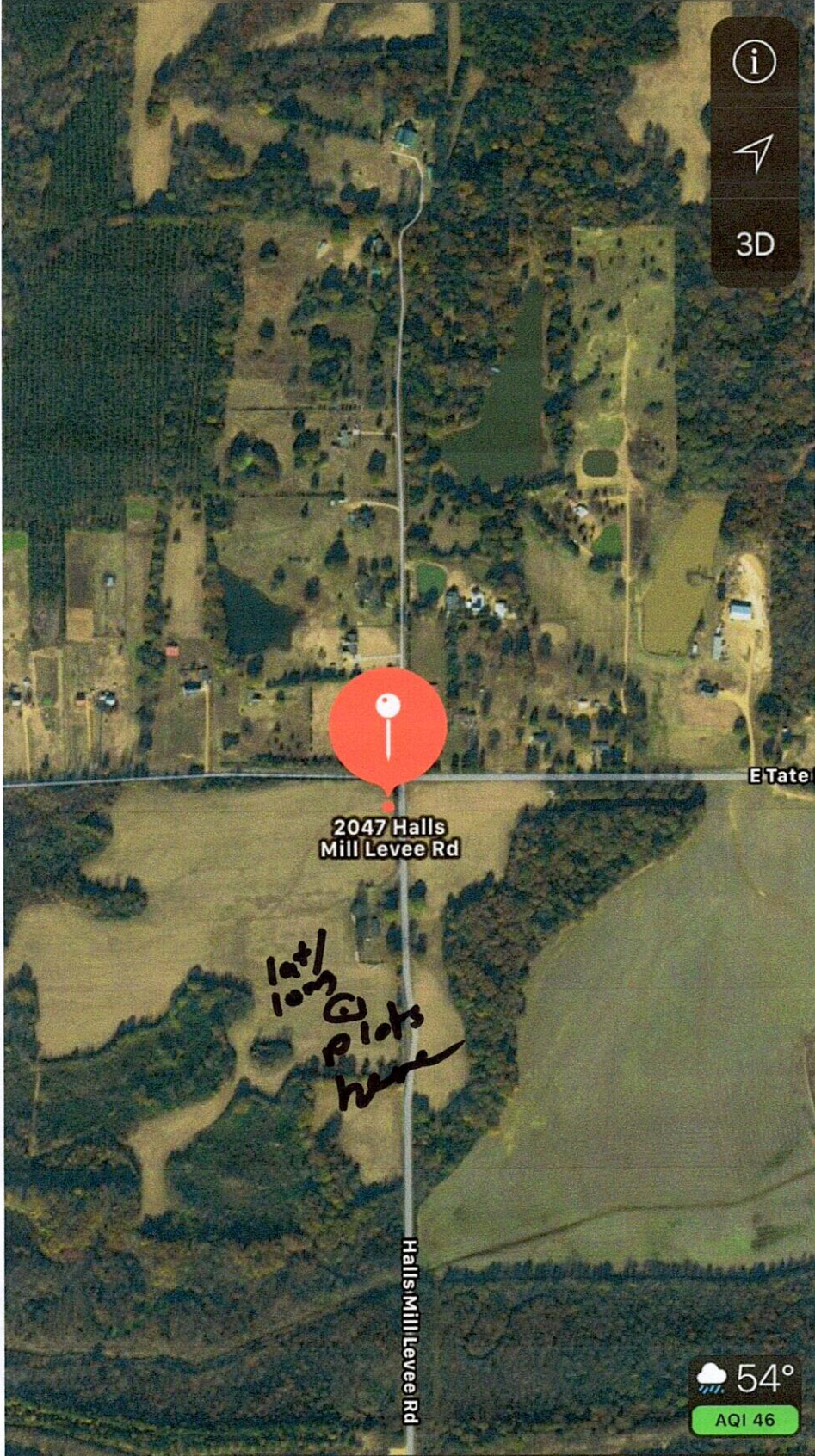

G 198  
Tate Co

2047 Halls  
Mill Levee Rd

E Tate

lat/  
long  
plots  
here

Halls Mill Levee Rd

54°  
AQI 46

2047 Halls Mill Levee Rd  
75 mi

RECEIVED  
NOV 01 2019  
BY OLWR



# STATE WELL REPORT

## Part 2

**Pump Installer's Completion Report**  
 Mississippi Department of Environmental Quality  
 Office of Land and Water Resources  
 P.O. Box 2309  
 Jackson, MS 39225  
 (601)961-5210  
 (601)961-5228 (fax)

County: Tate  
 Permit #: \_\_\_\_\_  
 Driller: Joel Jumper  
 Date completed: 9-27-19  
*Copy information from block on Part 1*

**For Office Use Only:**

Aquifer: \_\_\_\_\_  
 Well #: 6198  
 Elevation: \_\_\_\_\_

*This part of the report must be completed by a licensed water well contractor or a licensed pump installer. A copy of Part 1 of the report must be attached and both parts filed with the Department at the above address within 30 days of well completion.*

Well Owner Information	Well Location
Owner Name: <u>Cameron Smith</u>	Latitude: <u>34-38-17</u> Longitude: <u>89-55-32</u>
Mailing Address: <u>2047 Halls Mill</u> <u>Levee Rd</u> <u>Senatobia Ms 38668</u> City State Zip Code	Method of Lat/Long (check one): Conventional Survey _____ USGS quad _____, Hand-held GPS <input checked="" type="checkbox"/> , Survey-grade GPS _____ _____ ¼ _____ ¼ Sec _____ T _____ R _____
Telephone No. ( ) _____	Distance _____ Miles _____ of _____ Direction _____ Nearest Town _____

Pump Type Circle one	Power Type Circle one
Air Lift      Jet <input checked="" type="radio"/> Submersible	Diesel Engine      Gasoline Engine      Natural Gas
Bucket      Piston      Turbine	<input checked="" type="radio"/> Electric Motor      Hand      Tractor PTO
Centrifugal      Rotary      Flowing Well	Windmill      Other (specify): _____
Other (specify): _____	Horse Power Rating of Motor: <u>1.5</u>
Date Pump Installed: <u>9-27-19</u>	Setting Depth: <del>0 to</del> <u>110</u> feet
Rated Pump Capacity: <u>20</u> Gallons Per Minute	Number of Stages: <u>8</u>

RECEIVED  
 NOV 01 2019  
 BY OLWR

Pump Test Data	Method of Measuring Water Level Circle one
Date Well Tested: <u>9-27-19</u>	Air Line      Electric Measuring Line <input checked="" type="radio"/> Steel Tape
Static Water Level (A): <u>68</u> Feet Below Land Surface	Other (specify): _____
Pumping Water Level (B): <u>81</u> Feet Below Land Surface	For flowing well, measured shut in head: _____ feet
Drawdown [(B) - (A)]: <u>81</u> Feet Below Land Surface	Well yielded <u>20</u> GPM with a drawdown of
Test Pumping Rate: <u>20</u> Gallons Per Minute	<u>81</u> feet after <u>6</u> hours of pumping
Duration of Pump Test (minimum 4 hours): <u>6</u> hours	

I HEREBY CERTIFY that the above statements are true to the best of my knowledge.

Joel Jumper 5317      Joel Jumper  
 Print Name of Pump Installer and License No. (if applicable)      Signature of Pump Installer