

State Well Report

Part 1

Mississippi Department of Environmental Quality
 Office of Land and Water Resources
 P.O. Box 10631
 Jackson, MS 39289-0631
 (601)961-5210
 (601)354-6938 (fax)

For Office Use Only:

Aquifer: _____
 Well #: G-150
 L. S. Elevation: _____
 E-log #: _____

County: TATE
 Permit #: _____
 Driller: Bob Smith
 Date drilling completed: 7-28-07

State Law requires that this report be prepared by the driller in detail and filed with the Department within 30 days of completion of drilling of the well.

Well Owner Information		Well Location	
Owner Name: <u>PAUL McVEE HEE</u>	Latitude: _____	Longitude: _____	
Mailing Address: <u>BURNING SUB.</u>	Method of Lat/Long (circle one): <input type="checkbox"/> Conventional Survey,		
<u>SENTOBIA, MS 38668</u>	USGS quad, Hand-held GPS, Survey-grade GPS		
City State Zip Code	<u>1/4</u> <u>1/4</u> Sec. <u>4-35</u> Twn. <u>T55</u> Rng. <u>R-2W</u>		
Telephone No. <u>(662) 560-7000</u>	Distance: <u>1/2</u> Miles	Direction: <u>S</u>	Nearest Town: <u>NEW TOWN</u>

Well Data

Purpose of Well (circle one): Home Industrial Public Supply Irrigation Fish Culture Other: _____

Date well drilling started: 7-28-07 Date well drilling completed: 7-28-07

If flowing, method of flow regulation: Valve _____ Other (describe) _____

Static Water Level: 60 feet above or below (circle one) land surface Date measured: 7-28-07

Method of Measurement (circle one): steel tape electric tape air line other: _____

Hole depth: 111 Well depth: 111 Well grouted to a depth of 10 feet

Type of grout (circle one): Cement Bentonite Mix

Casing length: 91 feet Casing diameter: 4 inches Type of casing: PVC

Screen length: 20 feet Screen diameter: 4 inches Type of screen: PVC

Screen slot size: 13 MDUS inches Setting depth: From 91 feet to 111 feet

Type of completion (circle all applicable): Gravel packed Unfinished Telescoped Open hole Natural Development

Other (describe): WASHED SAND

Top of lap pipe or reduction in casing: _____ feet. If telescoped or more than one screen, describe on back of page

Logs run (circle all applicable): No log run Electric Gamma Ray Density Sonic Neutron Other: _____

Name of organization running log(s): _____

I certify that the well was drilled, constructed, and completed in accordance with all applicable requirements of the Mississippi Department of Environmental Quality under the Mississippi Department of Health regulations and state laws.

Bob Smith 0-645 _____
 Print Name of Water Well Contractor and License No. Signature of Water Well Contractor

RECEIVED
 AUG 03 2007
 BY: OLWR

G-150

If well telescopes please sketch below and show depths.

Ground Level

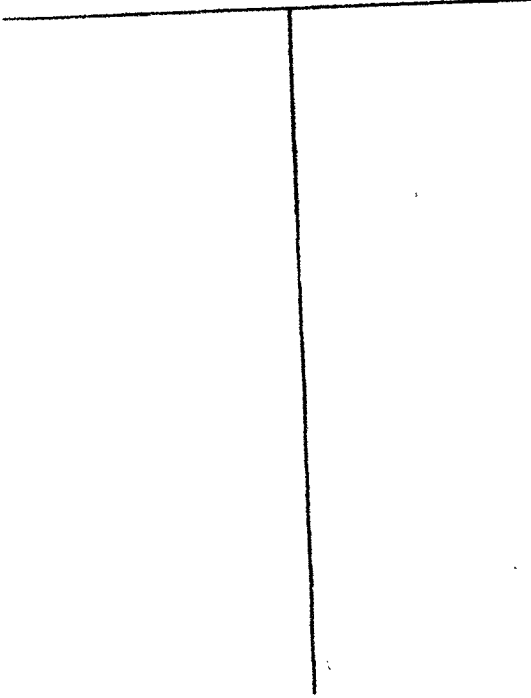

Description of Formations Encountered	From	To
TOP SOIL	0	5
BROWN CLAY	5	13
WHITE CLAY	13	40
WHITE CLAY SAND	40	70
WHITE SAND	70	111

If more than one screen, show location of each on sketch

Sketch the property layout and include the following: 1) the well location; 2) any permanent structures on the property that may aid in locating the well; 3) any roads, power lines, or other items that may aid in locating the property and the well; 4) indicate direction.

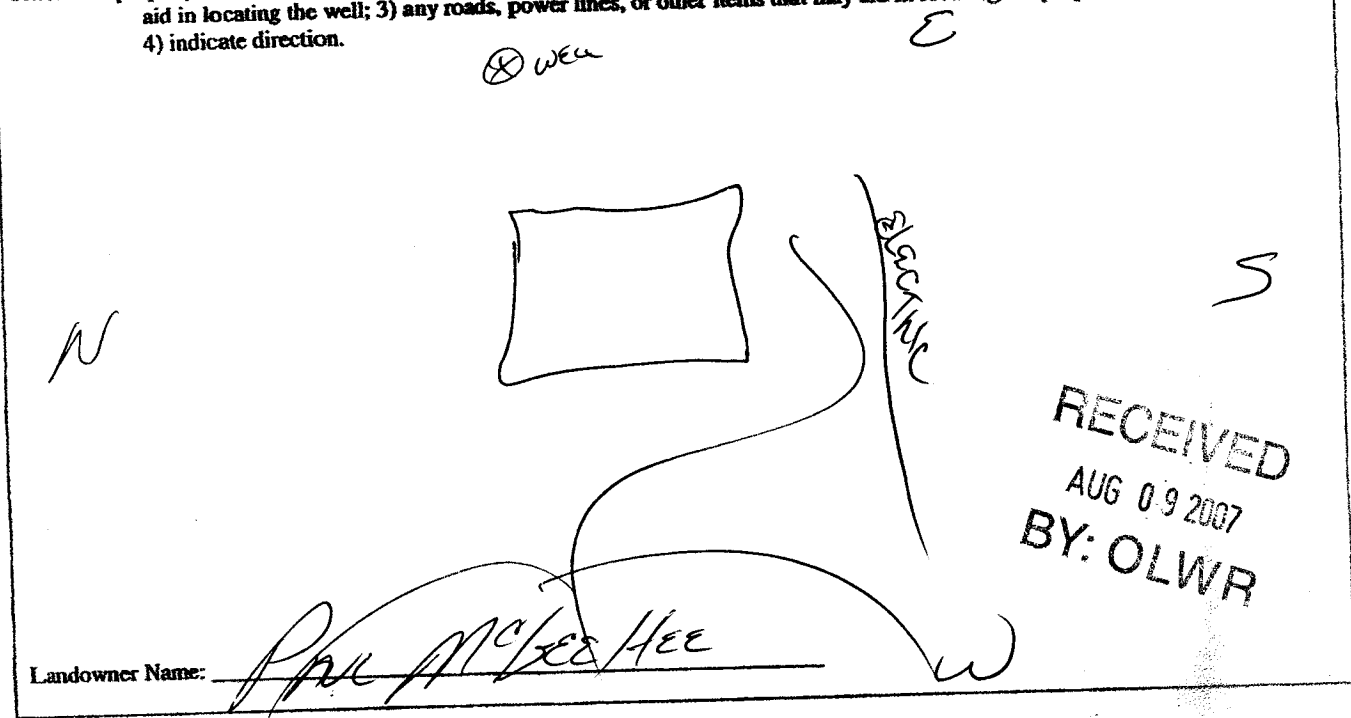

[Signature]
Signature of Water Well Contractor

STATE WELL REPORT

Part 2

Pump Installer's Completion Report
Mississippi Department of Environmental Quality
Office of Land and Water Resources
P.O. Box 10631
Jackson, MS 39289-0631
(601)961-5210
(601)354-6938 (fax)

For Office Use Only:

County: TATE
Permit #: _____
Driller: BOB SMITH
Date completed: 7-28-07

Aquifer: _____
Well #: G-150
Elevation: _____

This report should be prepared by the pump installer in detail and filed with the Department within 30 days of the installation of pump.

Well Owner Information	Well Location
Owner Name: <u>PAUL McGEHEE</u>	Latitude: _____ Longitude: _____
Mailing Address: <u>Burnwood SB</u>	Method of Lat/Long (circle one): Conventional Survey,
<u>BRADMAN MS 38668</u>	USGS quad, Hand-held GPS, Survey-grade GPS
City State Zip Code	<u>1/4 1/4 Sec 4-35 Twn T55 Rng R7W</u>
Telephone No. <u>(662) 500-7000</u>	Distance Direction Nearest Town
	<u>1/2 Miles S of NEW TOWN</u>

Pump Type Circle one	Power Type Circle one
Air Lift Jet <input checked="" type="radio"/> Submersible	Diesel Engine Gasoline Engine Natural Gas
Bucket Piston Turbine	<input checked="" type="radio"/> Electric Motor Hand Tractor PTO
Centrifugal Rotary Flowing Well	Windmill Other (specify): _____
Other (specify): _____	Horse Power Rating of Motor: _____
Date Pump Installed: <u>7-28-07</u>	Setting Depth: <u>80</u> feet
Rated Pump Capacity: <u>12</u> Gallons Per Minute	Number of Stages: <u>11</u>

Pump Test Data	Method of Measuring Water Level Circle one
Date Well Tested: <u>7-28-07</u>	Air Line <input checked="" type="radio"/> Electric Measuring Line <input checked="" type="radio"/> Steel Tape
Static Water Level (A): <u>60</u> Feet Below Land Surface	Other (specify): _____
Pumping Water Level (B): <u>64</u> Feet Below Land Surface	For flowing well, measured shot in head: _____ feet
Drawdown [(B) - (A)]: <u>4</u> Feet Below Land Surface	Well yielded <u>15</u> GPM with a drawdown of
Test Pumping Rate: <u>15</u> Gallons Per Minute	<u>4</u> feet after _____ hours of pumping
Duration of Pump Test (minimum 4 hours): _____ hours	

I HEREBY CERTIFY that the above statements are true to the best of my knowledge.

BOB SMITH 0645
Print Name of Pump Installer and License No. (if applicable)

[Signature]
Signature of Pump Installer