

STATE WELL REPORT

Part 1

Driller's Log

Mississippi Department of Environmental Quality
Office of Land and Water Resources
P.O. Box 2309
Jackson, MS 39225-2309
(601)961-5210
(601)360-0535 (fax)

For Office Use Only:

Well #: E67
Aquifer: _____
E-Log #: _____

County: Tate
Permit #: _____
Driller: Jones W. Mason
Date drilling completed: 9-1-14

State Law requires that this report be prepared by the license holder responsible for the work and filed with the Department at the above address within 30 days of completion of drilling of the well or borehole.

| Well Owner Information <small>(Landowner if borehole is not for a water well)</small> | Well or Borehole Location |
|--|--|
| Owner Name: <u>Dwight Williams</u> | Latitude: <u>34°40'10.80 N</u> Longitude: <u>89°47'30.12 W</u> |
| Mailing Address: <u>1252 Powell rd.</u> | Method of Lat/Long (check one): Conventional Survey _____, USGS quad _____, Hand-held GPS <input checked="" type="checkbox"/> , Survey-grade GPS _____ |
| <u>Coldwater</u> MS <u>38618</u> | <u>NW 1/4 NW 1/4, Sec 12 T 5S R6W</u> |
| City State Zip Code | <u>2.14</u> Miles <u>SW</u> of <u>Beth</u> |
| Telephone No. <u>(901)626-3948</u> | (Distance) (Direction) (Nearest Town) |

| Well / Borehole Data |
|--|
| Date drilling started: <u>9-1-14</u> Date drilling completed: <u>9-1-14</u> Hole depth: <u>170</u> Hole diameter: <u>6314</u> |
| Location of the source of any surface water used for drilling: <u>N/A</u> |
| Method of dosing and volume of Chlorine used in drilling and development: <u>5 ppm and greater</u> |
| Logs run (circle all applicable): <input checked="" type="checkbox"/> No log run <input type="checkbox"/> Electric <input type="checkbox"/> Gamma Ray <input type="checkbox"/> Density <input type="checkbox"/> Sonic <input type="checkbox"/> Neutron <input type="checkbox"/> Other: _____ |
| Name of organization running log(s): <u>N/A</u> |
| Purpose of borehole (circle one): <input checked="" type="radio"/> Water Well <input type="radio"/> Geotechnical/Geological Investigation <input type="radio"/> Ground Source Heat Pump <input type="radio"/> Seismic Survey <input type="radio"/> Other (describe) _____ |
| If drilling is not related to water well construction, skip the remainder of this block |

| |
|--|
| Purpose of Well (circle all applicable): <input checked="" type="checkbox"/> Home <input type="checkbox"/> Industrial <input type="checkbox"/> Public Supply <input type="checkbox"/> Irrigation <input type="checkbox"/> Fish Culture |
| Other (describe): _____ |
| If a flowing well, method of flow regulation: Valve <u>N/A</u> Other (describe) <u>N/A</u> |
| Static Water Level: <u>107</u> feet [above or <input checked="" type="checkbox"/> below] land surface Date measured: <u>9-1-14</u> <small>(circle one)</small> |
| Method of measurement (circle one): Steel tape <input type="checkbox"/> Electric tape <input type="checkbox"/> Air line <input type="checkbox"/> Other (describe): <u>string/weight</u> |
| Well depth: <u>170</u> Well grouted to a depth of: <u>10</u> feet Type of grout (circle one): Neat Cement <input type="checkbox"/> <input checked="" type="checkbox"/> Bentonite <input type="checkbox"/> Mix |
| Casing length: <u>160</u> feet Casing diameter: <u>4</u> inches Type of casing: <u>pvc</u> |
| Screen length: <u>10</u> feet Screen diameter: <u>4</u> inches Type of screen: <u>pvc</u> |
| Screen slot size: <u>.010</u> inches Setting depth: From <u>160</u> feet to <u>170</u> feet |
| Type of completion (circle all applicable): <input checked="" type="checkbox"/> Gravel packed <input type="checkbox"/> Underreamed <input type="checkbox"/> Open hole <input type="checkbox"/> Natural Development |
| Other (describe): <u>N/A</u> |
| Top of lap pipe or reduction in casing: <u>N/A</u> feet |
| If telescoped or more than one screen, describe on next page |

County: _____

Permit #: _____

For Office Use Only:

Well #: E67

The sketch below only required for water wells

If well telescopes, show depths on sketch.

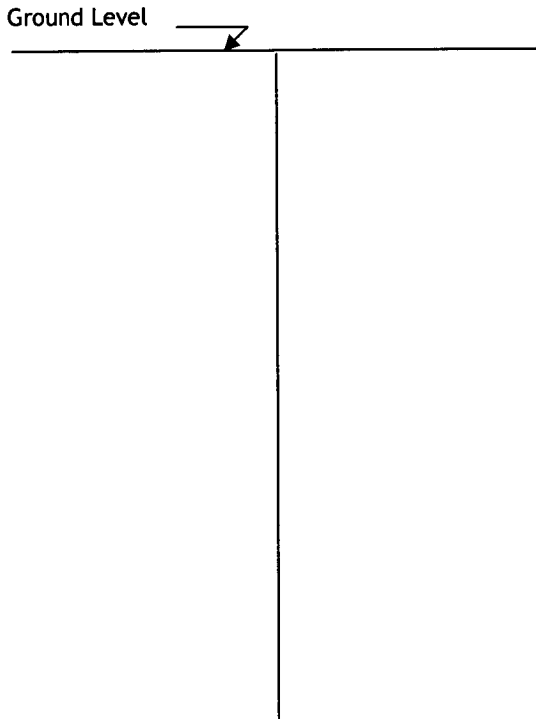

Description of formations encountered must be provided for all wells and boreholes, unless specifically exempted by regulations

| Description of Formations Encountered | From (depth) | To (depth) |
|---------------------------------------|--------------|------------|
| clay dirt | Ground level | 8 |
| Red sand | 8 | 15 |
| white sand | 15 | 30 |
| white clay | 30 | 90 |
| white sand | 90 | 170 |
| | | |
| | | |
| | | |
| | | |
| | | |
| | | |
| | | |
| | | |
| | | |
| | | |
| | | |
| | | |

If more than one screen, show location of each on sketch

Sketch the property layout and include the following:

- 1) the well location
- 2) any permanent structures on the property that may aid in locating the well
- 3) any roads, power lines, or other items that may aid in locating the property and the well
- 4) north arrow

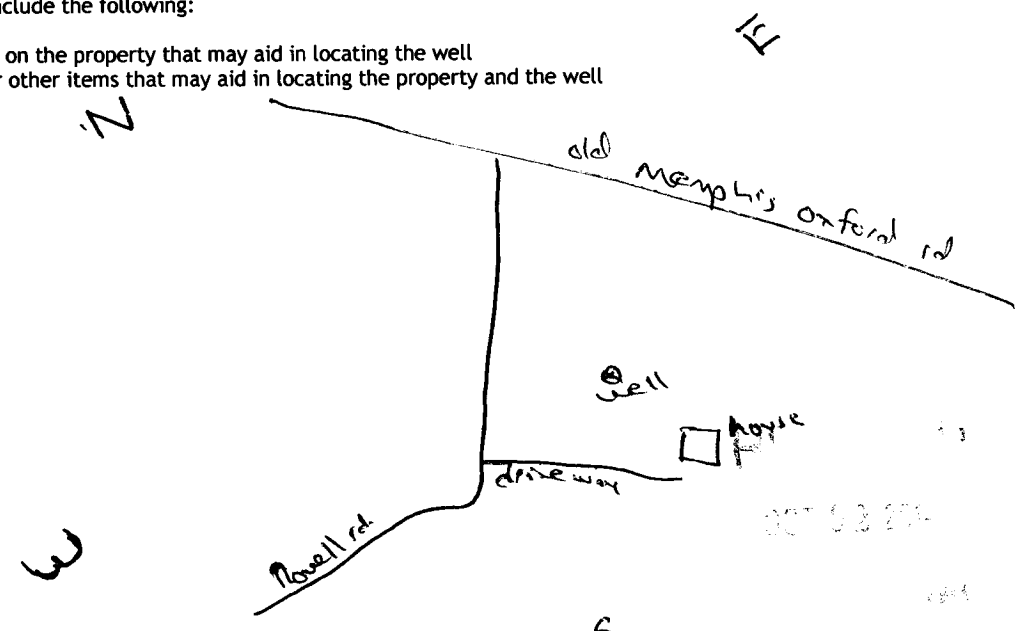

Landowner Name: Dwight Williams

I HEREBY CERTIFY that the well/borehole was drilled, constructed, and completed in accordance with all applicable requirements of the Mississippi Department of Environmental Quality and the Mississippi Department of Health regulations, if applicable, and state laws.

Jane W Mason 0-620
Print Name of Responsible Licensee and License No.

9-29-14
Date

Jane W. Mason
Signature of Licensee

STATE WELL REPORT

Part 2

Pump Installer's Completion Report
Mississippi Department of Environmental Quality
Office of Land and Water Resources
P.O. Box 2309
Jackson, MS 39225-2309
(601)961-5210
(601) 360-0535 (fax)

County: Tate
Permit #: _____
Driller: Jones W. Mason
Date completed: 9-1-14
Copy information from block on Part 1

For Office Use Only:
Well #: E67
Aquifer: _____

This part of the report must be completed by a licensed water well contractor or a licensed pump installer. A copy of Part 1 of the report must be attached and both parts filed with the Department at the above address within 30 days of well completion.

| Well Owner Information | Well Location |
|--|--|
| Owner Name: <u>Dwight Williams</u> | Latitude: <u>34°40'10.80" N</u> Longitude: <u>89°47'30.12" W</u> |
| Mailing Address: <u>1252 Rowell Rd</u> | Method of Lat/Long (check one): Conventional Survey _____, USGS quad _____, Hand-held GPS <input checked="" type="checkbox"/> , Survey-grade GPS _____ |
| <u>Coldwater</u> MS <u>38618</u> | <u>NW 1/4 NW 1/4, Sec 12 T 5s R 6w</u> |
| City State Zip Code | <u>2.14</u> Miles <u>SW</u> of <u>Beth</u> |
| Telephone No. (<u>901</u>) <u>626-3948</u> | (Distance) (Direction) (Nearest Town) |

Pump Type (circle one)
 Submersible Turbine Air Lift Centrifugal Flowing Well Jet Piston Rotary Other (describe): _____
Date Pump Installed: 9-1-14 Rated Pump Capacity: 10 Gallons Per Minute
Is This Pump (circle one): New Repaired Replacement

Power Type (circle one)
 Electric Diesel Gasoline Natural Gas Tractor PTO Windmill Other (describe): _____
Horse Power Rating of Motor: 3/4 Setting Depth: 140 feet Number of Stages: 8

Pump Test Data for Non Flowing Well
Date Well Tested: 9-1-14 Duration of Pump Test (minimum 4 hours): 24 hours
Static Water Level (A): 107 Feet Below Land Surface Pumping Water Level (B): N/A Feet Below Land Surface
Drawdown [(B) - (A)]: N/A Feet Below Land Surface Test Pumping Rate: 10 Gallons Per Minute
Method of measurement (circle one): Steel tape Electric tape Air line Other (describe): string/weight

Pump Test Data for Flowing Well
Measured shut in head: N/A feet.
Well yielded 10 GPM with a drawdown of N/A feet after 24 hours of pumping

Meter Installation
Meter Manufacturer: N/A Meter Serial Number: N/A
Meter Model Number/Name: N/A Type of Meter: N/A
Totalizer Register Unit and Multiplier Factor (AF x .001, gal x 1000, etc): N/A
Installation Date: N/A Meter installed by: N/A
Is This Meter (circle one): New Repaired Replacement

Important: By submitting the above information you are certifying that this meter was installed to manufacturer standards. For agricultural wells, a list of approved meters is on the MDEQ website.

I HEREBY CERTIFY that the above statements are true to the best of my knowledge.
Jones W. Mason 0-620 9-29-14 Jones W. Mason
Print Name of Pump Installer and License No. (if applicable) Date Signature of Pump Installer