

**State Well Report
Part 1 - Driller's Log**

Mississippi Department of Environmental Quality
Office of Land and Water Resources
P.O. Box 10631
Jackson, MS 39289-0631
(601)961-5210
(601)354-6938 (fax)

County: Tate
Permit #: _____
Driller: Jones W. Mason
Date drilling completed: 7-24-07

For Office Use Only:

Aquifer: _____
Well #: C-264
L. S. Elevation: _____
E-log #: _____

State Law requires that this report be prepared by the license holder responsible for the work and filed with the Department at the above address within 30 days of completion of drilling of the well or borehole.

Information on Well Owner <i>(Landowner if borehole is not for a water well)</i>	Well or Borehole Location
Owner Name: <u>Clark Scruggs</u>	Latitude: <u>34° 45' 56.7"</u> Longitude: <u>89° 50' 62.6"</u>
Mailing Address: <u>Palestine rd</u>	Method of Lat/Long (circle one): Conventional Survey, <u>37</u>
<u>Corner of Palestine & Greenleaf</u>	USGS quad, <u>(Hand-held GPS)</u> , Survey-grade GPS
<u>Coldwater MS 38618</u>	NW 1/4, NW 1/4 Sec <u>9</u> Twn <u>45</u> Rng <u>6W</u>
City State Zip Code	Distance Direction Nearest Town
Telephone No. <u>(662) 233-2003</u>	<u>1</u> Miles <u>N</u> of <u>Gingerhill</u>

Well / Borehole Data

Date drilling started: 7-24-07 Date drilling completed: 7-24-07 Hole depth: 165' Hole diameter: 63/4

Location of the source of any surface water used for drilling: NA

Method of dosing and volume of Chlorine used in drilling and development: NA

Logs run (circle all applicable): (No log run) Electric Gamma Ray Density Sonic Neutron Other: _____

Name of organization running log(s): NA

Purpose of borehole (check one): Water Well Geotechnical/Geological Investigation _____ Ground Source Heat Pump _____

Seismic Survey _____ Other (describe) NA

If drilling is not related to water well construction, skip the remainder of this block

Purpose of Well (check one): Home Industrial _____ Public Supply _____ Irrigation _____ Fish Culture _____ Other: _____

If a flowing well, method of flow regulation: Valve NA Other (describe) _____

Static Water Level: 100 feet above or below (circle one) land surface Date measured: 7-27-07

Method of Measurement (circle one) steel tape electric tape air line other: string/weight

Well depth: 165 Well grouted to a depth of 10 feet Type of grout (circle one): Neat Cement (Bentonite) Mix

Casing length: 155 feet Casing diameter: 4 inches Type of casing: pvc

Screen length: 10 feet Screen diameter: 4 inches Type of screen: pvc

Screen slot size: .010 inches Setting depth: From 155 feet to 165 feet

Type of completion (circle all applicable): (Gravel packed) Underreamed Telescoped Open hole Natural Development

Other (describe): NA

Top of lap pipe or reduction in casing: NA feet. *If telescoped or more than one screen, describe on next page*

Form: OLWR-SWR-1A

RECEIVED
AUG 27 2007
BY: OLWR

The sketch below only required for water wells

If well telescopes, show depths on sketch.

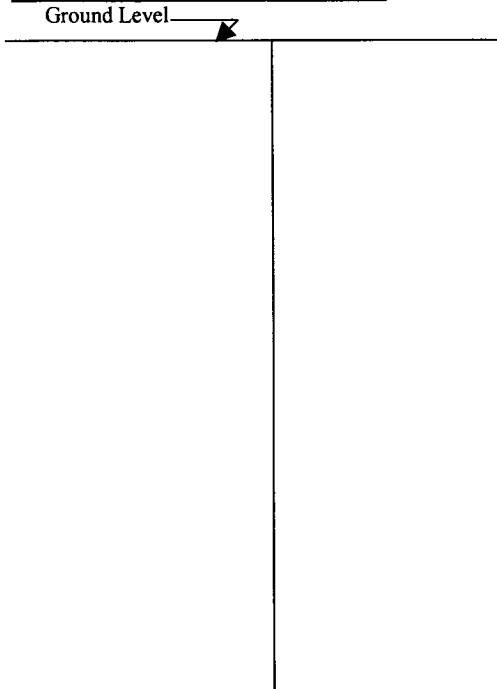

Description of formations encountered must be provided for all wells and boreholes, unless specifically exempted by regulations

Description of Formations Encountered	From (depth)	To (depth)
clay dirt	Ground Level	10
red sand	10	30
white clay	30	35
gravel	35	90
white clay	90	100
white sand	100	165

If more than one screen, show location of each on sketch

Sketch the property layout and include the following: 1) the well location; 2) any permanent structures on the property that may aid in locating the well; 3) any roads, power lines, or other items that may aid in locating the property and the well; 4) a north arrow.

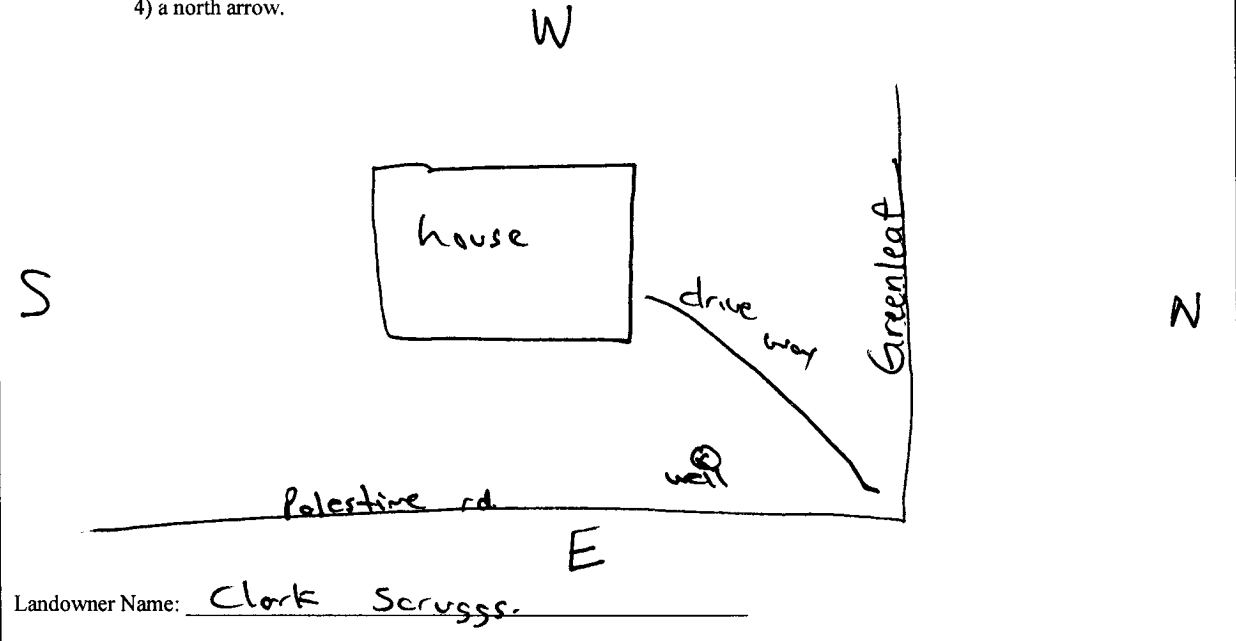

Form: OLWR-SWR-1A

I certify that the well/borehole was drilled, constructed, and completed in accordance with all applicable requirements of the Mississippi Department of Environmental Quality and the Mississippi Department of Health regulations, if applicable, and state laws.

Jones v. Marow 0-620 8-21-07
Print Name of Responsible Licensee and License No. Date

[Signature]
Signature of Licensee

RECEIVED
AUG 27 2007
BY: OLWR

STATE WELL REPORT

Part 2

Pump Installer's Completion Report

Mississippi Department of Environmental Quality
Office of Land and Water Resources
P.O. Box 10631
Jackson, MS 39289-0631
(601)961-5210
(601)354-6938 (fax)

County: Tate
 Permit #: _____
 Driller: Jones w. Mason
 Date completed: 7-27-07
Copy information from block on Part 1

For Office Use Only:

Aquifer: _____
 Well #: C-264
 Elevation: _____

This part of the report must be completed by a licensed water well contractor or a licensed pump installer. A copy of Part 1 of the report must be attached and both parts filed with the Department at the above address within 30 days of well completion.

Well Owner Information	Well Location
Owner Name: <u>Clark Scruggs</u>	Latitude: <u>34.45.567</u> Longitude: <u>89.50.626</u>
Mailing Address: <u>Palestine rd.</u> <u>Corner of Palestine & Greenleaf</u>	Method of Lat/Long (check one): Conventional Survey _____ USGS quad _____, Hand-held GPS <input checked="" type="checkbox"/> , Survey-grade GPS _____
<u>Coldwater</u> <u>ms</u> <u>38618</u> City State Zip Code	<u>NW 1/4 NW 1/4 Sec 9 T 4s R 6w</u>
Telephone No. <u>(601) 233-2003</u>	Distance Direction Nearest Town <u>1</u> Miles <u>N</u> of <u>Gingerhill</u>

Pump Type Circle one	Power Type Circle one
Air Lift Jet <input type="checkbox"/> Submersible <input checked="" type="checkbox"/>	Diesel Engine Gasoline Engine Natural Gas
Bucket Piston Turbine	Electric Motor <input checked="" type="checkbox"/> Hand Tractor PTO
Centrifugal Rotary Flowing Well	Windmill Other (specify): _____
Other (specify): _____	Horse Power Rating of Motor: <u>3/4</u>
Date Pump Installed: <u>7-27-07</u>	Setting Depth: <u>120</u> feet
Rated Pump Capacity: <u>12</u> Gallons Per Minute	Number of Stages: <u>11</u>

Pump Test Data	Method of Measuring Water Level Circle one
Date Well Tested: <u>7-27-07</u>	Air Line Electric Measuring Line Steel Tape
Static Water Level (A): <u>190</u> Feet Below Land Surface	Other (specify): <u>String Weight</u>
Pumping Water Level (B): <u>NA</u> Feet Below Land Surface	For flowing well, measured shut in head: <u>NA</u> feet
Drawdown [(B) - (A)]: <u>NA</u> Feet Below Land Surface	Well yielded <u>12</u> GPM with a drawdown of
Test Pumping Rate: <u>12</u> Gallons Per Minute	<u>NA</u> feet after <u>24</u> hours of pumping
Duration of Pump Test (minimum 4 hours): <u>24</u> hours	

I HEREBY CERTIFY that the above statements are true to the best of my knowledge.

Jones w. Mason 0-620 Jones w. Mason
 Print Name of Pump Installer and License No. (if applicable) Signature of Pump Installer

Form: OLWR-SWR-1B

RECEIVED

AUG 27 2007

BY: OLWR