

State Well Report

Part 1

Mississippi Department of Environmental Quality
Office of Land and Water Resources
P.O. Box 10631
Jackson, MS 39289-0631
(601)961-5210
(601)354-6938 (fax)

For Offices Use Only:

Aquifer: _____
Well #: B-160
L. S. Elevation: _____
E-log #: _____

County: TATE
Permit #: _____
Driller: Bob Smith
Date drilling completed: 3/28/07

State Law requires that this report be prepared by the driller in detail and filed with the Department within 30 days of completion of drilling of the well.

Well Owner Information	Well Location
Owner Name: <u>M.E. Smith Birmingham</u>	Latitude: _____ Longitude: _____
Mailing Address: <u>5018 Ardmore Rd.</u>	Method of Lat/Long (circle one): <u>Conventional Survey</u>
<u>Coldwater MS. 39028</u>	USGS quad, Hand-held GPS, Survey-grade GPS
City: _____ State: _____ Zip Code: _____	<u>1/4 1/4 Sec. B31 Twa T45 Rng R8W</u>
Telephone No.: <u>(901)-620-8994</u>	Distance _____ Direction _____ Nearest Town _____ <u>6 Miles W of COLDWATER</u>

Well Data

Purpose of Well (circle one): Home Industrial Public Supply Irrigation Fish Culture Other: _____

Date well drilling started: 3-28-07 Date well drilling completed: 3-28-07

If flowing, method of flow regulation: Valve _____ Other (describe) _____

Static Water Level: 55 feet above or below (circle one) land surface Date measured: 3-28-07

Method of Measurement (circle one): steel tape electric tape air line other: _____

Hole depth: 84 Well depth: 84 Well grouted to a depth of 10 feet

Type of grout (circle one): Cement Bentonite Mix

Casing length: 64 feet Casing diameter: 4 inches Type of casing: PVC

Screen length: 20 feet Screen diameter: 4 inches Type of screen: PVC

Screen slot size: 13 to 15 inches Setting depth: From 64 feet to 84 feet

Type of completion (circle all applicable): Gravel packed Underreamed Telescoped Open hole Natural Development
Other (describe): Washed Sand

Top of lap pipe or reduction in casing: _____ feet. If telescoped or more than one screen, describe on back of page

Logs run (circle all applicable): No log run Electric Gamma Ray Density Sonic Neutron Other: _____

Name of organization running log(s): _____

I certify that the well was drilled, constructed, and completed in accordance with all applicable requirements of the Mississippi Department of Environmental Quality and/or the Mississippi Department of Health regulations and state laws.

Bob Smith 0-049
Print Name of Water Well Contractor and License No.

[Signature]
Signature of Water Well Contractor

RECEIVED
MARCH 29 2007
STATE OF MISSISSIPPI

If well telescopes please sketch below and show depths.

B-160

Ground Level

Description of Formations Encountered	From	To
Top Soil	0	5
Brown clay	5	18
White clay	18	41
Sand + gravel	41	84
White clay	84	

If more than one screen, show location of each on sketch

Sketch the property layout and include the following: 1) the well location; 2) any permanent structures on the property that may aid in locating the well; 3) any roads, power lines, or other items that may aid in locating the property and the well; 4) indicate direction.

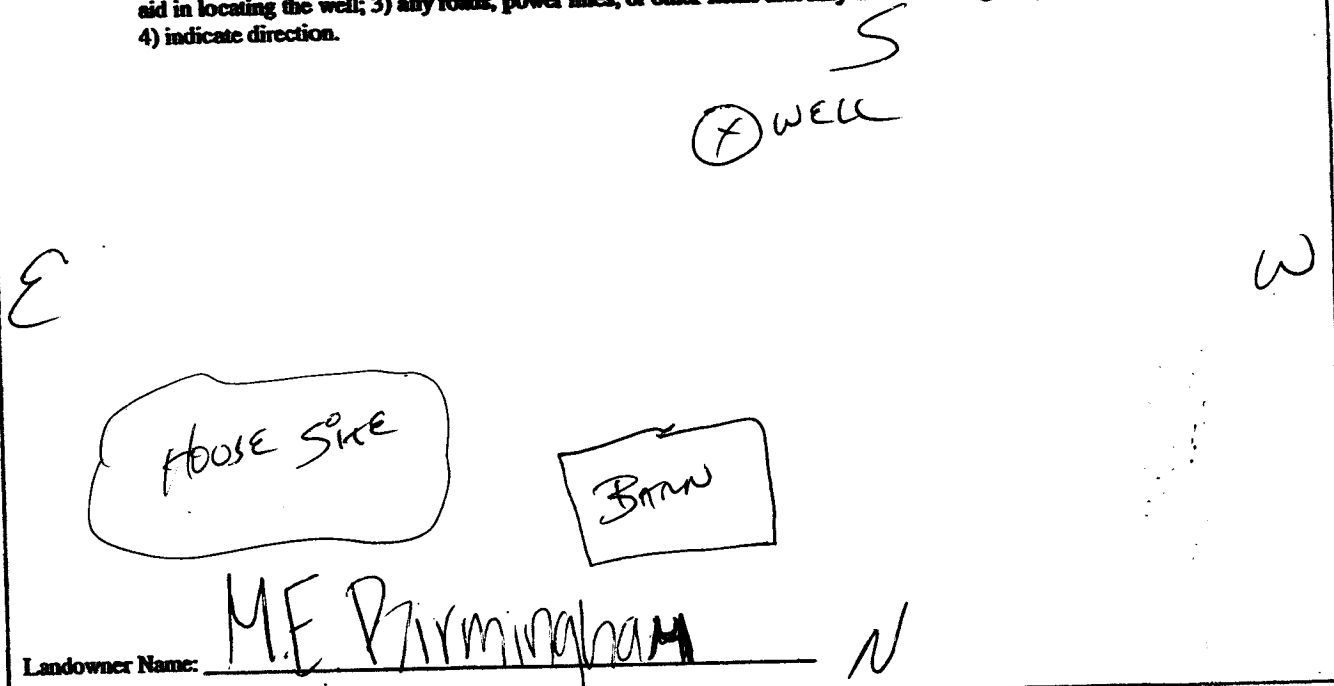

Landowner Name:

M.E. PIRMINGHAM

 Signature of Water Well Contractor

RECEIVED
 APR 10 2007
 BY CLWR

STATE WELL REPORT

Part 2

Pump Installer's Completion Report
 Mississippi Department of Environmental Quality
 Office of Land and Water Resources
 P.O. Box 10631
 Jackson, MS 39289-0631
 (601)961-5210
 (601)354-6938 (fax)

For Office Use Only:

Aquifer: _____

Well #: B-160

Elevation: _____

County: Tate
 Permit #: _____
 Driller: Bob Smith
 Date completed: 3/28/07

This report should be prepared by the pump installer in detail and filed with the Department within 30 days of the installation of pump.

Well Owner Information	Well Location
Owner Name: <u>M.E. Birmingham</u>	Latitude: _____ Longitude: _____
Mailing Address: <u>5018 Pryorville Rd</u>	Method of Lat/Long (circle one): <input type="checkbox"/> Conventional Survey, <input type="checkbox"/> USGS quad, <input type="checkbox"/> Hand-held GPS, <input type="checkbox"/> Survey-grade GPS
<u>Coldwater</u> <u>MS</u> <u>3861018</u>	<u>1/4</u> <u>1/4</u> Sec. <u>B31</u> Twn <u>T45</u> Rng <u>R8W</u>
City State Zip Code	Distance Direction Nearest Town
Telephone No. <u>(901) 6020-8554</u>	<u>6</u> Miles <u>W</u> of <u>COLDWATER</u>

Pump Type Circle one	Power Type Circle one
Air Lift Jet <input type="checkbox"/> <input checked="" type="checkbox"/> <u>Submersible</u>	Diesel Engine Gasoline Engine Natural Gas
Bucket Piston <input type="checkbox"/> <input type="checkbox"/> <u>Turbine</u>	<input checked="" type="checkbox"/> <u>Electric Motor</u> Hand Tractor PTO
Centrifugal Rotary <input type="checkbox"/> <input type="checkbox"/> <u>Flowing Well</u>	Windmill Other (specify): _____
Other (specify): _____	Horse Power Rating of Motor: <u>3/4</u>
Date Pump Installed: <u>3/28/07</u>	Setting Depth: <u>63</u> feet
Rated Pump Capacity: <u>12</u> Gallons Per Minute	Number of Stages: <u>14</u>

Pump Test Data	Method of Measuring Water Level Circle one
Date Well Tested: <u>3/28/07</u>	Air Line <input type="checkbox"/> <input checked="" type="checkbox"/> <u>Electric Measuring Line</u> <input type="checkbox"/> Steel Tape
Static Water Level (A): <u>55</u> Feet Below Land Surface	Other (specify): _____
Pumping Water Level (B): <u>58</u> Feet Below Land Surface	For flowing well, measured shut in head: _____ feet
Drawdown [(B) - (A)]: <u>3</u> Feet Below Land Surface	Well yielded <u>14</u> GPM with a drawdown of
Test Pumping Rate: <u>14</u> Gallons Per Minute	<u>3</u> feet after _____ hours of pumping
Duration of Pump Test (minimum 4 hours): _____ hours	

I HEREBY CERTIFY that the above statements are true to the best of my knowledge.

Bob Smith 01045 [Signature]
 Print Name of Pump Installer and License No. (if applicable) Signature of Pump Installer