

STATE WELL REPORT

County: TALLAHATCHIE
 Permit #: GW-50064
 Driller: CHAD MATTOX
 Date drilling completed: 7/18/17

Part 1
Driller's Log
 Mississippi Department of Environmental Quality
 Office of Land and Water Resources
 P.O. Box 2309
 Jackson, MS 39225-2309
 (601)961-5210
 (601)360-0535 (fax)

For Office Use Only:
 Well #: N124
 Aquifer: _____
 E-Log #: _____

State Law requires that this report be prepared by the license holder responsible for the work and filed with the Department at the above address within 30 days of completion of drilling of the well or borehole.

Well Owner Information (Landowner if borehole is not for a water well) Owner Name: <u>GARY TAYLOR</u> Mailing Address: <u>10355 MEMPHIS ARLINGTON RD</u> <u>LAKELAND</u> <u>TN</u> <u>38002</u> City State Zip Code Telephone No. (____) _____			Well or Borehole Location Latitude: <u>33-48-41.39N</u> Longitude: <u>90-27-05.93 W</u> Method of Lat/Long (check one): Conventional Survey _____, USGS quad _____, Hand-held GPS <input checked="" type="checkbox"/> , Survey-grade GPS _____ <u>SW</u> $\frac{1}{4}$ <u>SW</u> $\frac{1}{4}$, Sec <u>31</u> T <u>23N</u> R <u>02W</u> <u>4</u> Miles <u>E</u> of <u>DREW</u> (Distance) (Direction) (Nearest Town)		
---	--	--	--	--	--

Well / Borehole Data
 Date drilling started: 7/18/17 Date drilling completed: 7/18/17 Hole depth: 115' Hole diameter: 24"
 Location of the source of any surface water used for drilling: _____
 Method of dosing and volume of Chlorine used in drilling and development: _____
 Logs run (circle all applicable): No log run Electric Gamma Ray Density Sonic Neutron Other _____
 Name of organization running log(s): _____
 Purpose of borehole (circle one): Water Well Geotechnical/Geological Investigation Ground Source Heat Pump
 Seismic Survey Other (describe) _____

If drilling is not related to water well construction, skip the remainder of this block

Purpose of Well (circle all applicable): Home Industrial Public Supply Irrigation Fish Culture
 Other (describe): _____
 If a flowing well, method of flow regulation: Valve _____ Other (describe) _____
 Static Water Level: 38 feet [above or below] land surface Date measured: 7/18/17
 (circle one)
 Method of measurement (circle one): Steel tape Electric tape Air line Other (describe): _____
 Well depth: 115 Well grouted to a depth of: 10 feet Type of grout (circle one): Neat Cement Bentonite Mix
 Casing length: 75 feet Casing diameter: 16" inches Type of casing: PVC
 Screen length: 40 feet Screen diameter: 16 inches Type of screen: PVC
 Screen slot size: .050 inches Setting depth: From 70 feet to 115 feet
 Type of completion (circle all applicable): Gravel packed Underreamed Open hole Natural Development
 Other (describe): _____
 Top of lap pipe or reduction in casing: _____ feet

If telescoped or more than one screen, describe on next page

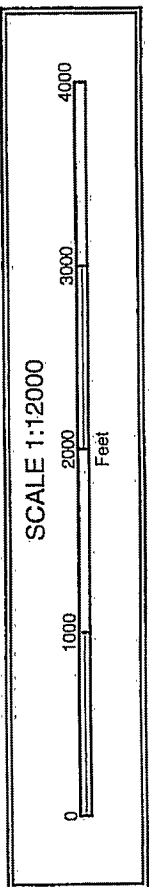
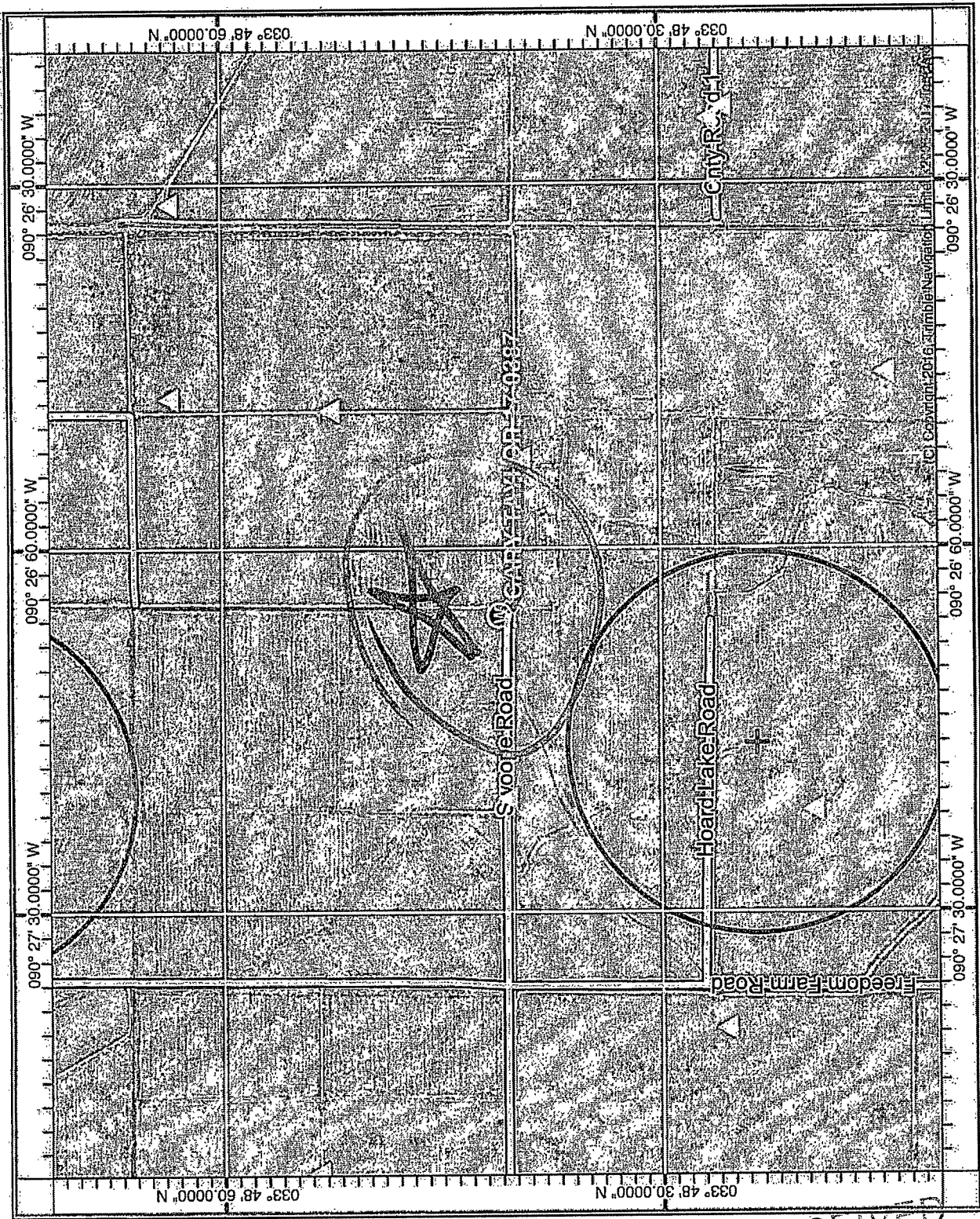

RECEIVED
 AUG 04 2017
 BY OLWR

STATE WELL REPORT

Part 2

Pump Installer's Completion Report
 Mississippi Department of Environmental Quality
 Office of Land and Water Resources
 P.O. Box 2309
 Jackson, MS 39225-2309
 (601)961-5210
 (601) 360-0535 (fax)

For Office Use Only:

Well #: N

Aquifer: _____

County: TALLAHATCHIE
 Permit #: GW-50064
 Driller: Chad Mattox
 Date completed: 7-18-17
 Copy information from block on Part 1

This part of the report must be completed by a licensed water well contractor or a licensed pump installer. A copy of Part 1 of the report must be attached and both parts filed with the Department at the above address within 30 days of well completion.

Well Owner Information	Well Location
Owner Name: <u>GARY TAYLOR</u>	Latitude: <u>33° 48.41'</u> Longitude: <u>90° 27.05'</u>
Mailing Address: <u>10355 Memphis Arlington Rd</u>	Method of Lat/Long (check one): Conventional Survey _____, USGS quad _____, Hand-held GPS _____, Survey-grade GPS _____
<u>Lakeland</u> <u>TN</u> <u>38002</u>	<u>SW 1/4 SW 1/4, Sec 31 T 23N R 02W</u>
City State Zip Code	<u>4.2</u> Miles <u>E</u> of <u>DREW</u>
Telephone No. <u>(901) 867-9905</u>	(Distance) (Direction) (Nearest Town)

Pump Type (circle one)

Submersible Turbine Air Lift Centrifugal Flowing Well Jet Piston Rotary Other (describe): _____

Date Pump Installed: 7-19-17 Rated Pump Capacity: 2200 Gallons Per Minute

Is This Pump (circle one): New Repaired Replacement USED

Power Type (circle one)

Electric Diesel Gasoline Natural Gas Tractor PTO Windmill Other (describe): _____

Horse Power Rating of Motor: 60 Setting Depth: 70 feet Number of Stages: 2

Pump Test Data for Non Flowing Well

Date Well Tested: _____ Duration of Pump Test (minimum 4 hours): _____ hours

Static Water Level (A): 38 Feet Below Land Surface Pumping Water Level (B): _____ Feet Below Land Surface

Drawdown [(B) - (A)]: _____ Feet Below Land Surface Test Pumping Rate: _____ Gallons Per Minute

Method of measurement (circle one): Steel tape Electric tape Air line Other (describe): _____

Pump Test Data for Flowing Well

Measured shut in head: _____ feet.

Well yielded _____ GPM with a drawdown of _____ feet after _____ hours of pumping

Meter Installation

Meter Manufacturer: _____ Meter Serial Number: _____

Meter Model Number/Name: _____ Type of Meter: _____

Totalizer Register Unit and Multiplier Factor (AF x .001, gal x 1000, etc): _____

Installation Date: _____ Meter installed by: _____

Is This Meter (circle one): New Repaired Replacement

Important: By submitting the above information you are certifying that this meter was installed to manufacturer standards. For agricultural wells, a list of approved meters is on the MDEQ website

RECEIVED
AUG 01 2017
BY OLWR

I HEREBY CERTIFY that the above statements are true to the best of my knowledge.

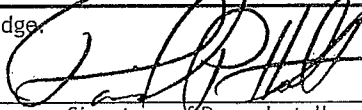
DAVID P. HOLT 0-752P 7-27-17 

Print Name of Pump Installer and License No. (if applicable) Date Signature of Pump Installer

17-0385