

DEQ

MISSISSIPPI DEPARTMENT OF ENVIRONMENTAL QUALITY
Office of Land and Water Resources
P. O. Box 2309
Jackson, MS 39225
Water Well Plugging/Decommissioning Form
OLWR-DF-1 (04/08)

no drill log

COUNTY WELL LOCATED: Tallahatchie	WELL NUMBER: H
PERMIT NUMBER: GW-00672	DATE WELL PLUGGED: 8-6-2019
NAME OF FIRM PLUGGING WELL: Irrigation Equipment Inc	TELEPHONE NUMBER: 662-887-2555
NAME AND ADDRESS OF CURRENT LANDOWNER: SPP, LLC P.O. Box 675 Webb, MS 38966	
WELL LOCATION: SECTION: 33 TOWNSHIP: 24N RANGE: 2W	
WELL LOCATION: LATITUDE: 33° 54' 33.7"N LONGITUDE: 90° 24' 27.8"W	METHOD (Check ONE): <input type="checkbox"/> USGS QUAD <input checked="" type="checkbox"/> CONVENTIONAL SURVEY <input type="checkbox"/> GPS - HAND HELD OR SURVEY GRADE
DISTANCE: DIRECTION: NEAREST TOWN: Webb OTHER LANDMARK:	
WELL PURPOSE (HOME, IRRIGATION, MUNICIPAL, ETC.): Irrigation	
NAME OF WELL CONTRACTOR WHO DRILLED THE WELL:	
NAME OF LANDOWNER WHEN WELL WAS DRILLED:	

RECEIVED
AUG 14 2019
BY OLWR

WELL DATA			
WELL DEPTH: 84'	HOLE DEPTH:		
CASING DIAMETER (IN.): 16	CASING LENGTH (FT.):	TYPE OF CASING: Steel	
DEPTH TO STATIC WATER LEVEL: 41	DATE WELL COMPLETED:		
WHY IS THE WELL BEING ABANDONED? Replaced			

DESCRIBE HOW THE WELL OR HOLE WAS PLUGGED (AMOUNT OF CASING AND/OR SCREEN THAT WAS REMOVED OR LEFT IN HOLE, MATERIAL AND AMOUNT USED IN PLUGGING, METHOD OF PLACING MATERIAL, ETC.)

Removed casing below ground level. Installed 5% chlorine bleach. Installed sand and gravel. Installed bentonite hole plug.

I CERTIFY THAT THE WELL WAS PLUGGED OR ABANDONED IN ACCORDANCE WITH THE STATE OF MISSISSIPPI REGULATIONS.

Patrick M Chism 0695
PRINT NAME MS LICENSE NUMBER
8-9-2019
SIGNATURE DATE

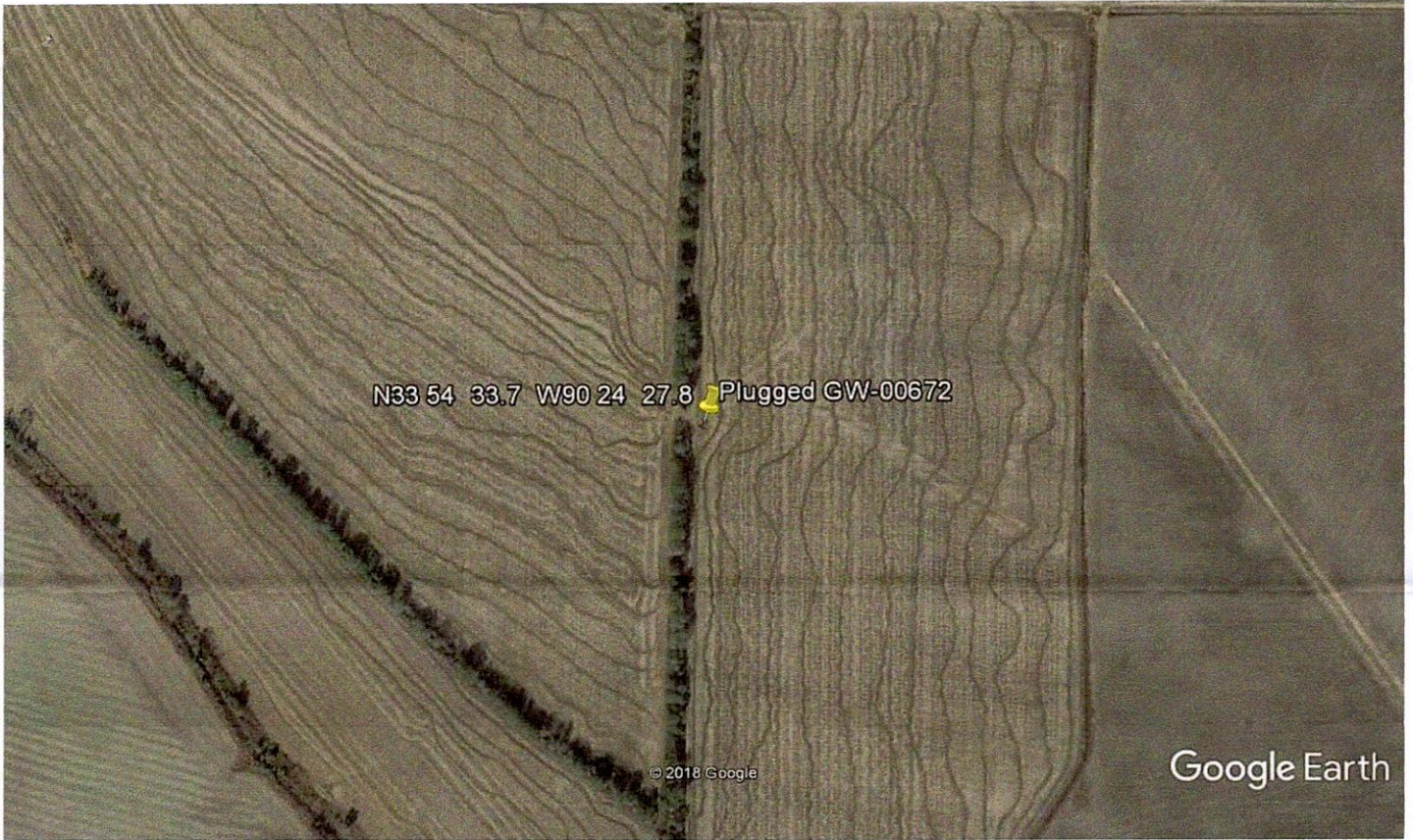

Google Earth



RECEIVED
AUG 14 2019
BY OLWR