

48225

County: Tallahatchie  
Permit #: GW-48225  
Driller: bel Jumper  
Date drilling completed: 6-15-14

State Well Report  
Part I - Driller's Log  
Mississippi Department of Environmental Quality  
Office of Land and Water Resources  
P.O. Box 2309  
Jackson, MS 39225  
(601)961-5210  
(601)961-5228 (fax)

For Office Use Only:  
Aquifer: \_\_\_\_\_  
Well #: F73  
L. S. Elevation: \_\_\_\_\_  
E-log #: \_\_\_\_\_

State Law requires that this report be prepared by the license holder responsible for the work and filed with the Department at the above address within 30 days of completion of drilling of the well or borehole.

Information on Well Owner (Landowner if borehole is not for a water well)	Well or Borehole Location
Owner Name: <u>Chat Williamson</u>	Latitude: <u>34° 02' 20"</u> Longitude: <u>90° 06' 27"</u>
Mailing Address: <u>313 Paducah</u>	Method of Lat/Long (circle one): Conventional Survey, USGS quad, Hand-held GPS, Survey-grade GPS
<u>Well Road</u>	USGS quad, Hand-held GPS, Survey-grade GPS
<u>Charleston Ms 38921</u>	<u>SW</u> 1/4 <u>NE</u> 1/4 Sec <u>17</u> Twp <u>25 N</u> Rng <u>02 E</u>
City State Zip Code	Distance Direction Nearest Town
Telephone No. ( ) _____	<u>3</u> Miles <u>SW</u> of <u>Charleston</u>

Well / Borehole Data

Date drilling started: 6-15-14 Date drilling completed: 6-15-14 Hole depth: 110 Hole diameter: 12

Location of the source of any surface water used for drilling: Nearest Well

Method of dosing and volume of Chlorine used in drilling and development: \_\_\_\_\_

Logs run (circle all applicable): No log run Electric Gamma Ray Density Sonic Neutron Other: \_\_\_\_\_

Name of organization running log(s): \_\_\_\_\_

Purpose of borehole (check one): Water Well \_\_\_\_\_  Geotechnical/Geological Investigation \_\_\_\_\_ Ground Source Heat Pump \_\_\_\_\_

Seismic Survey \_\_\_\_\_ Other (describe) \_\_\_\_\_

*If drilling is not related to water well construction, skip the remainder of this block*

Purpose of Well (check one): Home \_\_\_\_\_ Industrial \_\_\_\_\_ Public Supply \_\_\_\_\_ Irrigation  Fish Culture \_\_\_\_\_ Other: \_\_\_\_\_

If a flowing well, method of flow regulation: Valve \_\_\_\_\_ Other (describe) \_\_\_\_\_

Static Water Level: 10 feet above or below (circle one) land surface Date measured: 6-15-14

Method of Measurement (circle one) steel tape electric tape air line other: \_\_\_\_\_

Well depth: 110 Well grouted to a depth of 10 feet Type of grout (circle one): Neat Cement Bentonite Mix

Casing length: 70 feet Casing diameter: 12 inches Type of casing: pvc

Screen length: 40 feet Screen diameter: 12 inches Type of screen: pvc

Screen slot size: 0.50 inches Setting depth: From 0 feet to 60 feet

Type of completion (circle all applicable): Gravel packed Underreamed Telescoped Open hole Natural Development

Other (describe): \_\_\_\_\_

Top of lap pipe or reduction in casing: \_\_\_\_\_ feet. *If telescoped or more than one screen, describe on next page*

Form: OLWR-311  
**RECEIVED**  
JUL 22 2014  
BY OLWR

The sketch below only required for water wells

If well telescopes, show depths on sketch.

Ground Level →

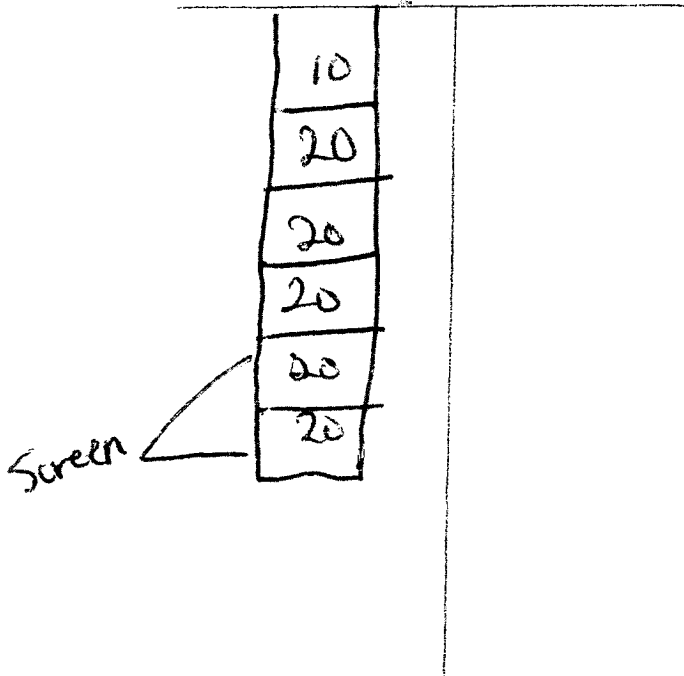

If more than one screen, show location of each on sketch

Description of formations encountered must be provided for all wells and boreholes, unless specifically exempted by regulations

Description of Formations Encountered	From (depth) Ground Level	To (depth)
Clay		20
Clay	20	40
sand	40	60
gravel	60	80
gravel	80	100
gravel	100	110

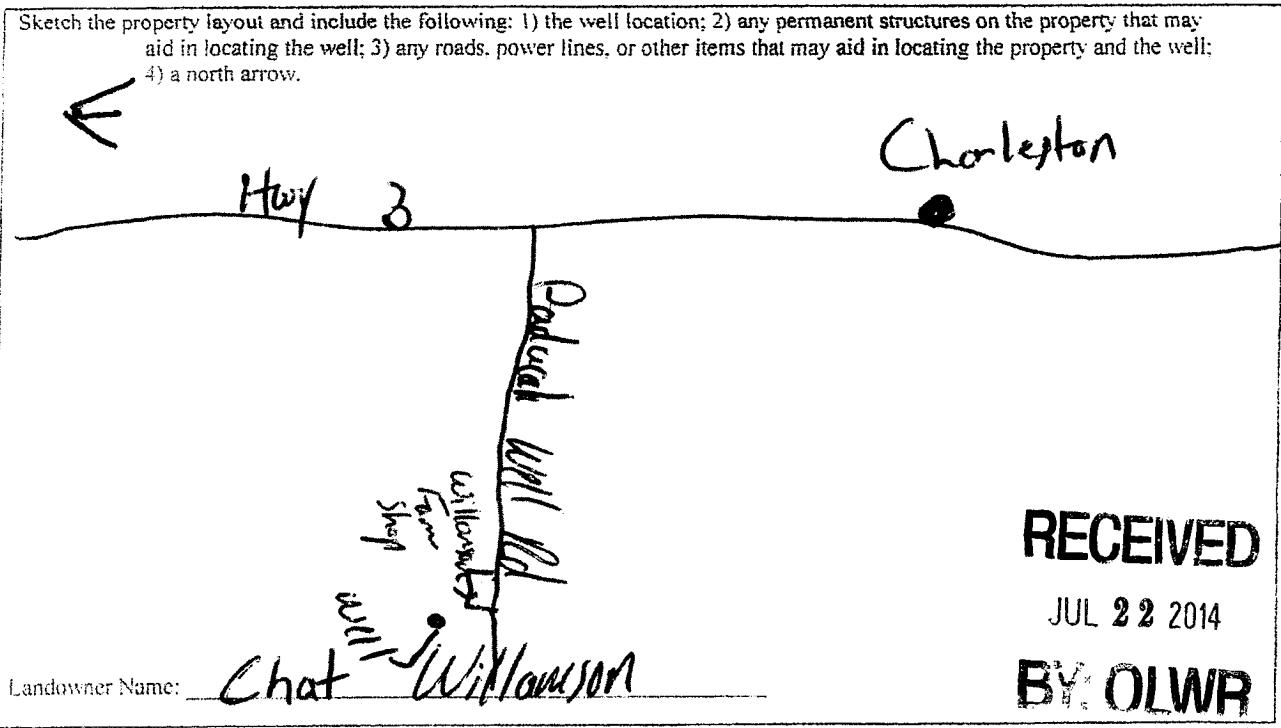

**RECEIVED**  
JUL 22 2014  
**BY OLWR**

Form: OLWR-SWR-1A (04/08)

I certify that the well/borehole was drilled, constructed, and completed in accordance with all applicable requirements of the Mississippi Department of Environmental Quality and the Mississippi Department of Health regulations, if applicable, and state laws.

Joel Jumper 5317 6-15-14   
Print Name of Responsible Licensee and License No.      Date      Signature of Licensee

# STATE WELL REPORT

## Part 2

**Pump Installer's Completion Report**  
 Mississippi Department of Environmental Quality  
 Office of Land and Water Resources  
 P.O. Box 2309  
 Jackson, MS 39225-2309  
 (601)961-5210  
 (601) 360-0535 (fax)

**For Office Use Only:**

Well #: \_\_\_\_\_

Aquifer: \_\_\_\_\_

County: TALLAHATCHIE  
 Permit #: GW-46225  
 Installer: BOLTED WELL SERVICE  
 Well Completed: 6.15.14  
 Copy information from block on Part 1

*This part of the report must be completed by a licensed water well contractor or a licensed pump installer. A copy of Part 1 of the report must be attached and both parts filed with the Department at the above address within 30 days of well completion.*

Well Owner Information	Well Location
Owner Name: <u>JERRY WILLIAMSON</u>	Latitude: <u>34° 02' 20"</u> Longitude: <u>90° 06' 27"</u>
Mailing Address: <u>321 PADUCAH WALLS RD</u>	Method of Lat/Long (check one): Conventional Survey _____, USGS quad _____, Hand-held GPS _____, Survey-grade GPS _____
<u>CHARLESTON</u> <u>MS</u> <u>38921</u>	<u>SW</u> ¼ <u>NE</u> ¼, Sec <u>17</u> T <u>25N</u> R <u>2E</u>
City State Zip Code	<u>3/4</u> Miles <u>NW</u> of <u>CHARLESTON</u>
Telephone No. (601) <u>647-1888</u>	(Distance) (Direction) (Nearest Town)

**Pump Type (circle one)**

Submersible  Turbine  Air Lift  Centrifugal  Flowing Well  Jet  Piston  Rotary  Other (describe): \_\_\_\_\_

Date Pump Installed: 6.16.14 Rated Pump Capacity: 850 Gallons Per Minute

Is This Pump (circle one):  New  Repaired  Replacement

**Power Type (circle one)**

Electric  Diesel  Gasoline  Natural Gas  Tractor PTO  Windmill  Other (describe): \_\_\_\_\_

Horse Power Rating of Motor: 15 Setting Depth: 60 feet Number of Stages: 1

**Pump Test Data for Non Flowing Well**

Date Well Tested: \_\_\_\_\_ Duration of Pump Test (minimum 4 hours): \_\_\_\_\_ hours

Static Water Level (A): 10 Feet Below Land Surface Pumping Water Level (B): \_\_\_\_\_ Feet Below Land Surface

Drawdown [(B) - (A)]: \_\_\_\_\_ Feet Below Land Surface Test Pumping Rate: \_\_\_\_\_ Gallons Per Minute

Method of measurement (circle one): Steel tape  Electric tape  Air line  Other (describe): \_\_\_\_\_

**Pump Test Data for Flowing Well**

Measured shut in head: \_\_\_\_\_ feet.

Well yielded \_\_\_\_\_ GPM with a drawdown of \_\_\_\_\_ feet after \_\_\_\_\_ hours of pumping

**Meter Installation**

Meter Manufacturer: N/A Meter Serial Number: \_\_\_\_\_

Meter Model Number/Name: \_\_\_\_\_ Type of Meter: \_\_\_\_\_

Totalizer Register Unit and Multiplier Factor (AF x .001, gal x 1000, etc): \_\_\_\_\_

Installation Date: \_\_\_\_\_ Meter installed by: \_\_\_\_\_

Is This Meter (circle one):  New  Repaired  Replacement

*Important: By submitting the above information you are certifying that this meter was installed to manufacturer standards. For agricultural wells, a list of approved meters is on the MDEQ website.*

I HEREBY CERTIFY that the above statements are true to the best of my knowledge.

DAVID P. HOLT 0-752P 7.7.14 [Signature]

Print Name of Pump Installer and License No. (if applicable) Date Signature of Pump Installer

**RECEIVED**  
 JUN 20 2014  
**BY: OLWR**

14-0220