

# State Well Report

Part 1

Mississippi Department of Environmental Quality  
Office of Land and Water Resources  
P.O. Box 10631  
Jackson, MS 39289-0631  
(601)961-5210  
(601)354-6938 (fax)

For Office Use Only:

Aquifer: \_\_\_\_\_  
Well #: F-57  
L. S. Elevation: \_\_\_\_\_  
E-log #: \_\_\_\_\_

County: Tallahatchie  
Permit #: \_\_\_\_\_  
Driller: Willie L Bryant  
Date drilling completed: 7-11-06

State Law requires that this report be prepared by the driller in detail and filed with the Department within 30 days of completion of drilling of the well.

Well Owner Information	Well Location
Owner Name: <u>Jessie Herrin</u>	Latitude: <u>34° 01' 19N</u> Longitude: <u>090° 03' 35W</u>
Mailing Address: <u>172 Teasdale Rd.</u>	Method of Lat/Long (circle one): Conventional Survey, USGS quad, <u>Hand-held GPS</u> , Survey-grade GPS
<u>Charleston MS 38921</u> City State Zip Code	<u>1/4</u> <u>1/4</u> Sec <u>23</u> Twn <u>25N</u> Rng <u>2E</u>
Telephone No. <u>(601) 647-0449</u>	Distance <u>1 1/2</u> Miles Direction <u>NE</u> of Nearest Town <u>Charleston</u> <u>Teasdale Rd.</u>

**Well Data**

Purpose of Well (circle one) Home Industrial Public Supply Irrigation Fish Culture Other: \_\_\_\_\_

Date well drilling started: 7-11-06 Date well drilling completed: 7-11-06

If flowing, method of flow regulation: Valve \_\_\_\_\_ Other (describe) \_\_\_\_\_

Static Water Level: 16' feet above or (below) (circle one) land surface Date measured: 7-15-06

Method of Measurement (circle one) steel tape electric tape air line other: Rope & weight

Hole depth: 150' Well depth: 150' Well grouted to a depth of 10' feet

Type of grout (circle one): Cement Bentonite Mix

Casing length: 130 feet Casing diameter: 4 inches Type of casing: PVC 160

Screen length: 20 feet Screen diameter: 4 inches Type of screen: PVC slotted

Screen slot size: .013 inches Setting depth: From 78-88 feet to 120-130 feet  
10ft. 10ft.

Type of completion (circle all applicable): Gravel packed Underreamed Telescoped Open hole Natural Development

Other (describe): \_\_\_\_\_

Top of lap pipe or reduction in casing: 0 feet. If telescoped or more than one screen, describe on back of page

Logs run (circle all applicable): No log run Electric Gamma Ray Density Sonic Neutron Other: \_\_\_\_\_

Name of organization running log(s): \_\_\_\_\_

I certify that the well was drilled, constructed, and completed in accordance with all applicable requirements of the Mississippi Department of Environmental Quality and/or the Mississippi Department of Health regulations and state laws.

Willie L Bryant 0-639  
Print Name of Water Well Contractor and License No.

Willie L Bryant  
Signature of Water Well Contractor

RECEIVED  
AUG 10 2006  
BY: OLWR

If well telescopes please sketch below and show depths.

Ground Level

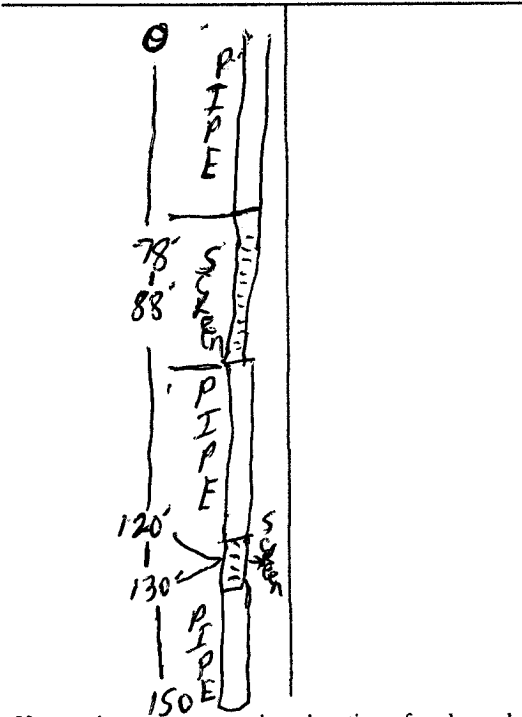

Description of Formations Encountered	From	To
Red clay & gravel	0	20
Red gravel	20	40
Clay	40	60
Clay & gravel	60	78
gravel	78	88
clay & fine sand	88	100
Med. Sand & clay	100	115
" " Sand & clay	115	120
Sand & clay	120	140
Clay	140	150

If more than one screen, show location of each on sketch

Sketch the property layout and include the following: 1) the well location; 2) any permanent structures on the property that may aid in locating the well; 3) any roads, power lines, or other items that may aid in locating the property and the well; 4) indicate direction.

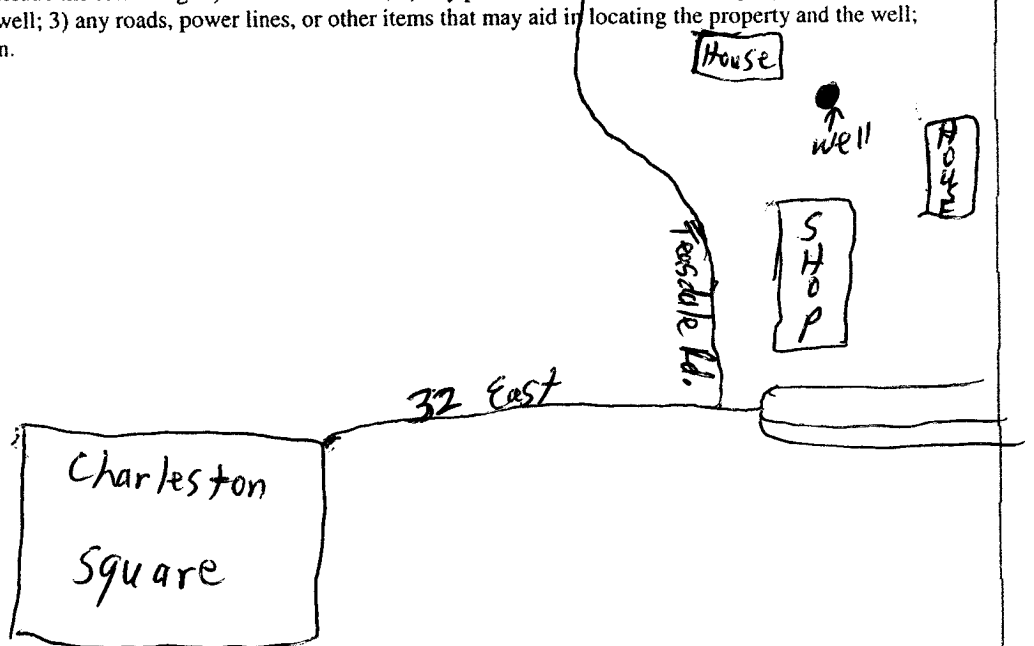

Landowner Name: Jessie Herrin

Willy L. Bryant  
 Signature of Water Well Contractor

RECEIVED  
 AUG 10 2006  
 BY: OLWR

# STATE WELL REPORT

## Part 2

**Pump Installer's Completion Report**  
 Mississippi Department of Environmental Quality  
 Office of Land and Water Resources  
 P.O. Box 10631  
 Jackson, MS 39289-0631  
 (601)961-5210  
 (601)354-6938 (fax)

For Office Use Only:

Aquifer: \_\_\_\_\_

Well #: F-57

Elevation: \_\_\_\_\_

County: Tallahatchie

Permit #: \_\_\_\_\_

Driller: Willie L. Bryant

Date completed: 7-15-06

**This report should be prepared by the pump installer in detail and filed with the Department within 30 days of the installation of pump.**

Well Owner Information	Well Location
Owner Name: <u>Jessie Herrin</u>	Latitude: <u>34° 01.19 N</u> Longitude: <u>090° 03.35 W</u>
Mailing Address: <u>172 Teasdale Rd.</u>	Method of Lat/Long (circle one): Conventional Survey,
<u>Charleston MS 38921</u>	USGS quad. <u>Hand-held GPS</u> , Survey-grade GPS
City State Zip Code	_____ 1/4 _____ 1/4 Sec <u>23</u> Twn <u>25 N</u> Rng <u>2 E</u>
Telephone No. ( <u>662</u> ) <u>647-0449</u>	Distance Direction Nearest Town
	<u>1 1/2</u> Miles <u>NE</u> of <u>Charleston</u> <u>Teasdale Rd.</u>

Pump Type Circle one	Power Type Circle one
Air Lift Jet <input type="radio"/> <u>Submersible</u> <input type="radio"/>	Diesel Engine Gasoline Engine Natural Gas
Bucket Piston Turbine	<u>Electric Motor</u> <input type="radio"/> Hand Tractor PTO
Centrifugal Rotary Flowing Well	Windmill Other (specify): _____
Other (specify): _____	Horse Power Rating of Motor: <u>1 HP</u>
Date Pump Installed: <u>7-15-06</u>	Setting Depth: <u>80</u> feet
Rated Pump Capacity: <u>20</u> Gallons Per Minute	Number of Stages: <u>8</u>

Pump Test Data	Method of Measuring Water Level Circle one
Date Well Tested: <u>7-15-06</u>	Air Line Electric Measuring Line Steel Tape
Static Water Level (A): <u>16'</u> Feet Below Land Surface	Other (specify): <u>Rope &amp; Weight</u>
Pumping Water Level (B): <u>18</u> Feet Below Land Surface	For flowing well, measured shut in head: _____ feet
Drawdown [(B) - (A)]: <u>2</u> Feet Below Land Surface	Well yielded <u>20</u> GPM with a drawdown of
Test Pumping Rate: <u>20</u> Gallons Per Minute	<u>2</u> feet after <u>4</u> hours of pumping
Duration of Pump Test (minimum 4 hours): <u>4</u> hours	

I HEREBY CERTIFY that the above statements are true to the best of my knowledge.

Willie L. Bryant 0-639  
 Print Name of Pump Installer and License No. (if applicable)

Willie L. Bryant  
 Signature of Pump Installer

**RECEIVED**  
 AUG 10 2006  
 BY: OLWR