

# STATE WELL REPORT

## Part 1

### Driller's Log

Mississippi Department of Environmental Quality  
Office of Land and Water Resources  
P.O. Box 2309  
Jackson, MS 39225-2309  
(601)961-5210  
(601)360-0535 (fax)

#### For Office Use Only:

Well #: E83  
Aquifer: \_\_\_\_\_  
E-Log #: \_\_\_\_\_

County: Tallahatchie  
Permit #: GW-50090 ✓  
Driller: Chad Mattox  
Date drilling completed: 7/1/17

*State Law requires that this report be prepared by the license holder responsible for the work and filed with the Department at the above address within 30 days of completion of drilling of the well or borehole.*

Well Owner Information <small>(Landowner if borehole is not for a water well)</small>	Well or Borehole Location
Owner Name: <u>MALLARD ALLEY</u>	Latitude: <u>34-01-14.8</u> Longitude: <u>90-13-34.79</u>
Mailing Address: <u>PO Box 428</u>	Method of Lat/Long (check one): Conventional Survey _____, Hand-held GPS <input checked="" type="checkbox"/> , Survey-grade GPS _____
<u>MERIGOLD</u> <u>MS</u> <u>38759</u>	USGS quad _____, NE <input checked="" type="checkbox"/> SE <input checked="" type="checkbox"/> Sec <u>19</u> T <u>25N</u> R <u>01E</u>
City State Zip Code	<u>3/4</u> Miles <u>E</u> of <u>BRAZIL</u>
Telephone No. (____) _____	(Distance) (Direction) (Nearest Town)

Well / Borehole Data
Date drilling started: <u>7/1/17</u> Date drilling completed: <u>7/1/17</u> Hole depth: <u>101'</u> Hole diameter: <u>24"</u>
Location of the source of any surface water used for drilling: <u>NEARBY DITCH</u>
Method of dosing and volume of Chlorine used in drilling and development: _____
Logs run (circle all applicable): <u>No log run</u> Electric Gamma Ray Density Sonic Neutron Other: _____
Name of organization running log(s): _____
Purpose of borehole (circle one): <u>Water Well</u> Geotechnical/Geological Investigation Ground Source Heat Pump Seismic Survey Other (describe) _____
<i>If drilling is not related to water well construction, skip the remainder of this block</i>
Purpose of Well (circle all applicable): Home Industrial Public Supply <u>Irrigation</u> Fish Culture
Other (describe): <u>Replaces MS-GW-36289</u>
If a flowing well, method of flow regulation: Valve _____ Other (describe) _____
Static Water Level: <u>31</u> feet [above or below] land surface Date measured: <u>7/1/17</u> <small>(circle one)</small>
Method of measurement (circle one): <u>Steel tape</u> Electric tape Air line Other (describe): _____
Well depth: <u>101'</u> Well grouted to a depth of: <u>10</u> feet Type of grout (circle one): Neat Cement <u>Bentonite</u> Mix
Casing length: <u>61</u> feet Casing diameter: <u>16</u> inches Type of casing: <u>PVC</u>
Screen length: <u>40</u> feet Screen diameter: <u>16</u> inches Type of screen: <u>PVC</u>
Screen slot size: <u>.050</u> inches Setting depth: From <u>61</u> feet to <u>100</u> feet
Type of completion (circle all applicable): <u>Gravel packed</u> Underreamed Open hole Natural Development
Other (describe): _____
Top of lap pipe or reduction in casing: _____ feet
<i>If telescoped or more than one screen, describe on next page</i>



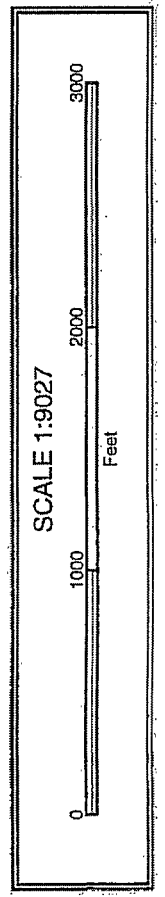
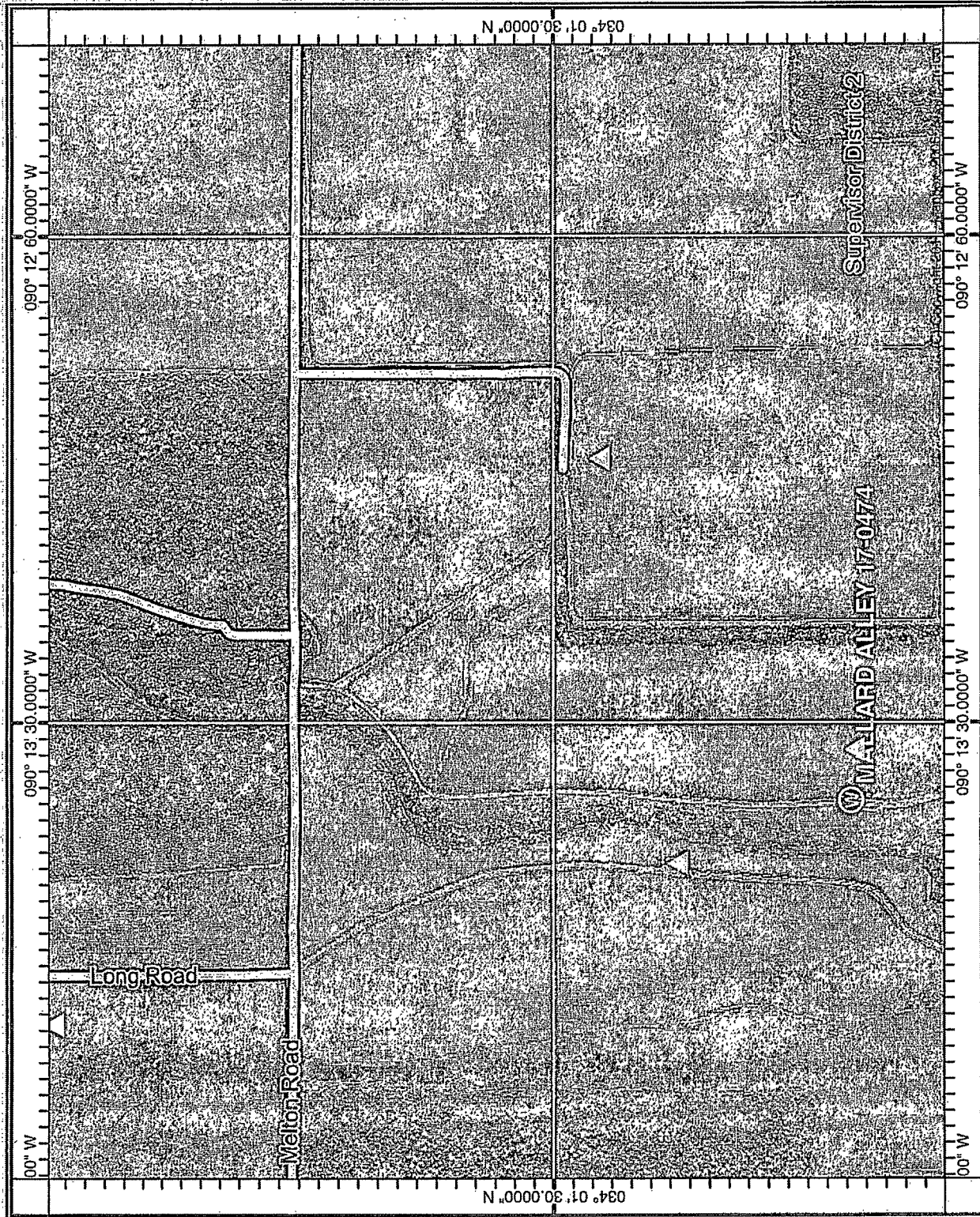

RECEIVED  
 AUG 04 2017  
 BY ULWR

# STATE WELL REPORT

## Part 2

**Pump Installer's Completion Report**  
 Mississippi Department of Environmental Quality  
 Office of Land and Water Resources  
 P.O. Box 2309  
 Jackson, MS 39225-2309  
 (601)961-5210  
 (601) 360-0535 (fax)

County: TALLAHATCHEE  
 Permit #: GW-50090  
 Driller: CHAO MATTOX  
 Date completed: 7-1-17  
Copy information from block on Part 1

**For Office Use Only:**

Well #: E83  
 Aquifer: \_\_\_\_\_

*This part of the report must be completed by a licensed water well contractor or a licensed pump installer. A copy of Part 1 of the report must be attached and both parts filed with the Department at the above address within 30 days of well completion.*

Well Owner Information	Well Location
Owner Name: <u>MALLARD ALLEY</u>	Latitude: <u>34° 01' 15"</u> Longitude: <u>90° 13' 32"</u>
Mailing Address: <u>P.O. BOX 428</u>	Method of Lat/Long (check one): Conventional Survey _____, USGS quad _____, Hand-held GPS _____, Survey-grade GPS _____
<u>MERIGOLD</u> City <u>MS</u> State <u>38759</u> Zip Code	<u>NE</u> ¼ <u>SE</u> ¼, Sec <u>19</u> T <u>25N</u> R <u>01E</u>
Telephone No. (____) _____	<u>3</u> Miles <u>E</u> of <u>BLAZEL</u> (Distance) (Direction) (Nearest Town)

**Pump Type (circle one)**

Submersible  Turbine    Air Lift    Centrifugal    Flowing Well    Jet    Piston    Rotary    Other (describe): \_\_\_\_\_

Date Pump Installed: 7-3-17      Rated Pump Capacity: 2200 Gallons Per Minute

Is This Pump (circle one):  New    Repaired    Replacement

**Power Type (circle one)**

Electric    Diesel    Gasoline    Natural Gas    Tractor PTO    Windmill    Other (describe): \_\_\_\_\_

Horse Power Rating of Motor: 60      Setting Depth: 60 feet      Number of Stages: 2

**Pump Test Data for Non Flowing Well**

Date Well Tested: \_\_\_\_\_      Duration of Pump Test (minimum 4 hours): \_\_\_\_\_ hours

Static Water Level (A): 31 Feet Below Land Surface      Pumping Water Level (B): \_\_\_\_\_ Feet Below Land Surface

Drawdown [(B) - (A)]: \_\_\_\_\_ Feet Below Land Surface      Test Pumping Rate: \_\_\_\_\_ Gallons Per Minute

Method of measurement (circle one): Steel tape    Electric tape    Air line    Other (describe): \_\_\_\_\_

**Pump Test Data for Flowing Well**

Measured shut in head: \_\_\_\_\_ feet.

Well yielded \_\_\_\_\_ GPM with a drawdown of \_\_\_\_\_ feet after \_\_\_\_\_ hours of pumping.

**Meter Installation**

Meter Manufacturer: \_\_\_\_\_      Meter Serial Number: \_\_\_\_\_

Meter Model Number/Name: \_\_\_\_\_      Type of Meter: \_\_\_\_\_

Totalizer Register Unit and Multiplier Factor (AF x .001, gal x 1000, etc): \_\_\_\_\_

Installation Date: \_\_\_\_\_      Meter installed by: \_\_\_\_\_

Is This Meter (circle one):    New    Repaired    Replacement

*Important: By submitting the above information you are certifying that this meter was installed to manufacturer standards. For agricultural wells, a list of approved meters is on the MDEQ website.*

I HEREBY CERTIFY that the above statements are true to the best of my knowledge.

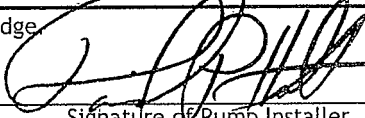
DAVID P. HOLT 0-752P      7-17-17      

Print Name of Pump Installer and License No. (if applicable)      Date      Signature of Pump Installer

RECEIVED  
 JUL 21 2017  
 BY: OLWR

17-0121