

Replaces 07613

County: Sunflower
 Permit #: GW-50123
 Driller: Irrigation Equipment, Inc.
 Date drilling completed: 7-18-17

STATE WELL REPORT
Part 1
Driller's Log
 Mississippi Department of Environmental Quality
 Office of Land and Water Resources
 P.O. Box 2309
 Jackson, MS 39225-2309
 (601) 961-5210
 (601) 360-0535 (fax)

For Office Use Only:
 Well #: T188
 Aquifer: _____
 E-Log #: _____

State Law requires that this report be prepared by the license holder responsible for the work and filed with the Department at the above address within 30 days of completion of drilling of the well or borehole.

Well Owner Information <i>(Landowner if borehole is not for a water well)</i>	Well or Borehole Location
Owner Name: <u>Lester Myers</u>	Latitude: <u>33° 16' 36.4"N</u> Longitude: <u>90° 33' 56.7"W</u>
Mailing Address: <u>P.O. Box 878</u>	Method of Lat/Long (check one): <input type="checkbox"/> Conventional Survey, <input type="checkbox"/> USGS quad, <input checked="" type="checkbox"/> Hand-held GPS, <input type="checkbox"/> Survey-grade GPS
<u>Indianola</u> <u>MS</u> <u>38751</u> City State Zip code	<u>NE</u> <u>SW</u> <u>SE</u> <u>NW</u> <u>36</u> <u>T</u> <u>17N</u> <u>R</u> <u>4W</u>
Telephone No. <u>() -</u>	<u>SE</u> of <u>Caile</u> (Distance) (Direction) (Nearest Town)

Well / Borehole Data

Date drilling started: 7-18-17 Date drilling completed: 7-18-17 Hole depth: 138' Hole diameter: 24"

Location of the source of any surface water used for drilling: Surface Water

Method of dosing and volume of Chlorine used in drilling and development: 50 PPM

Logs run (check all applicable): No log run Electric Gamma Ray Density Sonic Neutron Other: _____

Name of organization running log(s): _____

Purpose of borehole (check one): Water Well Geotechnical/Geological Investigation Ground Source Heat Pump
 Seismic Survey Other (describe) _____

If drilling is not related to water well construction, skip the remainder of this block

Purpose of Well (check all applicable): Home Industrial Public Supply Irrigation Fish Culture
 Other (describe): _____

If a flowing well, method of flow regulation: Valve _____ Other (describe) _____

Static Water Level: 39 feet [above or below] land surface Date measured: 7-19-17
(check one)

Method of Measurement (check one) Steel tape Electric tape Air line Other: (describe) _____

Well depth: 138' Well grouted to a depth of: 10 feet Type of grout (check one): Neat Cement Bentonite Mix

Casing length: 98 feet Casing diameter: 16 inches Type of casing: PVC

Screen length: 40 feet Screen diameter: 16 inches Type of screen: PVC

Screen slot size: .050 inches Setting depth: From 99 feet to 138 feet

Type of completion (check all applicable): Gravel packed Underreamed Open hole Natural Development
 Other (describe): _____

Top of lap pipe or reduction in casing: _____ Feet

If telescoped or more than one screen, describe on next page

Form: OLWR-SWR-1A (4/13)

RECEIVED
 AUG 31 2017
 BY OLWR

1. The first part of the document discusses the importance of maintaining accurate records of all transactions and activities. It emphasizes the need for transparency and accountability in financial reporting.

2. The second part of the document outlines the various methods used to collect and analyze data. It includes a detailed description of the sampling techniques employed and the statistical tests used to evaluate the results.

3. The third part of the document presents the findings of the study. It shows that there is a significant correlation between the variables being studied, and that the results are consistent across different groups and time periods.

4. The fourth part of the document discusses the implications of the findings for practice and policy. It suggests that the results can be used to inform decision-making and to develop more effective strategies for improving performance.

5. The fifth part of the document concludes the study and provides a summary of the key points. It also identifies some of the limitations of the study and suggests areas for further research.

County: Sunflower
 Permit #: GW-50123
 Driller: Irrigation Equipment, Inc.
 Date drilling completed: 7-18-17
Copy information from block on Part 1

STATE WELL REPORT
Part 2
Pump Installer's Completion Report
 Mississippi Department of Environmental Quality
 Office of Land and Water Resources
 P.O. Box 2309
 Jackson, MS 39225-2309
 (601) 961-5210
 (601) 360-0535 (fax)

For Office Use Only:

Well #: T188
 Aquifer: _____

This part of the report must be completed by a licensed water well contractor or a licensed pump installer. A copy of Part 1 of the report must be attached and both parts filed with the Department at the above address within 30 days of well completion.

Well Owner Information	Well Location
Owner Name: <u>Lester Myers</u>	Latitude: <u>33° 16' 36.4"N</u> Longitude: <u>90° 33' 56.7"W</u>
Mailing Address: <u>P.O. Box 878</u>	Method of Lat/Long (check one): <input type="checkbox"/> Conventional Survey, <input type="checkbox"/> USGS quad, <input checked="" type="checkbox"/> Hand-held GPS, <input type="checkbox"/> Survey-grade GPS
<u>Indianola</u> <u>MS</u> <u>38751</u>	<u>NE ¼ SW ¼, Sec 36 T 17N R 4W</u>
City State Zip code	<u> </u> Miles <u>SE</u> of <u>Caile</u>
Telephone No. <u>() -</u>	(Distance) (Direction) (Nearest Town)

Pump Type (check one)

Submersible Turbine Air Lift Centrifugal Flowing Well Jet Piston Rotary Other (describe): _____

Date Pump Installed 7-19-17 Rated Pump Capacity: 2100+/- Gallons Per Minute

Is This Pump (check one): New Repaired Replacement

Power Type (check one)

Electric Diesel Gasoline Natural Gas Tractor PTO Windmill Other (describe): _____

Horse Power Rating of Motor: 60 Setting Depth: 70 feet Number of Stages: 1

RECEIVED
 AUG 31 2017
 BY CLW

Pump Test Data for Non Flowing Well

Date Well Tested: _____ Duration of Pump Test (minimum 4 hours): _____ Hours

Static Water Level (A): _____ Feet Below Land Surface Pumping Water Level (B): _____ Feet Below Land Surface

Drawdown [(B) - (A)]: _____ Feet Below Land Surface Test Pumping Rate: _____ Gallons Per Minute

Method of measurement (check one): Steel tape Electric tape Air line Other (describe): _____

Pump Test Data for Flowing Well

Measured shut in head: _____ Feet

Well yielded _____ GPM with a drawdown of _____ feet after _____ hours of pumping

Meter Installation

Meter Manufacturer: _____ Meter Serial Number: _____

Meter Model Number/Name: _____ Type of Meter: _____

Totalizer Register Unit and Multiplier Factor (AF x .001, gal x 1000, etc): _____

Installation Date: _____ Meter installed by: _____

Is This Meter (check one): New Repaired Replacement

*Important: By submitting the above information you are certifying that this meter was installed to manufacturer standards.
 For agricultural wells, a list of approved meters is on the MDEQ website.*

I HEREBY CERTIFY that the above statements are true to the best of my knowledge.

0695 8-24-17
 Print Name of Pump Installer and License No. (if applicable) Date Signature of Pump Installer

Form: OLWR-SWR-1B (4/13)



P. O. Box 129
Stoneville, MS 38776
Tel.: (662) 686-7712
Fax: (662) 686-9078
www.ymd.org

Yazoo Mississippi Delta Joint Water Management District

August 23, 2017

Lester Myers
PO Box 873
Indianola MS 38751

RE: Receipt for Notification of Construction of Replacement Well **ME-GW-50123**
which will be replacing GW-07613 located at
Location: SE ¼ of the NW ¼ Section 36 Township 17N Range 04W County Sunflower
Latitude: 33 16 35 Longitude 90 33 56

Dear Lester Myers:

This letter acknowledges your notification to the state that you intend to replace a previously permitted well in the Mississippi River Valley Alluvial Aquifer and that this replacement construction will meet the requirements for a groundwater replacement well specified in 11 Miss. Admin. Code Part 7, Chapter 1, Rule 1.4.F.1 (see attached/back of page). Construction may begin immediately on your replacement well.

Remember that you are still required to submit a permit application (enclosed) for the replacement well within 5 days of construction beginning. You are also required to properly decommission (plug and abandon) the replaced well within 180 days of the replacement well's construction.

A copy of this letter, or a water use permit for the replacement well, must be attached to the State Well Report submitted by your driller to MDEQ and they must also submit a copy to YMD, as specified in the Water Well Contractor regulations found in 11 Miss. Admin. Code Part 7, Chapter 2, Rule 2.9.

If you have any questions, please call YMD at 662-686-7712.

Sincerely,

Dillard Melton, Jr
Permitting Director

T188

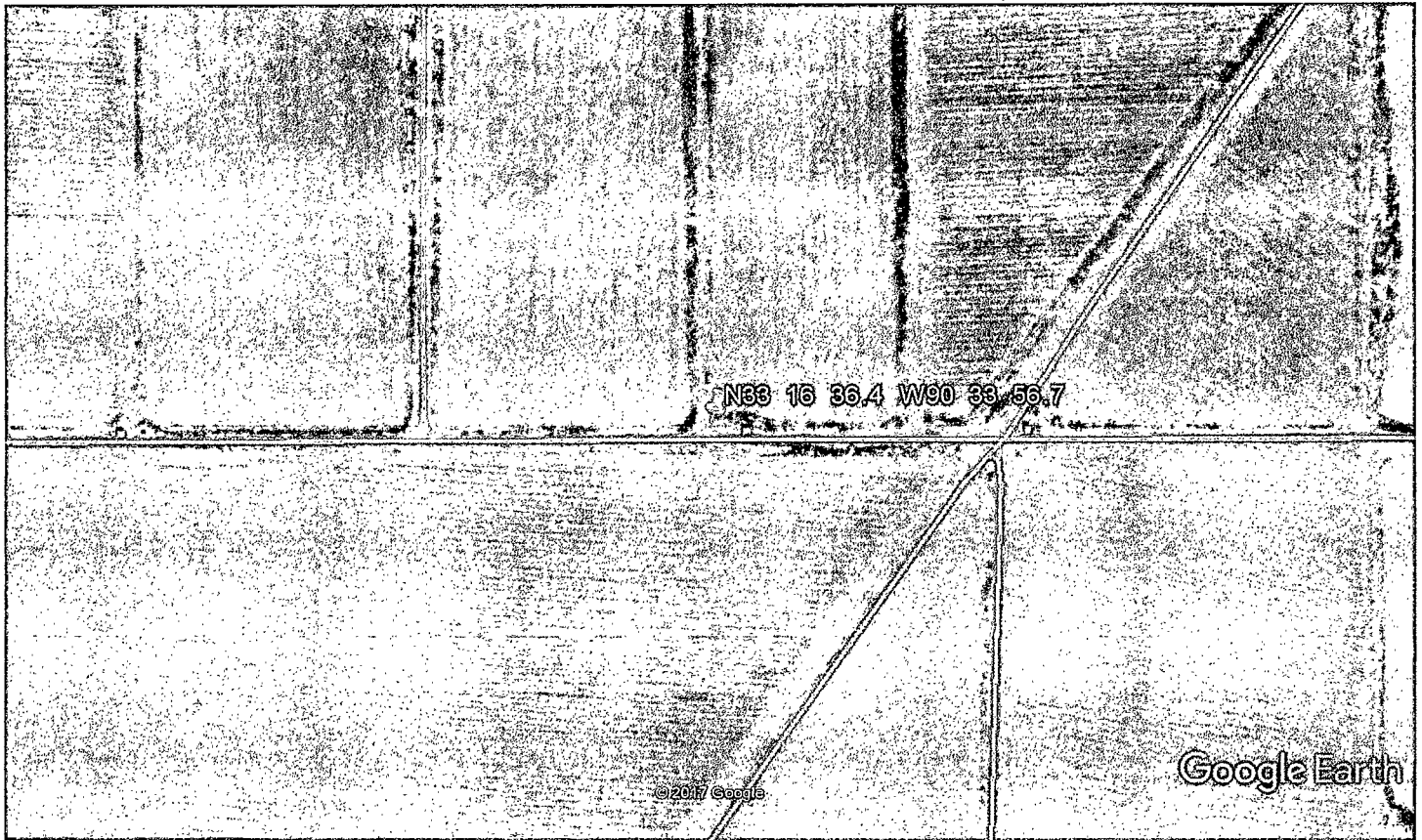

Google Earth



RECEIVED
AUG 31 2017
BY OLWR