

Sunflower

105

County: Humphreys
 Permit #: GW-50939
 Driller: Jonathan Gordon
 Date drilling completed: 9-12-19

STATE WELL REPORT

Part 1

Driller's Log

Mississippi Department of Environmental Quality
 Office of Land and Water Resources
 P.O. Box 2309
 Jackson, MS 39225-2309
 (601)961-5210
 (601)360-0535 (fax)

For Office Use Only:
 Well #: S 150
 Aquifer: _____
 E-Log #: _____

State Law requires that this report be prepared by the license holder responsible for the work and filed with the Department at the above address within 30 days of completion of drilling of the well or borehole.

Well Owner Information (Landowner if borehole is not for a water well)	Well or Borehole Location
Owner Name: <u>Dutch Brake Fisheries</u>	Latitude: <u>33° 16' 33.47"</u> Longitude: <u>90° 41' 57.30"</u>
Mailing Address: <u>4024 Money Sunk Rd</u>	Method of Lat/Long (check one): Conventional Survey _____
<u>Yazoo City MS 39194</u>	USGS quad _____, Hand-held GPS <input checked="" type="checkbox"/> , Survey-grade GPS _____
City State Zip Code	<u>NW 1/4 SE 1/4, Sec 39 T 17N R 05W</u>
Telephone No. <u>(662) 571-7213</u>	<u>6.38</u> Miles <u>West</u> of <u>Isola</u> (Distance) (Direction) (Nearest Town)

Well / Borehole Data

Date drilling started: 9-12-19 Date drilling completed: 9-12-19 Hole depth: 125' Hole diameter: 26"

Location of the source of any surface water used for drilling: Pond nearby

Method of dosing and volume of Chlorine used in drilling and development: _____

Logs run (circle all applicable): No log run Electric Gamma Ray Density Sonic Neutron Other: _____

Name of organization running log(s): _____

Purpose of borehole (circle one): Water Well Geotechnical/Geological Investigation Ground Source Heat Pump
 Seismic Survey Other (describe) _____

If drilling is not related to water well construction, skip the remainder of this block

Purpose of Well (circle all applicable): Home Industrial Public Supply Irrigation Fish Culture

Other (describe): _____

If a flowing well, method of flow regulation: Valve _____ Other (describe) _____

Static Water Level: 29 feet [above or below] land surface Date measured: 9-13-19
(circle one)

Method of measurement (circle one): Steel tape Electric tape Air line Other (describe): _____

Well depth: 125' Well grouted to a depth of: 10 feet Type of grout (circle one): Neat Cement Bentonite Mix

Casing length: 75 feet Casing diameter: 16 inches Type of casing: PVC

Screen length: 50 feet Screen diameter: 16 inches Type of screen: PVC

Screen slot size: .050 inches Setting depth: From 75 feet to 125 feet

Type of completion (circle all applicable): Gravel packed Underreamed Open hole Natural Development

Other (describe): _____

Top of lap pipe or reduction in casing: N/A feet

If telescoped or more than one screen, describe on next page

County: Humphreys
Permit #: GW-50939

For Office Use Only:
Well #: _____

The sketch below only required for water wells

If well telescopes, show depths on sketch.

Description of formations encountered must be provided for all wells and boreholes, unless specifically exempted by regulations

Ground Level \rightarrow

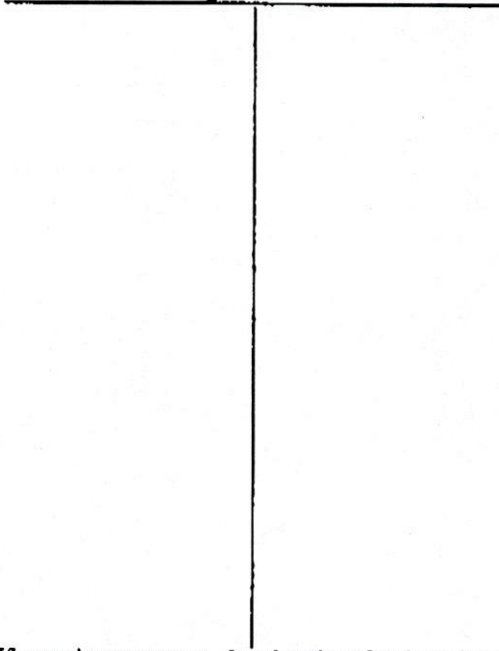

Description of Formations Encountered	From (depth)	To (depth)
Top Soil + Clay	Ground level	15
Sand + Clay	15	25
Med. Sand	25	35
Med. Sand	35	45
Med. / Fine Sand	45	55
Med / Coarse Sand	55	65
Coarse Sand	65	75
Coarse Sand	75	85
Coarse gravel	85	95
Coarse gravel	95	105
Med Coarse Sand	105	115
Med. Sand	115	125

If more than one screen, show location of each on sketch

Sketch the property layout and include the following:

- 1) the well location
- 2) any permanent structures on the property that may aid in locating the well
- 3) any roads, power lines, or other items that may aid in locating the property and the well
- 4) north arrow

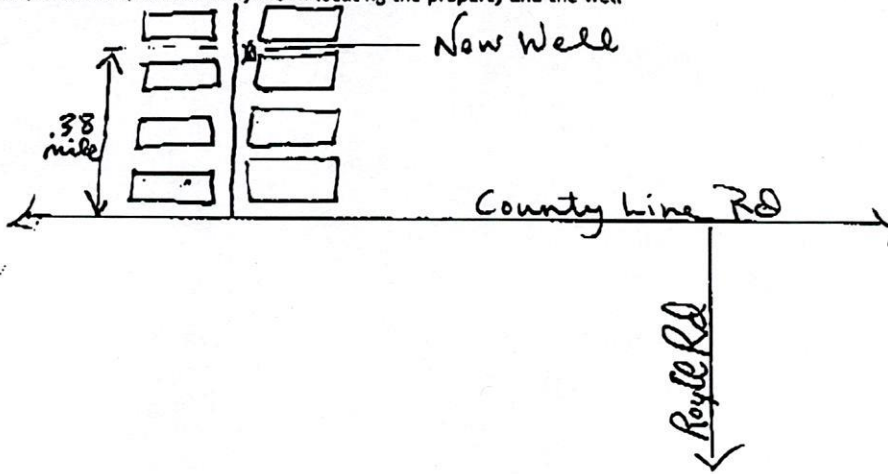

Landowner Name: Dutch Brake Fisheries

I HEREBY CERTIFY that the well/borehole was drilled, constructed, and completed in accordance with all applicable requirements of the Mississippi Department of Environmental Quality and the Mississippi Department of Health regulations, if applicable, and state laws.

Peyton Overstreet 00008076
Print Name of Responsible Licensee and License No.

9-19-19
Date

Peyton Overstreet
Signature of Licensee

STATE WELL REPORT

Part 2

Pump Installer's Completion Report
 Mississippi Department of Environmental Quality
 Office of Land and Water Resources
 P.O. Box 2309
 Jackson, MS 39225-2309
 (601)961-5210
 (601) 360-0535 (fax)

For Office Use Only:

Well #: S 150
 Aquifer: _____

County: Humphreys
 Permit #: GW-50939
 Driller: Jonathan Gordon
 Date completed: 9-13-19
Copy information from block on Part 1

This part of the report must be completed by a licensed water well contractor or a licensed pump installer. A copy of Part 1 of the report must be attached and both parts filed with the Department at the above address within 30 days of well completion.

Well Owner Information			Well Location		
Owner Name: <u>Dutch Brake Fisheries</u>			Latitude: <u>33° 16' 33.47"</u> Longitude: <u>90° 41' 57.30"</u>		
Mailing Address: <u>4024 Money Sunk Rd</u>			Method of Lat/Long (check one): Conventional Survey _____, USGS quad _____, Hand-held GPS <input checked="" type="checkbox"/> , Survey-grade GPS _____		
<u>Yazoo City</u> City	<u>MS</u> State	<u>39194</u> Zip Code	NW ^{NE} ¼ SE ¼, Sec <u>34</u> T <u>17N</u> R <u>05W</u>		
Telephone No. (662) <u>571-7213</u>			6.38 Miles <u>West</u> of <u>Isola</u> (Distance) (Direction) (Nearest Town)		

Pump Type (circle one)
 Submersible Turbine Air Lift Centrifugal Flowing Well Jet Piston Rotary Other (describe): _____
 Date Pump Installed: 9-13-19 Rated Pump Capacity: 1800 Gallons Per Minute
 Is This Pump (circle one): New Repaired Replacement

Power Type (circle one)
 Electric Diesel Gasoline Natural Gas Tractor PTO Windmill Other (describe): _____
 Horse Power Rating of Motor: 40 Setting Depth: 70 feet Number of Stages: 2

Pump Test Data for Non Flowing Well
 Date Well Tested: NOT TESTED Duration of Pump Test (minimum 4 hours): N/A hours
 Static Water Level (A): 29 Feet Below Land Surface Pumping Water Level (B): N/A Feet Below Land Surface
 Drawdown ((B) - (A)): N/A Feet Below Land Surface Test Pumping Rate: N/A Gallons Per Minute
 Method of measurement (circle one): Steel tape Electric tape Air line Other (describe): _____

Pump Test Data for Flowing Well
 Measured shut in head: _____ feet.
 Well yielded _____ GPM with a drawdown of _____ feet after _____ hours of pumping

Meter Installation N/A
 Meter Manufacturer: _____ Meter Serial Number: _____
 Meter Model Number/Name: _____ Type of Meter: _____
 Totalizer Register Unit and Multiplier Factor (AF x .001, gal x 1000, etc): _____
 Installation Date: _____ Meter installed by: _____
 Is This Meter (circle one): New Repaired Replacement
Important: By submitting the above information you are certifying that this meter was installed to manufacturer standards. For agricultural wells, a list of approved meters is on the MDEQ website.

I HEREBY CERTIFY that the above statements are true to the best of my knowledge.
Peyton Overstreet 0008026 9/19/19 Peyton Overstreet
 Print Name of Pump Installer and License No. (if applicable) Date Signature of Pump Installer

MISSISSIPPI DEPARTMENT OF ENVIRONMENTAL QUALITY
 Office of Land and Water Resources
 P. O. Box 2309
 Jackson, MS 39225
Water Well Plugging/Decommissioning Form
 OLWR-DF-1 (04/08)
 (601)961-5555 (601)961-5228 (fax)

COUNTY WELL LOCATED: <u>Humphreys</u>		WELL NUMBER:
PERMIT NUMBER: <u>EW-07448</u>	DATE WELL PLUGGED: <u>9-13-19</u>	
NAME OF FIRM PLUGGING WELL: <u>Mid South Water</u>	TELEPHONE NUMBER: <u>662-843-4076</u>	
NAME AND ADDRESS OF CURRENT LANDOWNER: <u>Dutch Brake Fisheries, LLC</u> <u>4024 Money Sunk Rd</u> <u>Yazoo City, MS 39194</u>		
WELL LOCATION:	SECTION:	TOWNSHIP: RANGE:
WELL LOCATION: LATITUDE: <u>33° 16' 33.3"</u> LONGITUDE: <u>90° 41' 57.67"</u> METHOD (Check ONE): <input checked="" type="checkbox"/> USGS QUAD <input type="checkbox"/> CONVENTIONAL SURVEY <input type="checkbox"/> GPS - HAND HELD OR SURVEY GRADE		
DISTANCE: <u>6.38</u> ^{road} DIRECTION: <u>West</u> NEAREST TOWN: <u>Isola</u> OTHER LANDMARK: <u>Fish Ponds</u>		
WELL PURPOSE (HOME, IRRIGATION, MUNICIPAL, ETC.): <u>Irrigation</u>		
NAME OF WELL CONTRACTOR WHO DRILLED THE WELL: <u>Unknown</u>		
NAME OF LANDOWNER WHEN WELL WAS DRILLED: <u>Dutch Brake Fisheries</u>		

WELL DATA			
WELL DEPTH: <u>85'</u>	<u>85'</u>	HOLE DEPTH: <u>(Caved in)</u>	
CASING DIAMETER (IN.): <u>16</u>	CASING LENGTH (FT.): <u>N/A</u>	TYPE OF CASING: <u>Steel</u>	
DEPTH TO STATIC WATER LEVEL: <u>29'</u>	DATE WELL COMPLETED: <u>Unknown</u>		
WHY IS THE WELL BEING ABANDONED? <u>Failed</u>			

DESCRIBE HOW THE WELL OR HOLE WAS PLUGGED (AMOUNT OF CASING AND/OR SCREEN THAT WAS REMOVED OR LEFT IN HOLE, MATERIAL AND AMOUNT USED IN PLUGGING, METHOD OF PLACING MATERIAL, ETC.)

Pump pulled from well
Removed soil from around well
Cut off casing 4' below ground level
Pour 2 gallons of bleach into well
Filled casing with sand & bentonite to 20' below G.L.
Topped off with Clay & Cement
Back filled with native soil & leveled off

I CERTIFY THAT THE WELL WAS PLUGGED OR ABANDONED IN ACCORDANCE WITH THE STATE OF MISSISSIPPI REGULATIONS.

Peyton Overstreet 00008026
 PRINT NAME MS LICENSE NUMBER
Peyton Overstreet 9-19-19
 SIGNATURE DATE



Don R. Christy, PhD
Executive Director
P. O. Box 129
Stoneville, MS 38776
Tel.: (662) 686-7712
Fax: (662) 686-9078
www.ymd.org

Yazoo Mississippi Delta Joint Water Management District

September 10, 2019

Dutch Brake Fisheries
4024 Money Sunk Road
Yazoo City, MS 39194

RE: Receipt for Notification of Construction of Replacement Well MS-GW-50939
which will be replacing GW-07448 well located at
Location: NW ¼ of the SE ¼ Section 34 Township 17N Range 05W County Sunflower
Latitude: 331632 Longitude: 904158

Dear Dutch Brake Fisheries,

This letter acknowledges your notification to the state that you intend to replace a previously permitted well in the Mississippi River Valley Alluvial Aquifer and that this replacement construction will meet the requirements for a groundwater replacement well specified in 11 Miss. Admin. Code Part 7, Chapter 1, Rule 1.4.F.1 (see attached/back of page). Construction may begin immediately on your replacement well.

Remember that you are still required to submit a permit application (enclosed) for the replacement well within 5 days of construction beginning. You are also required to properly decommission (plug and abandon) the replaced well within 180 days of the replacement well's construction.

A copy of this letter, or a water use permit for the replacement well, **must** be attached to the State Well Report submitted by your driller to MDEQ and they must also submit a copy to YMD, as specified in the Water Well Contractor regulations found in 11 Miss. Admin. Code Part 7, Chapter 2, Rule 2.9.

If you have any questions, please call YMD at 662-686-7712.

Sincerely,

Dillard Melton Jr.

Dillard Melton Jr.
Permitting Director