

State Well Report

Part I

Mississippi Department of Environmental Quality
 Office of Land and Water Resources
 P.O. Box 10631
 Jackson, MS 39289-0631
 (601)961-5210
 (601)354-6938 (fax)

For Office Use Only:

Aquifer: _____
 Well #: S-104
 L. S. Elevation: _____
 E-log #: _____

County: Sunflower
 Permit #: 4WA1907
 Irrigation Equipment
 Driller: _____
 Date drilling completed: 6-23-07

State Law requires that this report be prepared by the driller in detail and filed with the Department within 30 days of completion of drilling of the well.

Well Owner Information	Well Location
Owner Name: <u>Bramfield Plantation</u>	Latitude: <u>33.18.17.3</u> Longitude: <u>90.41.260</u>
Mailing Address: <u>P.O. Box 165</u>	Method of Lat/Long (circle one): Conventional Survey, USGS quad, Hand-held GPS, Survey-grade GPS
<u>Inverness Ms. 38753</u>	<u>SW 1/4 SW 1/4 Sec 23 Twn 17N Rng 5W</u>
City State Zip Code	Distance Direction Nearest Town <u>6 Miles SW of Inverness</u>
Telephone No. ()	

Pond #10

Well Data

Purpose of Well (circle one) Home Industrial Public Supply Irrigation Fish Culture Other Replacement

Date well drilling started: 6-23-07 Date well drilling completed: 6-23-07

If flowing, method of flow regulation: Valve _____ Other (describe) _____

Static Water Level: 29 feet above below (circle one) land surface Date measured: 6-25-07

Method of Measurement (circle one) steel tape electric tape air line other: _____

Hole depth: 129 Well depth: 129 Well grouted to a depth of 10 feet

Type of grout (circle one): Cement Bentonite Mix

Casing length: 89 feet Casing diameter: 16 inches Type of casing: PVC

Screen length: 40 feet Screen diameter: 16 inches Type of screen: PVC

Screen slot size: .050 inches Setting depth: From See Back feet to _____ feet

Type of completion (circle all applicable): Gravel packed Underreamed Telescoped Open hole Natural Development

Other (describe): _____

Top of lap pipe or reduction in casing: _____ feet. If telescoped or more than one screen, describe on back of page

Logs run (circle all applicable) No log run Electric Gamma Ray Density Sonic Neutron Other: _____

Name of organization running log(s): _____

I certify that the well was drilled, constructed, and completed in accordance with all applicable requirements of the Mississippi Department of Environmental Quality and/or the Mississippi Department of Health regulations and state laws.

Irrigation Equipment Inc.
 Patrick M. Chism 0695

Patrick M. Chism
 Signature of Water Well Contractor

Print Name of Water Well Contractor and License No.

RECEIVED

JUL 09 2007

BY: OLWR

STATE WELL REPORT

Part 2

Pump Installer's Completion Report
Mississippi Department of Environmental Quality
Office of Land and Water Resources
P.O. Box 10631
Jackson, MS 39289-0631
(601)961-5210
(601)354-6938 (fax)

County: Sunflower
 Permit #: Irrigation Equipment
 Driller: _____
 Date completed: 6-23-07

For Office Use Only:

Aquifer: _____
 Well #: S-104
 Elevation: _____

This report should be prepared by the pump installer in detail and filed with the Department within 30 days of the installation of pump.

Well Owner Information	Well Location
Owner Name: <u>Brumfield Plantation</u>	Latitude: _____ Longitude: _____
Mailing Address: <u>P.O. Box 165</u>	Method of Lat/Long (circle one): Conventional Survey, USGS quad, Hand-held GPS, Survey-grade GPS
<u>Inverness</u> <u>Ms.</u> <u>38753</u>	<u>SW 1/4 SW 1/4 Sec 23 Twn 17N Rng 5W</u>
City State Zip Code	Distance Direction Nearest Town
Telephone No. () _____	<u>6</u> Miles <u>SW</u> of <u>Inverness</u>

Pump Type Circle one	Power Type Circle one
Air Lift Jet Submersible	<u>Diesel Engine</u> Gasoline Engine Natural Gas
Bucket Piston <u>Turbine</u>	Electric Motor Hand Tractor PTO
Centrifugal Rotary Flowing Well	Windmill Other (specify): _____
Other (specify): _____	Horse Power Rating of Motor: <u>60</u>
Date Pump Installed: <u>6-25-07</u>	Setting Depth: <u>70</u> feet
Rated Pump Capacity: <u>2800±</u> Gallons Per Minute	Number of Stages: <u>1</u>

Pump Test Data	Method of Measuring Water Level Circle one
Date Well Tested: _____	Air Line Electric Measuring Line Steel Tape
Static Water Level (A): _____ Feet Below Land Surface	Other (specify): _____
Pumping Water Level (B): _____ Feet Below Land Surface	For flowing well, measured shut in head: _____ feet
Drawdown [(B) - (A)]: _____ Feet Below Land Surface	Well yielded _____ GPM with a drawdown of _____ feet after _____ hours of pumping
Test Pumping Rate: _____ Gallons Per Minute	
Duration of Pump Test (minimum 4 hours): _____ hours	

I HEREBY CERTIFY that the above statements are true to the best of my knowledge.

Patrick M. Chism 0695 _____
 Print Name of Pump Installer and License No. (if applicable) Signature of Pump Installer

RECEIVED

JUL 09 2007
BY: OLWR

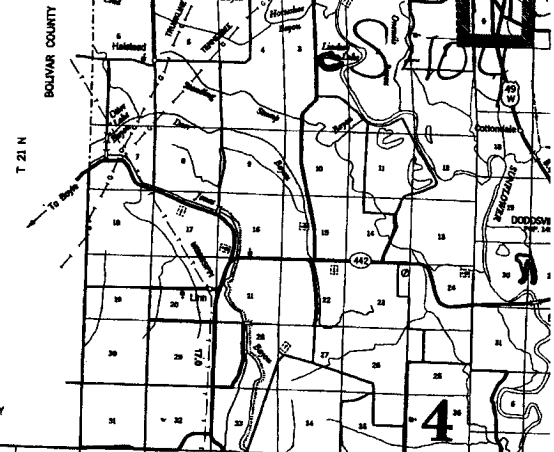
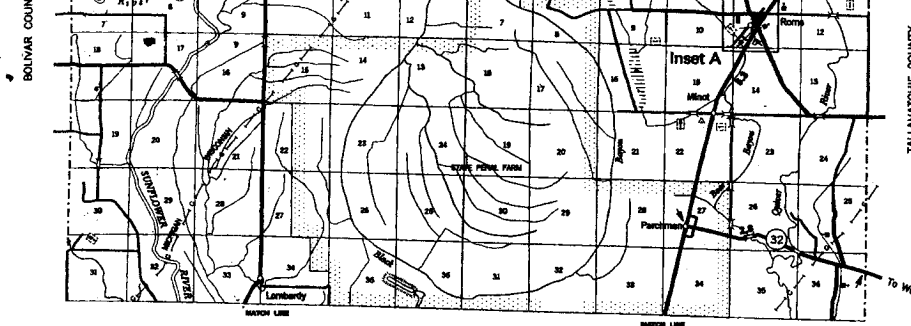

*Brumfield Plantation
Map*

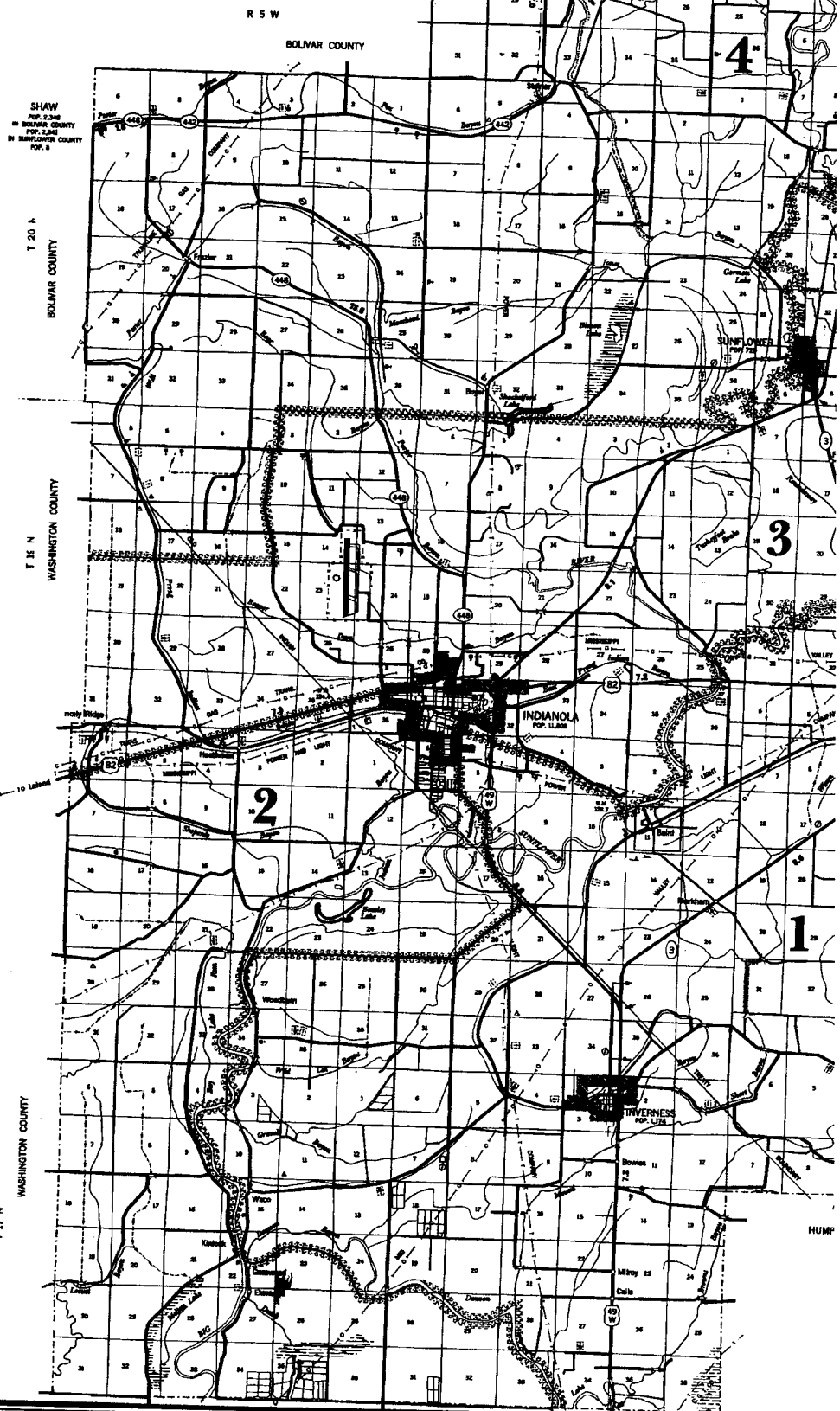

SHAW
POP. 2,348
IN BOLIVAR COUNTY
POP. 8,248
IN BURLINGAME COUNTY
POP. 8

NAMED FOR
the Sunflower
River which runs
through it.

ESTABLISHED
1844

COUNTY SEATED
Indianola

SIZE
707 square miles

POPULATION
52,867
21st of 82)

RECEIVED
JUL 09 2007
BY: OLWR

Indianola map, page 99