

County: Sumner  
 Permit #: MS-GW-45045  
 Driller: Next Drilling Co. Inc.  
 Date drilling completed: 4/3/11

### State Well Report

#### Part I - Driller's Log

Mississippi Department of Environmental Quality  
 Office of Land and Water Resources  
 P.O. Box 2309  
 Jackson, MS 39225  
 (601)961- 5210  
 (601)961- 5228 (fax)

For Office Use Only:  
 Aquifer: \_\_\_\_\_  
 Well #: H223  
 L. S. Elevation: \_\_\_\_\_  
 E-log #: \_\_\_\_\_

*State Law requires that this report be prepared by the license holder responsible for the work and filed with the Department at the above address within 30 days of completion of drilling of the well or borehole.*

<p><b>Information on Well Owner</b>  <i>(Landowner if borehole is not for a water well)</i></p> <p>Owner Name: <u>Joe McCarroll</u>        Mailing Address: <u>80 McCarroll Rd.</u>  <u>Bellevue MS. 38771</u>        City State Zip Code        Telephone No. ( ) _____</p>	<p><b>Well or Borehole Location</b></p> <p>Latitude: <u>33° 42' 13"</u> Longitude: <u>90° 31' 07"</u>        Method of Lat/Long (circle one): <u>Conventional Survey</u>        USGS quad, Hand-held GPS, Survey-grade GPS  <u>S4 1/4 SW 1/4 Sec 09 Twn 21N Rng 03W</u>        Distance <u>NW</u> Direction Nearest Town        Miles of _____</p>
--	--

**Well / Borehole Data**

Date drilling started: 4/3/11 Date drilling completed: 4/3/11 Hole depth: 120 ft Hole diameter: 20 in

Location of the source of any surface water used for drilling: \_\_\_\_\_  
 Method of dosing and volume of Chlorine used in drilling and development: \_\_\_\_\_

Logs run (circle all applicable): No log run  Electric  Gamma Ray  Density  Sonic  Neutron  Other: \_\_\_\_\_  
 Name of organization running log(s): \_\_\_\_\_

Purpose of borehole (check one): Water Well  Geotechnical/Geological Investigation  Ground Source Heat Pump   
 Seismic Survey  Other (describe) \_\_\_\_\_  
*If drilling is not related to water well construction, skip the remainder of this block*

Purpose of Well (check one): Home  Industrial  Public Supply  Irrigation  Fish Culture  Other: \_\_\_\_\_

If a flowing well, method of flow regulation: Valve \_\_\_\_\_ Other (describe) \_\_\_\_\_

Static Water Level: 45 feet above or below (circle one) land surface Date measured: 4/3/11

Method of Measurement (circle one) steel tape  electric tape  air line  other: \_\_\_\_\_

Well depth: 120 Well grouted to a depth of 10 feet Type of grout (circle one): Neat Cement  Bentonite  Mix

Casing length: 80 feet Casing diameter: 10 inches Type of casing: PVC

Screen length: 40 feet Screen diameter: 10 inches Type of screen: PVC

Screen slot size: 0.50 inches Setting depth: From 80 feet to 120 feet

Type of completion (circle all applicable):  Gravel packed  Underreamed  Telescoped  Open hole  Natural Development  
 Other (describe): \_\_\_\_\_

Top of lap pipe or reduction in casing: \_\_\_\_\_ feet. *If telescoped or more than one screen, describe on next page*

Form: OLWR-SWR-1A (04/08)

RECEIVED  
 JAN 24 2012  
 BY: OLWR

The sketch below only required for water wells

If well telescopes, show depths on sketch

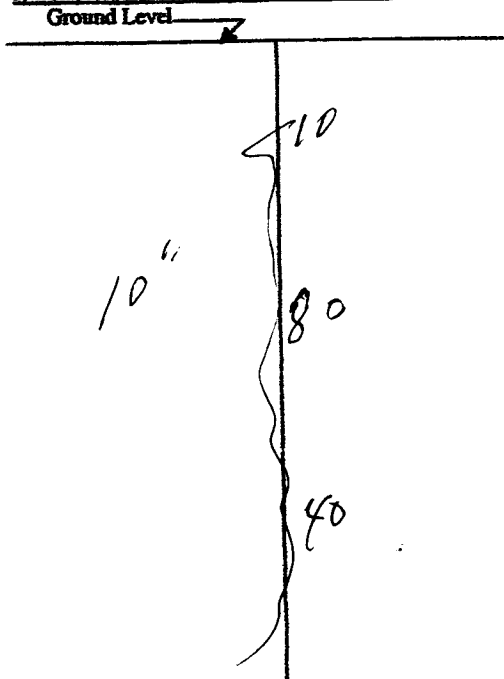

Description of formations encountered must be provided for all wells and boreholes, unless specifically exempted by regulations

Description of Formations Encountered	From (depth)	To (depth)
Clay	Ground Level	50 FT
Sand	50 FT	80 FT
Sand + gravel	80 FT	120 FT

If more than one screen, show location of each on sketch

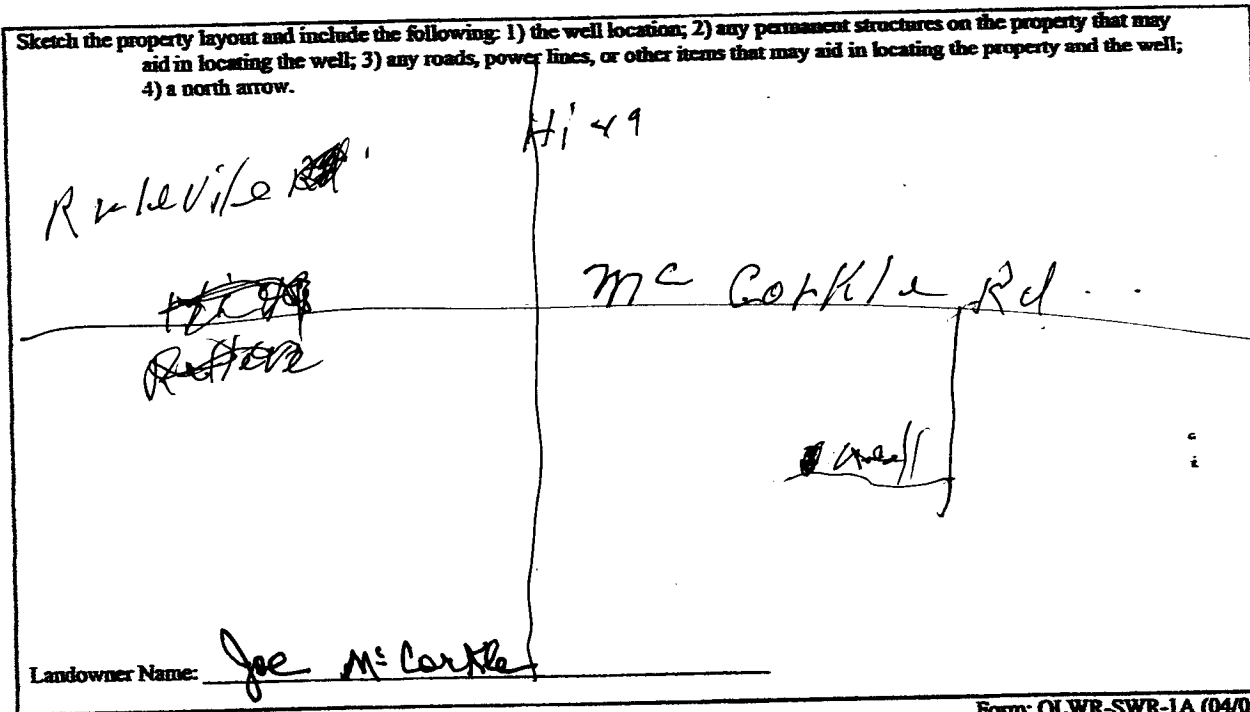

Form: OLWR-SWR-1A (04/08)

I certify that the well/borehole was drilled, constructed, and completed in accordance with all applicable requirements of the Mississippi Department of Environmental Quality and the Mississippi Department of Health regulations, if applicable, and state laws.

Cook Drilling, Inc 289  
Print Name of Responsible Licensee and License No.

1/16/12  
Date

Sidney Cook  
Signature of Licensee

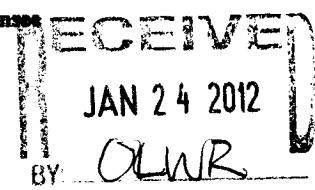

# STATE WELL REPORT

## Part 2

Pump Installer's Completion Report  
Mississippi Department of Environmental Quality  
Office of Land and Water Resources  
P.O. Box 2309  
Jackson, MS 39225  
(601)961-5210  
(601)961-5228 (fax)

County: Sunflower  
 Permit #: MS-GW 45045  
 Driller: Cook Drilling Co, Inc.  
 Date completed: 4/4/11  
*Copy information from block on Part 1*

**For Office Use Only:**

Aquifer: \_\_\_\_\_  
 Well #: H223  
 Elevation: \_\_\_\_\_

*This part of the report must be completed by a licensed water well contractor or a licensed pump installer. A copy of Part 1 of the report must be attached and both parts filed with the Department at the above address within 30 days of well completion.*

Well Owner Information	Well Location
Owner Name: <u>Joe McCarroll</u>	Latitude: _____ Longitude: _____
Mailing Address: <u>80 McCarroll Rd.</u>	Method of Lat/Long (check one): Conventional Survey _____
<u>Ridgeland Ms. 38771</u>	USGS quad _____, Hand-held GPS _____, Survey-grade GPS _____
City State Zip Code	<u>SW 1/4 SW 1/4 Sec 09 T21 R03W</u>
Telephone No. ( ) _____	Distance Direction Nearest Town _____ Miles of _____

Pump Type Circle one	Power Type Circle one
Air Lift <input type="checkbox"/> Jet <input type="checkbox"/> <b>Submersible</b> <input checked="" type="checkbox"/>	Diesel Engine <input type="checkbox"/> Gasoline Engine <input type="checkbox"/> Natural Gas <input type="checkbox"/>
Bucket <input type="checkbox"/> Piston <input type="checkbox"/> Turbine <input type="checkbox"/>	<b>Electric Motor</b> <input checked="" type="checkbox"/> Hand <input type="checkbox"/> Tractor PTO <input type="checkbox"/>
Centrifugal <input type="checkbox"/> Rotary <input type="checkbox"/> Flowing Well <input type="checkbox"/>	Windmill <input type="checkbox"/> Other (specify): _____
Other (specify): _____	Horse Power Rating of Motor: <u>10 HP</u>
Date Pump Installed: <u>4/4/11</u>	Setting Depth: <u>70</u> feet
Rated Pump Capacity: <u>400</u> Gallons Per Minute	Number of Stages: <u>1</u>

Pump Test Data	Method of Measuring Water Level Circle one
Date Well Tested: _____	Air Line <input type="checkbox"/> Electric Measuring Line <input type="checkbox"/> Steel Tape <input type="checkbox"/>
Static Water Level (A): <u>45</u> Feet Below Land Surface	Other (specify): _____
Pumping Water Level (B): _____ Feet Below Land Surface	For flowing well, measured shut in head: _____ feet
Drawdown [(B) - (A)]: _____ Feet Below Land Surface	Well yielded _____ GPM with a drawdown of _____ feet after _____ hours of pumping
Test Pumping Rate: _____ Gallons Per Minute	
Duration of Pump Test (minimum 4 hours): _____ hours	

I HEREBY CERTIFY that the above statements are true to the best of my knowledge.

Cook Drilling, Inc. 289  
 Print Name of Pump Installer and License No. (if applicable)

Ball Will  
 Signature of Pump Installer

Form: OLWR-SWR-1B (04/08)

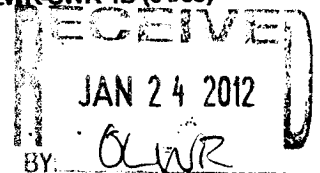

# STATE OF MISSISSIPPI

Department of Environmental Quality

Office of Land and Water Resources

P. O. Box 2309

Jackson, Mississippi 39225

H223

## PERMIT

### TO DIVERT OR WITHDRAW FOR BENEFICIAL USE THE PUBLIC WATERS

This permit is issued to the landowner named below in accordance with the provisions of the Mississippi Water Laws, Mississippi Code Sections 51-3-1, et seq.(1972, as amended), and the regulations and standards as promulgated thereunder. Whether or not specifically named in this permit or in the applications for this permit, anyone using water from the diversion/withdrawal point described below shall do so in compliance with the provisions of this permit. Neither this permit, nor any authority conferred hereby, may be sold, conveyed, encumbered, assigned, or otherwise aliened, for any period of time or under any conditions whatsoever. This permit may not be modified, transferred or revoked without prior action by the Permit Board. Any attempts to modify, transfer or revoke this permit, or to take any other action on this permit, shall be invalid and unenforceable and may result in immediate revocation or suspension of this permit. The holder of this permit shall at all times be responsible for adherence to the terms and conditions of this permit. No agreement between the permit holder and any other party shall affect the obligations and liabilities of the permit holder. Water use under this permit is allowed only when the streamflow, lake level elevation, or static groundwater level (whichever, if any, is applicable) is above the established minimum, pursuant to Mississippi Code Section 51-3-7. Authorization is hereby granted to divert/withdraw water for the beneficial use designated herein, and for no other purpose, subject to the following terms, conditions, and limitations:

**Permit Number:** MS-GW-45045

**Landowner Name:** MCCORKLE, JOE

**Landowner Address:** 80 MCCORKLE ROAD  
RULEVILLE MS 38771

**Source Of Water:** MISSISSIPPI RIVER VALLEY ALLUVIAL AQUIFER

**Beneficial Use:** IRRIGATION

**Diversion/Withdrawal Location:** SW 1/4 of the SW 1/4      **Section:** 09      **Township:** 21N      **Range:** 03W

**County:** SUNFLOWER

**Quad:** RULEVILLE

**Maximum Volume:** 45 Acre-Feet/Year      *equivalent to* .0402 Million Gallons/Day

**Maximum Rate:** 1200 Gallons/Minute

**Applicant Name:** MCCORKLE, JOE

**Applicant Address:** 80 MCCORKLE ROAD  
RULEVILLE MS 38771

**Date Permit Issued:** 03/21/2011

**Date Permit Expires:** 03/21/2016

**Date Permit Modified:**

**Date Permit Re-issued:**

This permit shall be deemed null and void if construction has not begun within one (1) year of permit issue date

SPECIAL TERMS AND CONDITIONS: SEE ATTACHMENT 1, WHICH IS HEREBY DECLARED TO BE PART OF THIS PERMIT.

  
Sam Mabry  
Office Director

