

County: Sunflower
 Permit #: GW-044183
 Driller: Cook Drilling Co., Inc.
 Date drilling completed: 7-30-10

State Well Report
 Part I - Driller's Log
 Mississippi Department of Environmental Quality
 Office of Land and Water Resources
 P.O. Box 2309
 Jackson, MS 39225
 (601)961- 5210
 (601)961- 5228 (fax)

For Office Use Only:
 Aquifer: H 200
 Well #: _____
 L. S. Elevation: _____
 E-log #: _____

State Law requires that this report be prepared by the license holder responsible for the work and filed with the Department at the above address within 30 days of completion of drilling of the well or borehole.

Information on Well Owner (Landowner if borehole is not for a water well)	Well or Borehole Location
Owner Name: <u>Avery Lubin</u>	Latitude: <u>33° 38' 16"</u> Longitude: <u>90° 27' 69"</u>
Mailing Address: <u>2036 Hwy 442 East</u>	Method of Lat/Long (circle one): Conventional Survey, <u>35</u>
<u>Doddsville, MS 38736</u>	USGS quad, Hand-held GPS, Survey-grade GPS
City State Zip Code	<u>SW</u> ¼ <u>SE</u> ¼ Sec <u>36</u> Twn <u>21</u> Rng <u>03</u> W
Telephone No. <u>(662) 756-4205</u>	Distance <u>5</u> Miles Direction <u>E</u> of Nearest Town <u>Doddsville MS</u>

Well / Borehole Data

Date drilling started: July 30, 10 Date drilling completed: July 30, 10 Hole depth: 120 Hole diameter: 26

Location of the source of any surface water used for drilling: _____
 Method of dosing and volume of Chlorine used in drilling and development: _____

Logs run (circle all applicable): No log run Electric Gamma Ray Density Sonic Neutron Other: _____
 Name of organization running log(s): _____

Purpose of borehole (check one): Water Well Geotechnical/Geological Investigation Ground Source Heat Pump
 Seismic Survey Other (describe) _____

If drilling is not related to water well construction, skip the remainder of this block

Purpose of Well (check one): Home Industrial Public Supply Irrigation Fish Culture Other: _____

If a flowing well, method of flow regulation: Valve _____ Other (describe) _____

Static Water Level: 59' feet above or below (circle one) land surface Date measured: 7-31-10

Method of Measurement (circle one) steel tape electric tape air line other: _____

Well depth: 120 Well grouted to a depth of 10 feet Type of grout (circle one): Neat Cement Bentonite Mix

Casing length: 80 feet Casing diameter: 16 inches Type of casing: PVC

Screen length: 40 feet Screen diameter: 16 inches Type of screen: PVC

Screen slot size: 1.5" inches Setting depth: From 80 feet to 120 feet

Type of completion (circle all applicable): Gravel packed Underreamed Telescoped Open hole Natural Development
 Other (describe): _____

Top of lap pipe or reduction in casing: _____ feet. *If telescoped or more than one screen, describe on next page*

Form: OLWR-SWR-1A (04/08)

RECEIVED
 SEP 01 2010
 BY: OLWR

14200

The sketch below only required for water wells

Description of formations encountered must be provided for all wells and boreholes, unless specifically exempted by regulations

If well telescopes, show depths on sketch.

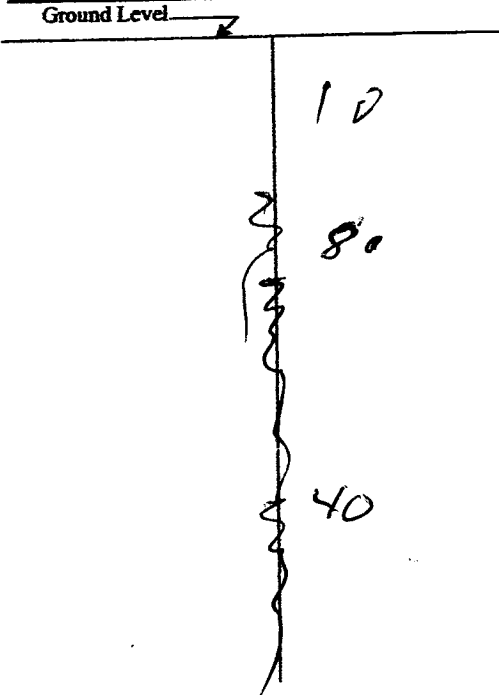

Description of Formations Encountered	From (depth)	To (depth)
	Ground Level	25'
fine sand	25'	65'
sand & gravel	65'	120'
Rock	120'	

If more than one screen, show location of each on sketch

Sketch the property layout and include the following: 1) the well location; 2) any permanent structures on the property that may aid in locating the well; 3) any roads, power lines, or other items that may aid in locating the property and the well; 4) a north arrow.

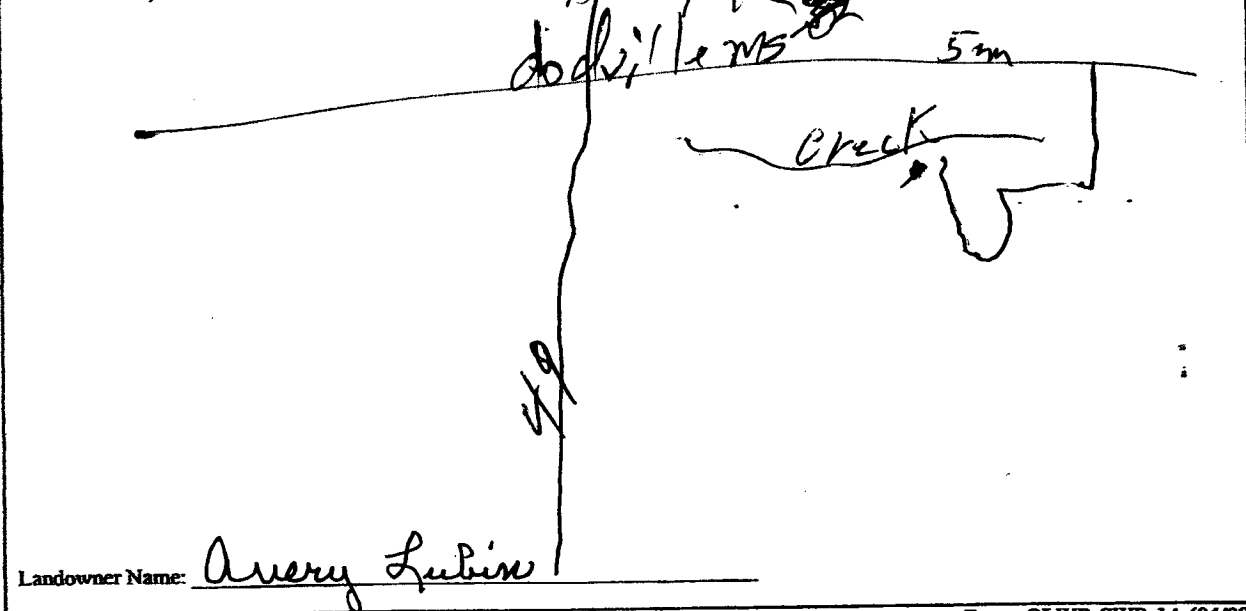

Form: OLWR-SWR-1A (04/08)

I certify that the well/borehole was drilled, constructed, and completed in accordance with all applicable requirements of the Mississippi Department of Environmental Quality and the Mississippi Department of Health regulations, if applicable, and state laws.

COOK Drilling Co., Inc. 289
Print Name of Responsible Licensee and License No.

7-30-10
Date

Sidney Cook
Signature of Licensee

STATE WELL REPORT

Part 2

Pump Installer's Completion Report
 Mississippi Department of Environmental Quality
 Office of Land and Water Resources
 P.O. Box 2309
 Jackson, MS 39225
 (601)961-5210
 (601)961-5228 (fax)

County: Sussex
 Permit #: GW-47183
 Driller: Cook Drilling Co., Inc.
 Date completed: 7-31-10
Copy information from block on Part 1

For Office Use Only:

Aquifer: H200
 Well #: _____
 Elevation: _____

This part of the report must be completed by a licensed water well contractor or a licensed pump installer. A copy of Part 1 of the report must be attached and both parts filed with the Department at the above address within 30 days of well completion.

Well Owner Information	Well Location
Owner Name: <u>Avery Lubin</u>	Latitude: <u>33-38160</u> Longitude: <u>90-27697</u>
Mailing Address: <u>2036 Hwy 42 East</u>	Method of Lat/Long (check one): Conventional Survey _____
<u>Doddsville, MS 38736</u>	USGS quad _____, Hand-held GPS _____, Survey-grade GPS _____
City State Zip Code	_____ 1/4 _____ 1/4 Sec <u>36</u> T <u>21</u> N R <u>03</u> W
Telephone No. <u>(662) 756-4205</u>	Distance Direction Nearest Town
	<u>5</u> Miles <u>E</u> of <u>Doddsville MS</u>

Pump Type Circle one	Power Type Circle one
Air Lift Jet <input type="radio"/> Submersible <input checked="" type="radio"/>	Diesel Engine Gasoline Engine Natural Gas
Bucket Piston <input type="radio"/> Turbine <input type="radio"/>	<input checked="" type="radio"/> Electric Motor <input type="radio"/> Hand <input type="radio"/> Tractor PTO
Centrifugal Rotary <input type="radio"/> Flowing Well <input type="radio"/>	Windmill Other (specify): _____
Other (specify): _____	Horse Power Rating of Motor: <u>50</u>
Date Pump Installed: <u>7-31-10</u>	Setting Depth: <u>80</u> feet
Rated Pump Capacity: <u>1800</u> Gallons Per Minute	Number of Stages: <u>1</u>

Pump Test Data	Method of Measuring Water Level Circle one
Date Well Tested: _____	Air Line Electric Measuring Line Steel Tape
Static Water Level (A): <u>57</u> Feet Below Land Surface	Other (specify): _____
Pumping Water Level (B): _____ Feet Below Land Surface	For flowing well, measured shut in head: _____ feet
Drawdown [(B) - (A)]: _____ Feet Below Land Surface	Well yielded _____ GPM with a drawdown of _____ feet after _____ hours of pumping
Test Pumping Rate: _____ Gallons Per Minute	
Duration of Pump Test (minimum 4 hours): _____ hours	

I HEREBY CERTIFY that the above statements are true to the best of my knowledge.

Cook Drilling Co., Inc. 289 Sidney Cook
 Print Name of Pump Installer and License No. (if applicable) Signature of Pump Installer

Form: OLWR-SWR-1B (04/08)

RECEIVED
 SEP 01 2010
 BY: OLWR