

# State Well Report

## Part 1

Mississippi Department of Environmental Quality  
Office of Land and Water Resources  
P.O. Box 10631  
Jackson, MS 39289-0631  
(601)961-5210  
(601)354-6938 (fax)

County: Sunflower  
Permit #: 6042442  
Irrigation Equipment  
Driller: \_\_\_\_\_  
Date drilling completed: 4-17-08

For Office Use Only:  
Aquifer: \_\_\_\_\_  
Well #: B-110  
L. S. Elevation: \_\_\_\_\_  
E-log #: \_\_\_\_\_

State Law requires that this report be prepared by the driller in detail and filed with the Department within 30 days of completion of drilling of the well.

Well Owner Information	Well Location
Owner Name: <u>Legg Farms II</u>	Latitude: <u>33° 55' 28.9"</u> Longitude: <u>90° 28' 18.5"</u>
Mailing Address: <u>203 Hwy 32</u>	Method of Lat/Long (circle one): Conventional Survey, USGS quad, Hand-held GPS, Survey-grade GPS
<u>Drew</u> <u>Ms.</u> <u>38737</u>	<u>NE</u> ¼ <u>NE</u> ¼ Sec <u>26</u> Twn <u>24N</u> Rng <u>3W</u>
City State Zip Code	Distance Direction Nearest Town <u>2</u> Miles <u>S</u> of <u>Rome</u>
Telephone No. ( ) _____	

Well Data

Purpose of Well (circle one) Home Industrial Public Supply Irrigation Fish Culture Other: \_\_\_\_\_

Date well drilling started: 4-17-08 Date well drilling completed: 4-17-08

If flowing, method of flow regulation: Valve \_\_\_\_\_ Other (describe) \_\_\_\_\_

Static Water Level: 41 feet above of below (circle one) land surface Date measured: 4-21-08

Method of Measurement (circle one) steel tape electric tape air line other: \_\_\_\_\_

Hole depth: 127 Well depth: 127 Well grouted to a depth of 10 feet

Type of grout (circle one): Cement Bentonite Mix

Casing length: 87 feet Casing diameter: 16 inches Type of casing: PVC

Screen length: 40 feet Screen diameter: 16 inches Type of screen: PVC

Screen slot size: .050 inches Setting depth: From 88 feet to 127 feet

Type of completion (circle all applicable): Gravel packed Underreamed Telescoped Open hole Natural Development

Other (describe): \_\_\_\_\_

Top of lap pipe or reduction in casing: \_\_\_\_\_ feet. If telescoped or more than one screen, describe on back of page

Logs run (circle all applicable): No log run Electric Gamma Ray Density Sonic Neutron Other: \_\_\_\_\_

Name of organization running log(s): \_\_\_\_\_

I certify that the well was drilled, constructed, and completed in accordance with all applicable requirements of the Mississippi Department of Environmental Quality and/or the Mississippi Department of Health regulations and state laws.

Irrigation Equipment Inc  
Patrick M. Chism 0695

Print Name of Water Well Contractor and License No. \_\_\_\_\_ Signature of Water Well Contractor Pat

RECEIVED

APR 24 2008

BY: OLWR

61042412

B-110

If well telescopes please sketch below and show depths.

Ground Level

Description of Formations Encountered	From	To
Clay	0	22
Fine Sand	23	38
Fine Sand + Gravel	39	72
Medium Sand + Gravel	73	127

If more than one screen, show location of each on sketch

Sketch the property layout and include the following: 1) the well location; 2) any permanent structures on the property that may aid in locating the well; 3) any roads, power lines, or other items that may aid in locating the property and the well; 4) indicate direction.

Landowner Name: Legg Farms II

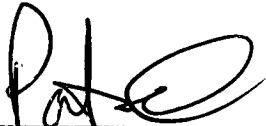
  
Signature of Water Well Contractor

RECEIVED  
APR 24 2008  
BY: OLWR

# STATE WELL REPORT

## Part 2

**Pump Installer's Completion Report**  
 Mississippi Department of Environmental Quality  
 Office of Land and Water Resources  
 P.O. Box 10631  
 Jackson, MS 39289-0631  
 (601)961-5210  
 (601)354-6938 (fax)

County: Sunflower  
 Permit #: GW 40440  
 Irrigation Equipment  
 Driller: \_\_\_\_\_  
 Date completed: \_\_\_\_\_

For Office Use Only:

Aquifer: \_\_\_\_\_  
 Well #: B-110  
 Elevation: \_\_\_\_\_

This report should be prepared by the pump installer in detail and filed with the Department within 30 days of the installation of pump.

Well Owner Information	Well Location
Owner Name: <u>Logg Farms II</u>	Latitude: _____ Longitude: _____
Mailing Address: <u>203 Hwy 32</u>	Method of Lat/Long (circle one): <input type="radio"/> Conventional Survey, <input type="radio"/> USGS quad, <input type="radio"/> Hand-held GPS, <input type="radio"/> Survey-grade GPS
<u>Drew</u> <u>Ms.</u> <u>38737</u> City State Zip Code	<u>NE 1/4 NE 1/4 Sec 26 Twn 24N Rng 3W</u>
Telephone No. ( ) _____	Distance Direction Nearest Town <u>2</u> Miles <u>S</u> of <u>Rome</u>

Pump Type Circle one	Power Type Circle one
Air Lift: <input type="radio"/> Jet <input type="radio"/> Submersible	<input checked="" type="radio"/> Diesel Engine <input type="radio"/> Gasoline Engine <input type="radio"/> Natural Gas
Bucket: <input type="radio"/> Piston <input checked="" type="radio"/> Turbine	Electric Motor <input type="radio"/> Hand <input type="radio"/> Tractor PTO
Centrifugal: <input type="radio"/> Rotary <input type="radio"/> Flowing Well	Windmill <input type="radio"/> Other (specify): _____
Other (specify): _____	Horse Power Rating of Motor: <u>60</u>
Date Pump Installed: <u>4-21-08</u>	Setting Depth: <u>70</u> feet
Rated Pump Capacity: <u>2800±</u> Gallons Per Minute	Number of Stages: <u>1</u>

Pump Test Data	Method of Measuring Water Level Circle one
Date Well Tested: _____	<input type="radio"/> Air Line <input type="radio"/> Electric Measuring Line <input type="radio"/> Steel Tape
Static Water Level (A): _____ Feet Below Land Surface	Other (specify): _____
Pumping Water Level (B): _____ Feet Below Land Surface	For flowing well, measured shut in head: _____ feet
Drawdown [(B) - (A)]: _____ Feet Below Land Surface	Well yielded _____ GPM with a drawdown of _____ feet after _____ hours of pumping
Test Pumping Rate: _____ Gallons Per Minute	
Duration of Pump Test (minimum 4 hours): _____ hours	

I HEREBY CERTIFY that the above statements are true to the best of my knowledge.

Patrick M. Chism 0695  
 Print Name of Pump Installer and License No. (if applicable)

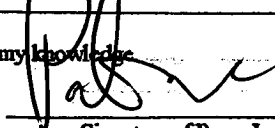
  
 Signature of Pump Installer

RECEIVED  
 APR 24 2008  
 BY: OLWR

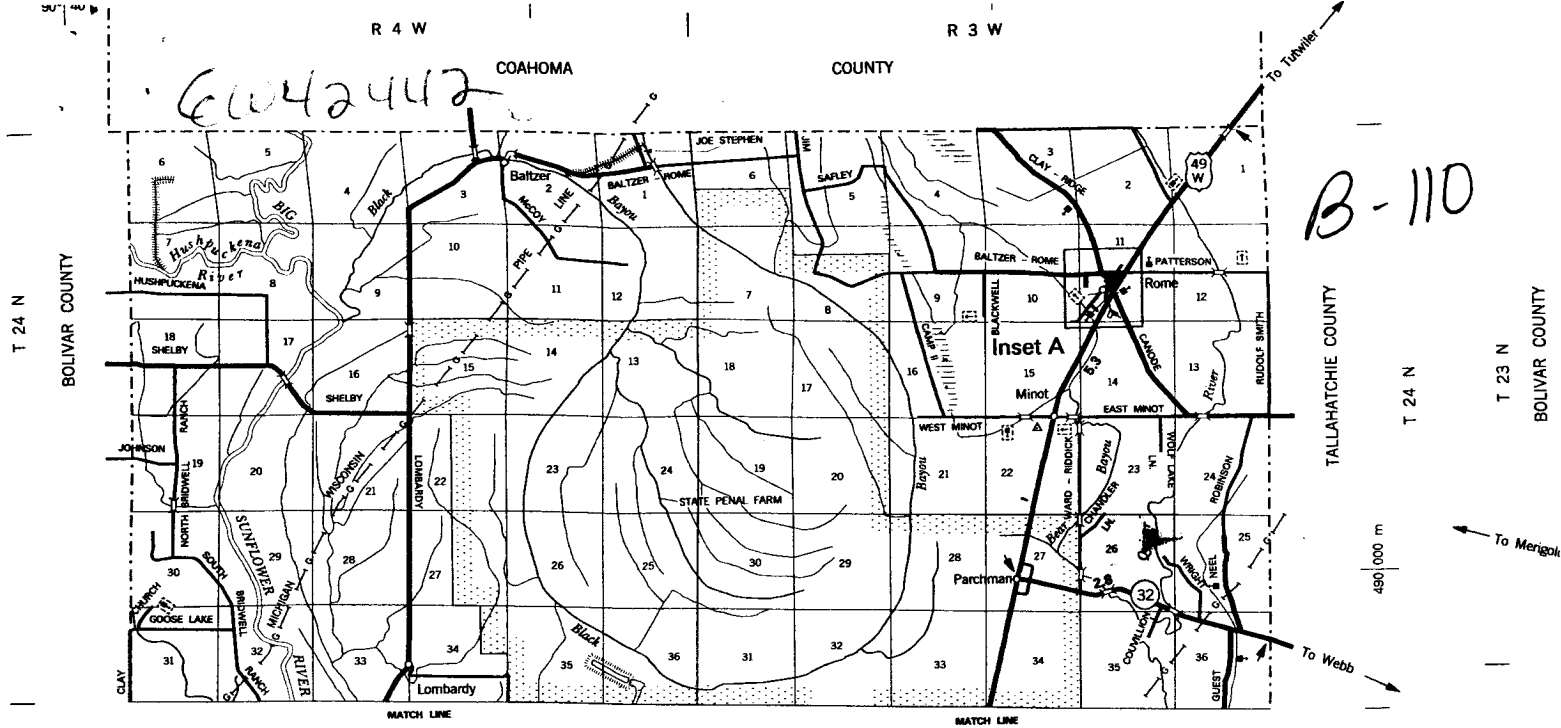

# Legg Farms Map

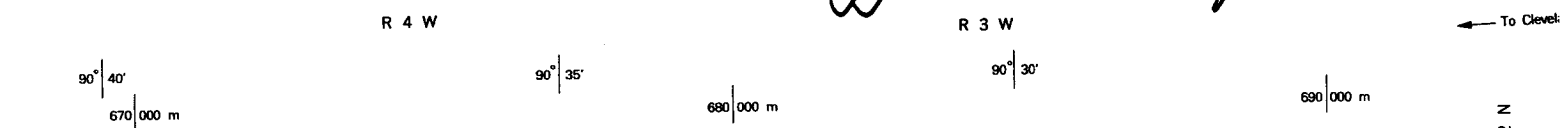

- EAST AUSTIN E5
- EAST BLACKBELT E5
- EAST CALE G4
- EMT WILE DXT. E6
- EAST GARVINS E4
- EAST GRESHAM E5
- EAST HARTWYRE B4
- EAST MINOT A3
- EAST MOBILE E5
- EAST PATTON C4
- EAST OLIVER B5,C5
- EASTLAND C3
- FAIRVIEW E3
- FARMONA PLANTION E4
- FARSH C5
- FEEDLOT A4
- FENCE E4
- FERGUSON ST. B2
- RTTS E5
- RTTIGHIGH A6
- RSACKENLY D6
- FLORA'S LAL. E4
- FLOYD SMITH F3
- FOND E4
- FOUR MILE G4
- FREEDOM FARM A6,B5
- FRESHMAN D4
- FRENCH E4
- G. W. MANNING A5
- GENE LESTER C3
- GIBSON B2
- GIBBS C4
- GOLDFIELD A5
- GOOSE LAKE A1
- GRACE F6
- GRADY D4
- GREYLY B6
- GUEST A3
- GWIN - LIPWICK E4
- H. TURNER C3
- HAMPTON F3
- HARRY A5
- HARRAH B4
- HARD LAKE A6
- HARRIS E3
- HART B6
- HAYS E3
- HEARN C4
- HEATHMAN HOLLY RIDGE E3,F3
- HELDROSE E4
- HEARD LAKE A5
- HOBBS - BRICK F5
- HOBBS F5
- HODGES WRISTON COURTNAY D3
- HOLDER B4
- HOLDERFIELD D4
- HOLEMAN FOND D6
- HOLLAND E4
- HOLLY RIDGE HOLMES F3
- HOOKER B2
- HORNE F4
- HUGHES - BRASWELL D4
- HUGHES - ERTLE D4
- HUGHES - WALKER D4
- HULAHAY LANE BRISTON E3
- HUMPHREYS COUNTY LINE ROAD G3
- HUNTER B6
- HUSHUCKENA A1
- HVV. JH G3
- IDLEWOOD E4
- JACK CURRY B6
- JEFF COAT - LEMO C4
- JEFFCOAT D6
- JERRY MARLEY C4
- JERRY MOBLE E5
- JOE STEPHEN A2
- JOHN WATTS B4
- JOHNSON A1
- JONES C4
- KANSAS PLANTATION GEORGE BAIRD F4
- KATE LAL. F4
- KAY PLANTATION E4,F4
- KEITH LK. B4
- KING DLG6
- KING WILLIAMS G3
- KIRKOCK F4,G3
- KIRK D4
- KIRSEY RD. E3
- KROBBER B5
- LAKE DANWON G4
- LAND FIELD E4
- LANNIE MOORE F5
- LEFLORE COUNTY LINE C3
- LINDSEY C5
- LINN C4
- LIVINGSTON B5
- LOMBARDY A1
- LONG B4
- LOWER E3
- LUCY MANNING B5
- LINGER LAKE A1
- LUK C4
- LYON BRIDGE D3
- M. CRITTMAN A5
- MADDEN D4
- MAON B2
- MAJORS E3
- MALLETT - JONES C4
- MAMIE LEE F4
- MARIONAM B3,F5
- MARY ST. B2
- MAXWELL F5
- MCCARTY C3
- MCCOY C5
- MCCOY F5
- MCDANIELS A5
- MCHRYRE C3
- MIDWELL CALD4
- MIYON C4
- MOLL E4
- MOOREHEAD - NELSON F5
- MOUND G4
- MOUND FISH POND G4
- MOUNT GAULICE C5
- MULLIN E5
- MURTAGH SHEPHERD E5
- MUEZ D3
- MVERS G4
- NASH E3
- NEEL ROBINSON A3
- NEZEL C4
- NORTH AIRPORT B6
- NORTH BARNETT B6
- NORTH BRIDWELL RANCH A1
- NORTH MOBILE E4
- NORTH SIMMONS E3
- NORTH WADE SCHOOL A5
- O. W. BAYELL E4
- ORCHARD RD. E4
- PARKER F5
- PARKS B4
- PAT SHEPHERD B6
- PARKWAY ST. B2
- PATTERSON A3
- PETE KING LAL. G4
- PERRY SHERMAN G4
- PITTMAN DODD D6,E5
- POLLOCK F4
- POND EXT. C5
- PODDORN E4
- POVERTY LAL. B4
- POWELL B6,C4
- PRATT PLACE G4
- PREACHERS E5
- PROMISE LANE A6
- QUINN E3
- RABBO - STATION B4
- RALPH RAY B4
- RASH B5
- RATTLENAKE C3
- REED A5
- REED LOOP F4,G3
- RICHARDS B4
- RICHARDSON C5
- RICKLES A6
- ROBERT SHEPHERD G3
- ROBERT VAN PONDENSTER F4
- ROME - MERIGOLD D6
- ROOSE LAL. E4
- ROUND LAKE LAL. E4
- RUDOLF SMITH A3
- RULE C5
- RUPERT BAIRD F4
- SAFEY A2
- SAGE A5
- SAWELL B5
- SCALLINGS A4
- SCORODGINS B2
- SCORODGINS C5
- SECTION B5
- SHELBY A1
- SIEPHERDS BAYOU F3
- SUSH D6
- SLEEPY MARTIN A6
- SMITH - MURPHY A6
- SHAKE MORGAN C4
- SOUTH BRIDWELL RANCH A1
- SOUTH CHURCH F4
- SOUTH LUNCAN F4
- SOUTH RTTS E5
- SOUTH GARVINS FERRY B2
- SOUTH MAWHELL F5
- SOUTH MOUND G4
- SOUTH SHEPHERD F5
- SOUTH TAYLOR E5
- SOUTH WADE E3
- SOUTHWEST C4
- STAAGS C4
- STANSEL B6
- STEED - MCKON D4
- STELAMAM D6
- STEPHEN - LYON D3
- STEWART E4
- STINSON E4,F4
- STRINGFELLOW B4
- SUNFLOWER - ITTA BEMA E5
- SUNFLOWER E4
- SUNWASE B2
- SWANGO F3
- SWOOP E6
- TAYLOR C4
- TENNELL C5
- THARP A4
- THOMAS GOODON B4
- THOMPSON F4
- THREBLE F3
- THREE MILE LAKE F6,G5
- TOLER REEDMAN G5
- TOMMY BAIRD G4
- TRANSFERERY F6
- TRAMM B5
- TROTTER CALD4
- TURNER B4
- TV STATION F5
- TURNER B6,C5
- VALLEY E5
- W. D. KIRK BLAINE D4
- WACO C3
- WADE SCHOOL A5
- WALKER C4
- WALTONIA LAL. E4
- WARD - MIDDICK A3
- WATSON F6
- WATSON AL5,F4
- WASHINGTON F2
- WELCH F3
- WEST CAME G4
- WEST GRESHAM E3
- WEST MINOT A2
- WEST PATTON G4
- WEST GREEN D6
- WHITTINGTON RD. F4,G4
- WILLIE MARTIN C4
- WILLINGHAM A4
- WYFLE B6
- WOLF LAKE LAL. A3
- WOODBURN F3
- WOODS D4
- WRIGHT A3

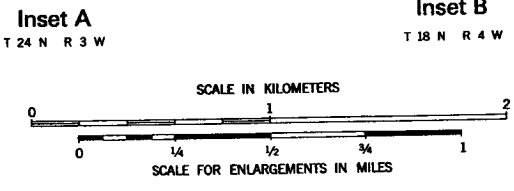
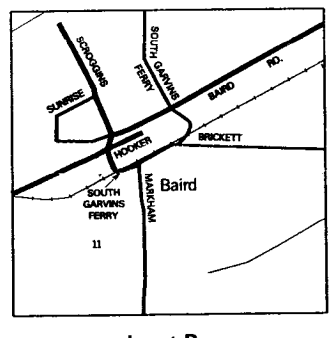
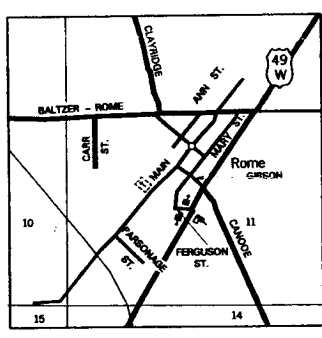

RECEIVED  
 APR 24 2008  
 BY: OLWR  
 BOLIVAR COUNTY

