

Smith

County: ~~Scott~~
 Permit #: 0-586
 Driller: JAMES WELLS
 Date drilling completed: 4-13-10

State Well Report
Part 1 - Driller's Log
 Mississippi Department of Environmental Quality
 Office of Land and Water Resources
 P.O. Box 2309
 Jackson, MS 39225
 (601)961- 5210
 (601)961- 5228 (fax)

For Office Use Only:
 Aquifer: P60
 Well #: _____
 L. S. Elevation: _____
 E-log #: _____

State Law requires that this report be prepared by the license holder responsible for the work and filed with the Department at the above address within 30 days of completion of drilling of the well or borehole.

Information on Well Owner (Landowner if borehole is not for a water well)	Well or Borehole Location
Owner Name: <u>William Allen</u>	Latitude: <u>31.48.32</u> , Longitude: <u>89.35.26</u>
Mailing Address: <u> Hwy 35 North</u> <u> Mize MS</u>	Method of Lat/Long (circle one): Conventional Survey, USGS quad, Hand-held GPS, Survey-grade GPS
City: _____ State: _____ Zip Code: _____	<u>NE 1/4 NE 1/4 Sec 27 Twn 10N Rng 16W</u>
Telephone No. (<u>601</u>) <u>317-0719</u>	Distance <u>5</u> Miles <u>South</u> of <u>Mize MS</u>

Well / Borehole Data

Date drilling started: 4-13-10 Date drilling completed: 4-13-10 Hole depth: 225 Hole diameter: 7

Location of the source of any surface water used for drilling: creek

Method of dosing and volume of Chlorine used in drilling and development: 3 lb Shock

Logs run (circle all applicable): No log run Electric Gamma Ray Density Sonic Neutron Other: _____

Name of organization running log(s): _____

Purpose of borehole (check one): Water Well Geotechnical/Geological Investigation _____ Ground Source Heat Pump _____

Seismic Survey _____ Other (describe) _____

If drilling is not related to water well construction, skip the remainder of this block

Purpose of Well (check one): Home Industrial _____ Public Supply _____ Irrigation Fish Culture _____ Other: _____

If a flowing well, method of flow regulation: Valve _____ Other (describe) _____

Static Water Level: 125 feet above or below (circle one) land surface Date measured: 4-13-10

Method of Measurement (circle one) steel tape electric tape air line other: _____

Well depth: 225 Well grouted to a depth of 16 feet Type of grout (circle one): Neat Cement Bentonite Mix

Casing length: 195 feet Casing diameter: 4 inches Type of casing: PVC

Screen length: 30 feet Screen diameter: 4 inches Type of screen: PVC

Screen slot size: .008 inches Setting depth: From 195 feet to 195 feet

Type of completion (circle all applicable): Gravel packed Underreamed Telescoped Open hole Natural Development

Other (describe): _____

Top of lap pipe or reduction in casing: _____ feet. *If telescoped or more than one screen, describe on next page*

Form: OLWR-SWR-1A (04/08)

RECEIVED
 MAY 13 2010
 BY: OLWR

If well telescopes please sketch below and show depths.

Ground Level

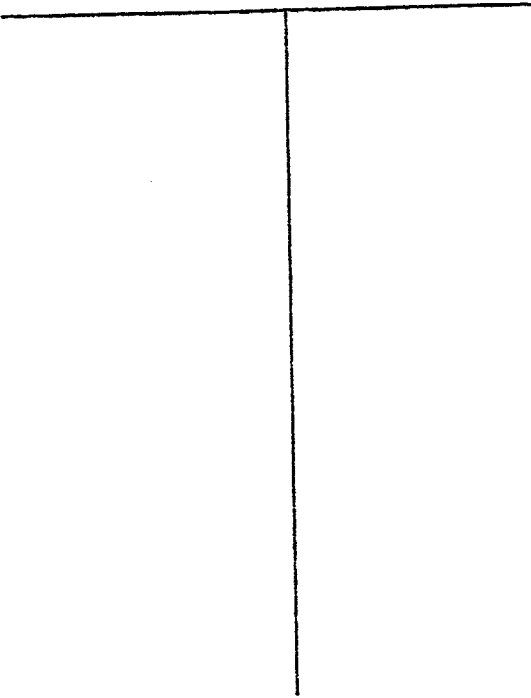

Description of Formations Encountered

From To

Description of Formations Encountered	From	To
Top Sand	0	2
Clay	2	25
Sand	25	60
Clay	60	140
Sand	140	225

P60

If more than one screen, show location of each on sketch

Sketch the property layout and include the following: 1) the well location; 2) any permanent structures on the property that may aid in locating the well; 3) any roads, power lines, or other items that may aid in locating the property and the well; 4) indicate direction.

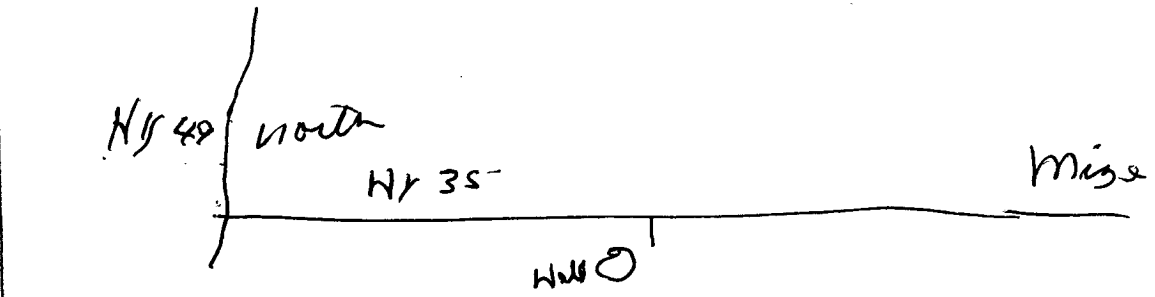

Landowner Name: ~~C. Allen~~ William Allen

James Wells
Signature of Water Well Contractor

RECEIVED
MAY 13 2010
BY: OLWR

STATE WELL REPORT

Part 2

Pump Installer's Completion Report
Mississippi Department of Environmental Quality
Office of Land and Water Resources
P.O. Box 10631
Jackson, MS 39289-0631
(601)961-5210
(601)354-6938 (fax)

For Office Use Only:

Aquifer: P60
Well #: _____
Elevation: _____

County: Smith
Permit #: _____
Driller: JAMES WELLS
Date completed: 4-13-10

This report should be prepared by the pump installer in detail and filed with the Department within 30 days of the installation of pump.

Well Owner Information	Well Location
Owner Name: <u>William Allen</u>	Latitude: _____ Longitude: _____
Mailing Address: <u>Hwy. 35 North</u> <u>Mize MS</u>	Method of Lat/Long (circle one): Conventional Survey, USGS quad, Hand-held GPS, Survey-grade GPS
City _____ State _____ Zip Code _____	<u>1/4</u> _____ <u>1/4</u> Sec <u>27</u> Twn <u>10N</u> Rng <u>16W</u>
Telephone No. <u>(601) 317-0719</u>	Distance _____ Direction _____ Nearest Town _____ <u>5</u> Miles <u>S</u> of <u>Mize</u>

Pump Type Circle one	Power Type Circle one
Air Lift Jet <u>Submersible</u>	Diesel Engine Gasoline Engine Natural Gas
Bucket Piston Turbine	<u>Electric Motor</u> Hand Tractor PTO
Centrifugal Rotary Flowing Well	Windmill Other (specify): _____
Other (specify): _____	Horse Power Rating of Motor: <u>5 HP</u>
Date Pump Installed: <u>4-13-10</u>	Setting Depth: <u>175</u> feet
Rated Pump Capacity: <u>50</u> Gallons Per Minute	Number of Stages: <u>13</u>

Pump Test Data	Method of Measuring Water Level Circle one
Date Well Tested: <u>4-13-10</u>	Air Line Electric Measuring Line Steel Tape
Static Water Level (A): <u>125</u> Feet Below Land Surface	Other (specify): _____
Pumping Water Level (B): <u>175</u> Feet Below Land Surface	For flowing well, measured shut in head: _____ feet
Drawdown [(B) - (A)]: <u>140</u> Feet Below Land Surface	Well yielded <u>56</u> GPM with a drawdown of
Test Pumping Rate: <u>50</u> Gallons Per Minute	<u>125</u> feet after <u>4</u> hours of pumping
Duration of Pump Test (minimum 4 hours): <u>4</u> hours	

I HEREBY CERTIFY that the above statements are true to the best of my knowledge.

JAMES WELLS 0-586
Print Name of Pump Installer and License No. (if applicable)

James Wells
Signature of Pump Installer

RECEIVED
MAY 13 2010
BY: OLWR