

03/02/1996 16:02 6014281435

A-1 DRILLING SERVICE

PAGE 06

### State Well Report

Part 1

Mississippi Department of Environmental Quality  
Office of Land and Water Resources  
P.O. Box 10631  
Jackson, MS 39289-0631  
(601)961-5210  
(601)354-6938 (fax)

For Office Use Only:

Aquifer: \_\_\_\_\_  
Well #: C-26  
L. S. Elevation: \_\_\_\_\_  
E-log #: \_\_\_\_\_

County: Smith  
Permit #: \_\_\_\_\_  
Driller: A-1 Drilling Serv  
Date drilling completed: 10-14-05

State Law requires that this report be prepared by the driller in detail and filed with the Department within 30 days of completion of drilling of the well.

Well Owner Information <u>Well # 2005-1</u>		Well Location	
Owner Name: <u>BATTE LUMBER CO.</u>	Latitude: _____	Longitude: _____	
Mailing Address: <u>ROUTE 2 BOX 707</u>	Method of Lat/Long (circle one): Conventional Survey,		
<u>Forest</u> <u>Ms</u> <u>39074</u>	USGS quad; Hand-held GPS, Survey-grade GPS		
City State Zip Code	<u>NW 1/4 NE 1/4 Sec 29 Twn 4 N Rng 8 E</u>		
Telephone No. <u>(601) 536-2096</u>	Distance	Direction	Nearest Town
	<u>1 1/2</u> Miles	<u>S</u>	of <u>Lorena</u>

**Well Data**

Purpose of Well (circle one) Home  Industrial Public Supply Irrigation Fish Culture Other: Leak sprinkling

Date well drilling started: 10-11-05 Date well drilling completed: 10-14-05

If flowing, method of flow regulation: Valve \_\_\_\_\_ Other (describe) \_\_\_\_\_

Static Water Level: 62 feet above or  below (circle one) land surface Date measured: 10-12-05

Method of Measurement (circle one) steel tape  electric tape air line other: \_\_\_\_\_

Hole depth: 140 Well depth: 102 Well grouted to a depth of 12 feet

Type of grout (circle one):  Cement  Bentonite Mix

Casing length: 82 feet Casing diameter: 4 inches Type of casing: PVC

Screen length: 20 feet Screen diameter: 4 inches Type of screen: slotted PVC

Screen slot size: .006 inches Setting depth: From 82 feet to 102 feet

Type of completion (circle all applicable): Gravel packed Underreamed Telescoped Open hole  Natural Development

Other (describe): This well produced insignificant amt of water - abandoned & grouted up.

Top of lap pipe or reduction in casing: \_\_\_\_\_ feet. If telescoped or more than one screen, describe on back of page

Logs run (circle all applicable): No log run  Electric Gamma Ray Density Sonic Neutron Other: \_\_\_\_\_

Name of organization running log(s): OFFICE OF GEOLOGY

I certify that the well was drilled, constructed, and completed in accordance with all applicable requirements of the Mississippi Department of Environmental Quality and/or the Mississippi Department of Health regulations and state laws.

Mike Baughman 587  
Print Name of Water Well Contractor and License No.

Mike Baughman  
Signature of Water Well Contractor

03/02/1996 16:02 6014281435

A-1 DRILLING SERVICE

PAGE 12

C-26

If well telescopes please sketch below and show depths.

Ground Level

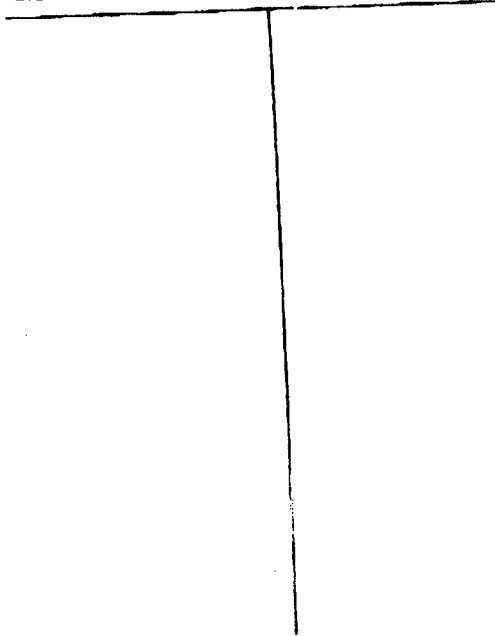

Description of Formations Encountered	From	To
Fill Red clay	0	2
Red sandy clay	2	6
Tan clay	6	11
Sandy clay	11	21
Sand	21	27
clay: sandy	27	43
algae tan	43	53
Sandy clay	53	83
Sand	83	102
Orange clay	102	129
Rock	129	129 1/2
Grey-green clay	129 1/2	130

If more than one screen, show location of each on sketch

Sketch the property layout and include the following: 1) the well location; 2) any permanent structures on the property that may aid in locating the well; 3) any roads, power lines, or other items that may aid in locating the property and the well; 4) indicate direction.

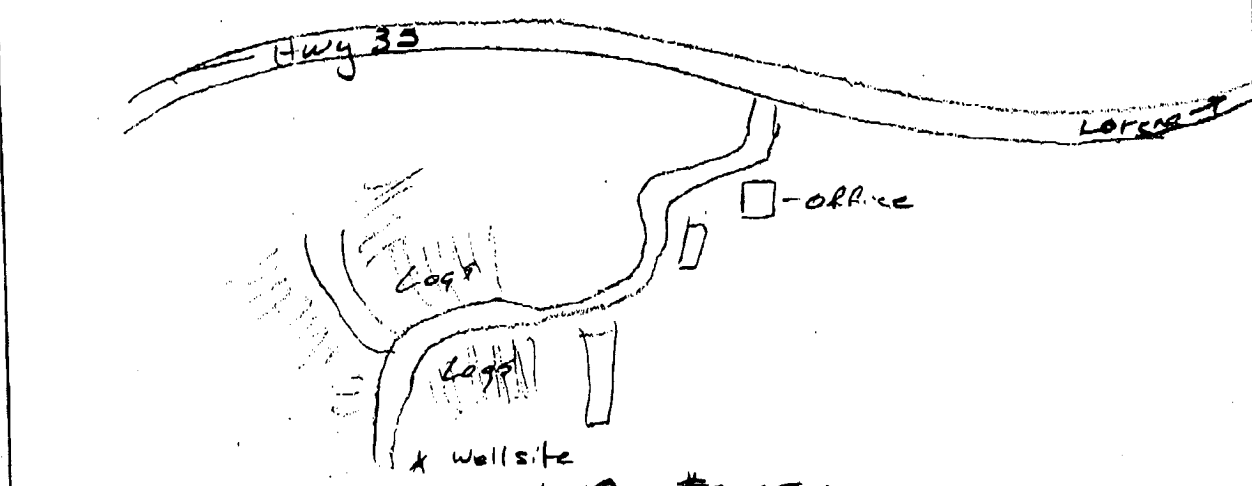

Landowner Name: BATTE LUMBER Co. #2005-1

*Steve Leigh*  
 \_\_\_\_\_  
 Signature of Water Well Contractor