

512

# STATE WELL REPORT

County: Simpson  
 Permit #: \_\_\_\_\_  
 Driller: J. Bradshaw  
 Date drilling completed: 7-18-19

**Part 1**  
**Driller's Log**  
 Mississippi Department of Environmental Quality  
 Office of Land and Water Resources  
 P.O. Box 2309  
 Jackson, MS 39225-2309  
 (601)961-5210  
 (601)360-0535 (fax)

**For Office Use Only:**  
 Well #: N 58  
 Aquifer: \_\_\_\_\_  
 E-Log #: \_\_\_\_\_

*State Law requires that this report be prepared by the license holder responsible for the work and filed with the Department at the above address within 30 days of completion of drilling of the well or borehole.*

Well Owner Information <i>(Landowner if borehole is not for a water well)</i>	Well or Borehole Location
Owner Name: <u>Luke Shivers</u>	Latitude: <u>31°48'55"W</u> Longitude: <u>89°59'35"W</u>
Mailing Address: <u>609 Hwy 435</u>	Method of Lat/Long (check one): Conventional Survey _____, USGS quad _____, Hand-held GPS <input checked="" type="checkbox"/> , Survey-grade GPS _____
<u>Pinola</u> MS <u>39149</u>	<u>SE</u> ¼ <u>SE</u> ¼, Sec <u>22</u> T <u>10N</u> R <u>20W</u>
City State Zip Code	<u>12</u> Miles <u>N</u> of <u>New Hebron</u>
Telephone No. (601) <u>874-5577</u>	(Distance) (Direction) (Nearest Town)

**Well / Borehole Data**

Date drilling started: 7-18-19 Date drilling completed: 7-18-19 Hole depth: 220 Hole diameter: 7

Location of the source of any surface water used for drilling: City

Method of dosing and volume of Chlorine used in drilling and development: N/A

Logs run (circle all applicable):  No log run  Electric  Gamma Ray  Density  Sonic  Neutron Other: \_\_\_\_\_

Name of organization running log(s): N/A

Purpose of borehole (circle one):  Water Well  Geotechnical/Geological Investigation  Ground Source Heat Pump  
 Seismic Survey Other (describe) Live Stock

**RECEIVED**  
**JUL 31 2019**  
**BY OLWR**

*If drilling is not related to water well construction, skip the remainder of this block*

Purpose of Well (circle all applicable): Home Industrial Public Supply Irrigation Fish Culture  
 Other (describe): Live Stock

If a flowing well, method of flow regulation: Valve \_\_\_\_\_ Other (describe) \_\_\_\_\_

Static Water Level: 122 feet [above or  below] land surface Date measured: 7-19-19  
 (circle one)

Method of measurement (circle one): Steel tape  Electric tape Air line Other (describe): \_\_\_\_\_

Well depth: 200 Well grouted to a depth of: 10 feet Type of grout (circle one):  Neat Cement Bentonite Mix

Casing length: 180 feet Casing diameter: 4 inches Type of casing: PVC

Screen length: 20 feet Screen diameter: 4 inches Type of screen: PVC

Screen slot size: #8 inches Setting depth: From 180 feet to 200 feet

Type of completion (circle all applicable): Gravel packed Underreamed Open hole  Natural Development

Other (describe): \_\_\_\_\_

Top of lap pipe or reduction in casing: \_\_\_\_\_ feet

*If telescoped or more than one screen, describe on next page*





# STATE WELL REPORT

## Part 2

**Pump Installer's Completion Report**  
 Mississippi Department of Environmental Quality  
 Office of Land and Water Resources  
 P.O. Box 2309  
 Jackson, MS 39225-2309  
 (601)961-5210  
 (601) 360-0535 (fax)

County: Simpson  
 Permit #: \_\_\_\_\_  
 Driller: J. Bradshaw  
 Date completed: 7-19-19  
Copy information from block on Part 1

**For Office Use Only:**

Well #: N 58  
 Aquifer: \_\_\_\_\_

*This part of the report must be completed by a licensed water well contractor or a licensed pump installer. A copy of Part 1 of the report must be attached and both parts filed with the Department at the above address within 30 days of well completion.*

Well Owner Information	Well Location
Owner Name: <u>Luke Shivers</u>	Latitude: <u>31°48'55"N</u> Longitude: <u>89°59'35"W</u>
Mailing Address: <u>609 Hwy 435</u>	Method of Lat/Long (check one): Conventional Survey _____, USGS quad _____, Hand-held GPS <input checked="" type="checkbox"/> , Survey-grade GPS _____
<u>Pinola</u> <u>MS</u> <u>39149</u> City State Zip Code	<u>SE</u> ¼ <u>SE</u> ¼, Sec <u>22</u> T <u>10N</u> R <u>20W</u>
Telephone No. <u>(601) 874-5577</u>	<u>12</u> Miles <u>N</u> of <u>New Hebron</u> (Distance) (Direction) (Nearest Town)

**Pump Type (circle one)**

Submersible  Turbine  Air Lift  Centrifugal  Flowing Well  Jet  Piston  Rotary  Other (describe): \_\_\_\_\_

Date Pump Installed: 7-19-19 Rated Pump Capacity: 10 Gallons Per Minute

Is This Pump (circle one):  New  Repaired  Replacement

**Power Type (circle one)**

Electric  Diesel  Gasoline  Natural Gas  Tractor PTO  Windmill  Other (describe): \_\_\_\_\_

Horse Power Rating of Motor: 1 Setting Depth: 170' feet Number of Stages: 11

**Pump Test Data for Non Flowing Well**

Date Well Tested: 7-19-19 Duration of Pump Test (minimum 4 hours): 6 hours

Static Water Level (A): 122 Feet Below Land Surface Pumping Water Level (B): 128 Feet Below Land Surface

Drawdown [(B) - (A)]: ~~6~~ 6 Feet Below Land Surface Test Pumping Rate: 20 Gallons Per Minute

Method of measurement (circle one): Steel tape  Electric tape  Air line  Other (describe): \_\_\_\_\_

**Pump Test Data for Flowing Well**

Measured shut in head: \_\_\_\_\_ feet.

Well yielded \_\_\_\_\_ GPM with a drawdown of \_\_\_\_\_ feet after \_\_\_\_\_ hours of pumping

**Meter Installation**

Meter Manufacturer: \_\_\_\_\_ Meter Serial Number: \_\_\_\_\_

Meter Model Number/Name: \_\_\_\_\_ Type of Meter: \_\_\_\_\_

Totalizer Register Unit and Multiplier Factor (AF x .001, gal x 1000, etc): \_\_\_\_\_

Installation Date: \_\_\_\_\_ Meter installed by: \_\_\_\_\_

Is This Meter (circle one):  New  Repaired  Replacement

*Important: By submitting the above information you are certifying that this meter was installed to manufacturer standards. For agricultural wells, a list of approved meters is on the MDEQ website.*

I HEREBY CERTIFY that the above statements are true to the best of my knowledge.

J. Bradshaw 7871 7-19-19  
 Print Name of Pump Installer and License No. (if applicable) Date Signature of Pump Installer



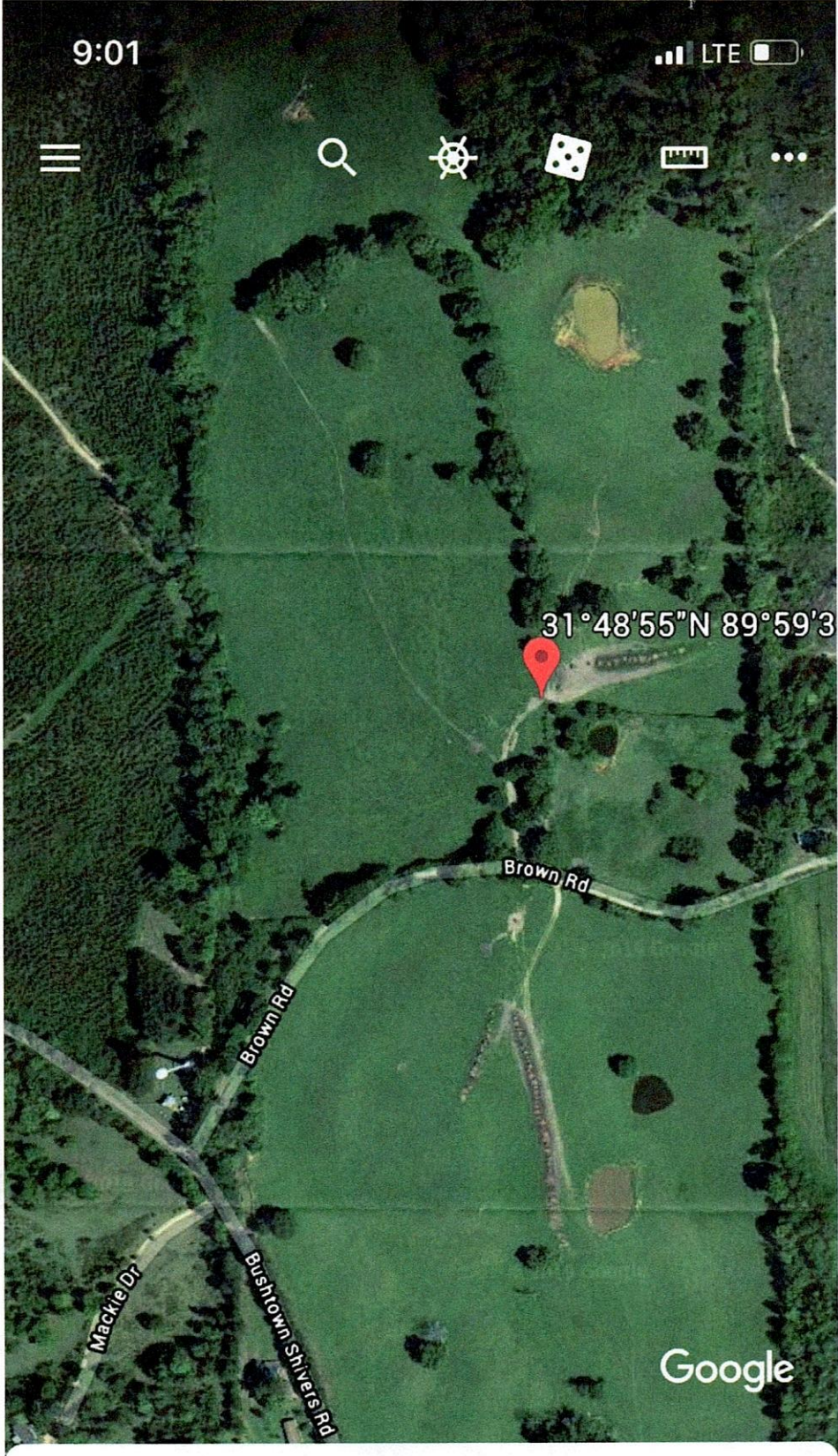

9:01

LTE



31°48'55"N 89°59'3



Brown Rd

Brown Rd

Mackie Dr

Bushtown Shivers Rd

Google

### Dropped Pin

31°48'55"N 89°59'35"W · 516 ft



Measure



RECEIVED

JUL 31 2019

BY OLWR



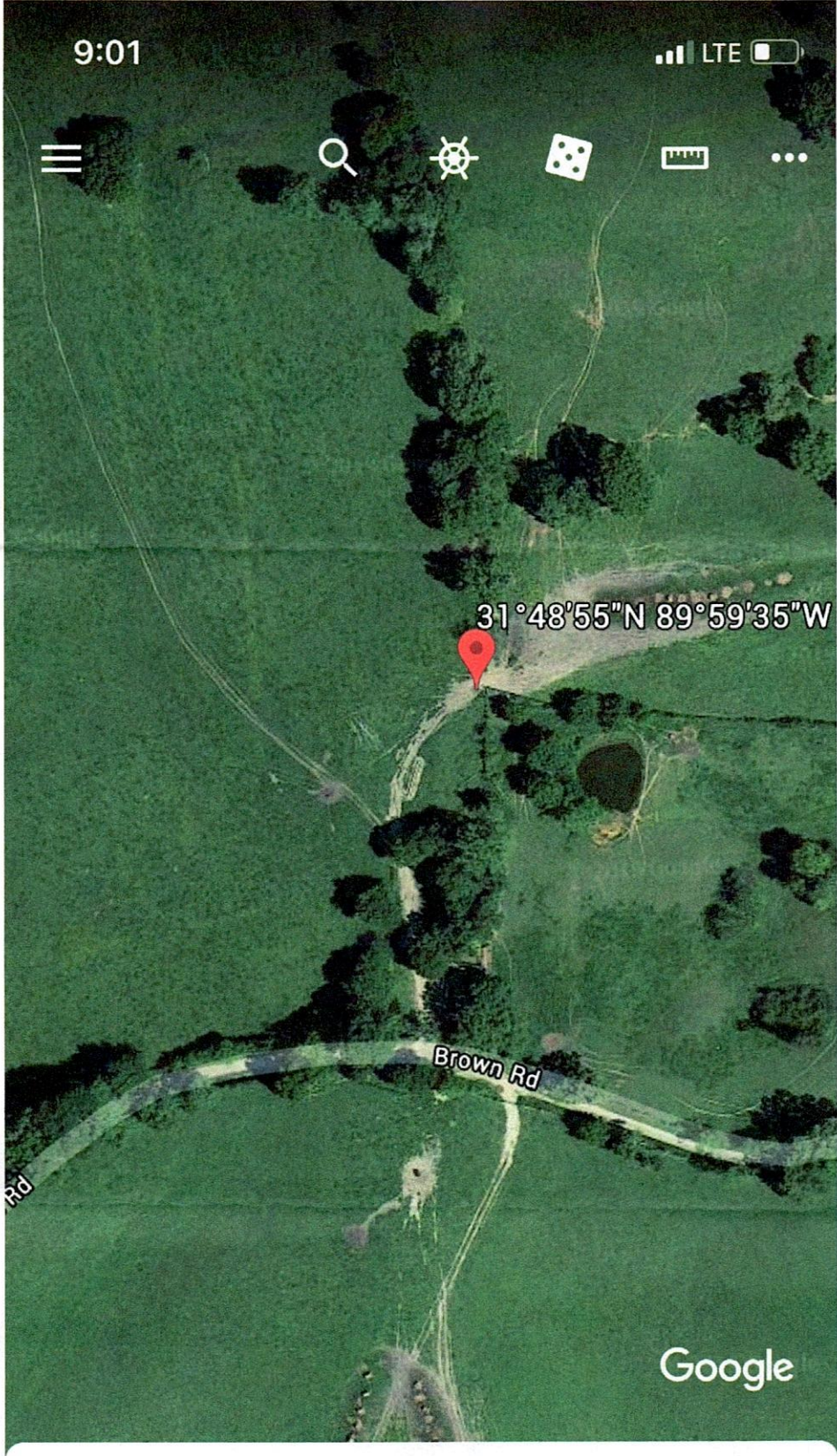

**Dropped Pin**

31°48'55"N 89°59'35"W · 516 ft

 Measure

×

**RECEIVED**  
**JUL 31 2019**  
**BY OLWR**





**Dropped Pin**

31°48'55"N 89°59'35"W · 516 ft

 Measure

×  
**RECEIVED**  
**JUL 31 2019**  
**BY OLV**