

MFU 22-9 # 2

### State Well Report

#### Part 1

Mississippi Department of Environmental Quality  
Office of Land and Water Resources  
P.O. Box 10631  
Jackson, MS 39289-0631  
(601)961-5210  
(601)354-6938 (fax)

**For Office Use Only:**

Aquifer: \_\_\_\_\_  
Well #: E 75  
L. S. Elevation: \_\_\_\_\_  
E-log #: \_\_\_\_\_

County: Simpson  
Permit #: \_\_\_\_\_  
Driller: John W Thompson  
Date drilling completed: 5-9-08

State Law requires that this report be prepared by the driller in detail and filed with the Department within 30 days of completion of drilling of the well.

Well Owner Information	Well Location
Owner Name: <u>De-bury Onshore</u>	Latitude: _____ Longitude: _____
Mailing Address: <u>P.O. Box 6506</u> <u>Laurel MS</u>	Method of Lat/Long (circle one): Conventional Survey, USGS quad, Hand-held GPS, Survey-grade GPS
City: _____ State: _____ Zip Code: _____	<u>1/4</u> <u>1/4</u> Sec <u>22</u> Twn <u>2N</u> Rng <u>5E</u>
Telephone No. (____) _____	Distance _____ Direction <u>NE</u> Nearest Town <u>Mendenhall</u>

**Well Data**

Purpose of Well (circle one) Home Industrial Public Supply Irrigation Fish Culture Other: rig supply

Date well drilling started: 5-6-08 Date well drilling completed: 5-9-08

If flowing, method of flow regulation: Valve \_\_\_\_\_ Other (describe) \_\_\_\_\_

Static Water Level: 156 feet above or below (circle one) land surface Date measured: 5-9-08

Method of Measurement (circle one) steel tape electric tape air line other: \_\_\_\_\_

Hole depth: 320 Well depth: 310 Well grouted to a depth of 20 feet

Type of grout (circle one): Cement Bentonite Mix

Casing length: 260 feet Casing diameter: 4 inches Type of casing: PVC

Screen length: 50 feet Screen diameter: 4 inches Type of screen: PVC Slotted

Screen slot size: .010 inches Setting depth: From 260 feet to 310 feet

Type of completion (circle all applicable): Gravel packed Underreamed Telescoped Open hole Natural Development

Other (describe): \_\_\_\_\_

Top of lap pipe or reduction in casing: \_\_\_\_\_ feet. If telescoped or more than one screen, describe on back of page

Logs run (circle all applicable): No log run Electric Gamma Ray Density Sonic Neutron Other: \_\_\_\_\_

Name of organization running log(s): \_\_\_\_\_

I certify that the well was drilled, constructed, and completed in accordance with all applicable requirements of the Mississippi Department of Environmental Quality and/or the Mississippi Department of Health regulations and state laws.

John W Thompson 0-679  
Print Name of Water Well Contractor and License No.

John W Thompson  
Signature of Water Well Contractor

RECEIVED  
MAY 23 2008  
BY: OLWR

If well telescopes please sketch below and show depths

Ground Level

--

Description of Formations Encountered	From	To
sand	0	6
sand & clay strips	6	55
rock & clay strips	55	85
clay	85	117
sand & clay	117	147
clay	147	245
clay & fine sand	245	260
sand	260	310
clay	310	320

If more than one screen, show location of each on sketch

Sketch the property layout and include the following: 1) the well location; 2) any permanent structures on the property that may aid in locating the well; 3) any roads, power lines, or other items that may aid in locating the property and the well; 4) indicate direction.

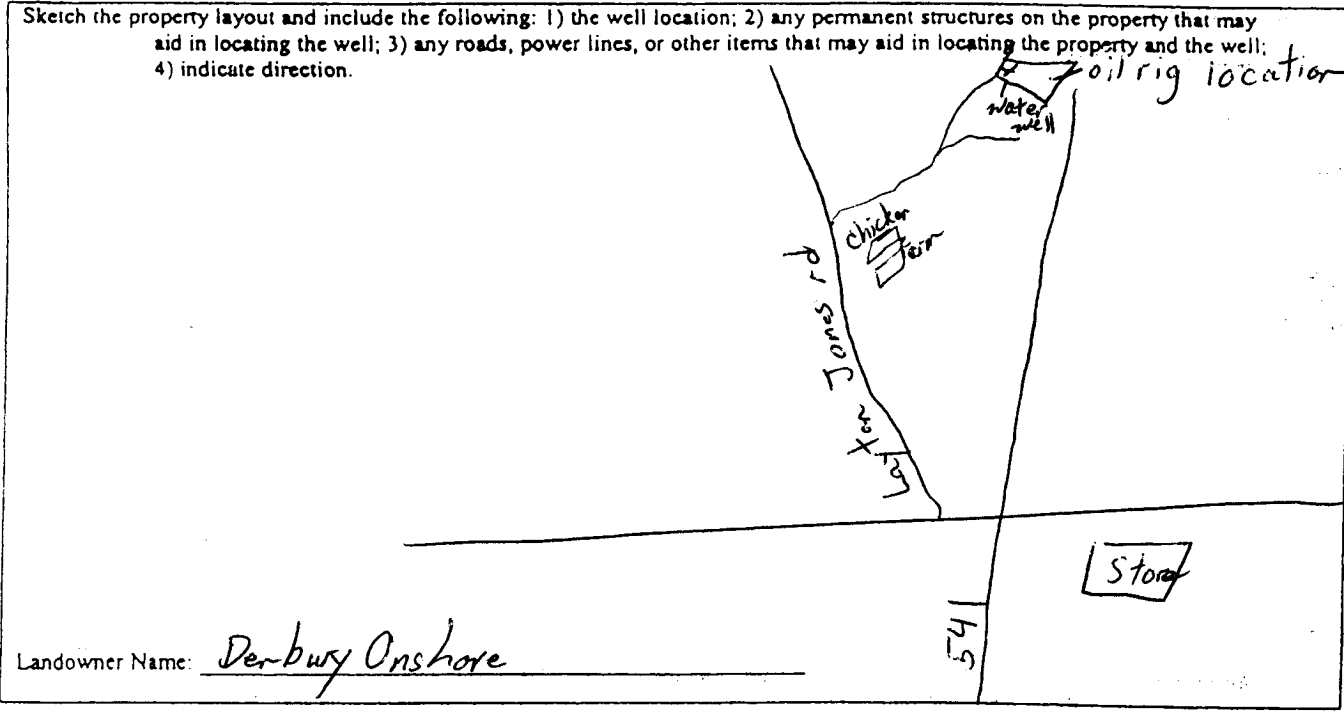

Landowner Name: Derbury Onshore

John W Thompson  
 Signature of Water Well Contractor

# STATE WELL REPORT

## Part 2

**Pump Installer's Completion Report**  
 Mississippi Department of Environmental Quality  
 Office of Land and Water Resources  
 P.O. Box 10631  
 Jackson, MS 39289-0631  
 (601)961-5210  
 (601)354-6938 (fax)

County: Simpson  
 Permit #: \_\_\_\_\_  
 Driller: John W Thompson  
 Date completed: 5-9-08  
*Copy information from block on Part 1*

**For Office Use Only:**

Aquifer: \_\_\_\_\_  
 Well #: E 75  
 Elevation: \_\_\_\_\_

*This part of the report must be completed by a licensed water well contractor or a licensed pump installer. A copy of Part 1 of the report must be attached and both parts filed with the Department at the above address within 30 days of well completion.*

Well Owner Information	Well Location
Owner Name: <u>Denbury Onshore</u>	Latitude: _____ Longitude: _____
Mailing Address: <u>P.O. Box 6506</u>	Method of Lat/Long (check one): Conventional Survey _____
<u>Laurel MS</u>	USGS quad _____, Hand-held GPS _____, Survey-grade GPS _____
City State Zip Code	_____ 1/4 _____ 1/4 Sec <u>22</u> T <u>2N</u> R <u>5E</u>
Telephone No. ( ) _____	Distance Direction Nearest Town
	<u>5</u> Miles <u>NE</u> of <u>Mendenhall</u>

Pump Type Circle one	Power Type Circle one
Air Lift Jet <input checked="" type="radio"/> <u>Submersible</u>	Diesel Engine Gasoline Engine Natural Gas
Bucket Piston Turbine <input checked="" type="radio"/> <u>Electric Motor</u>	Hand Tractor PTO
Centrifugal Rotary Flowing Well	Windmill Other (specify): _____
Other (specify): _____	Horse Power Rating of Motor: <u>5</u>
Date Pump Installed: <u>5-9-08</u>	Setting Depth: <u>200</u> feet
Rated Pump Capacity: <u>55</u> Gallons Per Minute	Number of Stages: _____

Pump Test Data	Method of Measuring Water Level Circle one
Date Well Tested: <u>5-9-08</u>	Air Line <input checked="" type="radio"/> <u>Electric Measuring Line</u> Steel Tape
Static Water Level (A): <u>156</u> Feet Below Land Surface	Other (specify): _____
Pumping Water Level (B): <u>160</u> Feet Below Land Surface	For flowing well, measured shut in head: _____ feet
Drawdown [(B) - (A)]: <u>4</u> Feet Below Land Surface	Well yielded <u>45</u> GPM with a drawdown of
Test Pumping Rate: <u>45</u> Gallons Per Minute	<u>4</u> feet after <u>4</u> hours of pumping
Duration of Pump Test (minimum 4 hours): <u>4</u> hours	

I HEREBY CERTIFY that the above statements are true to the best of my knowledge.

John W Thompson 0-679 John W Thompson  
 Print Name of Pump Installer and License No. (if applicable) Signature of Pump Installer

Form: OLWR-SWR-1B

RECEIVED

MAY 23 2008

BY: OLWR