

County: Sharkey  
 Permit #: GW-49817 ✓  
 Driller: Irrigation Equipment, Inc.  
 Date drilling completed: 3-20-17

# STATE WELL REPORT

## Part 1

### Driller's Log

Mississippi Department of Environmental Quality  
 Office of Land and Water Resources  
 P.O. Box 2309  
 Jackson, MS 39225-2309  
 (601) 961-5210  
 (601) 360-0535 (fax)

**For Office Use Only:**  
 Well #: E101  
 Aquifer: \_\_\_\_\_  
 E-Log #: \_\_\_\_\_

*State Law requires that this report be prepared by the license holder responsible for the work and filed with the Department at the above address within 30 days of completion of drilling of the well or borehole.*

Well Owner Information <i>(Landowner if borehole is not for a water well)</i>	Well or Borehole Location
Owner Name: <u>Sandy Bayou Farms / Chris Martin</u>	Latitude: <u>32° 53' 23.7"</u> Longitude: <u>090° 53' 43.9"</u>
Mailing Address: <u>5415 Sandy Bayou Road</u>	Method of Lat/Long (check one): <input type="checkbox"/> Conventional Survey, <input type="checkbox"/> USGS quad, <input checked="" type="checkbox"/> Hand-held GPS, <input type="checkbox"/> Survey-grade GPS
<u>Rolling Fork</u> <u>MS</u> <u>39159</u> City State Zip code	<u>NE 1/4 NE 1/4, Sec 15 T 12N R 7W</u>
Telephone No. <u>( ) -</u>	<u>SW</u> of <u>Rolling Fork</u> (Distance) (Direction) (Nearest Town)

**Well / Borehole Data**

Date drilling started: 3-20-17 Date drilling completed: 3-20-17 Hole depth: 128' Hole diameter: 24"

Location of the source of any surface water used for drilling: Surface Water

Method of dosing and volume of Chlorine used in drilling and development: 50 PPM

Logs run (check all applicable):  No log run  Electric  Gamma Ray  Density  Sonic  Neutron  Other: \_\_\_\_\_

Name of organization running log(s): \_\_\_\_\_

Purpose of borehole (check one):  Water Well  Geotechnical/Geological Investigation  Ground Source Heat Pump  
 Seismic Survey  Other (describe) \_\_\_\_\_

*If drilling is not related to water well construction, skip the remainder of this block*

Purpose of Well (check all applicable):  Home  Industrial  Public Supply  Irrigation  Fish Culture  
 Other (describe): \_\_\_\_\_

If a flowing well, method of flow regulation: Valve \_\_\_\_\_ Other (describe) \_\_\_\_\_

Static Water Level: 18' feet [ above or  below] land surface Date measured: 3-21-17  
 (check one)

Method of Measurement (check one)  Steel tape  Electric tape  Air line  Other: (describe) \_\_\_\_\_

Well depth: 128' Well grouted to a depth of: 10 feet Type of grout (check one):  Neat Cement  Bentonite  Mix

Casing length: 88 feet Casing diameter: 16 inches Type of casing: PVC

Screen length: 40 feet Screen diameter: 16 inches Type of screen: PVC

Screen slot size: .050 inches Setting depth: From 89 feet to 128 feet

Type of completion (check all applicable):  Gravel packed  Underreamed  Open hole  Natural Development  
 Other (describe): \_\_\_\_\_

Top of lap pipe or reduction in casing: \_\_\_\_\_ Feet

*If telescoped or more than one screen, describe on next page*

RECEIVED

MAY 15 2017

Form: OLWR-SWR-VA (4/13)

BY OLWR

County: Sharkey  
 Permit #: GW-49817

**For Office Use Only:**  
 Well #: E101

*The sketch below only required for water wells*

*If well telescopes, show depths on sketch.*

Ground level →

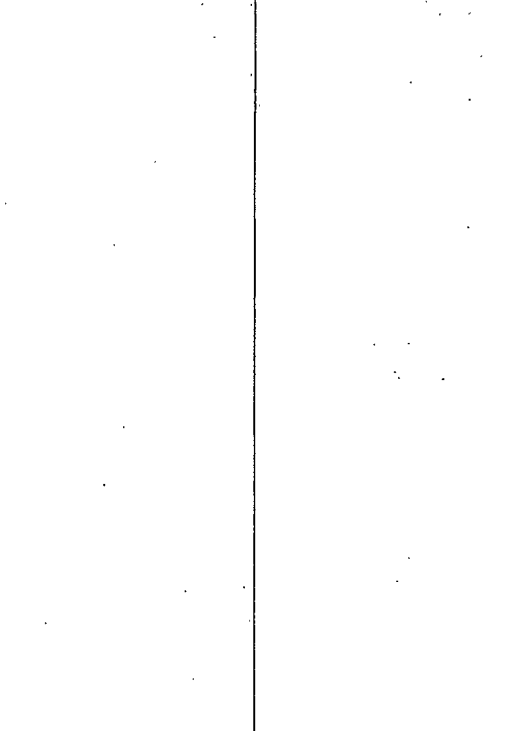

**Description of formations encountered must be provided for all wells and boreholes, unless specifically exempted by regulations**

Description of Formations Encountered	From (depth)	To (depth)
<b>Clay</b>	Ground level	<b>35</b>
<b>Fine Sand</b>	<b>36</b>	<b>62</b>
<b>Fine Sand &amp; Gravel</b>	<b>63</b>	<b>73</b>
<b>Med. Sand &amp; Gravel</b>	<b>74</b>	<b>128</b>

If more than one screen, show location of each on sketch

- Sketch the property layout and include the following:
- 1) the well location
  - 2) any permanent structures on the property that may aid in locating the well
  - 3) any roads, power lines, or other items that may aid in locating the property and the well
  - 4) a north arrow

RECEIVED  
 MAY 15 2017  
 BY OLWR

Landowner Name: \_\_\_\_\_

I HEREBY CERTIFY that the well/borehole was drilled, constructed, and completed in accordance with all applicable requirements of the Mississippi Department of Environmental Quality and the Mississippi Department of Health regulations, if applicable, and state laws.

**0695** \_\_\_\_\_ **5-10-17** \_\_\_\_\_  
 Print Name of Responsible Licensee and License No.      Date      Signature of Licensee

Form: OLWR-SWR-1A (4/13)

County: Sharkey  
 Permit #: GW-49817  
 Driller: Irrigation Equipment, Inc.  
 Date drilling completed: 3-20-17  
Copy information from block on Part 1

**STATE WELL REPORT**  
**Part 2**  
**Pump Installer's Completion Report**  
 Mississippi Department of Environmental Quality  
 Office of Land and Water Resources  
 P.O. Box 2309  
 Jackson, MS 39225-2309  
 (601) 961-5210  
 (601) 360-0535 (fax)

**For Office Use Only:**

Well #: E101  
 Aquifer: \_\_\_\_\_

*This part of the report must be completed by a licensed water well contractor or a licensed pump installer. A copy of Part 1 of the report must be attached and both parts filed with the Department at the above address within 30 days of well completion.*

Well Owner Information	Well Location
Owner Name: <u>Sandy Bayou Farms / Chris Martin</u>	Latitude: <u>32° 53' 23.7"</u> Longitude: <u>090° 53' 43.9"</u>
Mailing Address: <u>5415 Sandy Bayou Road</u>	Method of Lat/Long (check one): <input type="checkbox"/> Conventional Survey, <input type="checkbox"/> USGS quad, <input checked="" type="checkbox"/> Hand-held GPS, <input type="checkbox"/> Survey-grade GPS
<u>Rolling Fork</u> <u>MS</u> <u>39159</u> City State Zip code	<u>NE ¼ NE ¼, Sec 15 T 12N R 7W</u>
Telephone No. <u>( ) -</u>	<u>SW</u> of <u>Rolling Fork</u> (Distance) (Direction) (Nearest Town)

**Pump Type (check one)**

Submersible  Turbine  Air Lift  Centrifugal  Flowing Well  Jet  Piston  Rotary  Other (describe): \_\_\_\_\_

Date Pump Installed 3-21-17 Rated Pump Capacity: 1500+/- Gallons Per Minute

Is This Pump (check one):  New  Repaired  Replacement

**Power Type (check one)**

Electric  Diesel  Gasoline  Natural Gas  Tractor PTO  Windmill  Other (describe): \_\_\_\_\_

Horse Power Rating of Motor: 50 Setting Depth: 80 feet Number of Stages: 1

**Pump Test Data for Non Flowing Well**

Date Well Tested: \_\_\_\_\_ Duration of Pump Test (minimum 4 hours): \_\_\_\_\_ Hours

Static Water Level (A): \_\_\_\_\_ Feet Below Land Surface Pumping Water Level (B): \_\_\_\_\_ Feet Below Land Surface

Drawdown [(B) - (A)]: \_\_\_\_\_ Feet Below Land Surface Test Pumping Rate: \_\_\_\_\_ Gallons Per Minute

Method of measurement (check one):  Steel tape  Electric tape  Air line  Other (describe): \_\_\_\_\_

**Pump Test Data for Flowing Well**

Measured shut in head: \_\_\_\_\_ Feet

Well yielded \_\_\_\_\_ GPM with a drawdown of \_\_\_\_\_ feet after \_\_\_\_\_ hours of pumping

**Meter Installation**

Meter Manufacturer: \_\_\_\_\_ Meter Serial Number: \_\_\_\_\_

Meter Model Number/Name: \_\_\_\_\_ Type of Meter: \_\_\_\_\_

Totalizer Register Unit and Multiplier Factor (AF x .001, gal x 1000, etc): \_\_\_\_\_

Installation Date: \_\_\_\_\_ Meter installed by: \_\_\_\_\_

Is This Meter (check one):  New  Repaired  Replacement

*Important: By submitting the above information you are certifying that this meter was installed to manufacturer standards.  
 For agricultural wells, a list of approved meters is on the MDEQ website.*

I HEREBY CERTIFY that the above statements are true to the best of my knowledge.

0695 5-10-17  
 Print Name of Pump Installer and License No. (if applicable) Date Signature of Pump Installer

Form: OLWR-SWR-1B (4/13)

**STATE OF MISSISSIPPI**  
**Department of Environmental Quality**  
**Office of Land and Water Resources**  
**P. O. Box 2309**  
**Jackson, Mississippi 39225**

**PERMIT**

**TO DIVERT OR WITHDRAW FOR BENEFICIAL USE THE PUBLIC WATERS**

This permit is issued to the landowner named below in accordance with the provisions of the Mississippi Water Laws, Mississippi Code Sections 51-3-1, et seq. (1972, as amended), and the regulations and standards as promulgated thereunder. Whether or not specifically named in this permit or in the applications for this permit, anyone using water from the diversion/withdrawal point described below shall do so in compliance with the provisions of this permit. Neither this permit, nor any authority conferred hereby, may be sold, conveyed, encumbered, assigned, or otherwise aliened, for any period of time or under any conditions whatsoever. This permit may not be modified, transferred or revoked without prior action by the Permit Board. Any attempts to modify, transfer or revoke this permit, or to take any other action on this permit, shall be invalid and unenforceable and may result in immediate revocation or suspension of this permit. The holder of this permit shall at all times be responsible for adherence to the terms and conditions of this permit. No agreement between the permit holder and any other party shall affect the obligations and liabilities of the permit holder. Water use under this permit is allowed only when the streamflow, lake level elevation, or static groundwater level (whichever, if any, is applicable) is above the established minimum, pursuant to Mississippi Code Section 51-3-7. Authorization is hereby granted to divert/withdraw water for the beneficial use designated herein, and for no other purpose, subject to the following terms, conditions, and limitations:

**Permit Number:** MS-GW-49817

**Landowner Name:** SANDY BAYOU LAND AND TIMBER

**Landowner Address:** 5415 SANDY BAYOU ROAD  
ROLLING FORK MS 39159

**Source Of Water:** MISSISSIPPI RIVER VALLEY ALLUVIAL AQUIFER

**Beneficial Use:** IRRIGATION

**Diversion/Withdrawal Location:** NE 1/4 of the NE 1/4 **Section:** 15 **Township:** 12N **Range:** 07W

**County:** SHARKEY

**Quad:** ROLLING FORK WEST

**Maximum Volume:** 120 Acre-Feet/Year *equivalent to* .1071 Million Gallons/Day

**Maximum Rate:** 2500 Gallons/Minute

**Applicant Name:** SANDY BAYOU FARMS

**Applicant Address:** 5415 SANDY BAYOU ROAD  
ROLLING FORK MS 39159

**Date Permit Issued:** 02/06/2017

**Date Permit Expires:** 02/06/2022

**Date Permit Modified:**

**Date Permit Re-issued:**

This permit shall be deemed null and void if construction has not begun within one (1) year of permit issue date

**SPECIAL TERMS AND CONDITIONS:** SEE ATTACHMENT 1, WHICH IS HEREBY DECLARED TO BE PART OF THIS PERMIT.

**SPECIAL TERMS AND CONDITIONS:** 2:

RECEIVED  
MAY 15 2017  
BY OLWR



Gary C. Rikard, Executive Director  
Mississippi Department of Environmental Quality

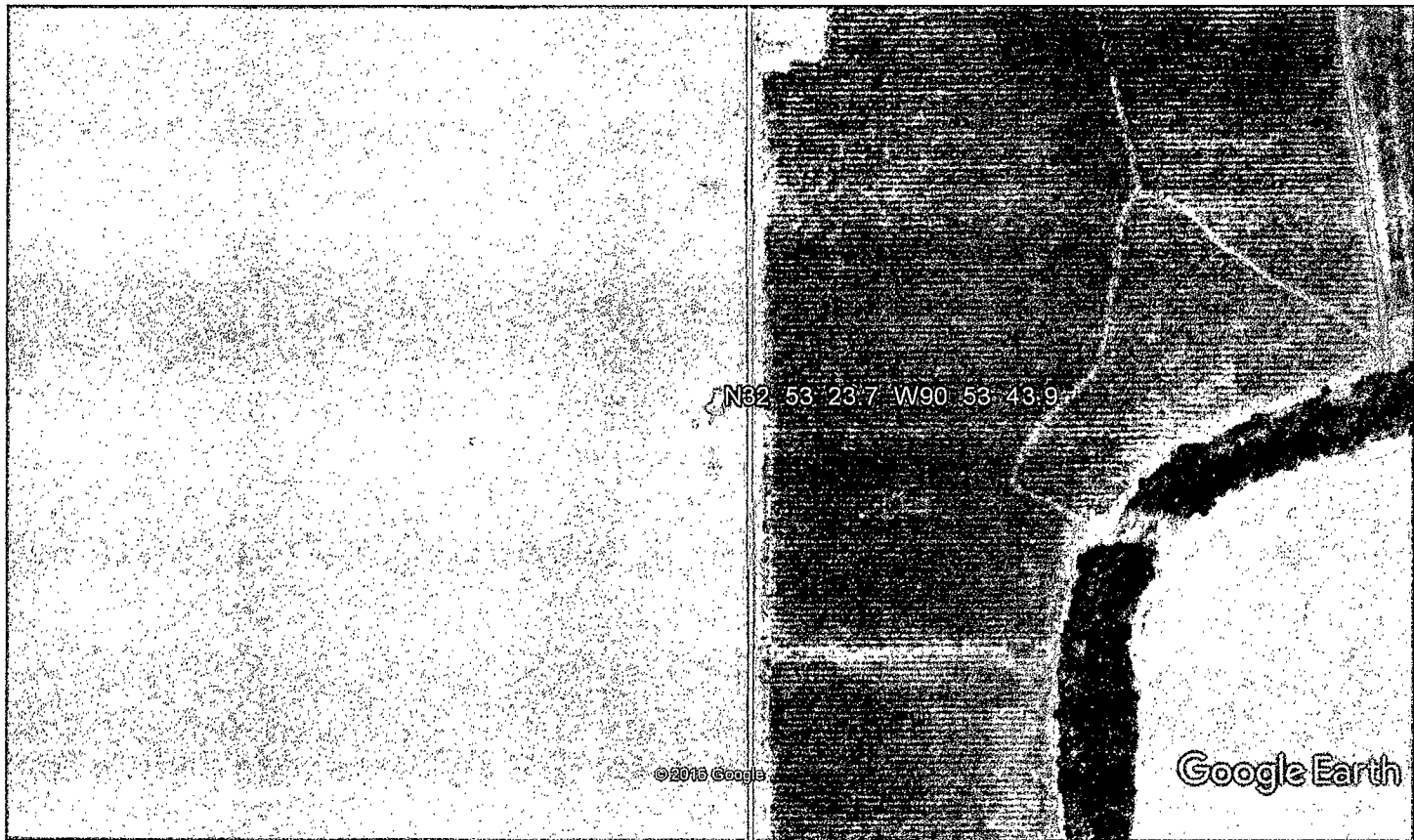

©2015 Google

Google Earth

Google Earth



RECEIVED  
 MAY 15 2017  
 BY OLWR