

STATE WELL REPORT

Part 1

Driller's Log

Mississippi Department of Environmental Quality
Office of Land and Water Resources
P.O. Box 2309
Jackson, MS 39225-2309
(601)961-5210
(601)360-0535 (fax)

County: Sharkey
Permit #: MS BW 49584
Driller: _____
Date drilling completed: 9-14-14

For Office Use Only:

Well #: D 603
Aquifer: _____
E-Log #: _____

State Law requires that this report be prepared by the license holder responsible for the work and filed with the Department at the above address within 30 days of completion of drilling of the well or borehole.

Well Owner Information <small>(Landowner if borehole is not for a water well)</small>	Well or Borehole Location
Owner Name: <u>Evans Alty. Co.</u>	Latitude: <u>32 56 38</u> Longitude: <u>90 39 53</u>
Mailing Address: <u>4164 Straight Bayou Rd.</u>	Method of Lat/Long (check one): Conventional Survey _____
<u>Anguilla</u> MS <u>38721</u>	USGS quad _____ Hand-held GPS _____ Survey-grade GPS _____
City State Zip Code	<u>NW 1/4 SE 1/4</u> , Sec <u>25</u> T <u>13N</u> R <u>05W</u>
Telephone No. (____) _____	_____ Miles _____ of _____ (Distance) (Direction) (Nearest Town)

Well / Borehole Data

Date drilling started: 9/14/14 Date drilling completed: 9/14/14 Hole depth: 117 Hole diameter: 26

Location of the source of any surface water used for drilling: _____

Method of dosing and volume of Chlorine used in drilling and development: _____

Logs run (circle all applicable): No log run Electric Gamma Ray Density Sonic Neutron Other: _____

Name of organization running log(s): _____

Purpose of borehole (circle one): Water Well Geotechnical/Geological Investigation Ground Source Heat Pump
Seismic Survey Other (describe) _____

If drilling is not related to water well construction, skip the remainder of this block

Purpose of Well (circle all applicable): Home Industrial Public Supply Irrigation Fish Culture

Other (describe): _____

If a flowing well, method of flow regulation: Valve _____ Other (describe) _____

Static Water Level: 28 feet [above or below] land surface Date measured: _____
(circle one)

Method of measurement (circle one): Steel tape Electric tape Air line Other (describe): _____

Well depth: 117 Well grouted to a depth of: 10 feet Type of grout (circle one): Neat Cement Bentonite Mix

Casing length: 77 feet Casing diameter: 16 inches Type of casing: PVC

Screen length: 40 feet Screen diameter: 16 inches Type of screen: PVC

Screen slot size: 0.32 inches Setting depth: From 77 feet to 117 feet

Type of completion (circle all applicable): Gravel packed Underreamed Open hole Natural Development

Other (describe): _____

Top of lap pipe or reduction in casing: _____ feet

If telescoped or more than one screen, describe on next page

RECEIVED

OCT 17 2014 (4/13)

BY OLWR

D63

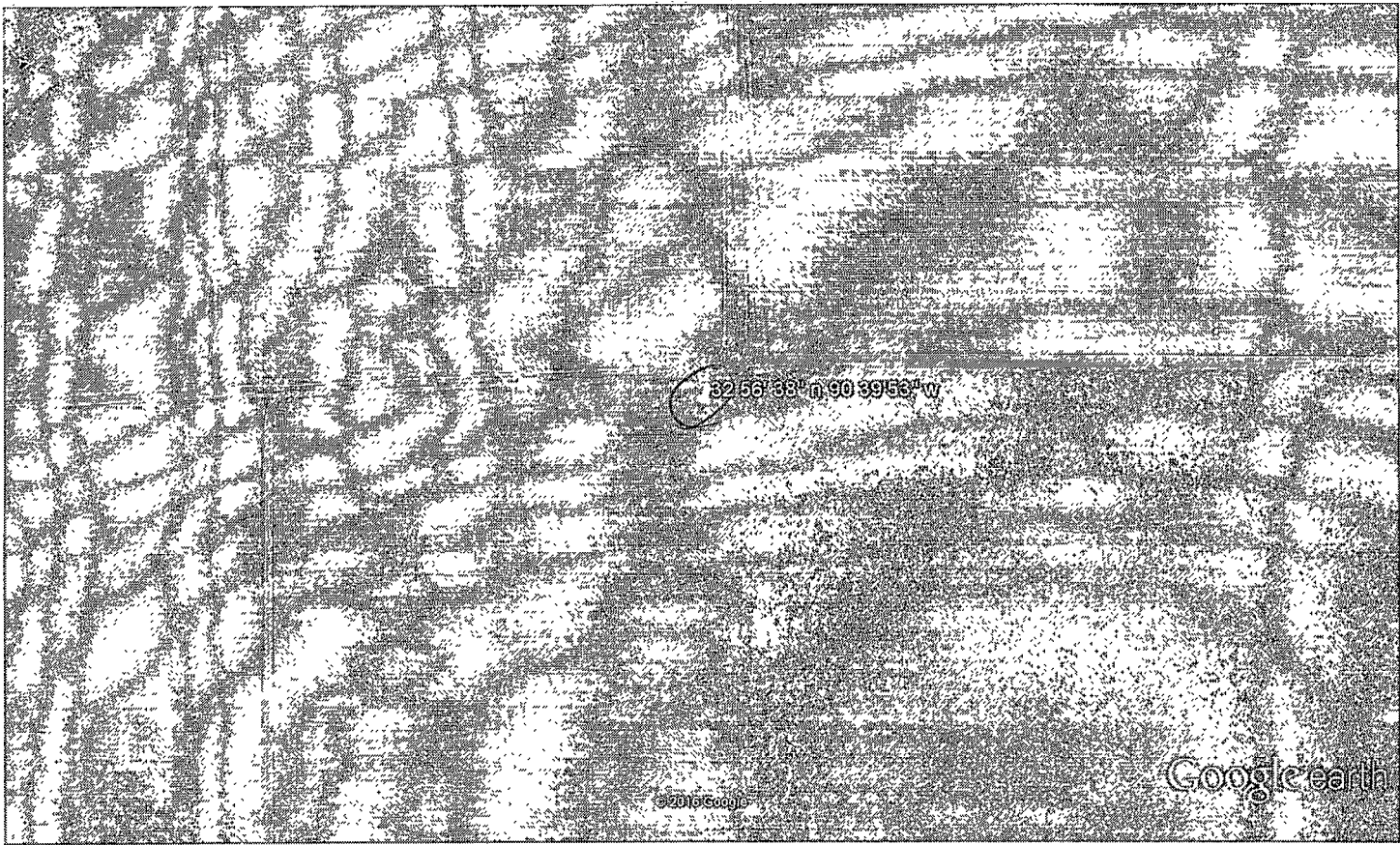

32°56'35\"/>

© 2016 Google

Google earth

Google earth



RECEIVED
OCT 17 2016
BY OLWR

D 103

Dean A. Pennington, PhD
Executive Director

P. O. Box 129
Stoneville, MS 38776

Tel.: (662) 686-7712

Fax: (662) 686-9078

www.ymd.org



Yazoo Mississippi Delta Joint Water Management District

July 5, 2016

RECEIVED

OCT 17 2016

BY OLWR

Evans Planting Co.
4164 Straight Bayou Rd
Anguilla MS 38721

RE: Receipt for Notification of Construction of Replacement Well MS-GW-49584
which will be replacing GW-03667 located at

Location: NE ¼ of the SW ¼ Section 25 Township 13N Range 05W County Sharkey
Latitude: 32 56 38 Longitude 90 39 53

Dear Evans Planting Co.:

This letter acknowledges your notification to the state that you intend to replace a previously permitted well in the Mississippi River Valley Alluvial Aquifer and that this replacement construction will meet the requirements for a groundwater replacement well specified in 11 Miss. Admin. Code Part 7, Chapter 1, Rule 1.4.F.1 (see attached/back of page). Construction may begin immediately on your replacement well.

Remember that you are still required to submit a permit application (enclosed) for the replacement well within 5 days of construction beginning. You are also required to properly decommission (plug and abandon) the replaced well within 180 days of the replacement well's construction.

A copy of this letter, or a water use permit for the replacement well, must be attached to the State Well Report submitted by your driller to MDEQ and they must also submit a copy to YMD, as specified in the Water Well Contractor regulations found in 11 Miss. Admin. Code Part 7, Chapter 2, Rule 2.9.

If you have any questions, please call YMD at 662-686-7712.

Sincerely,

Dillard Melton, Jr
Permitting Director