

# State Well Report

## Part 1

Mississippi Department of Environmental Quality  
Office of Land and Water Resources  
P.O. Box 10631  
Jackson, MS 39289-0631  
(601)961-5210  
(601)354-6938 (fax)

### For Office Use Only:

Aquifer: \_\_\_\_\_  
Well #: A-152  
L. S. Elevation: \_\_\_\_\_  
E-log #: \_\_\_\_\_

County: SHARKEY  
Permit #: 01042403  
Driller: J. NEWCOME 0-773  
Date drilling completed: 3-18-08

State Law requires that this report be prepared by the driller in detail and filed with the Department within 30 days of completion of drilling of the well.

Well Owner Information	Well Location
Owner Name: <u>GRACEWOOD FARMS</u>	Latitude: <u>33° 05' 45"</u> Longitude: <u>90° 46' 13"</u>
Mailing Address: <u>10 GENE STOCK</u> <u>1371 MURPHY RD.</u> <u>HOLLANDALE, MS 38748</u> City State Zip Code	Method of Lat/Long (circle one): Conventional Survey, USGS quad, <u>Hand-held GPS</u> , Survey-grade GPS
Telephone: <u>602-820-6668</u>	<u>NE</u> ¼ <u>NW</u> ¼ Sec <u>1</u> Twn <u>14N</u> Rng <u>6W</u>
	Distance <u>1.5</u> Miles Direction <u>N.E.</u> of Nearest Town <u>DELTA CITY</u>

### Well Data

Purpose of Well (circle one) Home Industrial Public Supply Irrigation Fish Culture Other: \_\_\_\_\_

Date well drilling started: 3-18-08 Date well drilling completed: 3-18-08

If flowing, method of flow regulation: Valve \_\_\_\_\_ Other (describe) \_\_\_\_\_

Static Water Level: \_\_\_\_\_ feet above or below (circle one) land surface Date measured: \_\_\_\_\_

Method of Measurement (circle one) steel tape electric tape air line other: \_\_\_\_\_

Hole depth: 103 Well depth: 100 Well grouted to a depth of 10 feet

Type of grout (circle one): Cement Bentonite Mix

Casing length: 60 feet Casing diameter: 16 inches Type of casing: PVC

Screen length: 40 feet Screen diameter: 16 inches Type of screen: PVC

Screen slot size: 050 inches Setting depth: From 60 feet to 100 feet

Type of completion (circle all applicable): Gravel packed Underreamed Telescoped Open hole Natural Development  
Other (describe): \_\_\_\_\_

Top of lap pipe or reduction in casing: \_\_\_\_\_ feet. If telescoped or more than one screen, describe on back of page

Logs run (circle all applicable): No log run Electric Gamma Ray Density Sonic Neutron Other: \_\_\_\_\_

Name of organization running log(s): \_\_\_\_\_

I certify that the well was drilled, constructed, and completed in accordance with all applicable requirements of the Mississippi Department of Environmental Quality and/or the Mississippi Department of Health regulations and state laws.

JOHN NEWCOME 0-773  
Print Name of Water Well Contractor and License No.

[Signature]  
Signature of Water Well Contractor

RECEIVED  
APR 10 2008  
BY: OLWR

If well telescopes please sketch below and show depths.

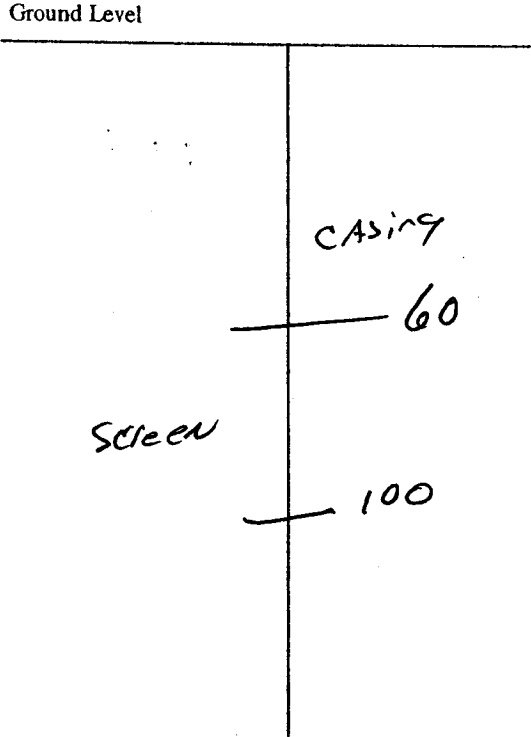

Description of Formations Encountered	From	To
TOP Soil	0	10
Mix CLAY	10	40
FINE SAND	40	60
COARSE Sand - gravel	60	103

If more than one screen, show location of each on sketch

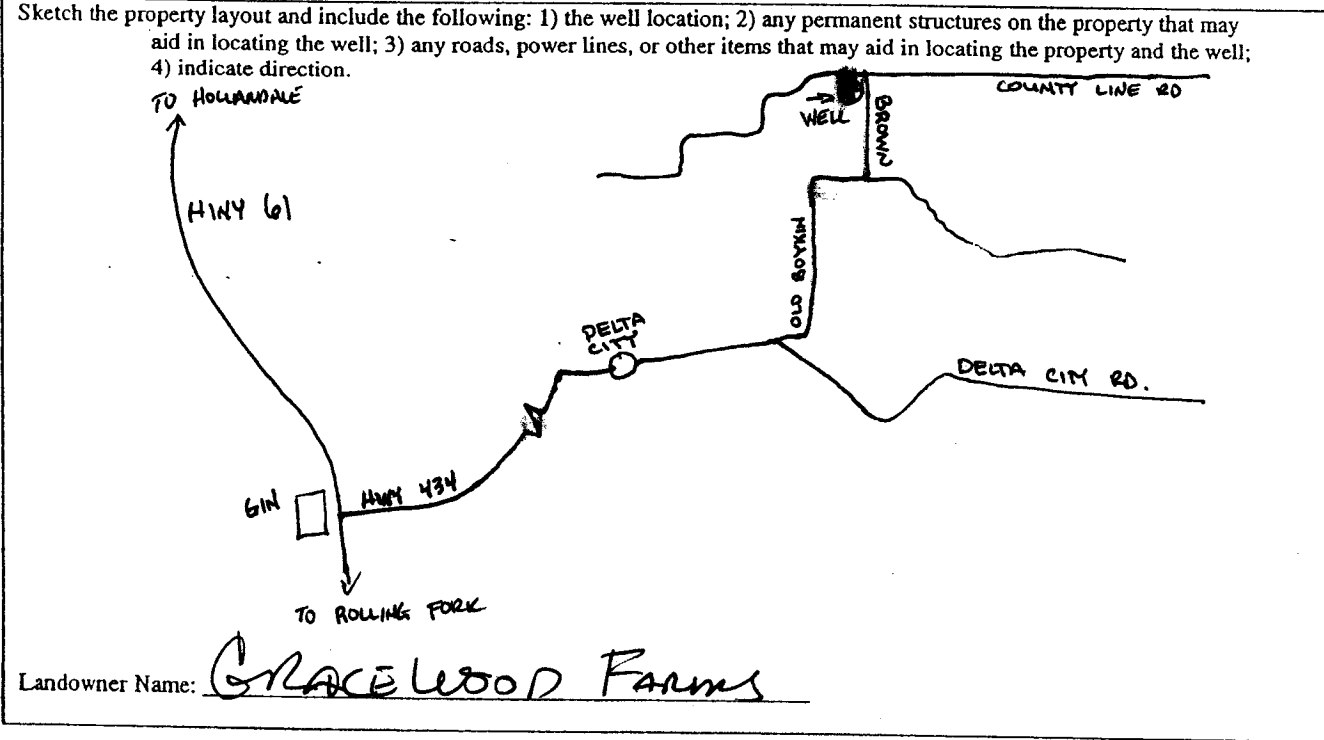

Ed Newcome  
Signature of Water Well Contractor

# STATE WELL REPORT

## Part 2

Pump Installer's Completion Report  
Mississippi Department of Environmental Quality  
Office of Land and Water Resources  
P.O. Box 10631  
Jackson, MS 39289-0631  
(601)961-5210  
(601)354-6938 (fax)

For Office Use Only:

Aquifer: \_\_\_\_\_  
Well #: A-152  
Elevation: \_\_\_\_\_

County: SHARKEY  
Permit #: 6W42403  
Driller: J. NEWCOME 0-773  
Date completed: 3-18-08

This report should be prepared by the pump installer in detail and filed with the Department within 30 days of the installation of pump.

Well Owner Information	Well Location
Owner Name: <u>GRACEWOOD FARMS</u>	Latitude: <u>33-05-45</u> Longitude: <u>90-46-13</u>
Mailing Address: <u>C/O BENE STOCK</u> <u>1371 MURPHY RD.</u> <u>HAYLANDALE, MS 38748</u>	Method of Lat/Long (circle one): Conventional Survey, USGS quad, <u>Hand-held GPS</u> , Survey-grade GPS
City: _____ State: _____ Zip Code: _____	<u>NE</u> ¼ <u>NW</u> ¼ Sec <u>1</u> Twn <u>14N</u> Rng <u>6W</u>
Telephone No.: <u>662-820-6168</u>	Distance: <u>1.5</u> Miles Direction: <u>NE</u> of Nearest Town: <u>DELTA CITY</u>

Pump Type Circle one	Power Type Circle one
Air Lift: Jet <input type="checkbox"/> <u>Submersible</u> <input checked="" type="checkbox"/>	Diesel Engine <input type="checkbox"/> Gasoline Engine <input type="checkbox"/> Natural Gas <input type="checkbox"/>
Bucket: Piston <input type="checkbox"/> Turbine <input type="checkbox"/>	<u>Electric Motor</u> <input checked="" type="checkbox"/> Hand <input type="checkbox"/> Tractor PTO <input type="checkbox"/>
Centrifugal: Rotary <input type="checkbox"/> Flowing Well <input type="checkbox"/>	Windmill <input type="checkbox"/> Other (specify): _____
Other (specify): _____	Horse Power Rating of Motor: <u>50</u>
Date Pump Installed: <u>3-20-08</u>	Setting Depth: <u>70</u> feet
Rated Pump Capacity: <u>1500</u> Gallons Per Minute	Number of Stages: <u>1-Stage 10" Pump</u>

Pump Test Data	Method of Measuring Water Level Circle one
Date Well Tested: _____	Air Line <input type="checkbox"/> Electric Measuring Line <input type="checkbox"/> Steel Tape <input type="checkbox"/>
Static Water Level (A): <u>NO TEST</u> Feet Below Land Surface	Other (specify): _____
Pumping Water Level (B): _____ Feet Below Land Surface	For flowing well, measured shut in head: _____ feet
Drawdown [(B) - (A)]: _____ Feet Below Land Surface	Well yielded _____ GPM with a drawdown of _____ feet after _____ hours of pumping
Test Pumping Rate: _____ Gallons Per Minute	
Duration of Pump Test (minimum 4 hours): _____ hours	

I HEREBY CERTIFY that the above statements are true to the best of my knowledge.

GLEN ROWE #710-P  
Print Name of Pump Installer and License No. (if applicable)

[Signature]  
Signature of Pump Installer

RECEIVED  
APR 10 2008  
BY: OLWR