

### STATE WELL REPORT

#### Part 1

#### Driller's Log

Mississippi Department of Environmental Quality  
 Office of Land and Water Resources  
 P.O. Box 2309  
 Jackson, MS 39225-2309  
 (601)961-5555  
 (601)961-5228 (fax)

County: SCOTT  
 Permit #: THOMAS DRILLING  
 Driller: THOMAS DRILLING  
 Date drilling completed: 11/8/17

**For Office Use Only:**  
 Well #: 656  
 Aquifer: \_\_\_\_\_  
 E-Log #: \_\_\_\_\_

*State Law requires that this report be prepared by the license holder responsible for the work and filed with the Department at the above address within 30 days of completion of drilling of the well or borehole.*

<b>Well Owner Information</b> <i>(Landowner if borehole is not for a water well)</i> Owner Name: <u>DON HUFF</u> Mailing Address: <u>1819 OLD HILLSBORO RD</u> <u>FOREST MS 39074</u> City State Zip Code Telephone No. ( <u>601</u> ) <u>469-3553</u>			<b>Well or Borehole Location</b> Latitude: <u>32°24'3.07"N</u> Longitude: <u>89°28'35.19"W</u> Method of Lat/Long (check one): Conventional Survey _____, Hand-held GPS <input checked="" type="checkbox"/> , Survey-grade GPS _____ USGS quad _____, Hand-held GPS <input checked="" type="checkbox"/> , Survey-grade GPS _____ <u>SE ¼ SE ¼, Sec 33 ✓ T 7N ✓ R 8E ✓</u> <u>3</u> Miles <u>N</u> of <u>FOREST</u> (Distance) (Direction) (Nearest Town)		
--	--	--	--	--	--

**Well / Borehole Data**

Date drilling started: 11/8/17 Date drilling completed: 11/8/17 Hole depth: 220 Hole diameter: 4

Location of the source of any surface water used for drilling: \_\_\_\_\_

Method of dosing and volume of Chlorine used in drilling and development: 1lbs IN TENDER AND WASH

Logs run (check all applicable):  log run  Electric  Gamma Ray  Density  Sonic  Neutron Other: \_\_\_\_\_

Name of organization running log(s): \_\_\_\_\_

Purpose of borehole (check one): Water Well  Geotechnical/Geological Investigation  Ground Source Heat Pump  Seismic Survey Other (describe) \_\_\_\_\_

*If drilling is not related to water well construction, skip the remainder of this block*

Purpose of Well (check all applicable):  Home  Industrial  Public Supply  Irrigation  Fish Culture

Other (describe): \_\_\_\_\_

If a flowing well, method of flow regulation: Valve \_\_\_\_\_ Other (describe) \_\_\_\_\_

Static Water Level: 74 feet  above or  below land surface Date measured: 11/8/17  
 (check one)

Method of measurement (check one)  Steel tape  Electric tape  Air line  Other (describe): \_\_\_\_\_

Well depth: 220 Well grouted to a depth of: 30 feet Type of grout (check one)  Neat Cement  Bentonite  Mix

Casing length: 200 feet Casing diameter: 4 inches Type of casing: PVC

Screen length: 20 feet Screen diameter: 4 inches Type of screen: PVC

Screen slot size: .010 inches Setting depth: From 200 feet to 220 feet

Type of completion (check all applicable)  gravel packed  Underreamed  Open hole  Natural Development

Other (describe): \_\_\_\_\_

Top of lap pipe or reduction in casing: \_\_\_\_\_ feet

*If telescoped or more than one screen, describe on next page*

County: SCOTT  
 Permit #: \_\_\_\_\_

**For Office Use Only:**  
 Well #: 656

The sketch below only required for water wells

If well telescopes, show depths on sketch.

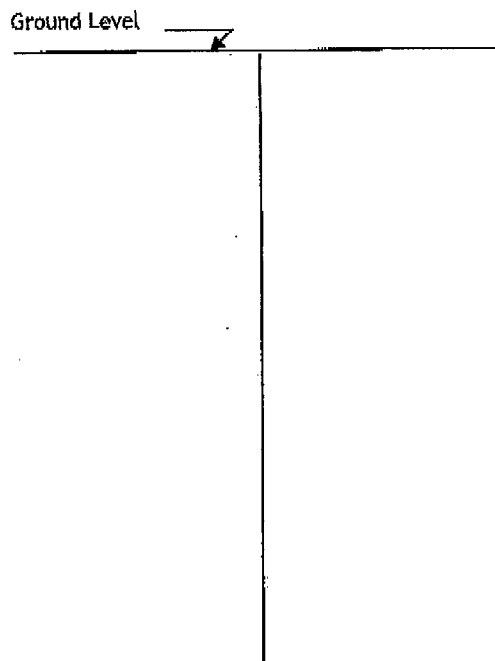

Description of formations encountered must be provided for all wells and boreholes, unless specifically exempted by regulations

Description of Formations Encountered	From (depth) To (depth)	
	Ground level	
YELLOW PRAIRIE CLAY	0	18
SOFT GRAY CLAY	18	40
ROCK	40	44
GRAY CLAY	44	56
SANDSTONE	56	58
GRAY CLAY W/ STREAKS	58	123
GRAY SAND MIXED W/CLAY	123	142
CLAY	142	145
GRAY SAND	145	157
CLAY/SAND/LIGNITE	157	165
SAND W/LIGNITE	165	185
GRAY SAND	185	225

If more than one screen, show location of each on sketch

Sketch the property layout and include the following:

- 1) the well location
- 2) any permanent structures on the property that may aid in locating the well
- 3) any roads, power lines, or other items that may aid in locating the property and the well
- 4) north arrow

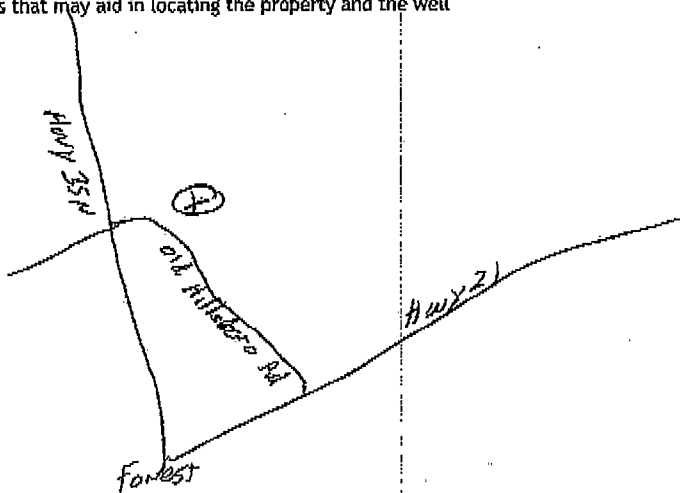

Landowner Name: DON HUFF

I HEREBY CERTIFY that the well/borehole was drilled, constructed, and completed in accordance with all applicable requirements of the Mississippi Department of Environmental Quality and the Mississippi Department of Health regulations, if applicable, and state laws.

DAVID S THOMAS

11/8/17

Print Name of Responsible Licensee and License No.

Date

Signature of Licensee

Form: OLWR-SWR-1B (4/13)

**STATE WELL REPORT**

**Part 2**

**Pump Installer's Completion Report**  
 Mississippi Department of Environmental Quality  
 Office of Land and Water Resources  
 P.O. Box 2309  
 Jackson, MS 39225-2309  
 (601)961-5210  
 (601) 360-0535 (fax)

County: SCOTT  
 Permit #: \_\_\_\_\_  
 Driller: THOMAS DRILLING  
 Date completed: 11/16/17  
*Copy information from block on Part 1*

**For Office Use Only:**  
 Well #: G56  
 Aquifer: \_\_\_\_\_

*This part of the report must be completed by a licensed water well contractor or a licensed pump installer. A copy of Part 1 of the report must be attached and both parts filed with the Department at the above address within 30 days of well completion.*

Well Owner Information			Well Location	
Owner Name: <u>DON HUFF</u>			Latitude: <u>32°24'3.07"N</u>	Longitude: <u>89°28'35.19"W</u>
Mailing Address: <u>1819 OLD HILLSBORO RD</u>			Method of Lat/Long (check one): Conventional Survey _____	
<u>FOREST</u>	<u>MS</u>	<u>39074</u>	USGS quad _____	Hand-held GPS <input checked="" type="checkbox"/> Survey-grade GPS _____
City	State	Zip Code	<u>SE 1/4 SE 1/4, Sec 33</u>	<u>T 7N R 8E</u>
Telephone No. ( <u>601</u> ) <u>469-3553</u>			<u>3</u> Miles <u>N</u> of <u>FOREST</u>	(Distance) (Direction) (Nearest Town)

**Pump Type (check one)**  
 Submersible  Turbine  Air Lift  Centrifugal  Flowing Well  Jet  Piston  Rotary  Other (describe): \_\_\_\_\_  
 Date Pump Installed: 11/16/17 Rated Pump Capacity: 10 Gallons Per Minute  
 Is This Pump (check one):  New  Repaired  Replacement

**Power Type (check one)**  
 Electric  Diesel  Gasoline  Natural Gas  Tractor PTO  Windmill  Other (describe): \_\_\_\_\_  
 Horse Power Rating of Motor: 1HP Setting Depth: 120 feet Number of Stages: 9

**Pump Test Data for Non Flowing Well**  
 Date Well Tested: 11/16/17 Duration of Pump Test (minimum 4 hours): \_\_\_\_\_ hours  
 Static Water Level (A): 74 Feet Below Land Surface Pumping Water Level (B): 120 Feet Below Land Surface  
 Drawdown [(B) - (A)]: 46 Feet Below Land Surface Test Pumping Rate: 30 Gallons Per Minute  
 Method of measurement (check one): Steel tape  Electric tape  Air line  Other (describe): \_\_\_\_\_

**Pump Test Data for Flowing Well**  
 Measured shut in head: \_\_\_\_\_ feet.  
 Well yielded \_\_\_\_\_ GPM with a drawdown of \_\_\_\_\_ feet after \_\_\_\_\_ hours of pumping

**Meter Installation**  
 Meter Manufacturer: \_\_\_\_\_ Meter Serial Number: \_\_\_\_\_  
 Meter Model Number/Name: \_\_\_\_\_ Type of Meter: \_\_\_\_\_  
 Totalizer Register Unit and Multiplier Factor (AF x .001, gal x 1000, etc): \_\_\_\_\_  
 Installation Date: \_\_\_\_\_ Meter installed by: \_\_\_\_\_  
 Is This Meter (check one):  New  Repaired  Replacement  
*Important: By submitting the above information you are certifying that this meter was installed to manufacturer standards. For agricultural wells, a list of approved meters is on the MDEQ website.*

I HEREBY CERTIFY that the above statements are true to the best of my knowledge.  
DAVID S THOMAS 0-147 11/16/17  
 Print Name of Pump Installer and License No. (if applicable) Date Signature of Pump Installer