

County: Rankin
 Permit #: _____
 Driller: Water Well Services
 Date drilling completed: 6-14-07

State Well Report

Part 1

Mississippi Department of Environmental Quality
 Office of Land and Water Resources
 P.O. Box 10631
 Jackson, MS 39289-0631
 (601)961-5210
 (601)354-6938 (fax)

For Office Use Only:
 Aquifer: V91
 Well #: _____
 L.S. Elevation: _____
 E-log #: V0091

State Law requires that this report be prepared by the driller in detail and filed with the Department within 30 days of completion of drilling of the well.

Well Owner Information	Well Location
Owner Name: <u>Johany ELLZY</u>	Latitude: <u>32° 05' 11" N</u> Longitude: <u>90° 01' 24" W</u>
Mailing Address: <u>1983 clarity Rd.</u>	Method of Lat/Long (circle one): <u>Conventional Survey</u>
<u>Florence MS 39073</u>	USGS quad, Hand-held GPS, Survey-grade GPS
City State Zip Code	<u>1/4 Sec 19 Twn 3 N Rng 3 E</u>
Telephone No. (601): <u>845-5718</u>	Distance Direction Nearest Town
	<u>2 Miles East of Star</u>

Well Data

Purpose of Well (circle one): Home Industrial Public Supply Irrigation Fish Culture Other: _____

Date well drilling started: 6-14-07 Date well drilling completed: 6-20-07

If flowing, method of flow regulation: Valve _____ Other (describe) _____

Static Water Level: _____ feet above or below (circle one) land surface Date measured: _____

Method of Measurement (circle one) steel tape electric tape air line other: _____

Hole depth: 600' Well depth: _____ Well grouted to a depth of _____ feet

Type of grout (circle one): Cement Bentonite Mix

Casing length: _____ feet Casing diameter: _____ inches Type of casing: _____

Screen length: _____ feet Screen diameter: _____ inches Type of screen: _____

Screen slot size: _____ inches Setting depth: From _____ feet to _____ feet

Type of completion (circle all applicable): Gravel packed Underreamed Telescoped Open hole Natural Development

Other (describe): _____

Top of lap pipe or reduction in casing: _____ feet. If telescoped or more than one screen, describe on back of page

Logs run (circle all applicable): No log run Electric Gamma Ray Density Sonic Neutron Other: _____

Name of organization running log(s): M.D.E.Q.

I certify that the well was drilled, constructed, and completed in accordance with all applicable requirements of the Mississippi Department of Environmental Quality and/or the Mississippi Department of Health regulations and state laws.

Arnold Fischer Sr
Carl Lutz #0-560 MS
 Print Name of Water Well Contractor and License No. Signature of Water Well Contractor

LOG hole only NO well made
 Hole Plugged

V91

If well telescopes please sketch below and show depths.

Ground Level

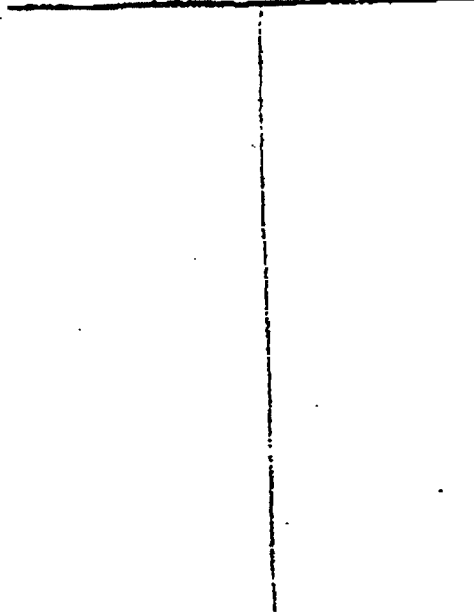

Description of Formations Encountered	From	To
Hard clay	0	115
Shale	115	135
Sand & clay streaks	135	160

If more than one screen, show location of each on sketch

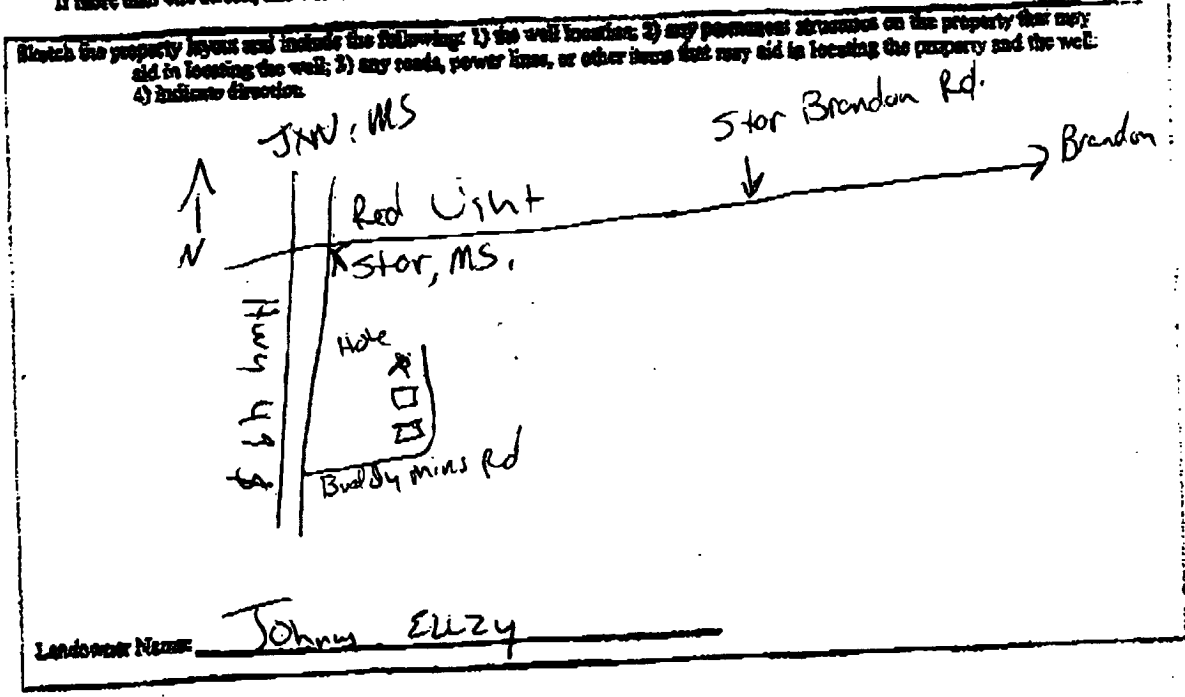

Landowner Name: Johnny Elzy

Signature of Water Well Contractor: [Handwritten Signature]