

GW48999

State Well Report

Part I - Driller's Log

Mississippi Department of Environmental Quality
Office of Land and Water Resources
P.O. Box 2309
Jackson, MS 39225
(601)961- 5210
(601)961- 5228 (fax)

For Office Use Only:

Aquifer:
Well #: L83
L. S. Elevation:
E-log #:

County: Quitman
Permit #: GW-47170?
Driller: Joel Jumper
Date drilling completed: 1-30-14

State Law requires that this report be prepared by the license holder responsible for the work and filed with the Department at the above address within 30 days of completion of drilling of the well or borehole.

Information on Well Owner (Landowner if borehole is not for a water well)
Owner Name: Chris Crawford
Mailing Address: Po Box 1398
Lambert Ms 38643
City State Zip Code
Telephone No.
Well or Borehole Location
Latitude: 34° 8' 45" Longitude: 90° 14' 47"
Method of Lat/Long (circle one): Conventional Survey, Hand-held GPS, Survey-grade GPS
USGS quad, NE 1/4 Sec 12, Twn 26N, Rng 01W
Distance 3 Miles Direction E of Nearest Town Lambert

Well / Borehole Data
Date drilling started: 1-30-14 Date drilling completed: 1-30-14 Hole depth: 110 Hole diameter: 28 in
Location of the source of any surface water used for drilling: Nearest Well
Method of dosing and volume of Chlorine used in drilling and development:
Logs run (circle all applicable): No log run Electric Gamma Ray Density Sonic Neutron Other:
Name of organization running log(s):
Purpose of borehole (check one): Water Well Geotechnical/Geological Investigation Ground Source Heat Pump
Seismic Survey Other (describe)

If drilling is not related to water well construction, skip the remainder of this block
Purpose of Well (check one): Home Industrial Public Supply Irrigation Fish Culture Other:
If a flowing well, method of flow regulation: Valve Other (describe)
Static Water Level: 12 feet above or below (circle one) land surface Date measured: 1-30-14
Method of Measurement (circle one) steel tape electric tape air line other:
Well depth: 110 Well grouted to a depth of 10 feet Type of grout (circle one): Neat Cement Bentonite Mix
Casing length: 70 feet Casing diameter: 16 inches Type of casing: PVC
Screen length: 40 feet Screen diameter: 16 inches Type of screen: PVC
Screen slot size: 0.50 inches Setting depth: From 0-40 feet to 70 feet
Type of completion (circle all applicable): Gravel packed Underreamed Telescoped Open hole Natural Development
Other (describe):
Top of lap pipe or reduction in casing: feet. If telescoped or more than one screen, describe on next page

Form: OLWR-SWR-1A (04/08)

RECEIVED

FEB 10 2014

By: OLWR

The sketch below only required for water wells

If well telescopes, show depths on sketch.

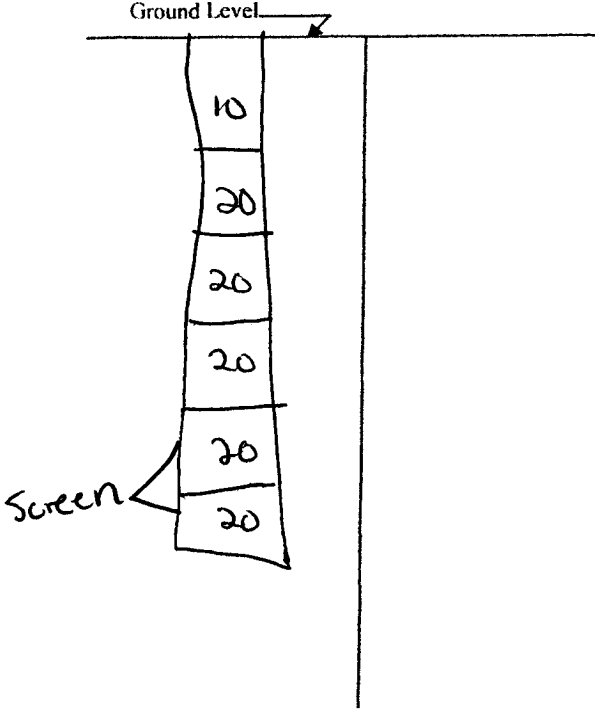

Description of formations encountered must be provided for all wells and boreholes, unless specifically exempted by regulations

Description of Formations Encountered	From (depth)	To (depth)
	Ground Level	20
Clay	20	40
Clay	40	60
Sand	60	80
course sand	80	100
gravel + sand	100	110
gravel + sand		
after III clay		

If more than one screen, show location of each on sketch

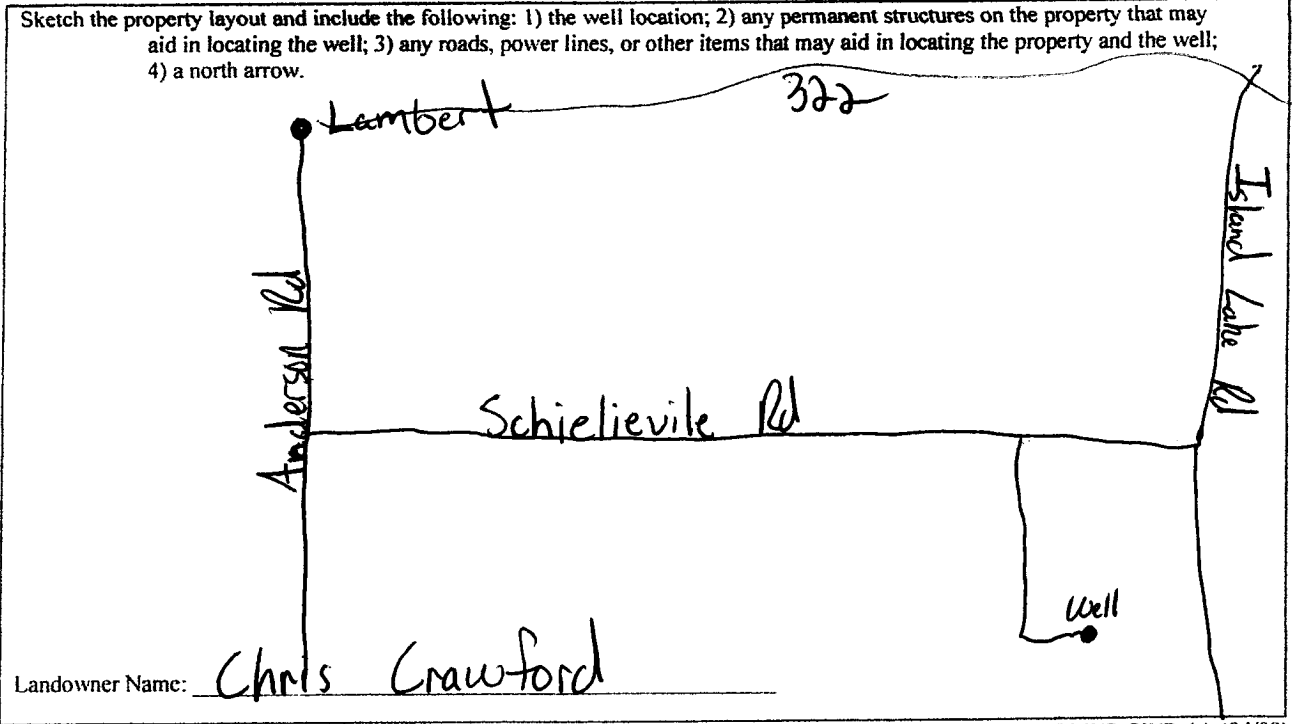

Form: OLWR-SWR-1A (04/08)

I certify that the well/borehole was drilled, constructed, and completed in accordance with all applicable requirements of the Mississippi Department of Environmental Quality and the Mississippi Department of Health regulations, if applicable, and state laws.

Joel Jumper 5317 1-30-14

Print Name of Responsible Licensee and License No. Date

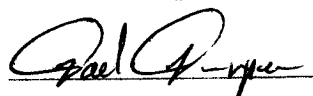
 Signature of Licensee

RECEIVED

FEB 10 2014

BY: OLWR